

6/26/12

# Plot Plan

# # 351-A-28

85' ±

I was in error on my condition for the rear deck. It was permitted in 1996

R-2 zone requires 10'

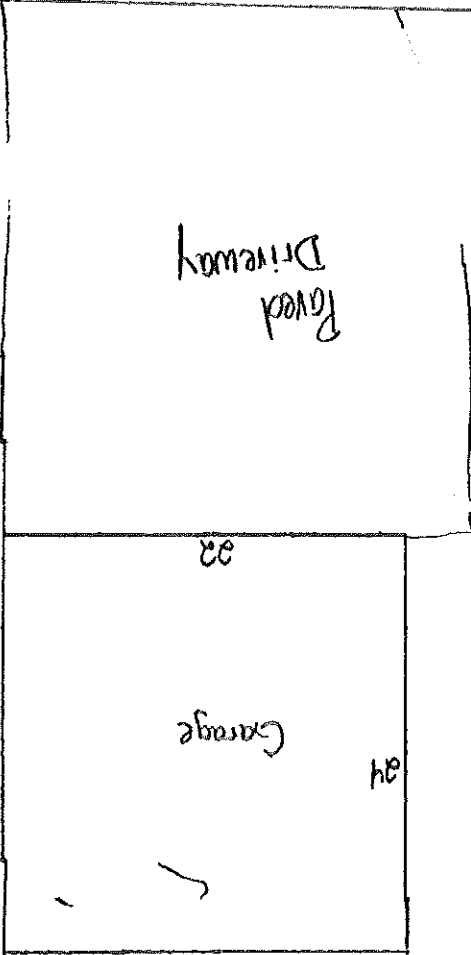
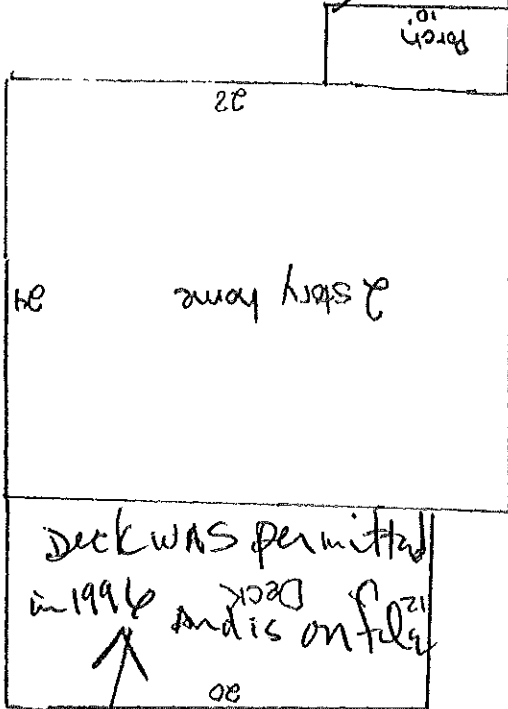

Requested permits for Deck & Shed

None shown on file part of conditions. This permit does NOT validate them

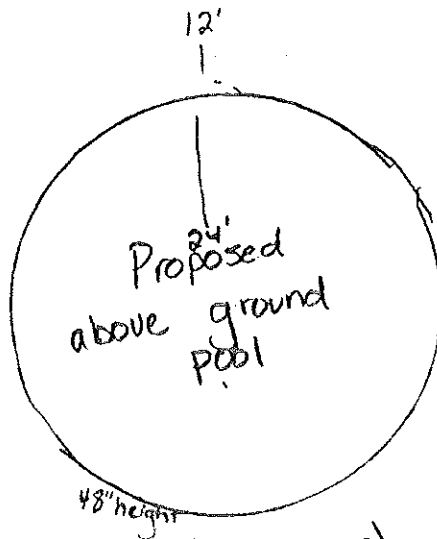
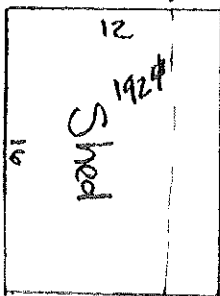

12  
24  
12  
44

13.5' ± set back from property line

Access pool with removable ladder

Assumed 10' to Rear PL  
Code Enforcement officer to verify 10' min setback

25' ±

please check off the appropriate description

**FOUNDATION**

Frost Wall, min 4" below grade. 8" thick

Sono Tube, 4" below grade. 6" min. on footing, hard pan or bedrock. (12" Ø Sono Tubes)

Other \_\_\_\_\_

Size \_\_\_\_\_ Distance between foundation supports

SILL

SPAN OF SILL

JOISTS SPAN

JOISTS SIZE

(10' to Carry Beam)

8' 12' w/ 2 (2x12's) @ 10' + 1 (4x4")

2 x 6  2 x 8 \_\_\_\_\_ 2 x 10 \_\_\_\_\_

DISTANCE BETWEEN JOISTS

16" O.C. \_\_\_\_\_ 24" O.C. \_\_\_\_\_ other \_\_\_\_\_

DECKING

5/4 \_\_\_\_\_ other explain \_\_\_\_\_

GUARD HEIGHT

36" \_\_\_\_\_ 42" \_\_\_\_\_

DISTANCE BETWEEN BALUSTER

4" spacing between \_\_\_\_\_

STAIR CONSTRUCTION

minimum 9" tread maximum 8 1/4" rise

please use space below for drawing of deck with measurements.

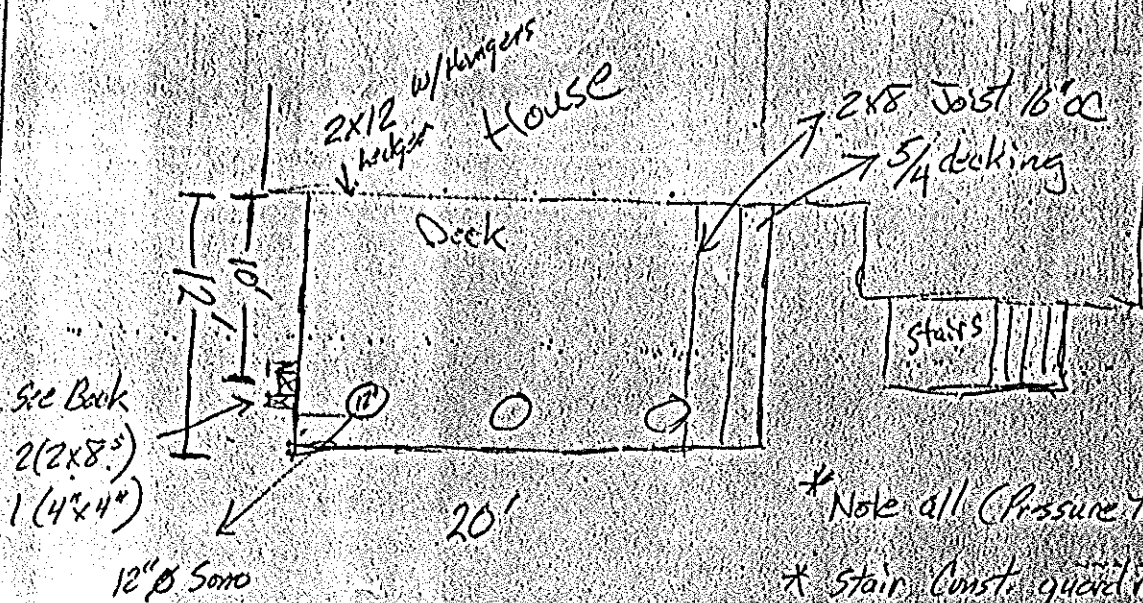

\* Note all (Pressure treated)

\* Stair Const. guard rails will be required on side of stair system

\* Note see back for Post 4x4 Vertical placement

PS - Include Plot Plan for Permit Application

Applicant: Tracey Corbex  
Address: 104 Shepherd Lane  
Assessors No.: 351-A-28

Date: 5/14/96

CHECK LIST AGAINST ZONING ORDINANCE

Date - Existing 1995

Zone Location - R-2

Interior or corner lot -

Use - Attached Deck 12' x 20'

Sewage Disposal - City

Rear Yards - 25' req - 75' shown

Side Yards - 12' req - 20' shown

Front Yards - N/A

Projections -

Height - 1 story

Lot Area - 10,000<sup>sq ft</sup> req 13,733<sup>sq ft</sup> shown

Building Area - MAX 20% of lot coverage = 2746.6<sup>sq ft</sup> MAX

Area per Family -

Width of Lot -

Lot Frontage -

Off-street Parking -

Loading Bays -

Site Plan - N/A

Shoreland Zoning - N/A

Flood Plains -

$$24 \times 28 = 672^{\text{sq ft}}$$

$$22 \times 24 = 528^{\text{sq ft}}$$

$$6 \times 10 = 60^{\text{sq ft}}$$

$$\text{NEW} \rightarrow 12 \times 20 = 240^{\text{sq ft}}$$

$$1500^{\text{sq ft}}$$