

PERMIT ISSUED

City of Portland, Maine - Building or Use Permit Application

389 Congress Street, 04101 Tel: (207) 874-8703, Fax: (207) 874-8716

| | | |
|-----------------------|---------------------------|---------------------|
| Permit No: 02-0155 | Queue Date: 2002 MAR 1 | CBL: 850 A018001 |
|-----------------------|---------------------------|---------------------|

| | | | |
|---------------------------------------------|---------------------------------|----------------------------------------------|------------------------|
| Location of Construction: 71 Primrose Ln | Owner Name: Zutter Brian A & | Owner Address: 71 Primrose Ln 828 7287 | Phone: 207-878-8339 |
| Business Name: n/a | Contractor Name: n/a | Contractor Address: n/a Portland | Phone: |
| Lessee/Buyer's Name n/a | Phone: n/a | Permit Type: Alterations - Dwellings | Zone: |

| | | | | |
|--------------------------------------------------------------------------|---------------------------------------------------------------------------------------------------------------------------------------------------------------|------------------------------------------------------------------------------------------------------|----------------------------------------------------|--------------------|
| Past Use: Single Family | Proposed Use: Single Family / Interior renovations; opening up 2 rooms into 1 room by installing an I-Beam, which measures 8" tall & 5 1/4" wide. | Permit Fee: \$51.00 | Cost of Work: \$4,000.00 | CEO District: 2 |
| Proposed Project Description: Interior renovations, installing I-Beam | | FIRE DEPT: N/A <input type="checkbox"/> Approved <input checked="" type="checkbox"/> Denied | INSPECTION: Use Group: R3 Type: SB BOCA 1999 | |

| | |
|--------------------------------------------------------------------------------------------------------------------------|---------------------------|
| Signature: | Signature: T. [Signature] |
| PEDESTRIAN ACTIVITIES DISTRICT (P.A.D.) | |
| Action: <input type="checkbox"/> Approved <input type="checkbox"/> Approved w/Conditions <input type="checkbox"/> Denied | |
| Signature: | Date: |

| | | | |
|------------------------|---------------------------------|------------------------|--|
| Permit Taken By: gg | Date Applied For: 02/27/2002 | Zoning Approval | |
|------------------------|---------------------------------|------------------------|--|

| | | | |
|-----------------------------------------------------------------------------------------------------------------------------------------------------------------------------------------------------------------------------------------------------------------------------------------------------------------------------------------------------------------------------------------------------------------------------|------------------------------------------------------------------------------------------------------------------------------------------------------------------------------------------------------------------------------------------------------------------------------------------------------------------------------------------|-----------------------------------------------------------------------------------------------------------------------------------------------------------------------------------------------------------------------------------------------------------------------------|-------------------------------------------------------------------------------------------------------------------------------------------------------------------------------------------------------------------------------------------------------------------------------------------------------------------------------------------|
| <ol style="list-style-type: none"> This permit application does not preclude the Applicant(s) from meeting applicable State and Federal Rules. Building permits do not include plumbing, septic or electrical work. Building permits are void if work is not started within six (6) months of the date of issuance. False information may invalidate a building permit and stop all work.. | Special Zone or Reviews <input type="checkbox"/> Shoreland <input type="checkbox"/> Wetland <input type="checkbox"/> Flood Zone <input type="checkbox"/> Subdivision <input type="checkbox"/> Site Plan Maj <input type="checkbox"/> Minor <input type="checkbox"/> MM <input type="checkbox"/> Date: 3/7/02 | Zoning Appeal <input type="checkbox"/> Variance <input type="checkbox"/> Miscellaneous <input type="checkbox"/> Conditional Use <input type="checkbox"/> Interpretation <input type="checkbox"/> Approved <input type="checkbox"/> Denied Date: | Historic Preservation <input checked="" type="checkbox"/> Not in District or Landmark <input type="checkbox"/> Does Not Require Review <input type="checkbox"/> Requires Review <input type="checkbox"/> Approved <input type="checkbox"/> Approved w/Conditions <input type="checkbox"/> Denied Date: 3/7/02 |
|-----------------------------------------------------------------------------------------------------------------------------------------------------------------------------------------------------------------------------------------------------------------------------------------------------------------------------------------------------------------------------------------------------------------------------|------------------------------------------------------------------------------------------------------------------------------------------------------------------------------------------------------------------------------------------------------------------------------------------------------------------------------------------|-----------------------------------------------------------------------------------------------------------------------------------------------------------------------------------------------------------------------------------------------------------------------------|-------------------------------------------------------------------------------------------------------------------------------------------------------------------------------------------------------------------------------------------------------------------------------------------------------------------------------------------|

CERTIFICATION

I hereby certify that I am the owner of record of the named property, or that the proposed work is authorized by the owner of record and that I have been authorized by the owner to make this application as his authorized agent and I agree to conform to all applicable laws of this jurisdiction. In addition, if a permit for work described in the application is issued, I certify that the code official's authorized representative shall have the authority to enter all areas covered by such permit at any reasonable hour to enforce the provision of the code(s) applicable to such permit.

| | | | |
|---------------------------------------------|---------|------|-------|
| SIGNATURE OF APPLICANT | ADDRESS | DATE | PHONE |
| RESPONSIBLE PERSON IN CHARGE OF WORK, TITLE | | DATE | PHONE |

All Purpose Building Permit Application

If you or the property owner owes real estate or personal property taxes or user charges on any property within the City, payment arrangements must be made before permits of any kind are accepted.

| | | |
|-----------------------------------------------------------------------------------------------------------------------------------------------------------------------------------------------------------------------------------------------------------------------------------------------------|-------------------------------------------------------------------------------------------------------------------|--------------------------------------------------------------|
| Location/Address of Construction: <u>71 PRIMROSE LANE</u> | | |
| Total Square Footage of Proposed Structure | | Square Footage of Lot |
| Tax Assessor's Chart, Block & Lot Chart# <u>350</u> Block# <u>A</u> Lot# <u>018</u> | Owner: <u>ALISON & BRIAN ZUTTER</u> | Telephone: <u>878-8339</u> |
| Lessee/Buyer's Name (If Applicable) | Applicant name, address & telephone: <u>David Bunge</u> <u>13 Belmont St.</u> <u>Brunswick, ME 04011</u> | Cost Of Work: \$ <u>4,000.00</u> Fee: \$ <u>51.00</u> |
| Current use: <u>Residential</u> | | |
| If the location is currently vacant, what was prior use: <u>NO</u> | | |
| Approximately how long has it been vacant: _____ | | |
| Proposed use: <u>EXISTING SPACE, OPENING UP 2 ROOMS INTO 1 ROOM, BY</u> Project description: <u>INSTALLING AN L BEAM, WHICH MEASURES 8" TALL + 5 1/4" WIDE.</u> | | |
| Contractor's name, address & telephone: | | |
| Who should we contact when the permit is ready: <u>DAVID BUNGE x x 725 4201</u> | | |
| Mailing address: <u>13 Belmont St.</u> <u>Brunswick, ME 04011</u> | | |
| We will contact you by phone when the permit is ready. You must come in and pick up the permit and review the requirements before starting any work, with a Plan Reviewer. A stop work order will be issued and a \$100.00 fee if any work starts before the permit is picked up. PHONE: _____ | | |

IF THE REQUIRED INFORMATION IS NOT INCLUDED IN THE SUBMISSIONS THE PERMIT WILL BE AUTOMATICALLY DENIED AT THE DISCRETION OF THE BUILDING/PLANNING DEPARTMENT, WE MAY REQUIRE ADDITIONAL INFORMATION IN ORDER TO APPROVE THIS PERMIT.

I hereby certify that I am the Owner of record of the named property, or that the owner of record authorizes the proposed work and that I have been authorized by the owner to make this application as his/her authorized agent. I agree to conform to all applicable laws of this jurisdiction. In addition, if a permit for work described in this application is issued, I certify that the Code Official's authorized representative shall have the authority to enter all areas covered by this permit at any reasonable hour to enforce the provisions of the codes applicable to this permit.

| | |
|--------------------------------------------|----------------------|
| Signature of applicant: <u>[Signature]</u> | Date: <u>2/26/02</u> |
|--------------------------------------------|----------------------|

This is NOT a permit, you may not commence ANY work until the permit is issued.
If you are in a Historic District you may be subject to additional permitting and fees with the Planning Department on the 4th floor of City Hall

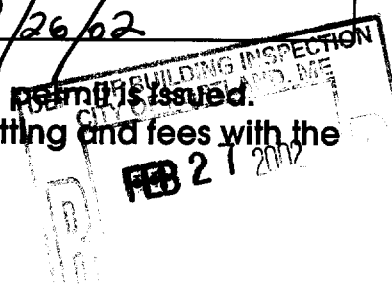

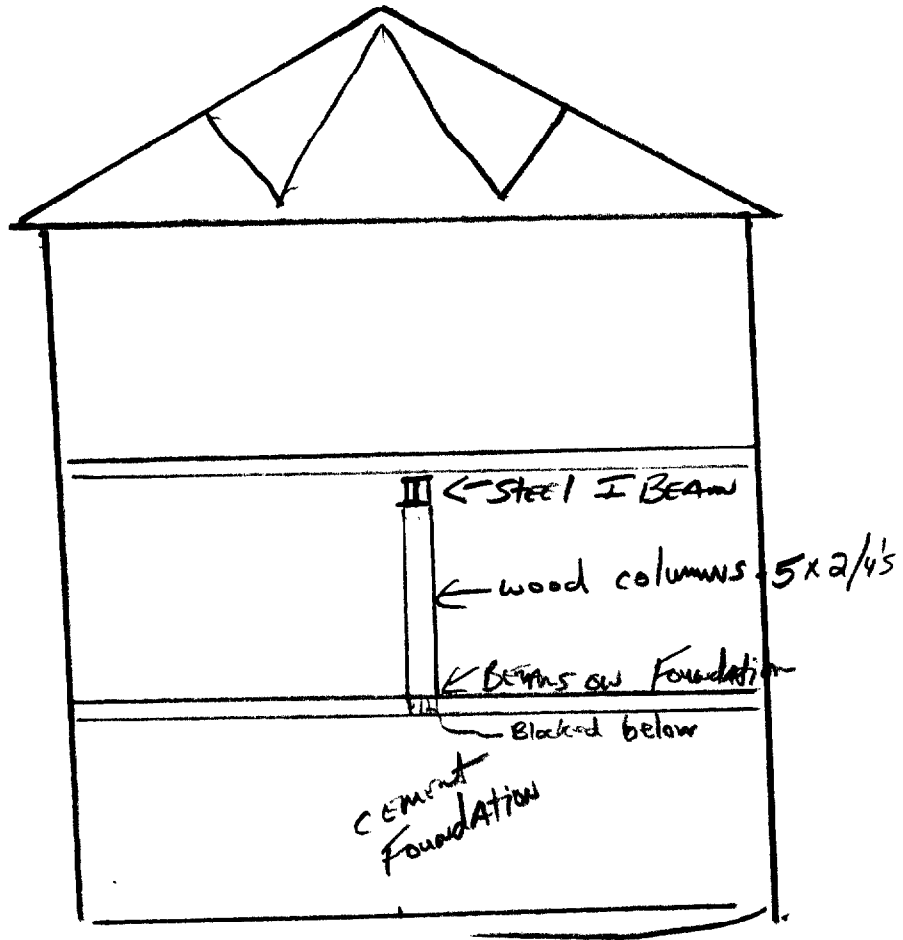

- * REMOVING EXISTING 14' WALL + putting in 16' STEEL BEAM
- * there is NO ROOF load on beam, only 2nd Floor joists
- * BEAM spec. by Eng. FROM DOWN EAST ENERGY

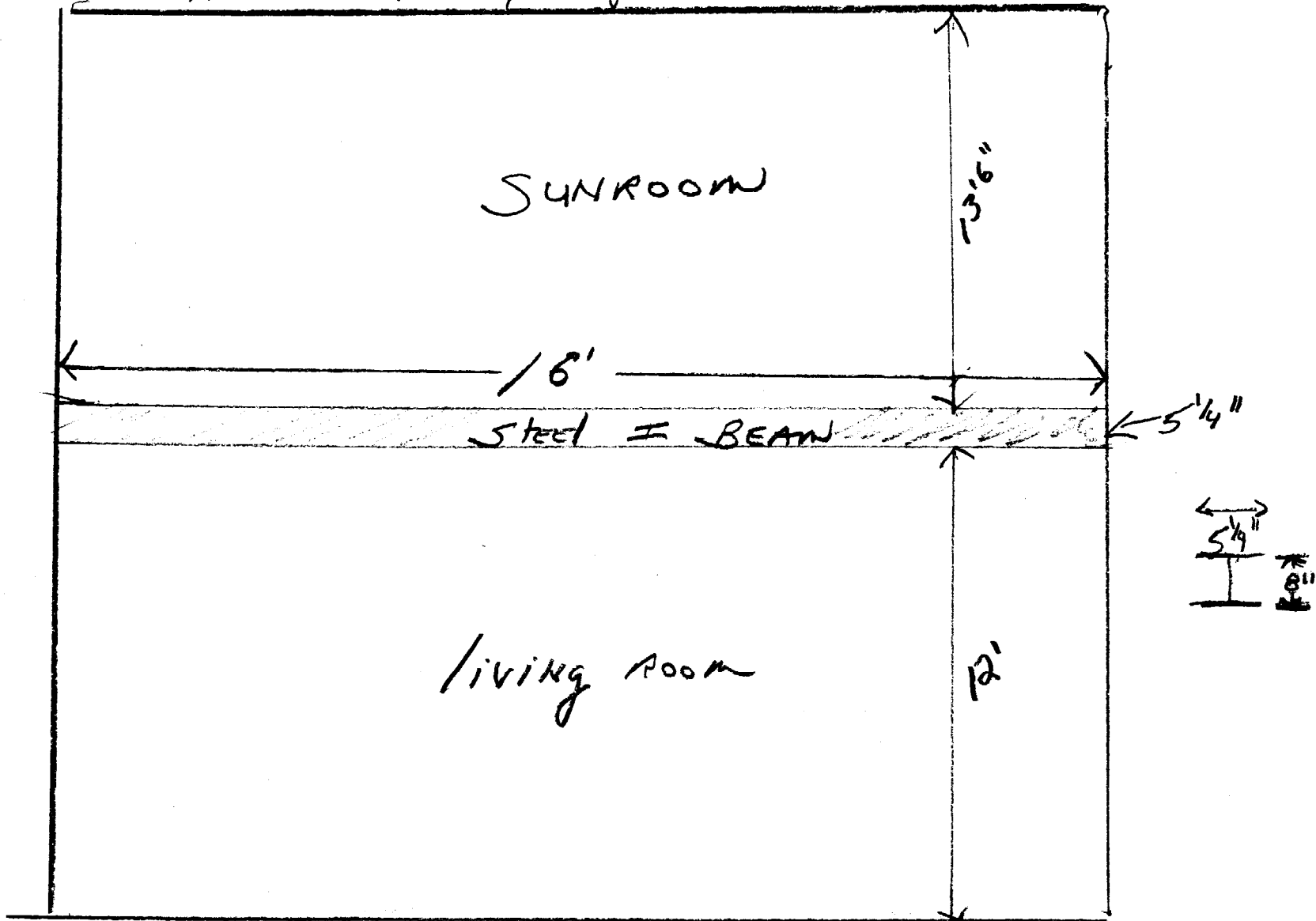



DOWNEAST BUILDING SUPPLY

Good Friends For All Seasons

PO BOX 250, 18 SPRING ST.
BRUNSWICK, ME 04011

****FACSIMILE TRANSMISSION COVER SHEET****

TO: Portland Codes

ATTENTION: Tammy Munson

NUMBER OF PAGES (INC. COVER SHEET) 2

PERSON SENDING TRANSMISSION: Matt Walker

IF YOU HAVE ANY PROBLEMS OR QUESTIONS REGARDING THIS
TRANSMISSION, PLEASE CALL
207-729-9921
FAX# 207-798-5674

*This is the steel sized for the Bunge/Sutter job
on Primrose Ln. (#71) Hope this is satisfactory.*

Matt Walker

This message is intended only for the use of the individual or entity to which it is addressed. If the reader of this message is not the intended recipient, you are hereby notified that any dissemination, distribution or copying of this communication is strictly prohibited. If you have received this communication in error, please notify us immediately by phone.

TELEPHONE 207-784-9371

FAX 207-784-9003

1-800-696-7799

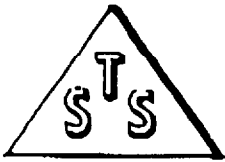

TRI-STATE STEEL INC.

WHOLESALE DISTRIBUTORS OF STEEL PRODUCTS

REMIT TO: P.O. BOX 1207 - Auburn, Maine 04211-1207
 CHASSE ST. & WASHINGTON ST., AUBURN, MAINE 04211-1207

QUOTATION ONLY

S
O
L
D

T
O

DOWNEAST BUILDING SUPPLY
 18 SPRING STREET
 BRUNSWICK, ME 04011
 C/O MATT WALKER

S
H
I
P

T
O

RE: BUNGE PROJECT

TERMS: 1/2 of 1% 10 days. Net 30 days. No Retainage Allowed.

FAX 798-5674

| Customer Order No. | Date Received | Sold By | Cash | C.O.D. | Chg. | Date Shipped | Invoice Date | Shipped Via: |
|--------------------|---------------|---------|------|--------|------|--------------|--------------|--------------|
| | 2-26-02 | | | | | | | O.T. |

| Quantity Ordered | Quantity Shipped | Description | Weight* | Unit Price | Amount |
|------------------|------------------|------------------------------------------------------------------|-----------------|------------|--------|
| | | EIVEN: 1 RES FLOOR LOAD | | | |
| | | AREA 16' x 26' | | | |
| | | CLEAR SPAN - 16' | | | |
| | | LIVE LOAD | 40 [#] | | |
| | | DEAD LOAD | 20 [#] | | |
| | | TOTAL | 60 [#] | | |
| | | $\frac{26'}{2} \times 16' \times 60^{\#} = 12,480^{\#} \sim 16'$ | | | |
| | | $WB \times 21 = 18,000^{\#} \sim 16'$ | | | |
| | | $F_y = 36 \text{ KSI} \quad S_x = 18.2 \text{ IN.}^3$ | | | |

* Weight subject to correction.

BUILDING PERMIT INSPECTION PROCEDURES

Please call 874-8703 or 874-8693 to schedule your inspections as agreed upon

Permits expire in 6 months, if the project is not started or ceases for 6 months.

The Owner or their designee is required to notify the inspections office for the following inspections and provide adequate notice. Notice must be called in 48-72 hours in advance in order to schedule an inspection:

By initializing at each inspection time, you are agreeing that you understand the inspection procedure and additional fees from a "Stop Work Order" and "Stop Work Order Release" will be incurred if the procedure is not followed as stated below.

J.B. **Pre-construction Meeting:** Must be scheduled with your inspection team upon receipt of this permit. Jay Reynolds, Development Review Coordinator at 874-8632 must also be contacted at this time, before any site work begins on any project other than single family additions or alterations.

NA **Footing/Building Location Inspection:** Prior to pouring concrete

NA **Re-Bar Schedule Inspection:** Prior to pouring concrete

NA **Foundation Inspection:** Prior to placing ANY backfill

N.B. **Framing/Rough Plumbing/Electrical:** Prior to any insulating or drywalling

N.B. **Final/Certificate of Occupancy:** Prior to any occupancy of the structure or use. NOTE: There is a ~~\$75.00~~ fee per inspection at this point.

Certificate of Occupancy is not required for certain projects. Your inspector can advise you if your project requires a Certificate of Occupancy. All projects DO require a final inspection

N.B. **If any of the inspections do not occur, the project cannot go on to the next phase, REGARDLESS OF THE NOTICE OR CIRCUMSTANCES.**

NA **CERTIFICATE OF OCCUPANCIES MUST BE ISSUED AND PAID FOR, BEFORE THE SPACE MAY BE OCCUPIED**

W. D. Doye
Signature of applicant/designee

3/13/02
Date

James Bouke
Signature of Inspections Official

3/13/02
Date

CBL: 350-A018 Building Permit #: 02-0165