

**City of Portland, Maine - Building or Use Permit Application**

389 Congress Street, 04101 Tel: (207) 874-8703, Fax: (207) 874-8716

Permit No: 09-0484	Issue Date:	CBL: 350 A008001
-----------------------	-------------	---------------------

Location of Construction: 124 GREENWOOD LN	Owner Name: REAGAN MICHAEL E VN VET &	Owner Address: 124 GREENWOOD LN	Phone:
Business Name:	Contractor Name: Irving Oil Corp	Contractor Address: P.O. Box 2650 Scarborough	Phone 2077728304
Lessee/Buyer's Name	Phone:	Permit Type: Tanks - Dwellings	Zone: R3

Past Use: Single Family Home	Proposed Use: Single Family Home - install a 120 gallon tank	Permit Fee: \$30.00	Cost of Work: \$30.00	CEO District: 5
		FIRE DEPT: <input type="checkbox"/> Approved <input type="checkbox"/> Denied	INSPECTION: Use Group: R3 Type: HVAC	

Proposed Project Description: install a 120 gallon tank	Signature:	Signature: IRC 2003 ST MEGAN REGS
PEDESTRIAN ACTIVITIES DISTRICT (P.A.D.)		
Action: <input type="checkbox"/> Approved <input type="checkbox"/> Approved w/Conditions <input type="checkbox"/> Denied		
Signature:		Date:

Permit Taken By: Ldobson	Date Applied For: 05/21/2009	<b>Zoning Approval</b>
-----------------------------	---------------------------------	------------------------

<p>1. This permit application does not preclude the Applicant(s) from meeting applicable State and Federal Rules.</p> <p>2. Building permits do not include plumbing, septic or electrical work.</p> <p>3. Building permits are void if work is not started within six (6) months of the date of issuance. False information may invalidate a building permit and stop all work..</p>	<p><b>Special Zone or Reviews</b></p> <input type="checkbox"/> Shoreland <input type="checkbox"/> Wetland <input type="checkbox"/> Flood Zone <input type="checkbox"/> Subdivision <input type="checkbox"/> Site Plan Maj <input type="checkbox"/> Minor <input type="checkbox"/> MM <input type="checkbox"/> Date: <i>jm</i>	<p><b>Zoning Appeal</b></p> <input type="checkbox"/> Variance <input type="checkbox"/> Miscellaneous <input type="checkbox"/> Conditional Use <input type="checkbox"/> Interpretation <input type="checkbox"/> Approved <input type="checkbox"/> Denied Date:	<p><b>Historic Preservation</b></p> <input checked="" type="checkbox"/> Not in District or Landmark <input checked="" type="checkbox"/> Does Not Require Review <input type="checkbox"/> Requires Review <input type="checkbox"/> Approved <input type="checkbox"/> Approved w/Conditions <input type="checkbox"/> Denied Date:
			

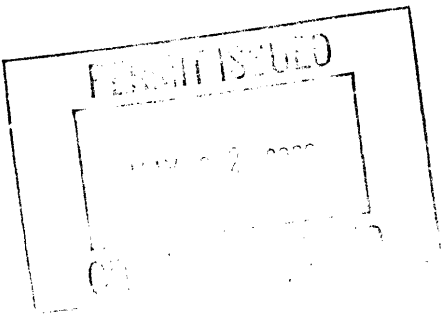

**CERTIFICATION**

I hereby certify that I am the owner of record of the named property, or that the proposed work is authorized by the owner of record and that I have been authorized by the owner to make this application as his authorized agent and I agree to conform to all applicable laws of this jurisdiction. In addition, if a permit for work described in the application is issued, I certify that the code official's authorized representative shall have the authority to enter all areas covered by such permit at any reasonable hour to enforce the provision of the code(s) applicable to such permit.

SIGNATURE OF APPLICANT	ADDRESS	DATE	PHONE
RESPONSIBLE PERSON IN CHARGE OF WORK, TITLE		DATE	PHONE

**City of Portland, Maine - Building or Use Permit**

389 Congress Street, 04101 Tel: (207) 874-8703, Fax: (207) 874-8716

<b>Permit No:</b> 09-0484	<b>Date Applied For:</b> 05/21/2009	<b>CBL:</b> 350 A008001
------------------------------	--	----------------------------

<b>Location of Construction:</b> 124 GREENWOOD LN	<b>Owner Name:</b> REAGAN MICHAEL E VN VET &	<b>Owner Address:</b> 124 GREENWOOD LN	<b>Phone:</b>
<b>Business Name:</b>	<b>Contractor Name:</b> Irving Oil Corp	<b>Contractor Address:</b> P.O. Box 2650 Scarborough	<b>Phone</b> (207) 772-8304
<b>Lessee/Buyer's Name</b>	<b>Phone:</b>	<b>Permit Type:</b> Tanks - Dwellings	

<b>Proposed Use:</b> Single Family Home - install a 120 gallon tank	<b>Proposed Project Description:</b> install a 120 gallon tank
--	---

<b>Dept:</b> Zoning	<b>Status:</b> Approved	<b>Reviewer:</b> Tom Markley	<b>Approval Date:</b> 05/21/2009
<b>Note:</b>			<b>Ok to Issue:</b> <input checked="" type="checkbox"/>
1) This property shall remain a single family dwelling. Any change of use shall require a separate permit application for review and approval.			
<b>Dept:</b> Building	<b>Status:</b> Approved with Conditions	<b>Reviewer:</b> Tom Markley	<b>Approval Date:</b> 05/21/2009
<b>Note:</b>			<b>Ok to Issue:</b> <input checked="" type="checkbox"/>
1) The installation must comply with the State of Maine Gas Regulations.			
2) Application approval based upon information provided by applicant. Any deviation from approved plans requires separate review and approval prior to work.			



FILL IN AND SIGN WITH INK

# APPLICATION FOR PERMIT HEATING OR POWER EQUIPMENT

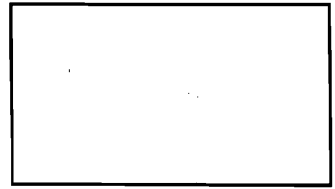

To the INSPECTOR OF BUILDINGS, PORTLAND, ME.

The undersigned hereby applies for a permit to install the following heating, cooking or power equipment in accordance with the Laws of Maine, the Building Code of the City of Portland, and the following specifications:

Location / CBL \_\_\_\_\_ Use of Building \_\_\_\_\_ Date 5-21-09  
 Name and address of owner of appliance Michael Reagan 124 Greenwood Ln  
Portland.  
 Installer's name and address Driving Energy / Mike Eaton  
385 US Route 1 S.P. 091 Telephone 207-210-0375

**Location of appliance:**  
 Basement                       Floor  
 Attic                                 Roof

**Type of Fuel:**  
 Gas                       Oil                       Solid

**Appliance Name:** \_\_\_\_\_  
 U.L. Approved  Yes  No

Will appliance be installed in accordance with the manufacture's installation instructions?  Yes                       No

IF NO Explain: \_\_\_\_\_  
 \_\_\_\_\_

**The Type of License of Installer:**  
 Master Plumber # \_\_\_\_\_  
 Solid Fuel # \_\_\_\_\_  
 Oil # \_\_\_\_\_  
 Gas # PNT 212  
 Other \_\_\_\_\_

**Type of Chimney:**  
 Masonry Lined  
 Factory built \_\_\_\_\_  
 Metal  
 Factory Built U.L. Listing # \_\_\_\_\_  
 Direct Vent  
 Type \_\_\_\_\_ UL# \_\_\_\_\_

**Type of Fuel Tank**  
 Oil  
 Gas

Size of Tank 120

Number of Tanks 1 set concrete Base.

Distance from Tank to Center of Flame 90' feet.

Cost of Work: \$ \_\_\_\_\_  
 Permit Fee: \$ \_\_\_\_\_

**Approved**

**Approved with Conditions**

Fire: \_\_\_\_\_  
 Ele.: \_\_\_\_\_  
 Bldg.: \_\_\_\_\_

See attached letter or requirement

Inspector's Signature

Date Approved

Signature of Installer \_\_\_\_\_

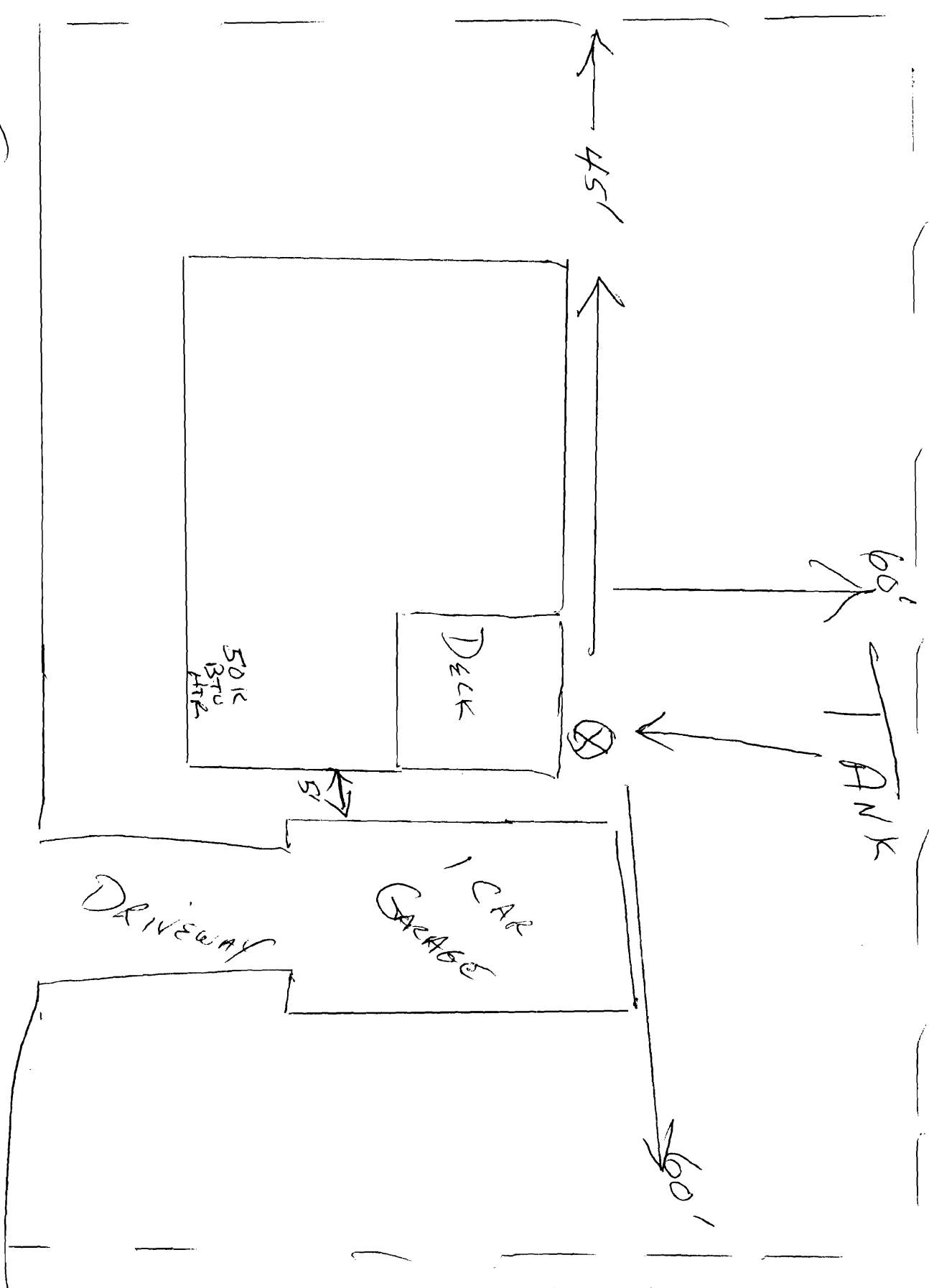

GREENWOOD LANE

M. PETER 124 GREENWOOD LN PORTLAND