

# FOR MORTGAGE LENDER USE ONLY

REV. 08/01/2013

**GENERAL NOTES:** (1) DISTANCES SHOWN ARE TAKEN FROM PROVIDED TITLE REFERENCES SHOWN BELOW. (2) THE PURPOSE OF THIS INSPECTION IS TO RENDER AN OPINION AS FOLLOWS: A) DWELLING AND ACCESSORY STRUCTURE'S COMPLIANCE WITH RESPECT TO MUNICIPAL ZONING SETBACKS, AND B) FLOOD ZONE DETERMINATION BY HORIZONTAL SCALING ON BELOW REFERENCED FEMA MAP. (3) THIS INSPECTION EXCEPTS OUT ALL TECHNICAL STANDARDS CURRENTLY SET FORTH BY STATE OF MAINE BOARD OF LICENSURE FOR PROFESSIONAL LAND SURVEYORS. (4) THIS INSPECTION IS TO BE USED ONLY BY THE BELOW LISTED LENDER AND IS NOT TO BE USED BY ANOTHER PARTY FOR BOUNDARY LINE LOCATIONS OR LAND TITLE OPINIONS. (5) TITLE OR OWNERSHIP NOT DETERMINED. (6) A BOUNDARY SURVEY SHOULD BE PERFORMED TO RENDER A PROFESSIONAL OPINION PERTAINING TO BOUNDARY LINE LOCATIONS, EASEMENTS, RIGHTS OF WAY, ENCUMBRANCES, ENCROACHMENTS, AND/OR CONFLICTS WITH ABUTTER'S DEEDS. (7) LOCATION/EXISTENCE OF WETLANDS NOT DETERMINED UNLESS SHOWN ON A RECORDED SUBDIVISION PLAN. (8) THIS OFFICE DOES NOT GRANT AUTHORIZATION TO ANY THIRD PARTY FOR USE OF THIS INSPECTION IN ANY BOUNDARY LINE EVALUATION FOR PERMITTING/PLANNING/APPROVALS. (9) THIS OFFICE ACCEPTS NO LIABILITY AND/OR RESPONSIBILITY FOR THE IMPROPER USE OF THIS MORTGAGE LOAN INSPECTION.

**THIS SKETCH IS NOT TO BE USED FOR CONSTRUCTION PURPOSES. IMPROVEMENTS SHOWN ARE APPROXIMATE.**

ADDRESS: 88 Greenwood Lane INSP. DATE: 9/25/2014  
Portland, Maine SCALE: 1" = 40'

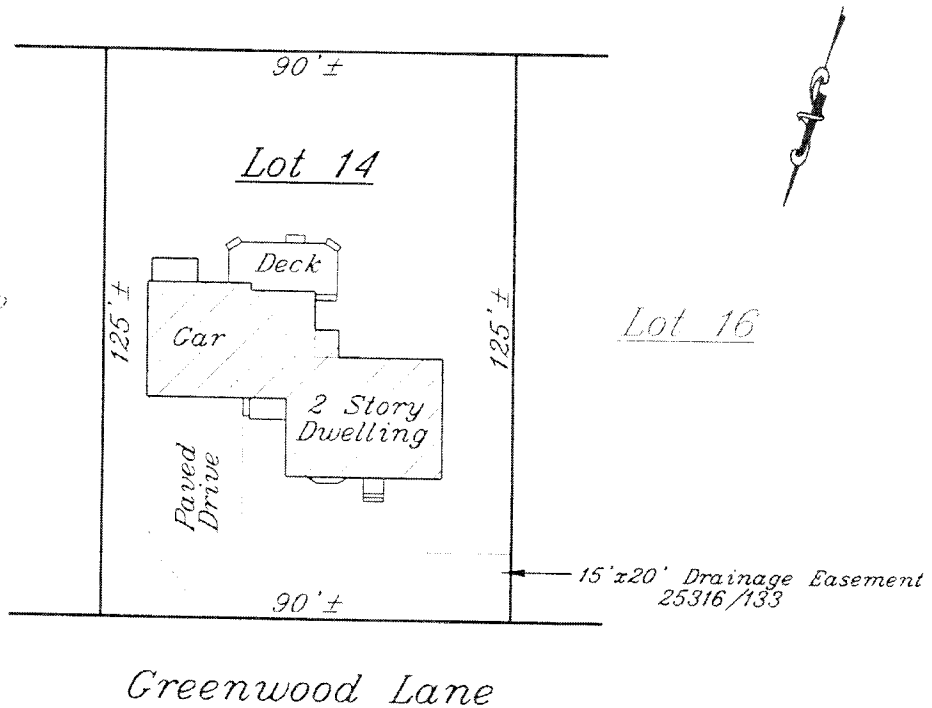

JPR

SEE PROVIDED TITLE REFERENCES FOR APPURTENANCES, IF ANY.

APPLICANT: Jerome & Janet LaMoria FILE#: 21427557  
 OWNER: John & Patricia Chesebro CLIENT#: 5550-14  
 LENDER: \_\_\_\_\_  
 REQ. PARTY: Baxter Title Company

TITLE REFERENCES: COUNTY: Cumberland  
 DEED BOOK: 3246 PAGE: 162  
 PLAN BOOK: 75 PAGE: 12 LOT: 14

MUNICIPAL REFERENCE:  
 MAP: 350 BLOCK: A LOT: 3

THE DWELLING DOES NOT FALL WITHIN A SPECIAL FLOOD HAZARD AREA PER FEMA COMMUNITY MAP No. 230051 PANEL 2222C ZONE X DATE 12/8/1998

THE DWELLING WAS  IN COMPLIANCE WITH MUNICIPAL ZONING SETBACK REQUIREMENTS AT THE TIME OF CONSTRUCTION

**Nadeau Land Surveys**  
 Professional Land Surveyors  
 Certified Floodplain Managers

918 BRIGHTON AVE. PH.(207)878-7870  
 PORTLAND, ME. 04102 F.(207)878-7871  
 THIS INSPECTION IS VALID ONLY WITH A SURVEYOR'S SEAL AND IS NULL & VOID 90 DAYS AFTER INSPECTION DATE

**THIS IS NOT A BOUNDARY SURVEY - NOT FOR RECORDING**