

**NOTES:**

1. ALL WORK SHALL CONFORM TO THE 2009 INTERNATIONAL RESIDENTIAL CODE, MAINE STATE PLUMBING CODE, NATIONAL ELECTRICAL CODE, AND ALL LOCAL AND STATE STANDARDS.
2. INSTALL PASSIVE RADON PIPING SYSTEM, INCLUDING 4-INCH THICK GAS PERMEABLE MATERIAL UNDER CONCRETE SLAB, PERFORATED PIPE WITH RISER THROUGH SLAB, AND 6 MIL POLYETHYLENE SHEETING WITH 12-INCH OVERLAP AT SEAMS. ADHERE TO EPA RECOMMENDATIONS.
3. CONCRETE FOUNDATION SHALL HAVE 18-INCH FOOTINGS, 4-INCH THICK SLAB, AND 8-INCH THICK WALLS.
4. SLOPE GRADE AWAY FROM FOUNDATION WALLS.
5. SEAL ALL JOINTS WATERTIGHT.
6. BASEMENT WALLS, FLOOR, AND CEILING SHALL BE UNFINISHED. CABLES AND PIPES SHALL BE EXPOSED AND ROUTED NEATLY.
7. STAIRS SHALL BE 7-3/4-INCH RISE, 10-INCH RUN, AND HAVE 6'-8" HEAD CLEARANCE.
8. FOUNDATION WALLS SHALL HAVE EXTERIOR 2-INCH THICK FOAM INSULATION.

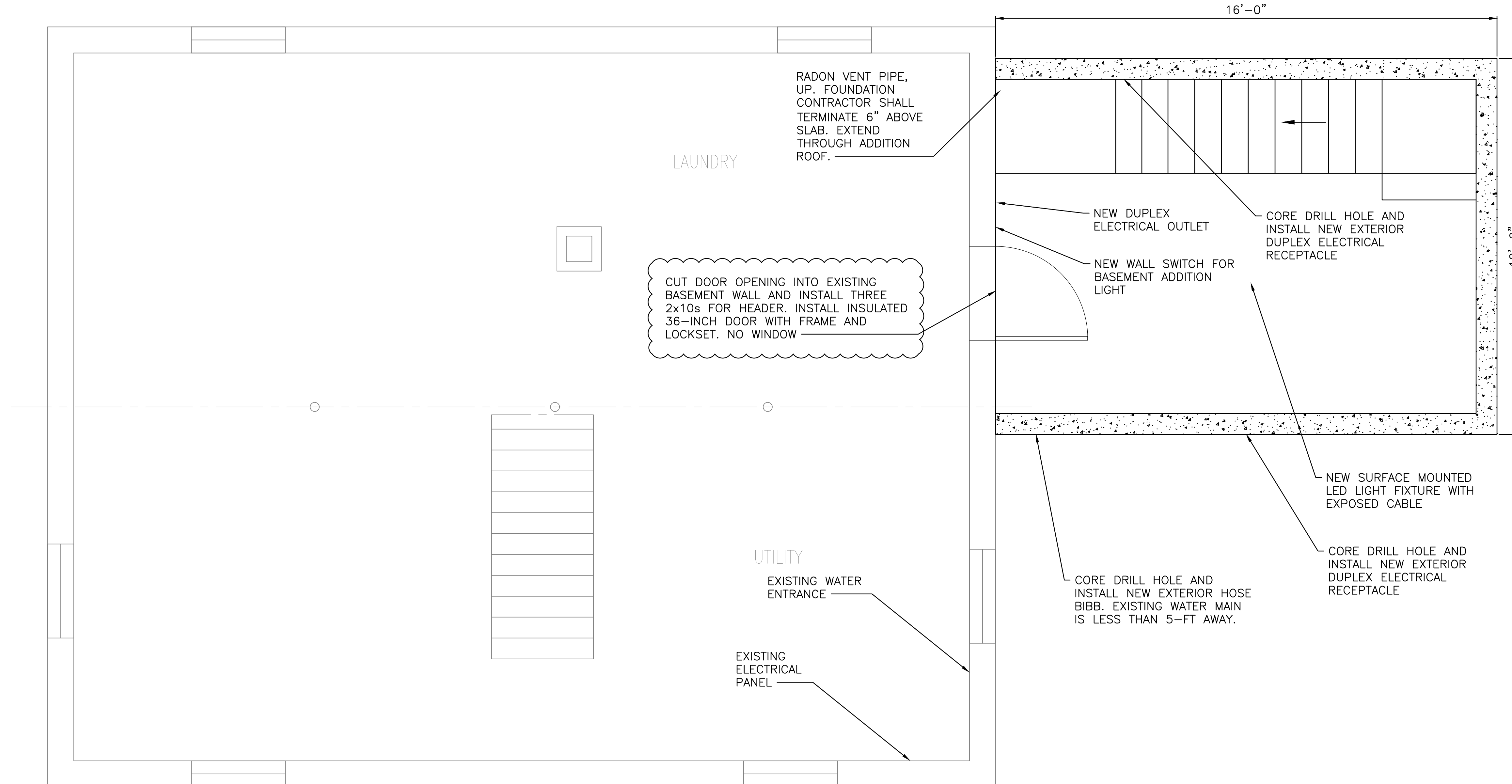

**BASEMENT FLOOR PLAN**

SCALE: 1/2" = 1'-0"

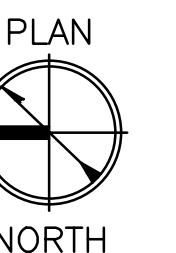

Scale: 1/2" = 1'-0"

		21 FISHER STREET PORTLAND, MAINE	
		16'x12' ADDITION	
1	PERMITTING COMMENTS	10/29/17	BASEMENT FLOOR PLAN
0	ISSUED FOR CONSTRUCTION	08/14/17	
REV	DESCRIPTION	DATE	
		SIZE: ANSI D	DRAWING NO. <b>G-101</b>
		DATE: 06/15/17	
		DES BY:	
		DWN BY:	
		CKD BY:	SHEET 2 OF 4