

NOTES:

1. ALL NEW WORK SHALL CONFORM TO THE 2009 INTERNATIONAL RESIDENTIAL CODE, MAINE STATE PLUMBING CODE, NATIONAL ELECTRICAL CODE, AND CITY AND STATE REQUIREMENTS.
2. PROPERTY IS LOCATED ON 21 FISHER STREET IN THE CITY OF PORTLAND, ME, CUMBERLAND COUNTY, REGISTRY OF DEEDS BOOK 29585 AND PAGE 195, AND OWNED BY EMILY PINYARD.
3. PROPERTY BOUNDARY LINES SHOWN ARE BASED ON CITY OF PORTLAND GIS VIEWER MAPS.
4. THE PROPOSED STRUCTURE IS A 16-FT X 12-FT INSULATED, UNHEATED ADDITION WITH A FULL BASEMENT AND PITCHED ROOF. ADDITION WILL PROVIDE ACCESS TO THE BASEMENT AND FIRST FLOOR LEVELS AND PROVIDE STORAGE FOR SHOES, COATS, RECYCLABLES, AND GENERAL, NON-HAZARDOUS ITEMS.
5. AN EXISTING DECK ATTACHED TO THE HOUSE WILL BE REMOVED BY THE CONTRACTOR PRIOR TO CONSTRUCTION OF THE NEW ADDITION.

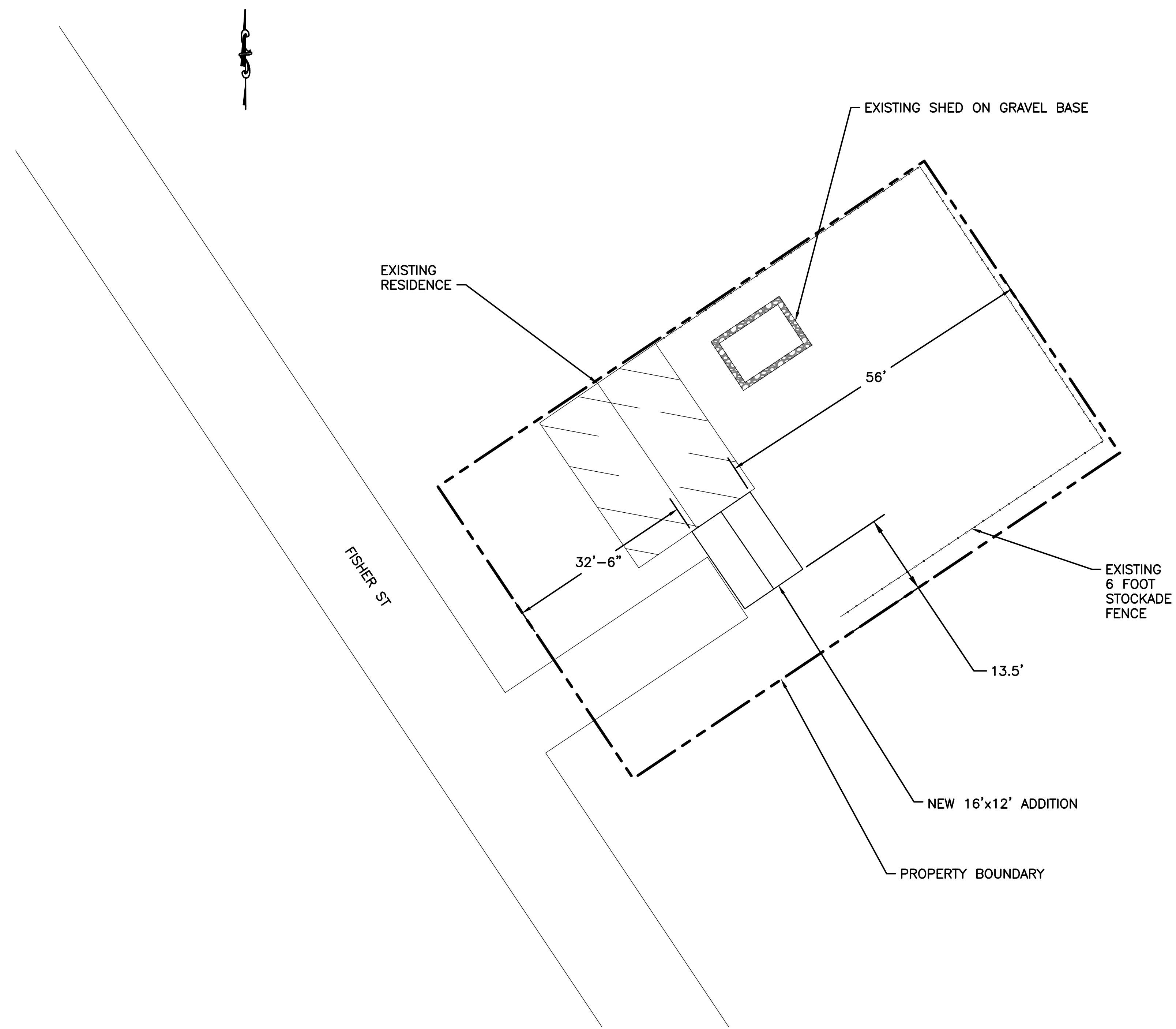

FISHER ST

EXISTING RESIDENCE

EXISTING SHED ON GRAVEL BASE

56'

32'-6"

EXISTING 6 FOOT STOCKADE FENCE

13.5'

NEW 16'x12' ADDITION

PROPERTY BOUNDARY

SITE PLAN

SCALE: 1/2" = 1'-0"

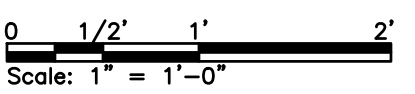

		21 FISHER STREET PORTLAND, MAINE	
		16'x12' ADDITION	
0	ISSUED FOR CONSTRUCTION	08/14/17	21 FISHER STREET SITE PLAN
REV	DESCRIPTION	DATE	
		SIZE: ANSI D	DRAWING NO. G-100
		DATE: 06/15/17	
		DES BY:	
		DWN BY:	
		CKD BY:	
			SHEET 1 OF 4