

City of Portland, Maine - Building or Use Permit Application

389 Congress Street, 04101 Tel: (207) 874-8703, Fax: (207) 874-8716

Permit No: 08-0015	Issue Date: 1/04/08	CBL: 347 C042001
-----------------------	------------------------	---------------------

Location of Construction: 1528 WASHINGTON AVE	Owner Name: DELPONTE LINDA G & DARRY	Owner Address: 1528 WASHINGTON AVE	Phone: 799-5585
Business Name:	Contractor Name: Down East Energy	Contractor Address: 172 Main Street South Portland	Phone: 2077995585
Lessee/Buyer's Name	Phone:	Permit Type: HVAC	Zone:

Past Use: Single Family Home	Proposed Use: Single Family Home with 120 gal gas tank	Permit Fee: \$30.00	Cost of Work: \$0.00	CEO District: 5
		FIRE DEPT: <input type="checkbox"/> Approved <input type="checkbox"/> Denied	INSPECTION: Use Group: R-3 Type: SB IMC 2003	

Proposed Project Description: Install 120 gallon Gas tank	Signature:	Signature: CLN 1/4/08
PEDESTRIAN ACTIVITIES DISTRICT (P.A.D.)		
Action: <input type="checkbox"/> Approved <input type="checkbox"/> Approved w/Conditions <input type="checkbox"/> Denied		
Signature: _____ Date: _____		

Permit Taken By: lmd	Date Applied For: 01/04/2008	Zoning Approval
-------------------------	---------------------------------	------------------------

1. This permit application does not preclude the Applicant(s) from meeting applicable State and Federal Rules.
2. Building permits do not include plumbing, septic or electrical work.
3. Building permits are void if work is not started within six (6) months of the date of issuance. False information may invalidate a building permit and stop all work..

Special Zone or Reviews	Zoning Appeal	Historic Preservation
<input type="checkbox"/> Shoreland	<input type="checkbox"/> Variance	<input type="checkbox"/> Not in District or Landmark
<input type="checkbox"/> Wetland	<input type="checkbox"/> Miscellaneous	<input type="checkbox"/> Does Not Require Review
<input type="checkbox"/> Flood Zone	<input type="checkbox"/> Conditional Use	<input type="checkbox"/> Requires Review
<input type="checkbox"/> Subdivision	<input type="checkbox"/> Interpretation	<input type="checkbox"/> Approved
<input type="checkbox"/> Site Plan	<input type="checkbox"/> Approved	<input type="checkbox"/> Approved w/Conditions
Maj <input type="checkbox"/> Minor <input type="checkbox"/> MM <input type="checkbox"/>	<input type="checkbox"/> Denied	<input type="checkbox"/> Denied
Date:	Date:	Date:

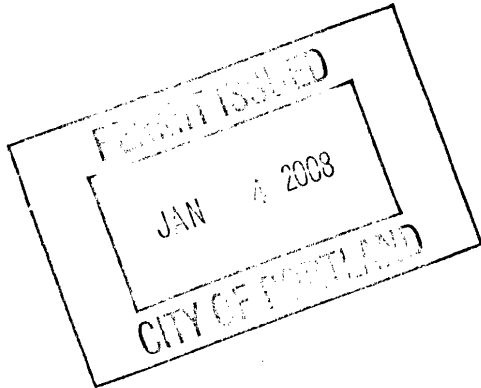

CERTIFICATION

I hereby certify that I am the owner of record of the named property, or that the proposed work is authorized by the owner of record and that I have been authorized by the owner to make this application as his authorized agent and I agree to conform to all applicable laws of this jurisdiction. In addition, if a permit for work described in the application is issued, I certify that the code official's authorized representative shall have the authority to enter all areas covered by such permit at any reasonable hour to enforce the provision of the code(s) applicable to such permit.

SIGNATURE OF APPLICANT	ADDRESS	DATE	PHONE
RESPONSIBLE PERSON IN CHARGE OF WORK, TITLE		DATE	PHONE

City of Portland, Maine - Building or Use Permit Application

389 Congress Street, 04101 Tel: (207) 874-8703, Fax: (207) 874-8716

Permit No: 08-0015	Issue Date: 1/04/08	CBL: 347 C042001
-----------------------	------------------------	---------------------

Location of Construction: 1528 WASHINGTON AVE	Owner Name: DELPONTE LINDA G & DARRY	Owner Address: 1528 WASHINGTON AVE	Phone: 799-5585
Business Name:	Contractor Name: Down East Energy	Contractor Address: 172 Main Street South Portland	Phone: 2077995585
Lessee/Buyer's Name	Phone:	Permit Type: HVAC	Zone:

Past Use: Single Family Home	Proposed Use: Single Family Home with 120 gal gas tank	Permit Fee: \$30.00	Cost of Work: \$0.00	CEO District: 5
		FIRE DEPT: <input type="checkbox"/> Approved <input type="checkbox"/> Denied	INSPECTION: Use Group: R-3 Type: SB IMC 2003	

Proposed Project Description: Install 120 gallon Gas tank	Signature:	Signature: <i>CLD 1/4/08</i>
PEDESTRIAN ACTIVITIES DISTRICT (P.A.D.)		
Action: <input type="checkbox"/> Approved <input type="checkbox"/> Approved w/Conditions <input type="checkbox"/> Denied		
Signature:		Date:

Permit Taken By: lmd	Date Applied For: 01/04/2008	Zoning Approval
-------------------------	---------------------------------	------------------------

<ol style="list-style-type: none"> This permit application does not preclude the Applicant(s) from meeting applicable State and Federal Rules. Building permits do not include plumbing, septic or electrical work. Building permits are void if work is not started within six (6) months of the date of issuance. False information may invalidate a building permit and stop all work.. 	Special Zone or Reviews <input type="checkbox"/> Shoreland <input type="checkbox"/> Wetland <input type="checkbox"/> Flood Zone <input type="checkbox"/> Subdivision <input type="checkbox"/> Site Plan Maj <input type="checkbox"/> Minor <input type="checkbox"/> MM <input type="checkbox"/> Date:	Zoning Appeal <input type="checkbox"/> Variance <input type="checkbox"/> Miscellaneous <input type="checkbox"/> Conditional Use <input type="checkbox"/> Interpretation <input type="checkbox"/> Approved <input type="checkbox"/> Denied Date:	Historic Preservation <input type="checkbox"/> Not in District or Landmark <input type="checkbox"/> Does Not Require Review <input type="checkbox"/> Requires Review <input type="checkbox"/> Approved <input type="checkbox"/> Approved w/Conditions <input type="checkbox"/> Denied Date:
---	---	---	---

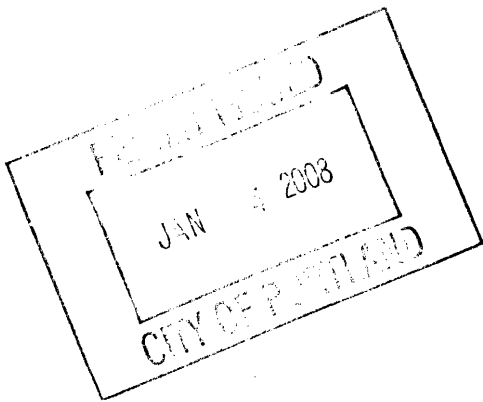

CERTIFICATION

I hereby certify that I am the owner of record of the named property, or that the proposed work is authorized by the owner of record and that I have been authorized by the owner to make this application as his authorized agent and I agree to conform to all applicable laws of this jurisdiction. In addition, if a permit for work described in the application is issued, I certify that the code official's authorized representative shall have the authority to enter all areas covered by such permit at any reasonable hour to enforce the provision of the code(s) applicable to such permit.

SIGNATURE OF APPLICANT ADDRESS DATE PHONE

RESPONSIBLE PERSON IN CHARGE OF WORK, TITLE DATE PHONE



FILL IN AND SIGN WITH INK

APPLICATION FOR PERMIT HEATING OR POWER EQUIPMENT

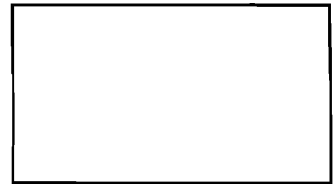

To the INSPECTOR OF BUILDINGS, PORTLAND, ME.

The undersigned hereby applies for a permit to install the following heating, cooking or power equipment in accordance with the Laws of Maine, the Building Code of the City of Portland, and the following specifications:

Location / CBL _____ Use of Building Private Date 1/4/08
 Name and address of owner of appliance Barry DeRose 1528 Washington Ave Portland
 Installer's name and address Young East Energy 172 Main St South Portland Telephone 799-5585

Location of appliance:

- Basement
- Floor
- Attic
- Roof

Type of Fuel:

- Gas
- Oil
- Solid

Appliance Name: _____

U.L. Approved Yes No

Will appliance be installed in accordance with the manufacture's installation instructions? Yes No

IF NO Explain: _____

The Type of License of Installer:

- Master Plumber # _____
- Solid Fuel # _____
- Oil # _____
- Gas # PVT 1445
- Other _____

Type of Chimney:

Masonry Lined
Factory built _____

Metal
Factory Built U.L. Listing # _____

²⁰⁰⁸
 Direct Vent
 Type _____ UL# _____

Type of Fuel Tank

- Oil
- Gas

Size of Tank 20

Number of Tanks 1

Distance from Tank to Center of Flame _____ feet.

Cost of Work: \$ _____

Permit Fee: \$ _____

Approved

Fire: _____
 Ele.: _____
 Bldg.: _____

Approved with Conditions

See attached letter or requirement

[Signature]
 Inspector's Signature

1/4/08
 Date Approved

Signature of Installer [Signature]

DAY OF INSTALL
DATE
TIME

1/27/08
AM

APPOINTMENT			
DATE	11/27/08	TIME	10:00
SALES REP	Bja		

PROPANE INSTALLATION FORM

NAME:	DARRYL DELPONTE	ACCOUNT#	
ADDRESS:	1528 Washington Ave	PHONE#	
DIRECTIONS:	Pontcharme		
	236-6844	OIL CUSTOMER?	
QUOTE: (Y/N)		LABOR:	
		PART:	

JOB DESCRIPTION

WORKORDER#(S) Harigault TICKETS _____

TANK SIZE	120	TRENCH REQ		TRENCH DUG BY						
HOT WORK	INST	UNIT:	Generator	SHOP	REQUIRE CONVERSION					
	HOOK			CUST						
WALK SAFE	INSTALL LOCATION	KITCH	LVRM	BDRM	BATH GAR BASE OTHER					
** UNSAFE COND.	ASBESTOS	CONFINED	WATER	ANIMALS	ELECTRIC WIRES OTHER *					
ELECTRIC GRD.	DESCRIPTION:									
CRAWL SPACE *	Generator TRW									
LADDER WRK *										
REMOVAL REQUIRED	TOTAL BTU LOAD	FURTHEST APPLIANCE								
PIPE SIZE	3/8	1/2	5/8	1/2BI	3/4BI	1BI	TRAC	PLASTIC		
VENTING REQUIRED	PARTS/EQUIPMENT:					NOTES: ** (SIDING/TILE/ETC)				
	JAN 4 2008					DISCUSSED W/ CUST:				
						SPECIAL TOOLS:				
						#TECHS				

DeLPonte Residence
1528 WASHINGTON AVE
PORTLAND, ME

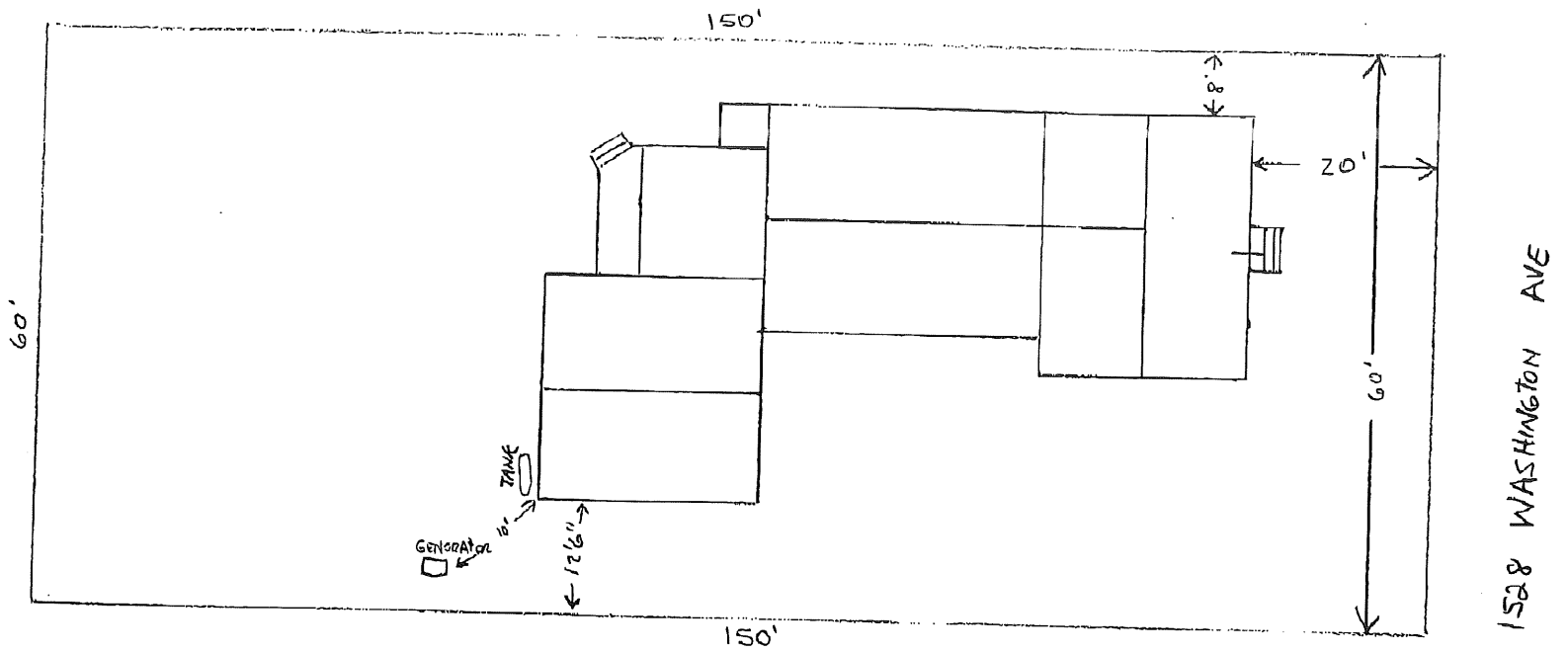

$\frac{1}{2}'' = 10'$
SCALE

1/2 cys
single stage

131

fence



garage



City of Portland, Maine - Building or Use Permit

389 Congress Street, 04101 Tel: (207) 874-8703, Fax: (207) 874-8716

Permit No: 08-0015	Date Applied For: 01/04/2008	CBL: 347 C042001
------------------------------	--	----------------------------

Location of Construction: 1528 WASHINGTON AVE	Owner Name: DELPONTE LINDA G & DARRY	Owner Address: 1528 WASHINGTON AVE	Phone: () 799-5585
Business Name:	Contractor Name: Down East Energy	Contractor Address: 172 Main Street South Portland	Phone: (207) 799-5585
Lessee/Buyer's Name	Phone:	Permit Type: HVAC	

Proposed Use: Single Family Home with 120 gal gas tank	Proposed Project Description: Install 120 gallon Gas tank
--	---

Dept: Zoning	Status: Approved	Reviewer: Chris Hanson	Approval Date: 01/04/2008
Note:			Ok to Issue: <input checked="" type="checkbox"/>
Dept: Building	Status: Approved with Conditions	Reviewer: Chris Hanson	Approval Date: 01/04/2008
Note:			Ok to Issue: <input checked="" type="checkbox"/>
1) Tanks shall be installed per NFPA 58			
2) The installation must comply with the State of Maine Gas Regulations.			

City of Portland, Maine - Building or Use Permit Application

389 Congress Street, 04101 Tel: (207) 874-8703, Fax: (207) 874-8716

Permit No: 08-0015	Issue Date: <i>1/04/08</i>	CBL: 347 C042001
-----------------------	-------------------------------	---------------------

Location of Construction: 1528 WASHINGTON AVE	Owner Name: DELPONTE LINDA G & DARRY	Owner Address: 1528 WASHINGTON AVE	Phone: 799-5585
Business Name:	Contractor Name: Down East Energy	Contractor Address: 172 Main Street South Portland	Phone: 2077995585
Lessee/Buyer's Name	Phone:	Permit Type: HVAC	Zone:

Past Use: Single Family Home	Proposed Use: Single Family Home with 120 gal gas tank	Permit Fee: \$30.00	Cost of Work: \$0.00	CEO District: 5
Proposed Project Description: Install 120 gallon Gas tank		FIRE DEPT: <input type="checkbox"/> Approved <input type="checkbox"/> Denied	INSPECTION: Use Group: <i>R-3</i> Type: <i>SB</i> <i>IMC 2003</i>	
		Signature: <i>CLW 1/4/08</i>		
PEDESTRIAN ACTIVITIES DISTRICT (P.A.D.)				
Action: <input type="checkbox"/> Approved <input type="checkbox"/> Approved w/Conditions <input type="checkbox"/> Denied				
Signature: _____ Date: _____				

Permit Taken By: lmd	Date Applied For: 01/04/2008	Zoning Approval		
-------------------------	---------------------------------	------------------------	--	--

- This permit application does not preclude the Applicant(s) from meeting applicable State and Federal Rules.
- Building permits do not include plumbing, septic or electrical work.
- Building permits are void if work is not started within six (6) months of the date of issuance. False information may invalidate a building permit and stop all work..

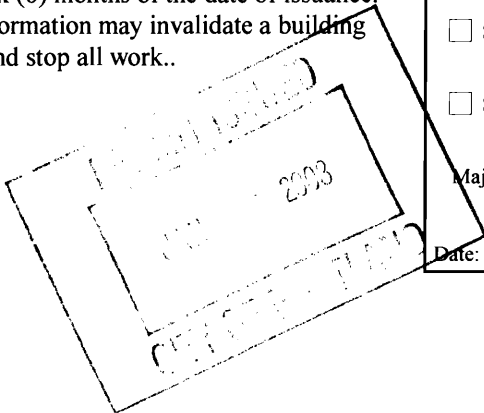

Special Zone or Reviews	Zoning Appeal	Historic Preservation
<input type="checkbox"/> Shoreland	<input type="checkbox"/> Variance	<input type="checkbox"/> Not in District or Landmark
<input type="checkbox"/> Wetland	<input type="checkbox"/> Miscellaneous	<input type="checkbox"/> Does Not Require Review
<input type="checkbox"/> Flood Zone	<input type="checkbox"/> Conditional Use	<input type="checkbox"/> Requires Review
<input type="checkbox"/> Subdivision	<input type="checkbox"/> Interpretation	<input type="checkbox"/> Approved
<input type="checkbox"/> Site Plan	<input type="checkbox"/> Approved	<input type="checkbox"/> Approved w/Conditions
Maj <input type="checkbox"/> Minor <input type="checkbox"/> MM <input type="checkbox"/>	<input type="checkbox"/> Denied	<input type="checkbox"/> Denied
Date: _____	Date: _____	Date: _____

CERTIFICATION

I hereby certify that I am the owner of record of the named property, or that the proposed work is authorized by the owner of record and that I have been authorized by the owner to make this application as his authorized agent and I agree to conform to all applicable laws of this jurisdiction. In addition, if a permit for work described in the application is issued, I certify that the code official's authorized representative shall have the authority to enter all areas covered by such permit at any reasonable hour to enforce the provision of the code(s) applicable to such permit.

SIGNATURE OF APPLICANT	ADDRESS	DATE	PHONE
RESPONSIBLE PERSON IN CHARGE OF WORK, TITLE		DATE	PHONE