

Karr Bailey Foundations

Scale $\frac{3}{4}'' = 1'$

Subolt 4' O.C.

Addition

Garage

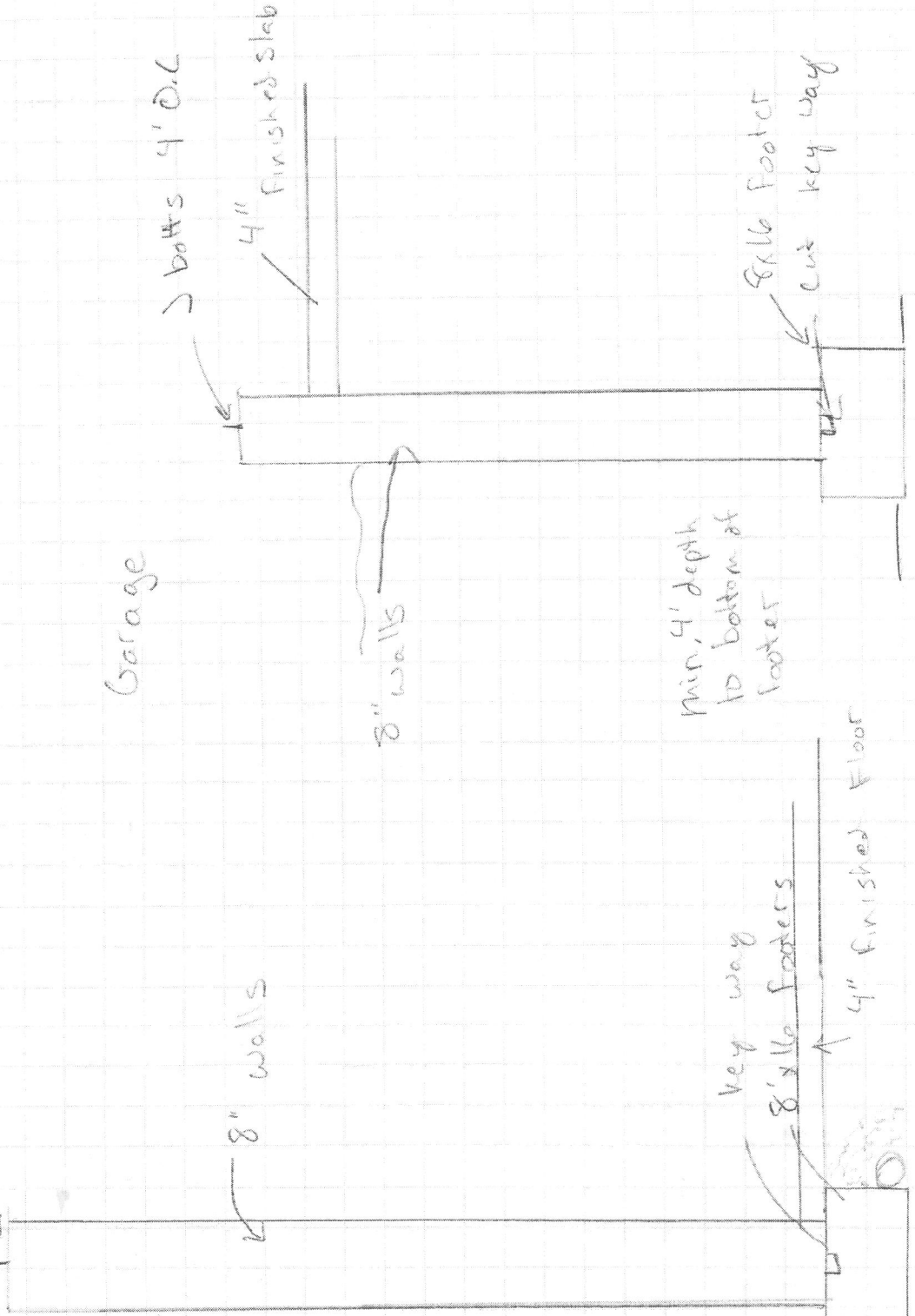

4" drain line tied into existing drainage

$\frac{3}{4}$ Stone

Min. 4' depth to bottom of footer

4" finished floor

8x16 Footer cut key way

8" walls

8" walls

4" finished slab

3 bolts 4' O.C.