

**PERMIT ISSUED**

**City of Portland, Maine - Building or Use Permit Application**  
389 Congress Street, 04101 Tel: (207) 874-8703, Fax: (207) 874-8716

<b>Permit No:</b> 03-0466	<b>Issue Date:</b> MAY 07 2003	<b>CBL:</b> 347 C028001
------------------------------	-----------------------------------	----------------------------

<b>Location of Construction:</b> 32 Skylark Rd	<b>Owner Name:</b> Decotiis Michael A &	<b>Owner Address:</b> 32 Skylark Rd CITY OF PORTLAND	<b>Phone:</b> 207-797-4931
<b>Business Name:</b>	<b>Contractor Name:</b> Nick Pools	<b>Contractor Address:</b> Westbrook	<b>Phone:</b> 2076372915
<b>Lessee/Buyer's Name:</b>	<b>Phone:</b>	<b>Permit Type:</b> Swimming Pools	<b>Zone:</b>

<b>Past Use:</b> single family	<b>Proposed Use:</b> single family w/21' round above ground pool	<b>Permit Fee:</b> \$44.00	<b>Cost of Work:</b> \$3,000.00	<b>CEO District:</b> 2
<b>Proposed Project Description:</b> Install 21' above ground pool		<b>FIRE DEPT:</b> <input type="checkbox"/> Approved <input checked="" type="checkbox"/> Denied <i>N/A</i>	<b>INSPECTION:</b> Use Group: U Type: Pool <i>BOCA 99</i>	
		<b>Signature:</b>	<b>Signature:</b>	

**PEDESTRIAN ACTIVITIES DISTRICT (P.A.D.)**

Action:  Approved  Approved w/Conditions  Denied

Signature: \_\_\_\_\_ Date: \_\_\_\_\_

<b>Permit Taken By:</b> gg	<b>Date Applied For:</b> 05/07/2003	<b>Zoning Approval</b>	
-------------------------------	--	------------------------	--

<p>1. This permit application does not preclude the Applicant(s) from meeting applicable State and Federal Rules.</p> <p>2. Building permits do not include plumbing, septic or electrical work.</p> <p>3. Building permits are void if work is not started within six (6) months of the date of issuance. False information may invalidate a building permit and stop all work..</p>	<p align="center"><b>Special Zone or Reviews</b></p> <p><input type="checkbox"/> Shoreland</p> <p><input type="checkbox"/> Wetland</p> <p><input type="checkbox"/> Flood Zone</p> <p><input type="checkbox"/> Subdivision</p> <p><input type="checkbox"/> Site Plan</p> <p>Maj <input type="checkbox"/> Minor <input type="checkbox"/> MM <input type="checkbox"/></p> <p>Date: <i>5/7/03</i></p>	<p align="center"><b>Zoning Appeal</b></p> <p><input type="checkbox"/> Variance</p> <p><input type="checkbox"/> Miscellaneous</p> <p><input type="checkbox"/> Conditional Use</p> <p><input type="checkbox"/> Interpretation</p> <p><input type="checkbox"/> Approved</p> <p><input type="checkbox"/> Denied</p> <p>Date: _____</p>	<p align="center"><b>Historic Preservation</b></p> <p><input checked="" type="checkbox"/> Not in District or Landmark</p> <p><input type="checkbox"/> Does Not Require Review</p> <p><input type="checkbox"/> Requires Review</p> <p><input type="checkbox"/> Approved</p> <p><input type="checkbox"/> Approved w/Conditions</p> <p><input type="checkbox"/> Denied</p> <p>Date: <i>5/7/03</i></p>
---	---	---	--

**CERTIFICATION**

I hereby certify that I am the owner of record of the named property, or that the proposed work is authorized by the owner of record and that I have been authorized by the owner to make this application as his authorized agent and I agree to conform to all applicable laws of this jurisdiction. In addition, if a permit for work described in the application is issued, I certify that the code official's authorized representative shall have the authority to enter all areas covered by such permit at any reasonable hour to enforce the provision of the code(s) applicable to such permit.

SIGNATURE OF APPLICANT	ADDRESS	DATE	PHONE
RESPONSIBLE PERSON IN CHARGE OF WORK, TITLE		DATE	PHONE

# BUILDING PERMIT INSPECTION PROCEDURES

Please call 874-8703 or 874-8693 to schedule your inspections as agreed upon

Permits expire in 6 months, if the project is not started or ceases for 6 months.

The Owner or their designee is required to notify the inspections office for the following inspections and provide adequate notice. Notice must be called in 48-72 hours in advance in order to schedule an inspection:

By initializing at each inspection time, you are agreeing that you understand the inspection procedure and additional fees from a "Stop Work Order" and "Stop Work Order Release" will be incurred if the procedure is not followed as stated below.

**Pre-construction Meeting:** Must be scheduled with your inspection team upon receipt of this permit. Jay Reynolds, Development Review Coordinator at 874-8632 must also be contacted at this time, before any site work begins on any project other than single family additions or alterations.

**Footing/Building Location Inspection:** Prior to pouring concrete

**Re-Bar Schedule Inspection:** Prior to pouring concrete

**Foundation Inspection:** Prior to placing ANY backfill

**Framing/Rough Plumbing/Electrical:** Prior to any insulating or drywalling

**Final/Certificate of Occupancy:** Prior to any occupancy of the structure or use. NOTE: There is a \$75.00 fee per inspection at this point.

Certificate of Occupancy is not required for certain projects. Your inspector can advise you if your project requires a Certificate of Occupancy. All projects DO require a final inspection

**If any of the inspections do not occur, the project cannot go on to the next phase, REGARDLESS OF THE NOTICE OR CIRCUMSTANCES.**

**CERIFICATE OF OCCUPANICES MUST BE ISSUED AND PAID FOR, BEFORE THE SPACE MAY BE OCCUPIED**

*M. J. DeGato*  
Signature of applicant/designee

Date 5/7/05

*[Signature]*  
Signature of Inspections Official

Date

CBL: 347-C-28 Building Permit #: 03-0466

# DISPLAY THIS CARD ON PRINCIPAL FRONTAGE OF WORK CITY OF PORTLAND

Please Read  
Application And  
Notes, If Any,  
Attached

BUILDING DEPARTMENT

## PERMIT

Permit Number: 030466

This is to certify that Decotiis Michael A & /Nick is  
has permission to Install 21' above ground pool  
AT 32 Skylark Rd 347 C028001

provided that the person or persons, firm or organization accepting this permit shall comply with all of the provisions of the Statutes of the State and of the Ordinances of the City of Portland regulating the construction, maintenance and use of buildings and structures, and of the application on file in this department.

Apply to Public Works for street line and grade if nature of work requires such information.

Notification of inspection must be given and when permission is procured before this building or part thereof is started or closed-in. 24 HOUR NOTICE IS REQUIRED.

A certificate of occupancy must be procured by owner before this building or part thereof is occupied.

**OTHER REQUIRED APPROVALS**

Fire Dept. **PERMIT ISSUED**  
Health Dept.  
Appeal Board  
Other **MAY 07 2003**  
Department Name

*[Signature]*  
Director - Building & Inspection Services

**CITY OF PORTLAND**

**PENALTY FOR REMOVING THIS CARD**

# Pool Installation/Construction Permit Application

If you or the property owner owes real estate or personal property taxes or user charges on any property within the City, payment arrangements must be made before permits of any kind are accepted.

Location/Address of Construction: <u>32 Skylark Road</u>		
Total Square Footage of Proposed Structure <u>364.18 sq FT</u>	Square Footage of Lot <u>9360 sq FT</u>	
Tax Assessor's Chart, Block & Lot Chart# <u>347</u> Block# <u>C</u> Lot# <u>028-001</u>	Owner: <u>Dawn + Michael DeCotiis</u>	Telephone: <u>797-4931</u>
Lessee/Buyer's Name (If Applicable)	Applicant name, address & telephone: <u>Dawn DeCotiis</u> <u>32 Skylark Road</u> <u>Portland 797-4931</u>	Cost Of Work: \$ <u>3000</u> <del>2000</del> Fee: \$ <u>44.00</u> <del>5000</del>
Dimensions of pool: <u>21' x 52"</u> Above or below ground: <u>Above</u>		
Dimensions of decking and/or any platforms, sheds, or other structures: <u><del>no</del> no decking, one ladder only.</u>		
Contractor's name, address & telephone: <u>Nicks Pools</u> <u>637-2915</u> <u>Westbrook</u>		
Whom should we contact when the permit is ready: <u>Mike DeCotiis</u>		
Mailing address: <u>32 Skylark Road</u> <u>Portland 04103</u>		
We will contact you by phone when the permit is ready. You must come in and pick up the permit and review the requirements before starting any work, with a Plan Reviewer. <b>A stop work order will be issued and a \$100.00 fee if any work starts before the permit is picked up.</b> PHONE: <u>797-4931</u>		

IF THE REQUIRED INFORMATION IS NOT INCLUDED IN THE SUBMISSIONS THE PERMIT WILL BE AUTOMATICALLY DENIED AT THE DISCRETION OF THE BUILDING/PLANNING DEPARTMENT, WE MAY REQUIRE ADDITIONAL INFORMATION IN ORDER TO APPROVE THIS PERMIT.

I hereby certify that I am the Owner of record of the named property, or that the owner of record authorizes the proposed work and that I have been authorized by the owner to make this application as his/her authorized agent. I agree to conform to all applicable laws of this jurisdiction. In addition, if a permit for work described in this application is issued, I certify that the Code Official's authorized representative shall have the authority to enter all areas covered by this permit at any reasonable hour to enforce the provisions of the codes applicable to this permit.

Signature of applicant: <u>Michael DeCotiis</u>	Date: <u>5/6/03</u>
---	---------------------

This is NOT a permit; you may not commence ANY work until the permit is issued. If you are in a Historic District you may be subject to additional permitting and fees with the Planning Department on the 4<sup>th</sup> floor of City Hall

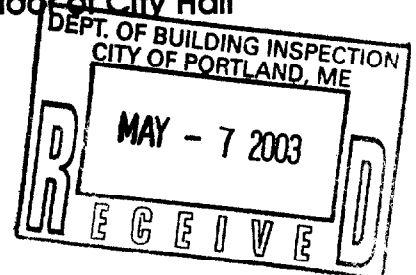

# FOR MORTGAGE LENDER USE ONLY

**GENERAL NOTES:** (1) DISTANCES SHOWN ARE TAKEN FROM PROVIDED TITLE REFERENCES SHOWN BELOW. (2) THIS INSPECTION EXAMINES DWELLING AND ACCESSORY STRUCTURE COMPLIANCE WITH RESPECT TO MUNICIPAL ZONING SETBACK REQUIREMENTS ONLY. (3) A STANDARD BOUNDARY SURVEY SHOULD BE PERFORMED TO RENDER A PROFESSIONAL OPINION AS TO ACTUAL PROPERTY LINE LOCATIONS. (4) THIS INSPECTION DEPICTS ALL VISIBLE STRUCTURAL ENCROACHMENTS WITH RESPECT TO APPARENT PROPERTY LINES AND RECOGNIZES ONLY THOSE EASEMENTS & RIGHTS OF WAYS STATED OR SHOWN IN BELOW PROVIDED TITLE REFERENCES AND DOES NOT REVEAL ANY CONFLICTS WITH ADJUTING DEEDS. (5) FLOOD HAZARD DETERMINATION IS MADE BY SCALING DISTANCES ON BELOW REFERENCED FEMA MAP. (6) THIS INSPECTION IS TO BE USED ONLY BY BELOW LISTED LENDER, TITLE COMPANY &/OR ATTORNEY AND ITS TITLE INSURER.

ADDRESS: 32 SKYLARK ROAD      INSPECTION DATE: MAY 10, 2000  
PORTLAND, MAINE      SCALE: 1"=30'

N/F  
Bailey

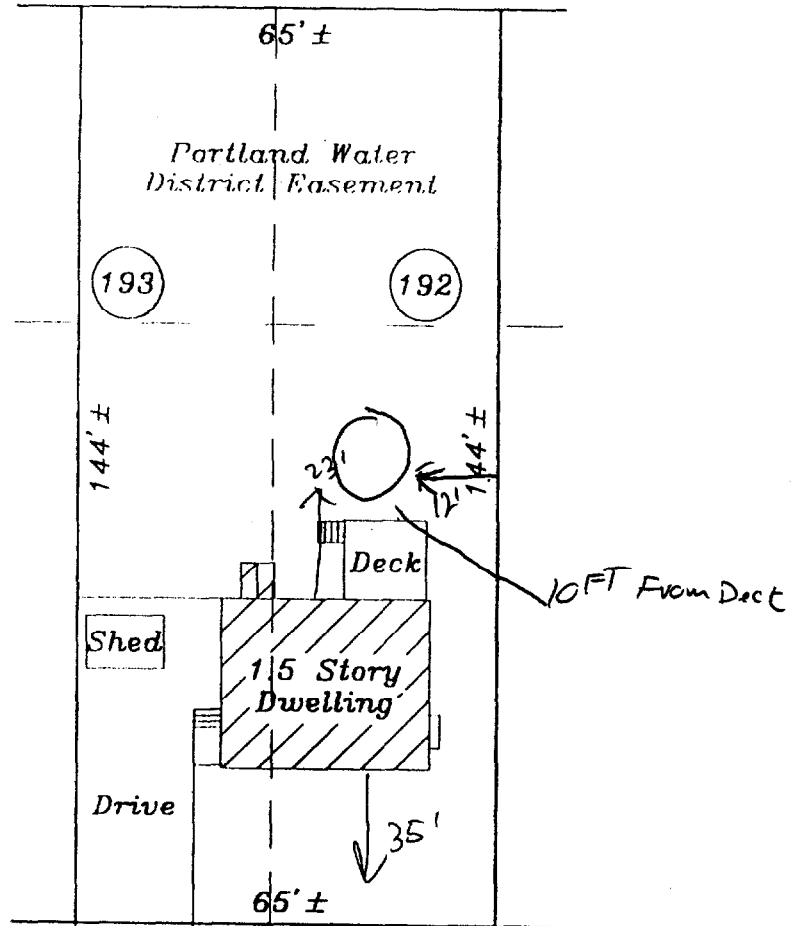

← To Washington Ave.

**SKYLARK ROAD**  
(f'ly BERTHA STREET)

SEE PROVIDED TITLE REFERENCES FOR APPLICABLE APPURTENANCES, IF ANY.

APPLICANT: SHARON ANDREWS      REQUESTING PARTY: LEETE & LEMIEUX  
 OWNER: ERIC & STEPHANIE SHIPLEY      ATTORNEY: JAMES R. LEMIEUX  
 LENDER: \_\_\_\_\_      FILE No. 2007875



**TITLE REFERENCES:**

YOUR FILE #: \_\_\_\_\_

DEED BOOK: 13139 PAGE: 263  
 PLAN BOOK: 14 PAGE: 70 LOT: p/o192+  
 COUNTY: CUMBERLAND      n/o199

**NADEAU & LODGE, INC.**  
 PROFESSIONAL LAND SURVEYORS

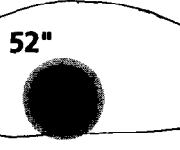
# Choice of Round or Oval Models... to fit any yard

Shape	Size/Feet	Size/Metres	Volume/U.S. Gal.	Volume/Litres
<b>Round Pool</b> 	12' x 52"	3.66 x 1.32	3,196	12,099
	15' x 52"	4.57 x 1.32	5,019	18,997
	18' x 52"	5.49 x 1.32	7,186	27,202
	21' x 52"	6.40 x 1.32	9,941	37,631
	24' x 52"	7.32 x 1.32	12,913	48,881
	27' x 52"	8.23 x 1.32	16,177	61,237
	30' x 52"	9.14 x 1.32	20,708	78,388
<b>Oval Pool</b> 	12' x 18' x 52"	3.66 x 5.49 x 1.32	5,341	20,222
	12' x 24' x 52"	3.66 x 7.32 x 1.32	7,300	27,633
	15' x 24' x 52"	4.57 x 7.32 x 1.32	9,110	34,484
	15' x 30' x 52"	4.57 x 9.14 x 1.32	11,430	43,270
	18' x 33' x 52"	5.49 x 10.1 x 1.32	14,880	56,330

## Frame & Wall Coatings

Atlantic Pools offer a beautiful combination of superior quality and exceptional value. Available in today's attractive colours and patterns, Atlantic offers strong, durable swimming pools that will assure years of trouble-free enjoyment. Top Rail

comes with Texture-Kote® coating for durability, the Galvanized Steel Frame is sealed with an exclusive coating to resist corrosion, scratching and U.V. rays. Oversized resin cap provides precise fit, extra strength and decorative finish.

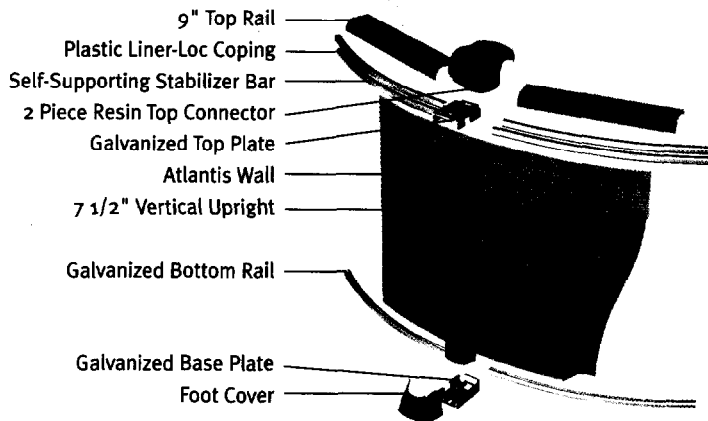

Dealer Imprint:

*\* Will have twist & lock single outlet w/ shut off switch for pump.*



**ATLANTIC**  
P O O L S

Jacuzzi Leisure Products • Canada: 1-800-387-2444 • USA: 1-800-836-1210  
330 Humberline Drive, Toronto, Ontario M9W 1R5

EASY ENTRY  
ENCLOSURE SYSTEM

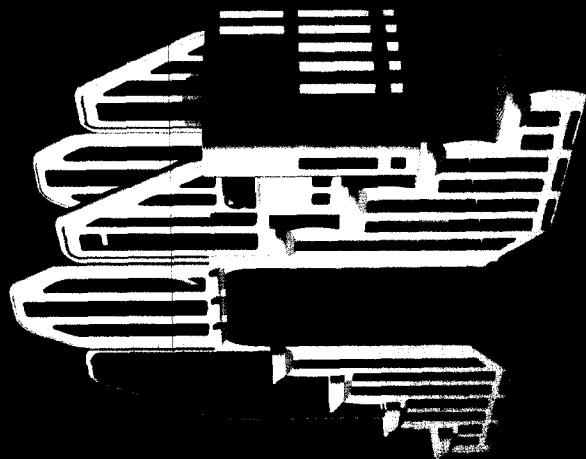

SMART CHOICE  
SYSTEM

