

DISPLAY THIS CARD ON PRINCIPAL FRONTAGE OF WORK

# CITY OF PORTLAND

## BUILDING INSPECTION

### PERMIT

**PERMIT ISSUED**

Permit Number: 060394  
APR - 3 2006

**CITY OF PORTLAND**

Please Read Application And Notes, If Any, Attached

This is to certify that POORE LORRAINE A

has permission to Install an 8' x 12' Shed

AT 119 HENNESSY DR

L 347 C009001

provided that the person or persons who perform or supervise the construction of this permit shall comply with all of the provisions of the Statutes of the State and of the Ordinances of the City of Portland regulating the construction, maintenance and use of buildings and structures, and of the application on file in this department.

Apply to Public Works for street line and grade if nature of work requires such information.

Notification of inspection must be given and when permission is procured before this building or part thereof is occupied or service is rendered in it. 4  
OUR NOTICE REQUIRED

A certificate of occupancy must be procured by owner before this building or part thereof is occupied.

**OTHER REQUIRED APPROVALS**

Fire Dept. \_\_\_\_\_  
Health Dept. \_\_\_\_\_  
Appeal Board \_\_\_\_\_  
Other \_\_\_\_\_  
Department Name

*[Signature]* 3/3/06  
Director - Building & Inspection Services

**PENALTY FOR REMOVING THIS CARD**

PERMIT ISSUED

City of Portland, Maine - Building or Use Permit Application

389 Congress Street, 04101 Tel: (207) 874-8703, Fax: (207) 874-8716

Permit No: 06-0394	Issue Date: APR - 3 2006	CBL: 347 C009001
-----------------------	-----------------------------	---------------------

Location of Construction: 119 HENNESSY DR	Owner Name: POORE LORRAINE A	Owner Address: 119 HENNESSY DR	Phone:
Business Name:	Contractor Name:	Contractor Address:	Phone:
Lessee/Buyer's Name	Phone:	Permit Type: Sheds	Zone: R3

Past Use: Single Family Home	Proposed Use: Single Family Home/ Install an 8' x 12' Shed	Permit Fee: \$39.00	Cost of Work: \$1,800.00	CEO District: 5
---------------------------------	---	------------------------	-----------------------------	--------------------

Proposed Project Description:  
Install an 8' x 12' Shed

FIRE DEPT: <input type="checkbox"/> Approved <input type="checkbox"/> Denied <i>N/A</i>	INSPECTION: Use Group: <i>U</i> Type: <i>5B</i> <i>3/3/06</i>
Signature:	Signature:
PEDESTRIAN ACTIVITIES DISTRICT (P.A.D.)	
Action: <input type="checkbox"/> Approved <input type="checkbox"/> Approved w/Conditions <input type="checkbox"/> Denied	
Signature:	Date:

Permit Taken By: Idobson	Date Applied For: 03/24/2006	<b>Zoning Approval</b>
-----------------------------	---------------------------------	------------------------

<ol style="list-style-type: none"> <li>This permit application does not preclude the Applicant(s) from meeting applicable State and Federal Rules.</li> <li>Building permits do not include plumbing, septic or electrical work.</li> <li>Building permits are void if work is not started within six (6) months of the date of issuance. False information may invalidate a building permit and stop all work..</li> </ol>	<b>Special Zone or Reviews</b> <input type="checkbox"/> Shoreland <input type="checkbox"/> Wetland <input type="checkbox"/> Flood Zone <input type="checkbox"/> Subdivision <input type="checkbox"/> Site Plan Maj <input type="checkbox"/> Minor <input type="checkbox"/> MM <input type="checkbox"/>	<b>Zoning Appeal</b> <input type="checkbox"/> Variance <input type="checkbox"/> Miscellaneous <input type="checkbox"/> Conditional Use <input type="checkbox"/> Interpretation <input type="checkbox"/> Approved <input type="checkbox"/> Denied	<b>Historic Preservation</b> <input type="checkbox"/> Not in District or Landmark <input type="checkbox"/> Does Not Require Review <input type="checkbox"/> Requires Review <input type="checkbox"/> Approved <input type="checkbox"/> Approved w/Conditions <input type="checkbox"/> Denied
	Date:	Date:	Date:

CERTIFICATION

I hereby certify that I am the owner of record of the named property, or that the proposed work is authorized by the owner of record and that I have been authorized by the owner to make this application as his authorized agent and I agree to conform to all applicable laws of this jurisdiction. In addition, if a permit for work described in the application is issued, I certify that the code official's authorized representative shall have the authority to enter all areas covered by such permit at any reasonable hour to enforce the provision of the code(s) applicable to such permit.

SIGNATURE OF APPLICANT	ADDRESS	DATE	PHONE
RESPONSIBLE PERSON IN CHARGE OF WORK, TITLE		DATE	PHONE

**City of Portland, Maine - Building or Use Permit**

389 Congress Street, 04101 Tel: (207) 874-8703, Fax: (207) 874-8716

<b>Permit No:</b> 06-0394	<b>Date Applied For:</b> 03/24/2006	<b>CBL:</b> 347 C009001
------------------------------	--	----------------------------

<b>Location of Construction:</b> 119 HENNESSY DR	<b>Owner Name:</b> POORE LORRAINE A	<b>Owner Address:</b> 119 HENNESSEY DR	<b>Phone:</b>
<b>Business Name:</b>	<b>Contractor Name:</b>	<b>Contractor Address:</b>	<b>Phone:</b>
<b>Lessee/Buyer's Name</b>	<b>Phone:</b>	<b>Permit Type:</b> Sheds	
<b>Proposed Use:</b> Single Family Home/ Install an 8' x 12' Shed		<b>Proposed Project Description:</b> Install an 8' x 12' Shed	

**Dept:** Zoning      **Status:** Approved with Conditions      **Reviewer:** Mike Nugent      **Approval Date:** 03/31/2006  
**Note:**      **Ok to Issue:**

1) Must be 5 feet set back from the actual side and rear property lines.

**Dept:** Building      **Status:** Not Applicable      **Reviewer:** Mike Nugent      **Approval Date:** 03/31/2006  
**Note:**      **Ok to Issue:**

1) Less than 120 sq.ft.



# General Building Permit Application

If you or the property owner owes real estate or personal property taxes or user charges on any property within the City, payment arrangements must be made before permits of any kind are accepted.

Location/Address of Construction: <u>9 Hennessy Dr.</u>		
Total Square Footage of Proposed Structure <u>46'</u>	Square Footage of Lot <u>143.32</u> <u>142.130</u>	
Assessor's Chart, Block & Lot Chart# <u>3Y7</u> Block# <u>C</u> Lot# <u>9</u>	Owner: <u>LORRAINE A. POORE</u>	Telephone: <u>797-3961</u>
Lessee/Buyer's Name (If Applicable)	Applicant name, address & telephone: <u>LORRAINE A. POORE</u> <u>119 HENNESSY DRIVE</u> <u>PORTLAND</u>	cost Of Work: \$ <u>1800.00</u> Fee: \$ _____ C of O Fee: \$ _____
Current Specific use: If vacant, what was the previous use? <u>x wall</u> Proposed Specific use: _____		
Project description: <u>12' Long</u> <u>8' Wide</u> <u>8' High</u>		
Contractor's name, address & telephone: <u>Ralph W. Poore</u>		
Who should we contact when the permit is ready: <u>LORRAINE A. POORE</u>		
Mailing address:		Phone: <u>797.3961</u>

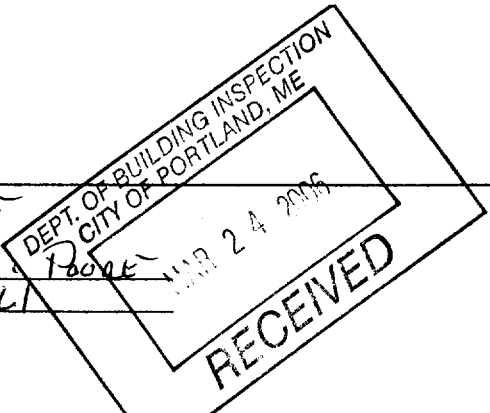

**Please submit all of the information outlined in the Commercial Application Checklist. Failure to do so will result in the automatic denial of your permit.**

In order to be sure the City fully understands the full scope of the project, the Planning and Development Department may request additional information prior to the issuance of a permit. For further information visit us on-line at [www.portlandmaine.gov](http://www.portlandmaine.gov), stop by the Building Inspections office, room 315 City Hall or call 874-8703.

I hereby certify that I am the Owner of record of the named property, or that the owner of record authorizes the proposed work and that I have been authorized by the owner to make this application as his/her authorized agent. I agree to conform to all applicable laws of this jurisdiction. In addition, if a permit for work described in this application is issued, I certify that the Code Official's authorized representatives shall have the authority to enter all areas covered by this permit at any reasonable hour to enforce the provisions of the codes applicable to this permit

Signature of applicant: <u>Ralph W. Poore</u>	Date: <u>3-24-06</u>
---	----------------------

**This is not a permit; you may not commence ANY work until the permit is issued.**

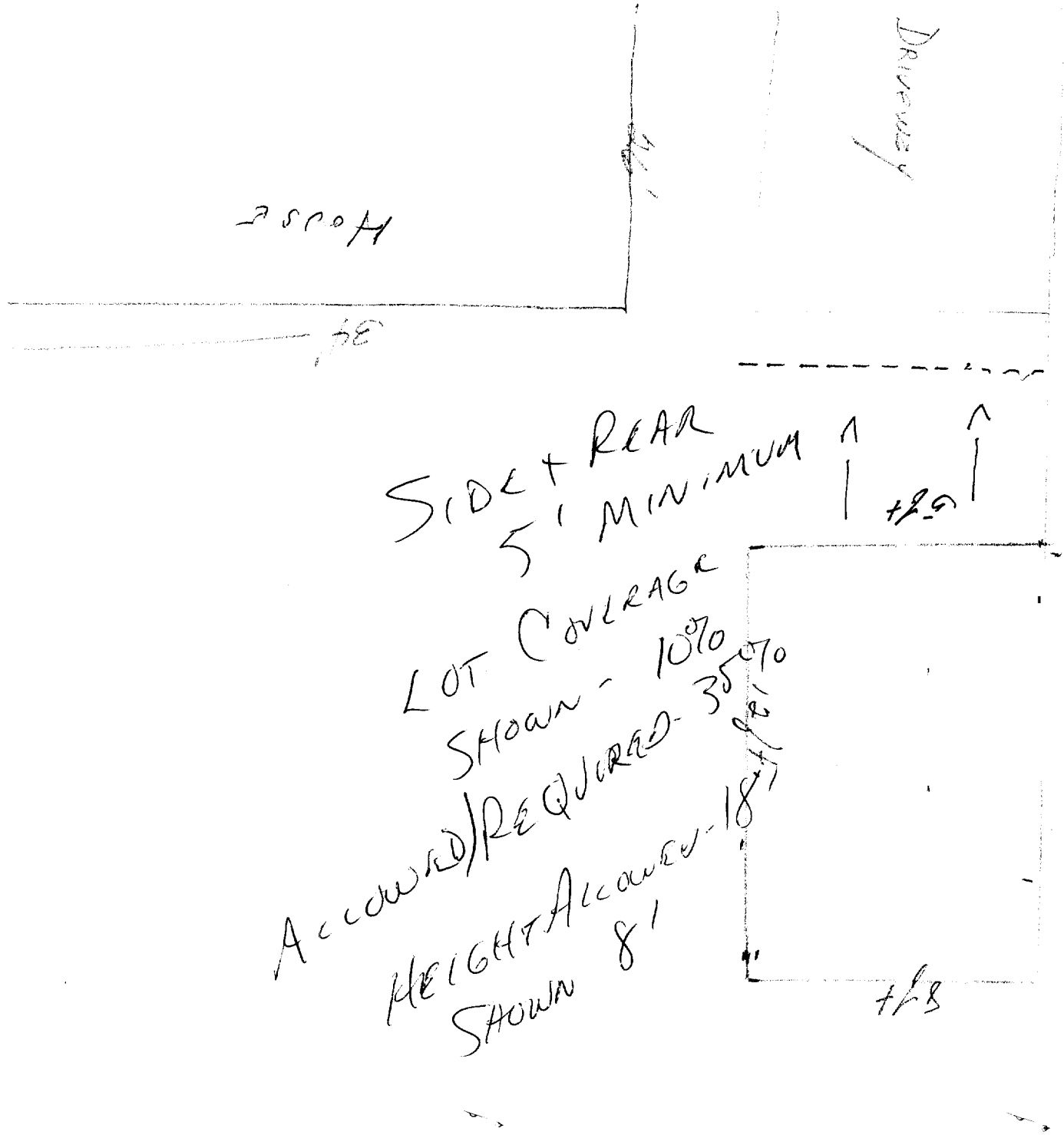

DORRINE A. FORT  
119 HERRASSY DRIVE

Notes: Medicare Part D  
LOT ... 14.5 ... 149.36 ...

Storage Shed For Lawn Tools 8'x12'

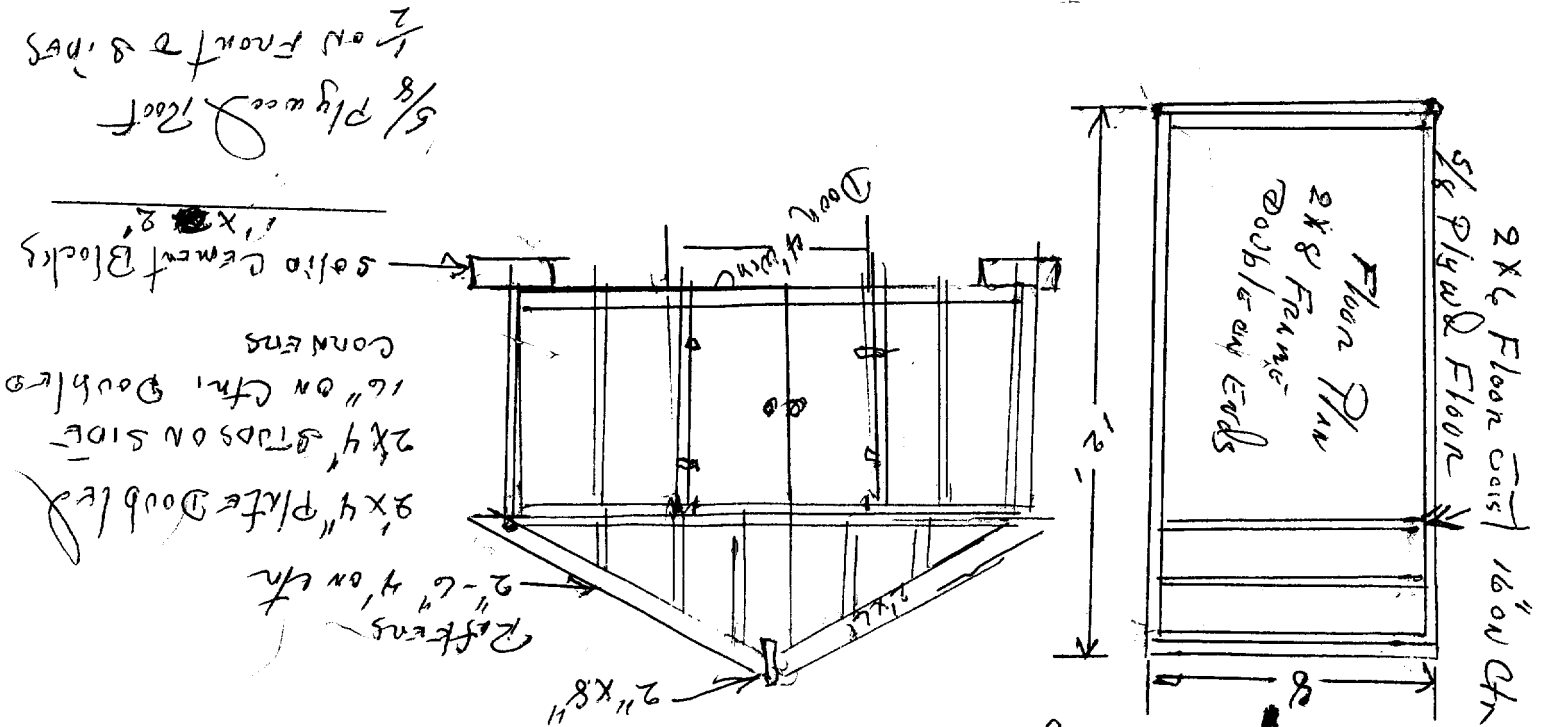

12  
8  
96

143  
142  
286  
5720