

City of Portland, Maine - Building or Use Permit Application

389 Congress Street, 04101 Tel: (207) 874-8703, Fax: (207) 874-8716

Permit No: 07-1481	Issue Date: 12/07/2007	CBL: 347 B035001
-----------------------	---------------------------	---------------------

Location of Construction: 104 HENNESSY DR	Owner Name: BEERS KATHLEEN M	Owner Address: 104 HENNESSY DR	Phone:
Business Name:	Contractor Name: Down East Energy	Contractor Address: 172 Main Street South Portland	Phone 2077995585
Lessee/Buyer's Name	Phone:	Permit Type: Tanks - Dwellings	Zone:

Past Use: Single Family Home	Proposed Use: Single Family Home - install a 120 gallon propane tank	Permit Fee: \$30.00	Cost of Work: \$30.00	CEO District: 5
Proposed Project Description: install a 120 gallon propane tank		FIRE DEPT: <input type="checkbox"/> Approved <input type="checkbox"/> Denied Signature: <i>[Signature]</i>		INSPECTION: Use Group: <i>NWA</i> Type: Signature: <i>[Signature]</i>
		PEDESTRIAN ACTIVITIES DISTRICT (P.A.D.) Action: <input type="checkbox"/> Approved <input type="checkbox"/> Approved w/Conditions <input type="checkbox"/> Denied Signature: _____ Date: _____		

Permit Taken By: Idobson	Date Applied For: 12/07/2007	Zoning Approval	
-----------------------------	---------------------------------	------------------------	--

- This permit application does not preclude the Applicant(s) from meeting applicable State and Federal Rules.
- Building permits do not include plumbing, septic or electrical work.
- Building permits are void if work is not started within six (6) months of the date of issuance. False information may invalidate a building permit and stop all work..

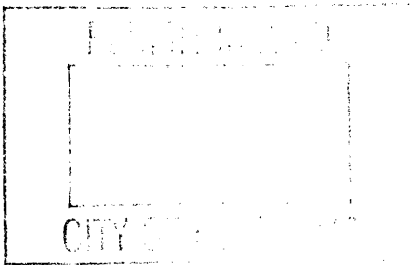

Special Zone or Reviews	Zoning Appeal	Historic Preservation
<input type="checkbox"/> Shoreland <input type="checkbox"/> Wetland <input type="checkbox"/> Flood Zone <input type="checkbox"/> Subdivision <input type="checkbox"/> Site Plan Maj <input type="checkbox"/> Minor <input type="checkbox"/> MM <input type="checkbox"/> Date: <i>12/1/07</i>	<input type="checkbox"/> Variance <input type="checkbox"/> Miscellaneous <input type="checkbox"/> Conditional Use <input type="checkbox"/> Interpretation <input type="checkbox"/> Approved <input type="checkbox"/> Denied Date: _____	<input checked="" type="checkbox"/> Not in District or Landmark <input type="checkbox"/> Does Not Require Review <input type="checkbox"/> Requires Review <input type="checkbox"/> Approved <input type="checkbox"/> Approved w/Conditions <input type="checkbox"/> Denied Date: <i>12/1/07</i>

CERTIFICATION

I hereby certify that I am the owner of record of the named property, or that the proposed work is authorized by the owner of record and that I have been authorized by the owner to make this application as his authorized agent and I agree to conform to all applicable laws of this jurisdiction. In addition, if a permit for work described in the application is issued, I certify that the code official's authorized representative shall have the authority to enter all areas covered by such permit at any reasonable hour to enforce the provision of the code(s) applicable to such permit.

SIGNATURE OF APPLICANT	ADDRESS	DATE	PHONE
RESPONSIBLE PERSON IN CHARGE OF WORK, TITLE		DATE	PHONE

City of Portland, Maine - Building or Use Permit

389 Congress Street, 04101 Tel: (207) 874-8703, Fax: (207) 874-8716

Permit No: 07-1481	Date Applied For: 12/07/2007	CBL: 347 B035001
------------------------------	--	----------------------------

Location of Construction: 104 HENNESSY DR	Owner Name: BEERS KATHLEEN M	Owner Address: 104 HENNESSY DR	Phone:
Business Name:	Contractor Name: Down East Energy	Contractor Address: 172 Main Street South Portland	Phone (207) 799-5585
Lessee/Buyer's Name	Phone:	Permit Type: Tanks - Dwellings	

Proposed Use: Single Family Home - install a 120 gallon propane tank	Proposed Project Description: install a 120 gallon propane tank
--	---

Dept: Zoning	Status: Approved	Reviewer: Tammy Munson	Approval Date: 12/07/2007
Note:			Ok to Issue: <input checked="" type="checkbox"/>
Dept: Building	Status: Approved with Conditions	Reviewer: Tammy Munson	Approval Date: 12/07/2007
Note:			Ok to Issue: <input checked="" type="checkbox"/>
1) The installation must comply with the State of Maine Gas Regulations.			



FILL IN AND SIGN WITH INK

APPLICATION FOR PERMIT HEATING OR POWER EQUIPMENT

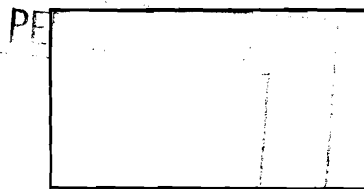

071481

To the INSPECTOR OF BUILDINGS, PORTLAND, ME.

The undersigned hereby applies for a permit to install the following heating, cooking or power equipment in accordance with the Laws of Maine, the Building Code of the City of Portland, and the following specifications:

Location / CBL 347 B35 Use of Building Private Date 12/26/7
 Name and address of owner of appliance Kathleen Beers 114 Hennessy St
Portland
 Installer's name and address Down East Energy 172 Main St
South Portland Telephone 799-5585

Location of appliance:

- Basement
- Attic
- Floor
- Roof

Type of Fuel:

- Gas
- Oil
- Solid

Appliance Name:

U.L. Approved Yes No

Will appliance be installed in accordance with the manufacture's installation instructions? Yes No

IF NO Explain: _____

The Type of License of Installer:

- Master Plumber # _____
- Solid Fuel # _____
- Oil # _____
- Gas # PWT 1445
- Other _____

Type of Chimney:

- Masonry Lined
Factory built _____
- Metal
Factory Built U.L. Listing # _____
- Direct Vent
Type _____ UL# _____

Type of Fuel Tank

- Oil
- Gas

Size of Tank 70

Number of Tanks 1

Distance from Tank to Center of Flame _____ feet.

Cost of Work: \$ _____

Permit Fee: \$ _____

Approved

Approved with Conditions

Fire: _____

Ele.: _____

Bldg.: _____

See attached letter or requirement

Inspector's Signature

Date Approved

Signature of Installer [Signature]

KATHLEEN BEERS
104 Hemmessey
Portland

06/06/2007 09:09 2078797871

JAMES D. NADEAU, LLC

PNL

FOR MORTGAGE LENDER USE ONLY

GENERAL NOTE: (1) THIS SKETCH IS NOT TO BE USED FOR CONSTRUCTION PURPOSES. (2) THE LOCATION OF IMPROVEMENTS SHOWN ARE APPROXIMATE ONLY. (3) THIS SKETCH IS NOT TO BE USED FOR CONSTRUCTION PURPOSES. (4) THE LOCATION OF IMPROVEMENTS SHOWN ARE APPROXIMATE ONLY. (5) THIS SKETCH IS NOT TO BE USED FOR CONSTRUCTION PURPOSES. (6) THE LOCATION OF IMPROVEMENTS SHOWN ARE APPROXIMATE ONLY. (7) THIS SKETCH IS NOT TO BE USED FOR CONSTRUCTION PURPOSES. (8) THE LOCATION OF IMPROVEMENTS SHOWN ARE APPROXIMATE ONLY. (9) THIS SKETCH IS NOT TO BE USED FOR CONSTRUCTION PURPOSES. (10) THE LOCATION OF IMPROVEMENTS SHOWN ARE APPROXIMATE ONLY.

**THIS SKETCH IS NOT TO BE USED FOR CONSTRUCTION PURPOSES
THE LOCATION OF IMPROVEMENTS SHOWN ARE APPROXIMATE ONLY.**

ADDRESS: 104 Hemmessey Drive INSPECTION DATE: 6-17-07
Portland, Maine SCALE: 1" = 32'

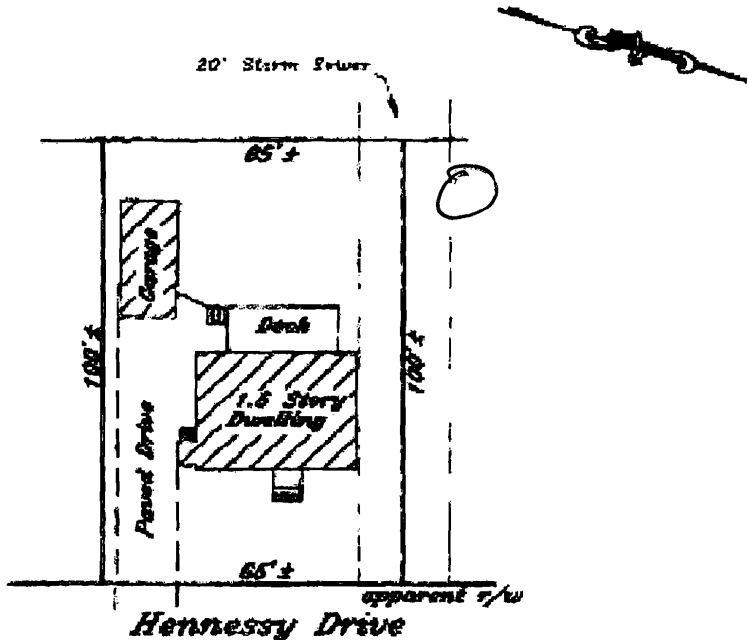

INSP BY: CJE

SEE PROVIDED TITLE REFERENCES FOR APPLICABLE APPURTENANCES, IF ANY.

APPLICANT: Kathleen M. Beers REF. PARTY: Atlantic Title Company
OWNER: John L. & Judith A. Robinson ATTORNEY:
LENDER: Meredith Mortgage Group, Inc. FILE NO. 8888888 CLIENT NO. 1234567

TITLE REFERENCES:
DEED BOOK 80842 PAGE 312
PLAN BOOK 52 PAGE 52 LOT 12
COUNTY Cumberland

MUNICIPAL REFERENCE:
MAP 367 BLOCK B LOT 35

THE DWELLING DOES NOT FALL WITHIN A SPECIAL FLOOD HAZARD ZONE PER FEMA COMMUNITY MAP NO. 488888 PLATE 42 ZONE X DATE 12-6-06

THE DWELLING IS NOT IN COMPLIANCE WITH MUNICIPAL SEWER SEWERAGE REQUIREMENTS AT THE TIME OF CONSTRUCTION.

COMMENTS:
Subject to an easement per book 2684/492

James D. Nadeau, LLC
Professional Land Surveyors

NO BOUNDARY SURVEY
NO CONVEYANCE OF REAL ESTATE
THIS SURVEY IS FOR MORTGAGE LENDER USE ONLY
IT IS NOT TO BE USED FOR RECORDING

THIS IS NOT A BOUNDARY SURVEY - NOT FOR RECORDING