

NO.	DATE	REVISION DESCRIPTION
1	01/18/2017	PLAN REVISIONS

WATER DISTRICT LOT
FRANK & SANTO DIDONATO
89 Skylark Road
Portland, MAINE

DRAWINGS THIS SHEET
BUILDING SECTIONS

DATE: 09/14/2016
REVISION DATE: -
DRAWN BY: JFD

SHEET:
A4.1

- OF -

© COPYRIGHT
REPRODUCTION OR REUSE OF THIS
DOCUMENT WITHOUT WRITTEN
PERMISSION OF DIDONATO
ARCHITECTS IS PROHIBITED

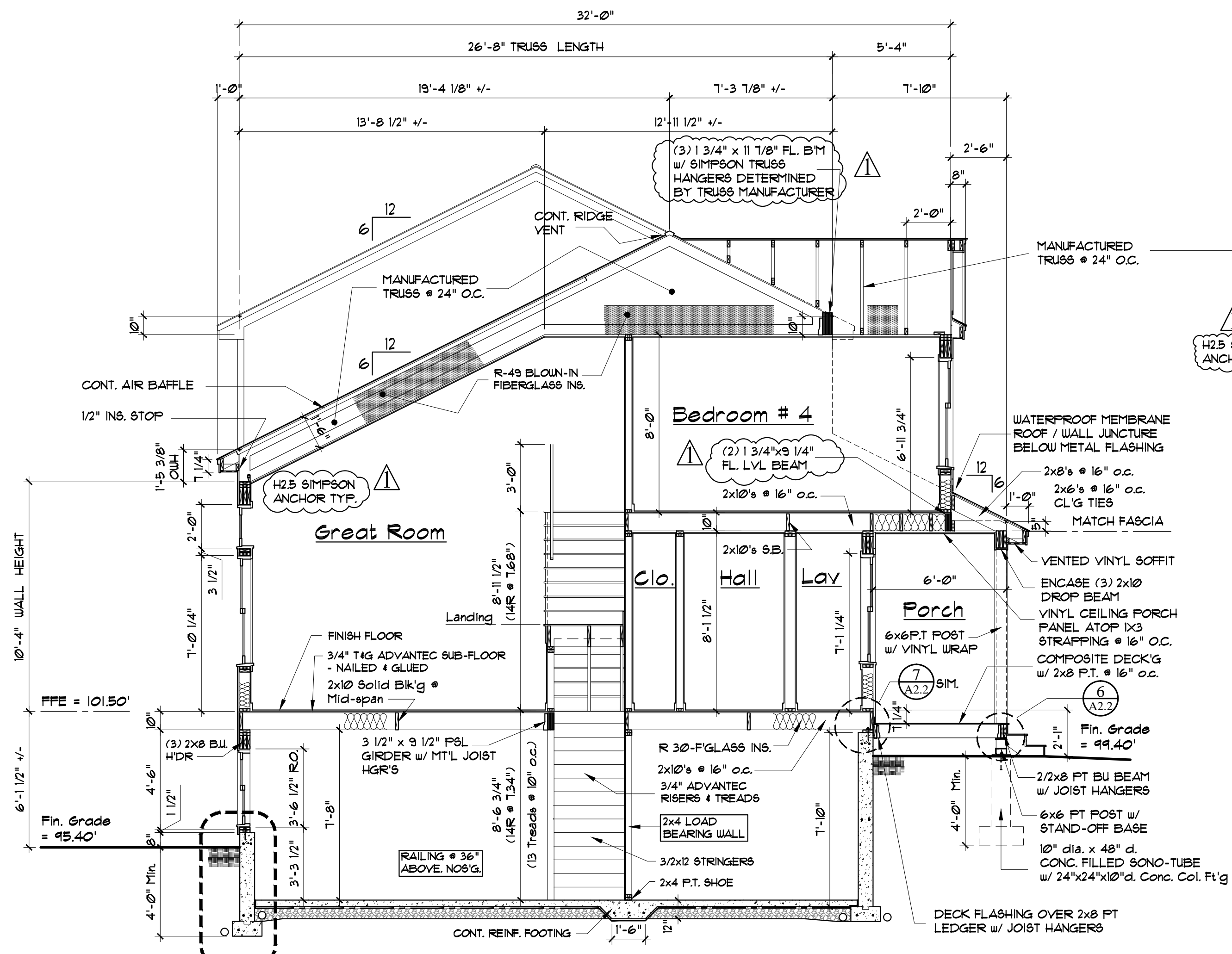

B BUILDING SECTION
Scale: 1/4" = 1'-0"

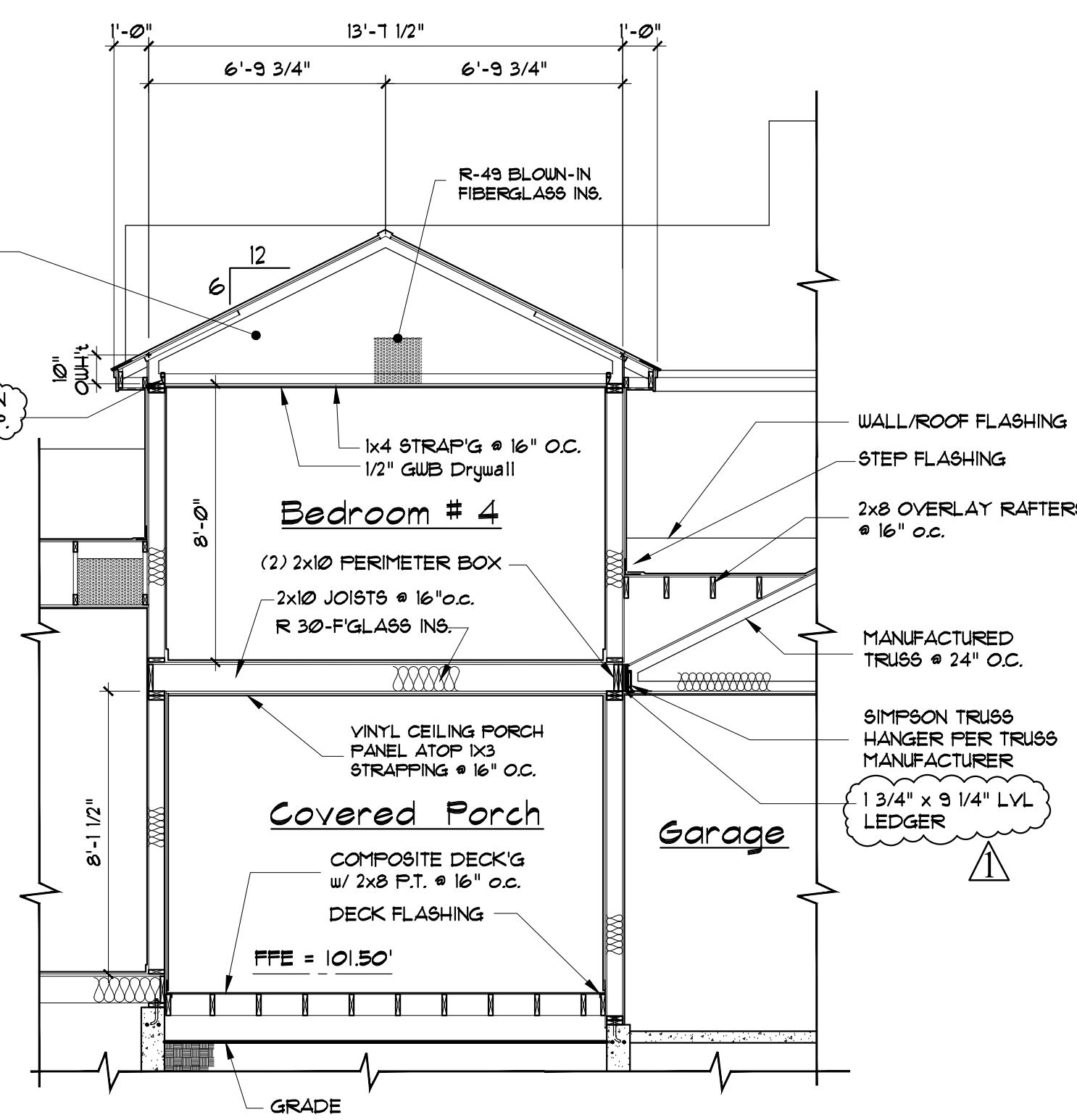

E BUILDING SECTION
Scale: 1/4" = 1'-0"

- MANUF. TRUSS SPECS:**
TC LL = 46.2 PSF
(Ground Snow = 60.0)
TC DL = 10.0 PSF
BC LL = 0.0 PSF
BC DL = 10.0 PSF
- FLOOR JOIST SPECS:**
WOOD SPECIES:
SFF = 2 OR BETTER
LL = 40.0 PSF
DL = 15.0 PSF

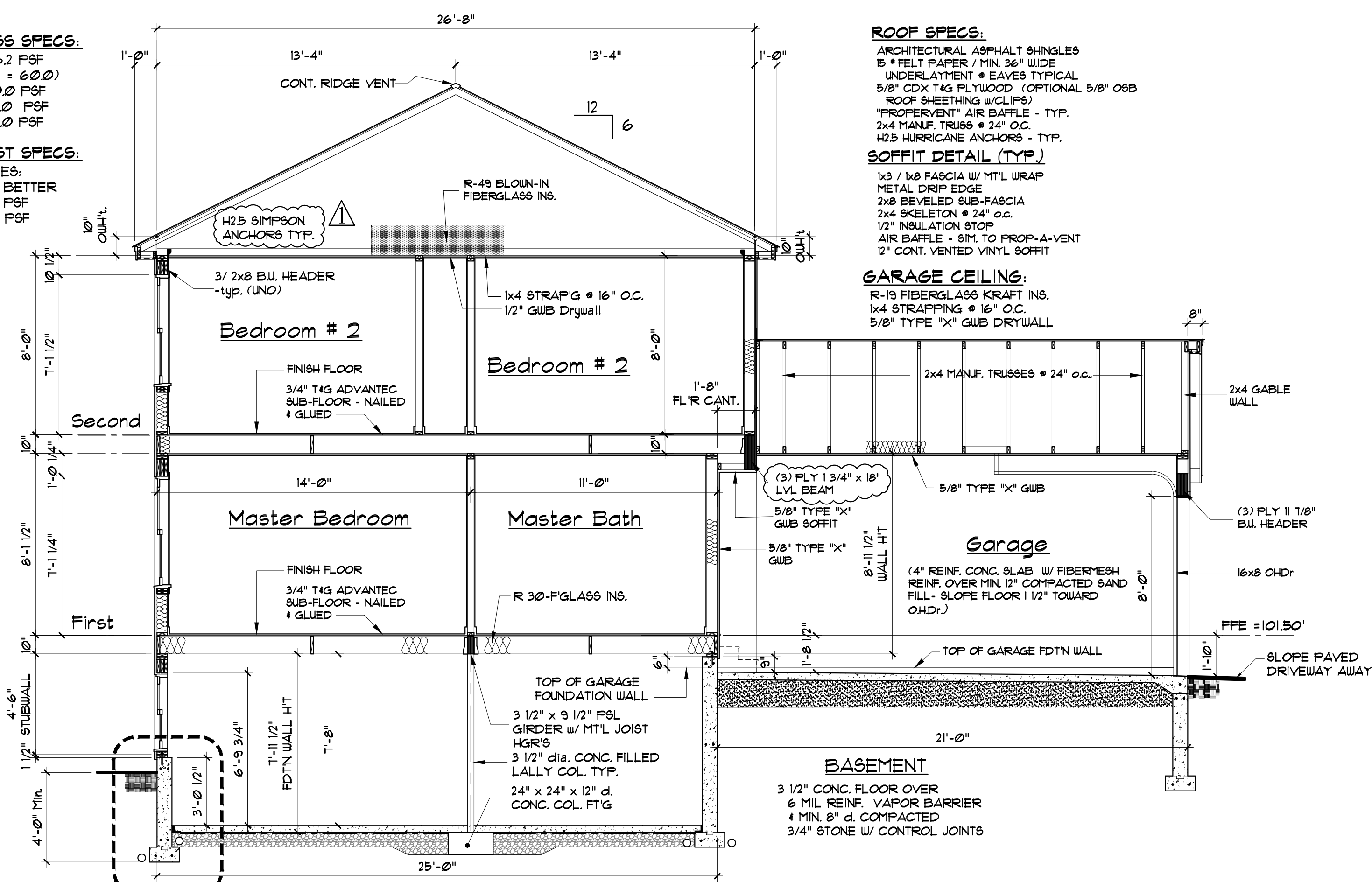

C BUILDING SECTION
Scale: 1/4" = 1'-0"

- ROOF SPECS:**
ARCHITECTURAL ASPHALT SHINGLES
15' FELT PAPER / MIN. 3/8" WIDE
UNDERLAYMENT - EAVES TYPICAL
5/8" CDX TAG PLYWOOD (OPTIONAL 5/8" OSB
ROOF SHEATHING w/CLIPS)
"PROPERVENT" AIR BAFFLE - TYP.
2x4 MANUF. TRUSSES @ 24" O.C.
H2.5 HURRICANE ANCHORS - TYP.
- SOFFIT DETAIL (TYP.)**
1x3 / 1x8 FASCIA w/ MTL WRAP
METAL DRIP EDGE
2x8 BEVELED SUB-FASCIA
2x4 SKELETON @ 24" O.C.
1/2" INSULATION STOP
AIR BAFFLE - SIM. TO PROP-A-VENT
12" CONT. VENTED VINYL SOFFIT
- GARAGE CEILING:**
R-19 FIBERGLASS KRAFT INS.
1x4 STRAPPING @ 16" O.C.
5/8" TYPE 'X' GUB DRYWALL

- GARAGE ROOF SPECS:**
ARCHITECTURAL ASPHALT SHINGLES
15' FELT PAPER / MIN. 3/8" WIDE
UNDERLAYMENT - EAVES TYPICAL
5/8" CDX TAG PLYWOOD
(OPTIONAL 5/8" OSB) ROOF SHEATHING w/CLIPS)
2x4 MANUF. TRUSSES @ 24" O.C.
H2.5 HURRICANE ANCHORS - TYP.

- SOFFIT DETAIL (TYP.)**
1x3 / 1x8 FASCIA w/ MTL WRAP
METAL DRIP EDGE
2x8 BEVELED SUB-FASCIA
2x4 SKELETON @ 24" O.C.
8" CONT. VENTED VINYL SOFFIT

- GARAGE**
4" REIN. CONC. SLAB w/ FIBERGLASS REIN.
OVER MIN. 1" COMPACTED SAND FILL -
SLOPE FLOOR 1/2" TOWARD O.H.D.R.)

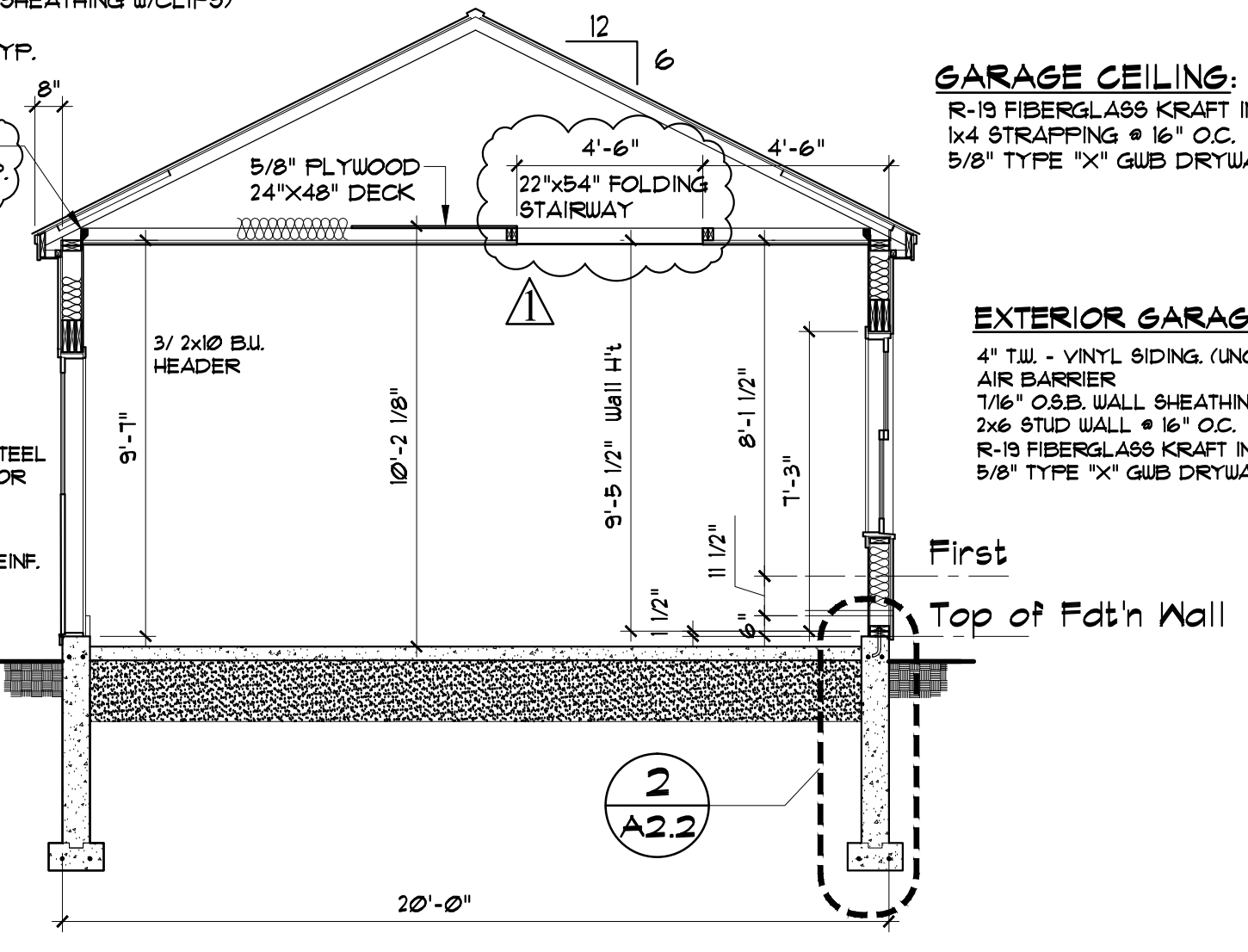

D GARAGE SECTION
Scale: 1/4" = 1'-0"

FOR CONSTRUCTION_09-14-16