

Anchor Bolts
1/2" x 8" - Max 4'-0" OC

What size are the anchor bolts?

2x6 P.T. STD. BILL w/ ANCHOR BOLTS - MAX. 4'-0" O.C.
1/2" x 6" FIBERGLASS BILL SEALER

BASEMENT FLOOR
4" REIN. CONC. SLAB w/ FIBER MESH OVER MIN. 1" d. COMPACTED SAND SLOPE FLOOR 1/2" TOWARD O.H.D.

Be more specific as to the type of damp proofing.

Henry 789 fibered asphalt emulsion damp proofing

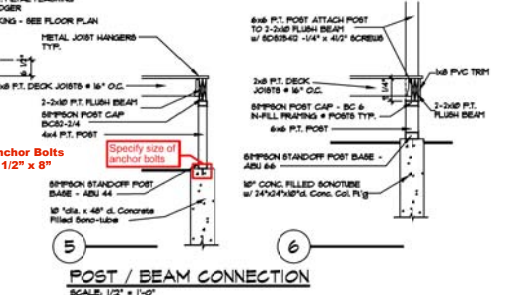
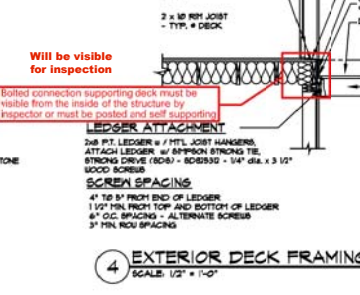
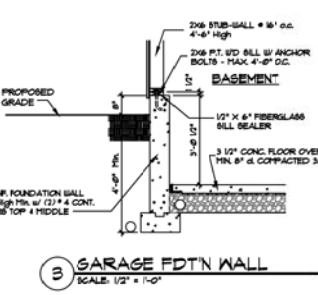

Will be visible for inspection

Both connection supporting deck must be visible from the inside of the structure by Inspector or must be posted and self supporting

LEDGER ATTACHMENT
2x6 P.T. LEDGER w/ HTL JOIST HANGERS ATTACH LEDGER w/ SIMPSON STRONG TIE STRONG DRIVE (SDS) - SDS330 - 1/4" dia. x 3 1/2" SPOD SCREWS

SCREEN SPACING
4" TO 8" FROM END OF LEDGER
1 1/2" MIN FROM TOP AND BOTTOM OF LEDGER
6" O.C. SPACING - ALTERNATE SCREWS
3" RH ROD SPACING

Anchor Bolts
1/2" x 8"

Specify size of anchor bolts

FOR CONSTRUCTION 09-14-16

DIDONATO RESISTO
CONSTRUCTION & DESIGN

114 Gates Road, Scarborough, ME 04074
P: 207.286.9000 F: 207.286.2900
T: Mail: didonato@didonato.com
www.didonato.com

NO.	REVISION	DESCRIPTION	DATE

WATER DISTRICT LOT
FRANK & SANTO DIDONATO
89 Skylark Road
Portland, MAINE

FOUNDATIONS PLAN
/ DETAILS

DRAWING THIS SHEET

DATE: 04/14/2016
REVISION DATE: -
DRAWN BY: JPD
SHEET: **A2.2**

© COPY RIGHT
REPRODUCTION OR USE OF THIS
DOCUMENT WITHOUT WRITTEN
PERMISSION OF DIDONATO
IS PROHIBITED