

DISPLAY THIS CARD ON PRINCIPAL FRONTAGE OF WORK CITY OF PORTLAND

BUILDING PERMIT

Permit Number: 090410

Please Read Application And Notes, If Any, Attached

This is to certify that CARVER LISA M /Northern Construction
has permission to Install 10'x12' Deck
AT 13 CHAPMAN ST CB# 344 1007001

provided that the person or persons, firm or corporation accepting this permit shall comply with all of the provisions of the Statutes of Maine and of the Ordinances of the City of Portland regulating the construction, maintenance and use of buildings and structures, and of the application on file in this department.

Apply to Public Works for street line and grade if nature of work requires such information.

Notification of inspection must be given and written permission procured before this building or part thereof is lathed or otherwise enclosed-in. 24 HOUR NOTICE IS REQUIRED.

A certificate of occupancy must be procured by owner before this building or part thereof is occupied.

PERMIT ISSUED	
OTHER REQUIRED APPROVALS	
Fire Dept.	
Health Dept.	MAY - 5 2009
Appeal Board	
Other	
CITY OF PORTLAND	

Thomas R. MacLay 5/5/09
Director - Building & Inspection Services

PENALTY FOR REMOVING THIS CARD

City of Portland, Maine - Building or Use Permit Application
 389 Congress Street, 04101 Tel: (207) 874-8703, Fax: (207) 874-8716

Permit No: 09-0410	Issue Date:	CBL: 344 I007001
-----------------------	-------------	---------------------

Location of Construction: 13 CHAPMAN ST	Owner Name: CARVER LISA M	Owner Address: 1 FIELDSTONE CT	Phone: 207-415-3203
Business Name:	Contractor Name: Northern Construction Services	Contractor Address: 47 Anthoine Road Windham	Phone: 2077498341
Lessee/Buyer's Name	Phone:	Permit Type: Additions - Dwellings	Zone: R3

Past Use: Single Family	Proposed Use: Single Family - Install 10'x12' Deck	Permit Fee: \$40.00	Cost of Work: \$2,000.00	CEO District: 5
Proposed Project Description: Install 10'x12' Deck		FIRE DEPT: <input type="checkbox"/> Approved <input type="checkbox"/> Denied	INSPECTION: Use Group: R3 Type: SB JRC 2003	
		Signature: Jm 5/5/09		
PEDESTRIAN ACTIVITIES DISTRICT (P.A.D.)				
Action: <input type="checkbox"/> Approved <input type="checkbox"/> Approved w/Conditions <input type="checkbox"/> Denied				
Signature: _____ Date: _____				

Permit Taken By: lmd	Date Applied For: 05/05/2009	Zoning Approval		
1. This permit application does not preclude the Applicant(s) from meeting applicable State and Federal Rules. 2. Building permits do not include plumbing, septic or electrical work. 3. Building permits are void if work is not started within six (6) months of the date of issuance. False information may invalidate a building permit and stop all work..		Special Zone or Reviews <input type="checkbox"/> Shoreland <input type="checkbox"/> Wetland <input type="checkbox"/> Flood Zone <input type="checkbox"/> Subdivision <input type="checkbox"/> Site Plan Maj <input type="checkbox"/> Minor <input type="checkbox"/> MM <input type="checkbox"/> Date: Jm 5/5/09	Zoning Appeal <input type="checkbox"/> Variance <input type="checkbox"/> Miscellaneous <input type="checkbox"/> Conditional Use <input type="checkbox"/> Interpretation <input type="checkbox"/> Approved <input type="checkbox"/> Denied Date: _____	Historic Preservation <input checked="" type="checkbox"/> Not in District or Landmark <input checked="" type="checkbox"/> Does Not Require Review <input type="checkbox"/> Requires Review <input type="checkbox"/> Approved <input type="checkbox"/> Approved w/Conditions <input type="checkbox"/> Denied Date: 5/5/09
		OIC		

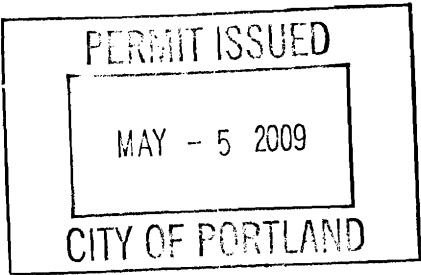

CERTIFICATION

I hereby certify that I am the owner of record of the named property, or that the proposed work is authorized by the owner of record and that I have been authorized by the owner to make this application as his authorized agent and I agree to conform to all applicable laws of this jurisdiction. In addition, if a permit for work described in the application is issued, I certify that the code official's authorized representative shall have the authority to enter all areas covered by such permit at any reasonable hour to enforce the provision of the code(s) applicable to such permit.

SIGNATURE OF APPLICANT	ADDRESS	DATE	PHONE
RESPONSIBLE PERSON IN CHARGE OF WORK, TITLE		DATE	PHONE

City of Portland, Maine - Building or Use Permit

389 Congress Street, 04101 Tel: (207) 874-8703, Fax: (207) 874-8716

Permit No: 09-0410	Date Applied For: 05/05/2009	CBL: 344 I007001
------------------------------	--	----------------------------

Location of Construction: 13 CHAPMAN ST	Owner Name: CARVER LISA M	Owner Address: 1 FIELDSTONE CT	Phone: 207-415-3203
Business Name:	Contractor Name: Northern Construction Services	Contractor Address: 47 AnthoineRoad Windham	Phone: (207) 749-8341
Lessee/Buyer's Name	Phone:	Permit Type: Additions - Dwellings	

Proposed Use: Single Family - Install 10'x12' Deck	Proposed Project Description: Install 10'x12' Deck
--	--

Dept: Zoning **Status:** Approved with Conditions **Reviewer:** Tom Markley **Approval Date:** 05/05/2009

Note: **Ok to Issue:**

- 1) This property shall remain a single family dwelling. Any change of use shall require a separate permit application for review and approval.
- 2) This permit is being approved on the basis of plans submitted. Any deviations shall require a separate approval before starting that work.

Dept: Building **Status:** Approved with Conditions **Reviewer:** Tom Markley **Approval Date:** 05/05/2009

Note: **Ok to Issue:**

- 1) Application approval based upon information provided by applicant. Any deviation from approved plans requires separate review and approval prior to work.



General Building Permit Application

If you or the property owner owes real estate or personal property taxes or user charges on any property within the City, payment arrangements must be made before permits of any kind are accepted.

Location/Address of Construction: <u>13 CHAPMAN ST</u>		
Total Square Footage of Proposed Structure/Area <u>10x12 = 120 sq. ft.</u>		Square Footage of Lot <u>7,887</u>
Tax Assessor's Chart, Block & Lot Chart# Block# Lot# <u>BOOK 2513 PAGE 403</u> <u>221</u>	Applicant * must be owner, Lessee or Buyer* Name <u>LISA CARVER</u> Address <u>13 CHAPMAN ST.</u> City, State & Zip <u>PORTLAND, ME 04103</u>	Telephone: <u>207.415.3203</u>
Lessee/DBA (If Applicable)	Owner (if different from Applicant) Name <u>SAME AS ABOVE</u> Address City, State & Zip	Cost Of Work: \$ <u>2,000.00</u> C of O Fee: \$ _____ Total Fee: \$ <u>2,000.00</u>
Current legal use (i.e. single family) <u>Single family</u> If vacant, what was the previous use? _____ Proposed Specific use: _____ Is property part of a subdivision? <u>NO</u> If yes, please name _____ Project description: <u>EXTERIOR DECK</u>		
Contractor's name: <u>NORTHERN CONSTRUCTION SERVICES - ANTHONY MASTROLICA</u> Address: <u>47 ANTOINE RD</u> City, State & Zip <u>WINDHAM, ME 04092</u> Telephone: <u>207.749.8341</u> Who should we contact when the permit is ready: <u>LISA CARVER</u> Telephone: <u>207.415.3203</u> Mailing address: <u>13 CHAPMAN ST PORTLAND, ME 04103</u>		

Please submit all of the information outlined on the applicable Checklist. Failure to do so will result in the automatic denial of your permit.

In order to be sure the City fully understands the full scope of the project, the Planning and Development Department may request additional information prior to the issuance of a permit. For further information or to download copies of this form and other applications visit the Inspections Division on-line at www.portlandmaine.gov, or stop by the Inspections Division office, room 315 City Hall or call 874-8703.

I hereby certify that I am the Owner of record of the named property, or that the owner of record authorizes the proposed work and that I have been authorized by the owner to make this application as his/her authorized agent. I agree to conform to all applicable laws of this jurisdiction. In addition, if a permit for work described in this application is issued, I certify that the Code Official's authorized representative shall have the authority to enter all areas covered by this permit at any reasonable hour to enforce the provisions of the codes applicable to this permit.

Signature: Lisa M. Carver Date: 04.23.09

This is not a permit; you may not commence ANY work until the permit is issue



Permitting By Appointment

As part of Portland's city-wide effort to improve customer service and help streamline doing business within the City, the Inspections Division has developed a new permitting system for qualified properties and for specific construction projects. Under this new program, you may be eligible to receive a building permit on the day you have a scheduled appointment with Inspection staff.

This permitting program applies only to existing one and two family homes not located within a historic district or shore land zone.

Eligible Projects

Please submit a complete application with the required plans

- Interior renovations, gut rehabs including structural changes
- Attached and detached garages
- Additions, decks, sheds, pools, dormers
- Rebuild of any exterior structure listed above

Inspections are still required per City Code of Ordinance.

In order to be sure the City fully understands the full scope of the project, the Planning and Development Department may request additional information prior to the issuance of a permit. For further information visit us on-line at www.portlandmaine.gov, stop by the Building Inspections office, room 315 City Hall or call 874-8703.

I hereby certify that this project meets the above criteria and that the work performed will not go beyond these parameters.

Signature of applicant: <i>Risa Dunbar</i>	Date: <i>04.23.09</i>
--	-----------------------

This is not a permit; you may not commence ANY work until the permit is issued.



Residential Additions/Alterations Permit Application Checklist

All of the following information is required and must be submitted. Checking off each item as you prepare your application package will ensure your package is complete and will help to expedite the permitting process.

The Maine Home Construction Contracts Act requires that any home construction or repair work for more than \$3000. in materials or labor must be based on a written contract unless the parties agree to exempt themselves. A sample contract is available on the City's website at www.portlandmaine.gov, in the Inspection Office, Room 315 of Portland City Hall or call (207)874-8703 to have one mailed to you.

One (1) complete set of construction drawings must include:

- Cross sections w/framing details
- Floor plans and elevations existing & proposed
- Detail removal of all partitions & any new structural beams
- Detail any new walls or permanent partitions
- Stair details including dimensions of: rise/run, head room, guards/handrails, baluster spacing
- Window and door schedules
- Foundation plans w/required drainage and damp proofing (if applicable)
- Detail egress requirements and fire separation/sound transmission ratings (if applicable)
- Insulation R-factors of walls, ceilings & floors & U-factors of windows per the IEEC 2003
- Deck construction including: pier layout, framing, fastenings, guards, stair dimensions
- Reduced plans or electronic files in pdf format are required if originals are larger than 11" x 17"
- Proof of ownership is required if it is inconsistent with the assessors records

Separate permits are required for internal & external plumbing, HVAC, and electrical installations.

If there are any additions to the footprint or volume of the structure, any new or rebuilt structures or, accessory detached structures a plot plan is required. A plot must include:

- The shape and dimension of the lot, footprint of the existing and proposed structure and the distance from the actual property lines. Structures include decks, porches; bow windows, cantilever sections and roof overhangs, sheds, pools, garages and any other accessory structures must be shown with dimensions if not to scale.
- Location and dimensions of parking areas and driveways
- A change of use may require a site plan exemption application to be filed.

Please submit all of the information outlined in this application checklist. If the application is incomplete, the application may be refused.

In order to be sure the City fully understands the full scope of the project, the Planning and Development Department may request additional information prior to the issuance of a permit. For further information visit us on-line at www.portlandmaine.gov, stop by the Building Inspections office, room 315 City Hall or call 874-8703.

Permit Fee: \$30.00 for the first \$1000.00 construction cost, \$10.00 per additional \$1000.00 cost
This is not a Permit; you may not commence any work until the Permit is issued.

35% max coverage

R-3 Zone

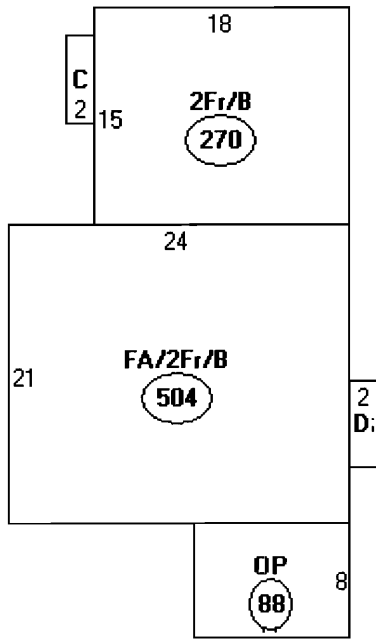

Descriptor/Area

- A: FA/2Fr/B
504 sqft
- B: 2Fr/B
270 sqft
- C: FBAY
12 sqft
- D: FBAY
12 sqft
- E: OP
88 sqft

SETBACKS - Front 25' - NA
 Rear 25' - 25'
 Sides 8' / 15'

886

7987 TOTAL

1170 new

1205 sqft new -

1302 new



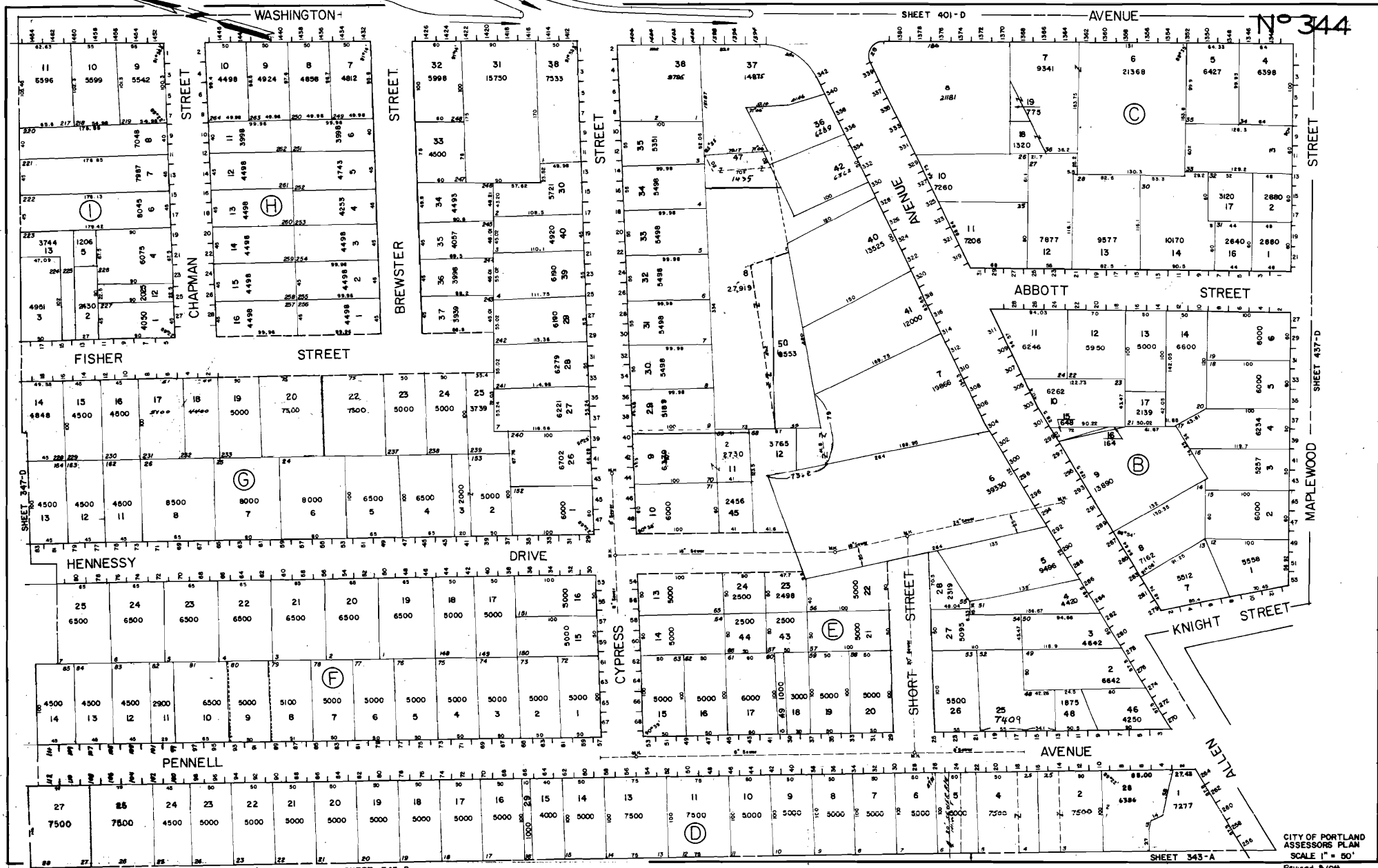

CITY OF PORTLAND
 ASSESSOR'S PLAN
 SCALE 1" = 50'
 Revised 5/24

This data is provided by the Assessor's Office and is current as of **Apr. 8, 2009**

Fees

CBL	<input type="text" value="344 1007001"/>	Acct No	<input type="text" value="36706"/>	Property Address	<input type="text" value="13 CHAPMAN ST"/>	Vie
Owner Name 1	<input type="text" value="CARVER LISA M"/>			Property Type	<input type="text" value="RESIDENTIAL"/>	Dist#: <input type="text" value="5"/>
Name 2	<input type="text"/>			Description	<input type="text" value="344-I-7"/>	
Mailing Address	<input type="text" value="1 FIELDSTONE CT"/>			Census Tract	<input type="text" value="21.01"/>	
City, State, Zip	<input type="text" value="PORTLAND"/>	<input type="text" value="ME"/>	<input type="text" value="04103"/>		<input type="text" value="7987 SF"/>	

Land Use	<input type="text" value="SINGLE FAMILY"/>		Nbr of Units	<input type="text" value="1"/>	Click Here to View: Picture Sketch			
Zone	<input type="text" value="R3"/>		Neighborhood	<input type="text"/>				
District	<input type="text" value="NORTH DEERING"/>		Historic District	<input type="text" value="No"/>				
Yr Built	<input type="text" value="1925"/>	House Style	<input type="text" value="OLD STYLE"/>					
Total Rms	<input type="text" value="6"/>	Baths	<input type="text" value="1"/>	1/2 Baths	<input type="text" value="0"/>	Bedrms	<input type="text" value="3"/>	NOTES
Heat Type	<input type="text" value="BASIC"/>		Basement	<input type="text" value="FULL"/>				
Fuel Type	<input type="text" value="OIL"/>		Attic	<input type="text" value="PART FINSH"/>				
System Type	<input type="text" value="WARM AIR"/>							

172 Route One
Falmouth, Maine
04105

SIMPLY
HOME



www.simplyhomepage.com
207.781.5651 tel
207.781.5653 fax
info@simplyhomepage.com

FAX

To: Jeannie Bourke
Fax#: 879.8716

Date: 04.30.09
From: Lisa Carver
Total # of pages: 4

Comments:

THANKS FOR MY APPT ON TUES 5/5
AT 1 PM.

CONTACT INFO

EMAIL: LISA@SIMPLYHOMEPAGE.COM
CELL# 415.3203

THANK YOU!

CONFIDENTIALITY NOTICE AND DISCLAIMER

The information in this transmission may be confidential and/or protected by legal professional privilege, and is intended only for the person or persons to whom it is addressed. If you are not such a person, you are warned that any disclosure, copying or dissemination of the information is unauthorized. If you have received the transmission in error, please immediately contact this office by telephone, fax or email, to inform us of the error and to enable arrangements to be made for the destruction of the transmission, or its return at our cost. No liability is accepted for any unauthorized use of the information contained in this transmission.

LISA M. CARVER
13 CHAPMAN ST.
PORTLAND, ME 04103
207.415.3203

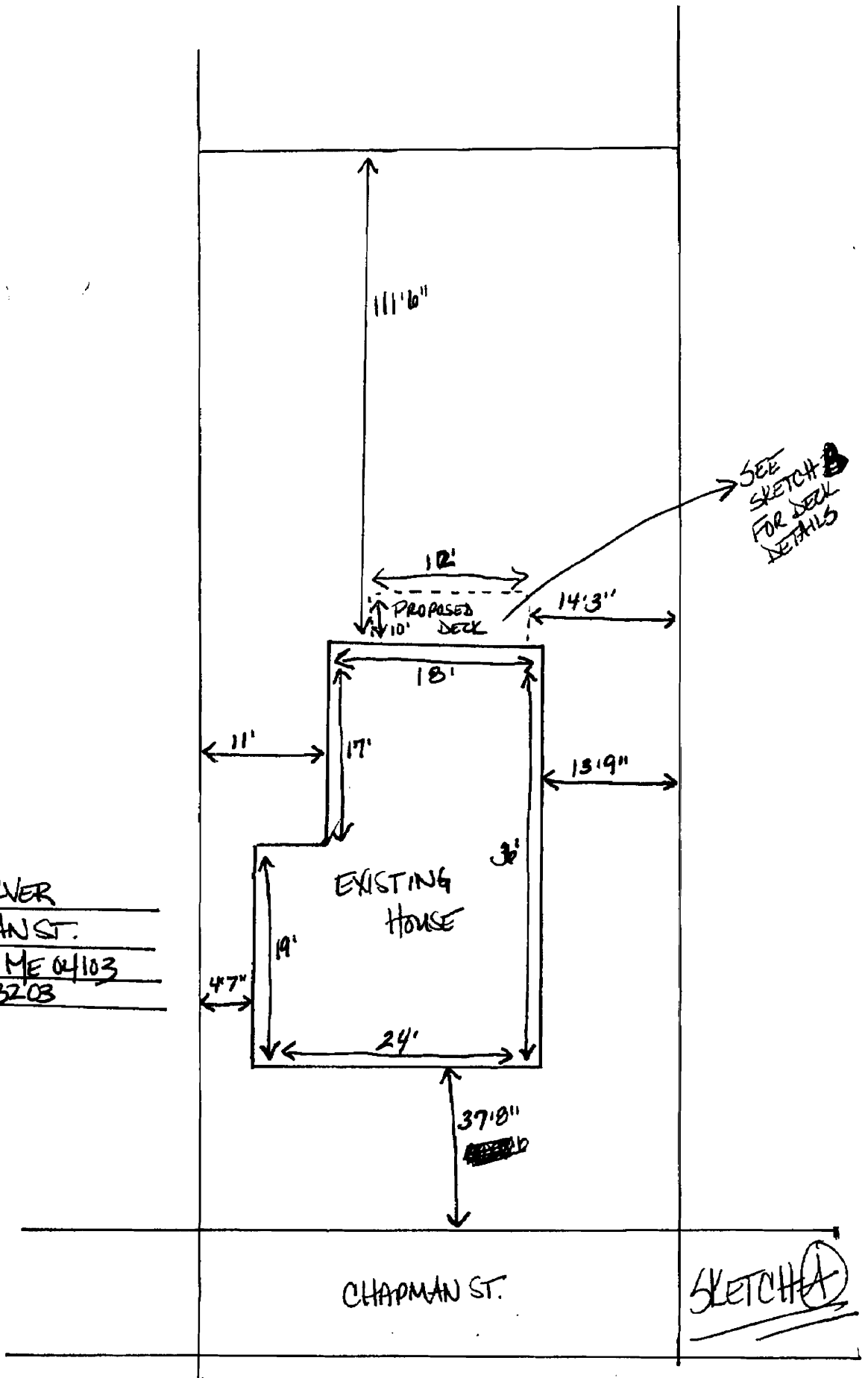

BUILDING PERMIT INSPECTION PROCEDURES

Please call 874-8703 or 874-8693 (ONLY)

to schedule your inspections as agreed upon

Permits expire in 6 months, if the project is not started or ceases for 6 months.

The Owner or their designee is required to notify the inspections office for the following inspections and provide adequate notice. Notice must be called in 48-72 hours in advance in order to schedule an inspection:

By initializing at each inspection time, you are agreeing that you understand the inspection procedure and additional fees from a "Stop Work Order" and "Stop Work Order Release" will be incurred if the procedure is not followed as stated below.

A Pre-construction Meeting will take place upon receipt of your building permit.

Footing/Building Location Inspection: Prior to pouring concrete or setting precast piers

Final inspection required at completion of work.

Certificate of Occupancy is not required for certain projects. Your inspector can advise you if your project requires a Certificate of Occupancy. All projects DO require a final inspection.

If any of the inspections do not occur, the project cannot go on to the next phase, REGARDLESS OF THE NOTICE OR CIRCUMSTANCES.

CERIFICATE OF OCCUPANICES MUST BE ISSUED AND PAID FOR, BEFORE THE SPACE MAY BE OCCUPIED.

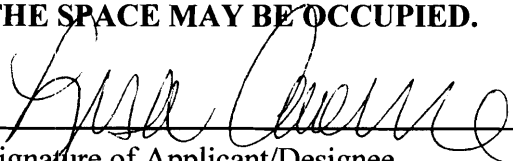

Signature of Applicant/Designee



Date

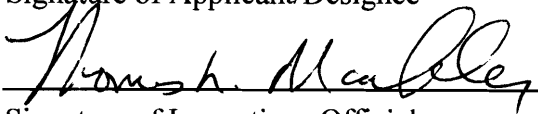

Signature of Inspections Official

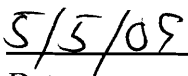

Date