

DISPLAY THIS CARD ON PRINCIPAL FRONTAGE OF WORK



# CITY OF PORTLAND

# BUILDING PERMIT

This is to certify that ERIC MARTIN

Located At 14 CHAPMAN ST

Job ID: 2012-09-4920-ALTR

CBL: 344-H-011-001

has permission to replace 1 flu chimney to 2 flu  
provided that the person or persons, firm or corporation accepting this permit shall comply with all of the provisions of the Statues of Maine and of the Ordinances of the City of Portland regulating the construction, maintenance and use of the buildings and structures, and of the application on file in the department.

Notification of inspection and written permission procured before this building or part thereof is lathed or otherwise closed-in. 48 HOUR NOTICE IS REQUIRED.

A final inspection must be completed by owner before this building or part thereof is occupied. If a certificate of occupancy is required, it must be

\_\_\_\_\_  
**Fire Prevention Officer**

A handwritten signature in black ink, appearing to be "J. J. [unclear]".

\_\_\_\_\_  
**Code Enforcement Officer / Plan Reviewer**

**THIS CARD MUST BE POSTED ON THE STREET SIDE OF THE PROPERTY  
PENALTY FOR REMOVING THIS CARD**

**SCANNED**

**WITHDRAW**

## BUILDING PERMIT INSPECTION PROCEDURES

Please call 874-8703 or 874-8693 (ONLY)

or email: [buildinginspections@portlandmaine.gov](mailto:buildinginspections@portlandmaine.gov)

With the issuance of this permit, the owner, builder or their designee is required to provide adequate notice to the city of Portland Inspections Services for the following inspections. Appointments must be requested 48 to 72 hours in advance of the required inspection. The inspection date will need to be confirmed by this office.

- **Please read the conditions of approval that is attached to this permit!! Contact this office if you have any questions.**
- **Permits expire in 6 months. If the project is not started or ceases for 6 months.**
- **If the inspection requirements are not followed as stated below additional fees may be incurred due to the issuance of a "Stop Work Order" and subsequent release to continue.**

Footings/Setbacks prior to pouring concrete

Close In Elec/Plmb/Frame prior to insulate or gyp

Final Inspection

The project cannot move to the next phase prior to the required inspection and approval to continue, REGARDLESS OF THE NOTICE OF CIRCUMSTANCES.

IF THE PERMIT REQUIRES A CERTIFICATE OF OCCUPANCY, IT MUST BE PAID FOR AND ISSUED TO THE OWNER OR DESIGNEE BEFORE THE SPACE MAY BE OCCUPIED.



# PORTLAND MAINE

*Strengthening a Remarkable City, Building a Community for Life • [www.portlandmaine.gov](http://www.portlandmaine.gov)*

Director of Planning and Urban Development  
Jeff Levine

Job ID: 2012-09-4920-ALTR

Located At: 14 CHAPMAN ST

CBL: 344- H-011-001

## **Conditions of Approval:**

### **Fire**

Installation shall comply with City Code Chapter 10.

Installation shall comply with NFPA 211, *Standard for Chimneys, Fireplaces, Vents, and Solid Fuel-Burning Appliances*;

**City of Portland, Maine - Building or Use Permit Application**

389 Congress Street, 04101 Tel: (207) 874-8703, FAX: (207) 8716

Job No: <b>2012-09-4920-ALTR</b>	Date Applied: <b>9/10/2012</b>	CBL: <b>344- H-011-001</b>	
Location of Construction: <b>14 CHAPMAN ST</b>	Owner Name: <b>ERIC MARTIN</b>	Owner Address: <b>14 CHAPMAN ST PORTLAND, ME 04103</b>	Phone: <b>797-3434</b>
Business Name:	Contractor Name: <b>Randall A. Wells</b>	Contractor Address: <b>736 Lower Street, Turner, ME 04282</b>	Phone: <b>225-3872</b>
Lessee/Buyer's Name:	Phone:	Permit Type: <b>BLDG ALT</b>	Zone: <b>R-3</b>
Past Use:  <b>Single Family Dwelling</b>	Proposed Use:  <b>Same: Single Family Dwelling - to replace and enlarge a 1 flue chimney to 2 flues</b>	Cost of Work: <b>1000.000000</b>	CEO District:
		Fire Dept: <input checked="" type="checkbox"/> Approved <input type="checkbox"/> Denied <input type="checkbox"/> N/A	Inspection: Use Group: <b>R-3</b> Type: <b>ILCOS</b>
Proposed Project Description: <b>replace 1 flue chimney to 2 flue</b>		Pedestrian Activities District (P.A.D.)	
Permit Taken By: <b>Gayle</b>		<b>Zoning Approval</b>	

WITHDRAW

1. This permit application does not preclude the Applicant(s) from meeting applicable State and Federal Rules.
2. Building Permits do not include plumbing, septic or electrical work.
3. Building permits are void if work is not started within six (6) months of the date of issuance. False informatin may invalidate a building permit and stop all work.

SCANNED

<b>Special Zone or Reviews</b> <input type="checkbox"/> Shoreland <input type="checkbox"/> Wetlands <input type="checkbox"/> Flood Zone <input type="checkbox"/> Subdivision <input type="checkbox"/> Site Plan <input type="checkbox"/> Maj <input type="checkbox"/> Min <input type="checkbox"/> MM Date: <b>9/11/12</b>	<b>Zoning Appeal</b> <input type="checkbox"/> Variance <input type="checkbox"/> Miscellaneous <input type="checkbox"/> Conditional Use <input type="checkbox"/> Interpretation <input checked="" type="checkbox"/> Approved <input type="checkbox"/> Denied Date:	<b>Historic Preservation</b> <input checked="" type="checkbox"/> Not in Dist or Landmark <input type="checkbox"/> Does not Require Review <input type="checkbox"/> Requires Review <input type="checkbox"/> Approved <input type="checkbox"/> Approved w/Conditions <input type="checkbox"/> Denied Date:
---	--	--

**CERTIFICATION**

I hereby certify that I am the owner of record of the named property, or that the proposed work is authorized by the owner of record and that I have been authorized by the owner to make this application as his authorized agent and I agree to conform to all applicable laws of this jurisdiction. In addition, if a permit for work described in the application is issued, I certify that the code official's authorized representative shall have the authority to enter all areas covered by such permit at any reasonable hour to enforce the provision of the code(s) applicable to such permit.

SIGNATURE OF APPLICANT ADDRESS DATE PHONE

RESPONSIBLE PERSON IN CHARGE OF WORK, TITLE DATE PHONE

2012 09 4920

60



# General Building Permit Application

If you or the property owner owes real estate or personal property taxes or user charges on any property within the City, payment arrangements must be made before permits of any kind are accepted.

R-3

Location/Address of Construction: <u>14 Chapman St</u>		
Total Square Footage of Proposed Structure/Area <u>1435</u>	Square Footage of Lot <u>8495</u>	Number of Stories <u>2</u>
Tax Assessor's Chart, Block & Lot Chart# <u>344</u> Block# <u>H011001</u> Lot# <u>(344-H-11-12)</u>	Applicant: (must be owner, lessee or buyer) Name <u>Eric Martin</u> Address <u>14 Chapman St</u> City, State & Zip <u>Portland ME 04103</u>	Telephone: <u>207-797-3434</u>
Lessee/DBA <b>RECEIVED</b>  <b>SEP 10 2012</b>  Dept. of Building Inspections City of Portland Maine	Owner: (if different from applicant) Name Address City, State & Zip	Cost of Work: \$ <u>1000</u> C of O Fee: \$ _____ Historic Review: \$ _____ Planning Amin.: \$ _____ Total Fee: \$ <u>1000</u>
Current legal use (i.e. single family) <u>Single Family</u> Number of Residential Units <u>1</u> If vacant, what was the previous use? _____ Proposed Specific use: _____ Is property part of a subdivision? <u>No</u> If yes, please name _____ Project description: <u>Replace 1 flu chimney with 2 flues</u>		
Contractor's name: <u>Randall A. Wells</u> Email: _____ Address: <u>736 Lower St</u> City, State & Zip: <u>Port Turner ME 04282</u> Telephone: <u>225-3879</u>		Who should we contact when the permit is ready: <u>Eric Martin</u> Telephone: <u>797-3434</u>
Mailing address: <u>14 Chapman St Portland ME 04103</u>		

**Please submit all of the information outlined on the applicable checklist. Failure to do so will result in the automatic denial of your permit.**

In order to be sure the City fully understands the full scope of the project, the Planning and Development Department may request additional information prior to the issuance of a permit. For further information or to download copies of this form and other applications visit the Inspections Division on-line at [www.portlandmaine.gov](http://www.portlandmaine.gov), or stop by the Inspections Division office, room 315 City Hall or call 874-8703.

and I hereby certify that I am the Owner of record of the named property, or that the owner of record authorizes the proposed work and that I have been authorized by the owner to make this application as his/her authorized agent. I agree to conform to all applicable laws of this jurisdiction. In addition, if a permit for work described in this application is issued, I certify that the Code Official's authorized representative shall have the authority to enter all areas covered by this permit at any reasonable hour to enforce the provisions of the codes applicable to this permit.

Signature: \_\_\_\_\_ Date: \_\_\_\_\_

**This is not a permit; you may not commence ANY work until the permit is issued**

# Current Chimney

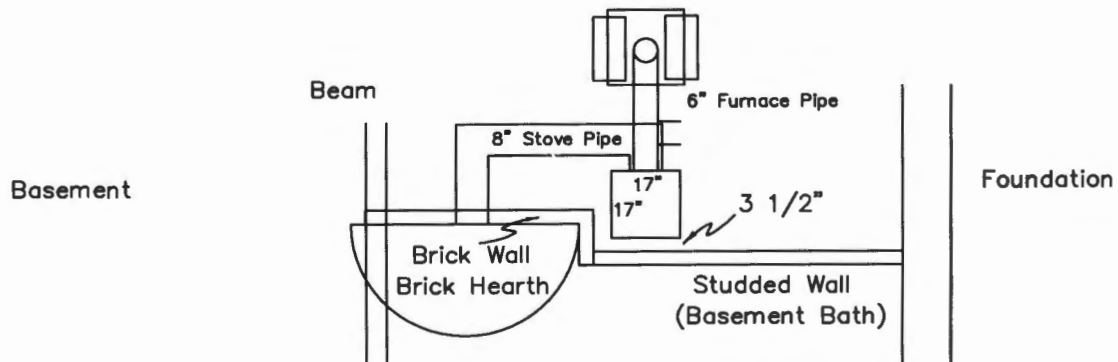
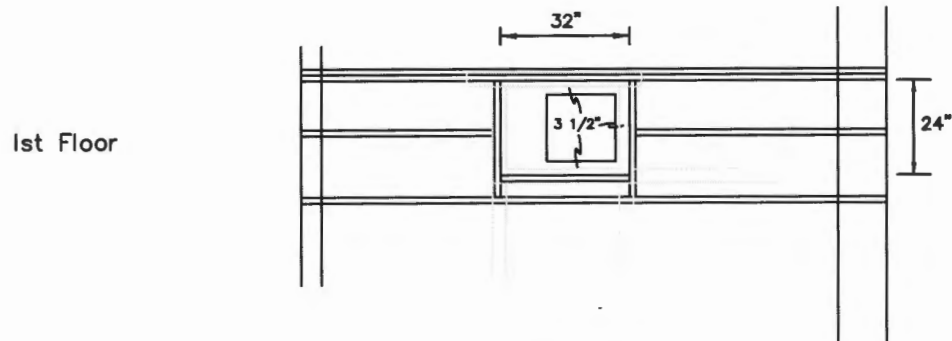
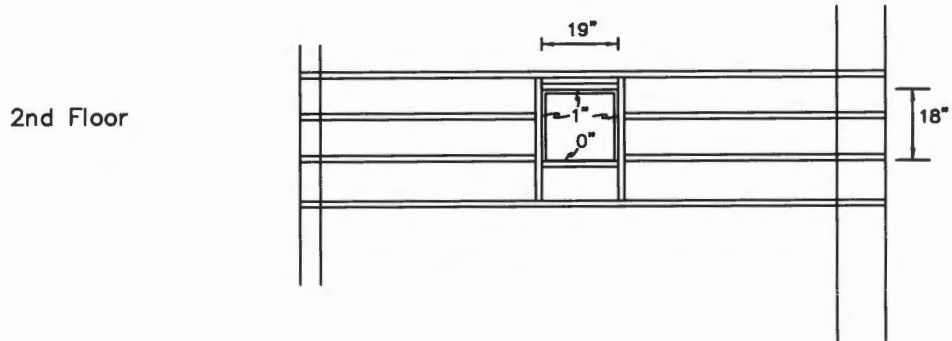
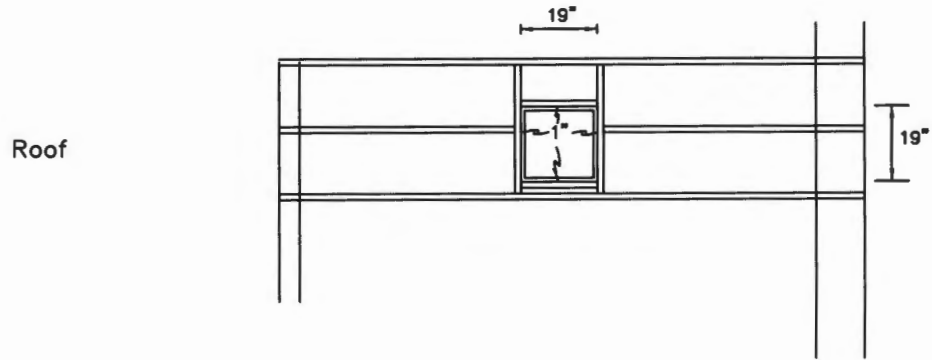

# Proposed Chimney

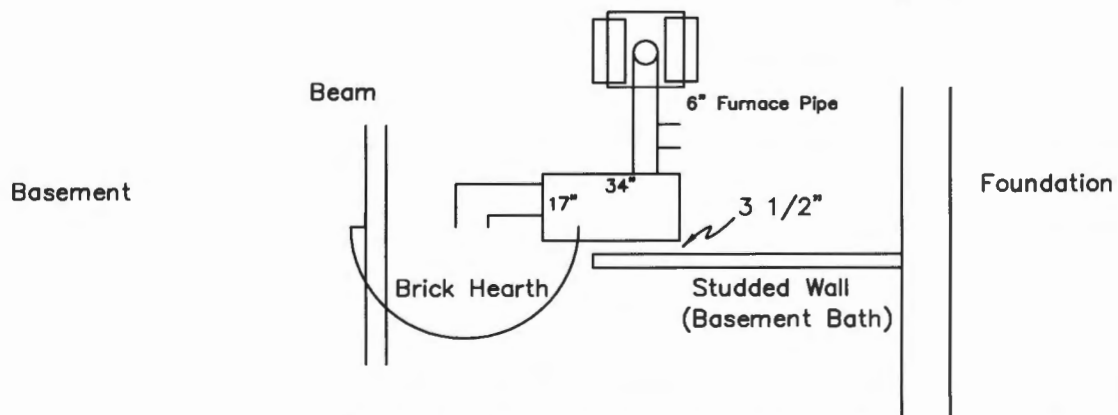
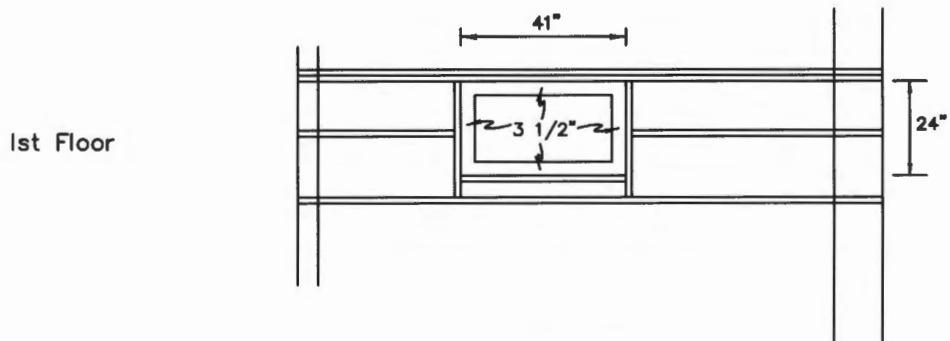
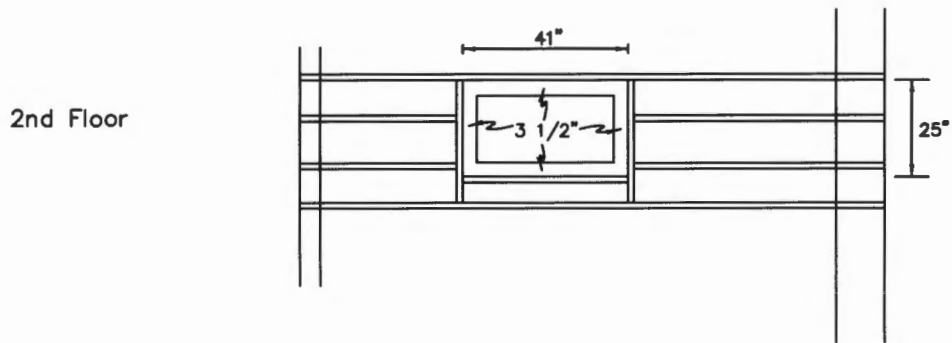
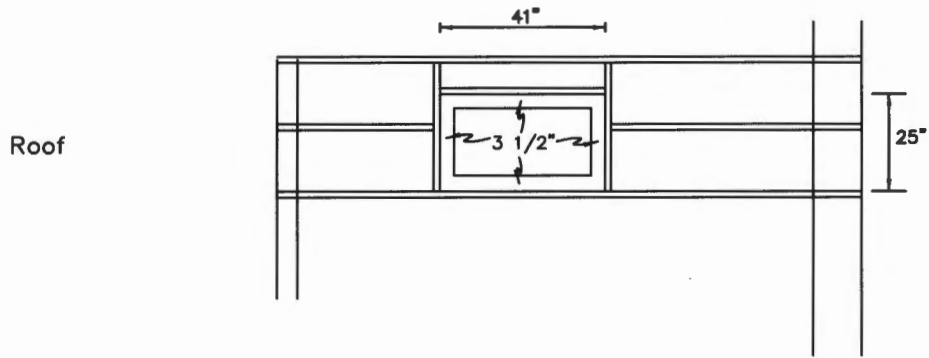



# PORTLAND MAINE

*Strengthening a Remarkable City, Building a Community for Life • [www.portlandmaine.gov](http://www.portlandmaine.gov)*

## Receipts Details:

**Tender Information:** Check , BusinessName: Visa, Check Number: 7471  
**Tender Amount:** 30.00

## Receipt Header:

**Cashier Id:** gguertin  
**Receipt Date:** 9/10/2012  
**Receipt Number:** 48033

## Receipt Details:

Referance ID:	7950	Fee Type:	BP-Constr
Receipt Number:	0	Payment Date:	
Transaction Amount:	30.00	Charge Amount:	30.00
Job ID: Job ID: 2012-09-4920-ALTR - replace 1 flu chimney to 2 flu			
Additional Comments: 14 Chapman St., Eric Martin			

**Thank You for your Payment!**



**Eric & Jeremy Cole Martin**  
14 Chapman Street  
Portland, Maine 04103  
tel: (207) 797-3434

October 21, 2012

Office of Planning  
City of Portland  
874-8703

**WITHDRAW**

Re: Job ID 2012-09-4920-ALTR  
CBL: 344-H-011-001

Dear Plan Reviewer/ Code Enforcement Officer,

*Withdraw*

Thank you for granting us a permit for rebuilding our chimney from one flu to two, as per the above Job and CBL identifiers. We are quite grateful. However, as so often occurs in life, a variety of events have conspired to prevent us from doing this work at this time. The permit expires before we will be able to do the work, and so we will re-apply in Spring of 2013.

I am writing because another permit request is going to cross your desk for this same property, and I hope to avert confusion. We have a contractor, Mark Moran, who is submitting an application for a permit to install a 15 foot shed dormer. We are seeking to create a third bedroom for the grandchildren (a one year old, and another on the way). That work, I hope, would be done before we are socked in with the truly cold weather. In other words, he says he is ready to move on this as soon as it is approved.

In summary, I am not sure how all this works on your end of things. But I was concerned that it might be odd receiving a request for further work on a property that had an as yet unacted upon permit outstanding. Please call if you have any questions or e-mail me at [colelcsw@gmail.com](mailto:colelcsw@gmail.com). Thank you for your attention.

Sincerely,

*Jeremy Cole Martin*  
(Ms) Jeremy Cole Martin

RECEIVED  
OCT 24 2012  
Dept. of Building Inspections  
City of Portland