

DRAWINGS/SPECIFICATIONS BY:

<input type="checkbox"/>	WALGREENS'
<input checked="" type="checkbox"/>	LANDLORD'S CONSULTANT

ALL CONSTRUCTION WORK, UNLESS NOTED OTHERWISE, BY:

<input type="checkbox"/>	WALGREENS' CONTRACTOR
<input checked="" type="checkbox"/>	LANDLORD'S CONTRACTOR (TURNKEY CONSTRUCTION)

STORE	BUILDING
NEW . . . . . <input checked="" type="checkbox"/>	NEW . . . . . <input checked="" type="checkbox"/>
REMODELING . . . . . <input type="checkbox"/>	EXISTING . . . . . <input type="checkbox"/>
RELOCATION . . . . . <input type="checkbox"/>	NEW SHELL ONLY . . . . . <input type="checkbox"/>
OTHERS . . . . . <input type="checkbox"/>	

**DESIGN CRITERIA**

- INITIAL DIAL TONE ORDER: 7 TO 9 BUSINESS LINES PLUS A 4-WIRE FRAME RELAY OR DSL CIRCUIT. ORDERS TO BE PLACED 45 DAYS BEFORE FIXTURE DATE BY WALGREENS TELECOMMUNICATIONS DEPARTMENT - INITIAL PAIR COUNT = 9 TO 11 PAIR.
- FUTURE LINE GROWTH: 4 TO 6 ADDITIONAL LINES DEPENDING ON GROWTH OF STORE VOLUME - FUTURE PAIR GROWTH = 4 TO 6 PAIR.
- TOTAL PAIR REQUIREMENTS WITHIN 3 YEARS = 13 TO 17 PAIR.

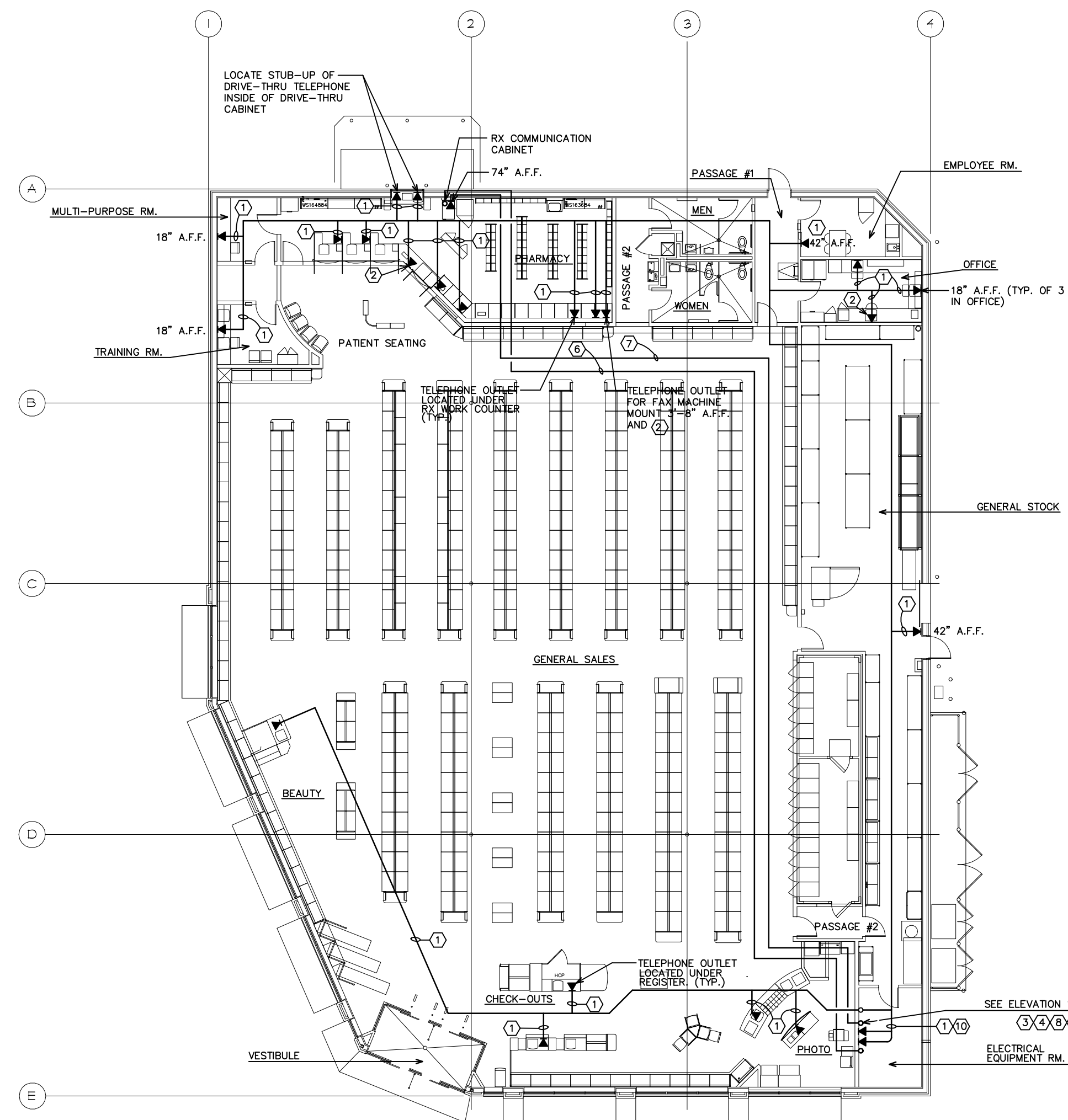

**FLOOR PLAN - TELEPHONE SYSTEM**  
 SCALE: 1/16" = 1'-0"

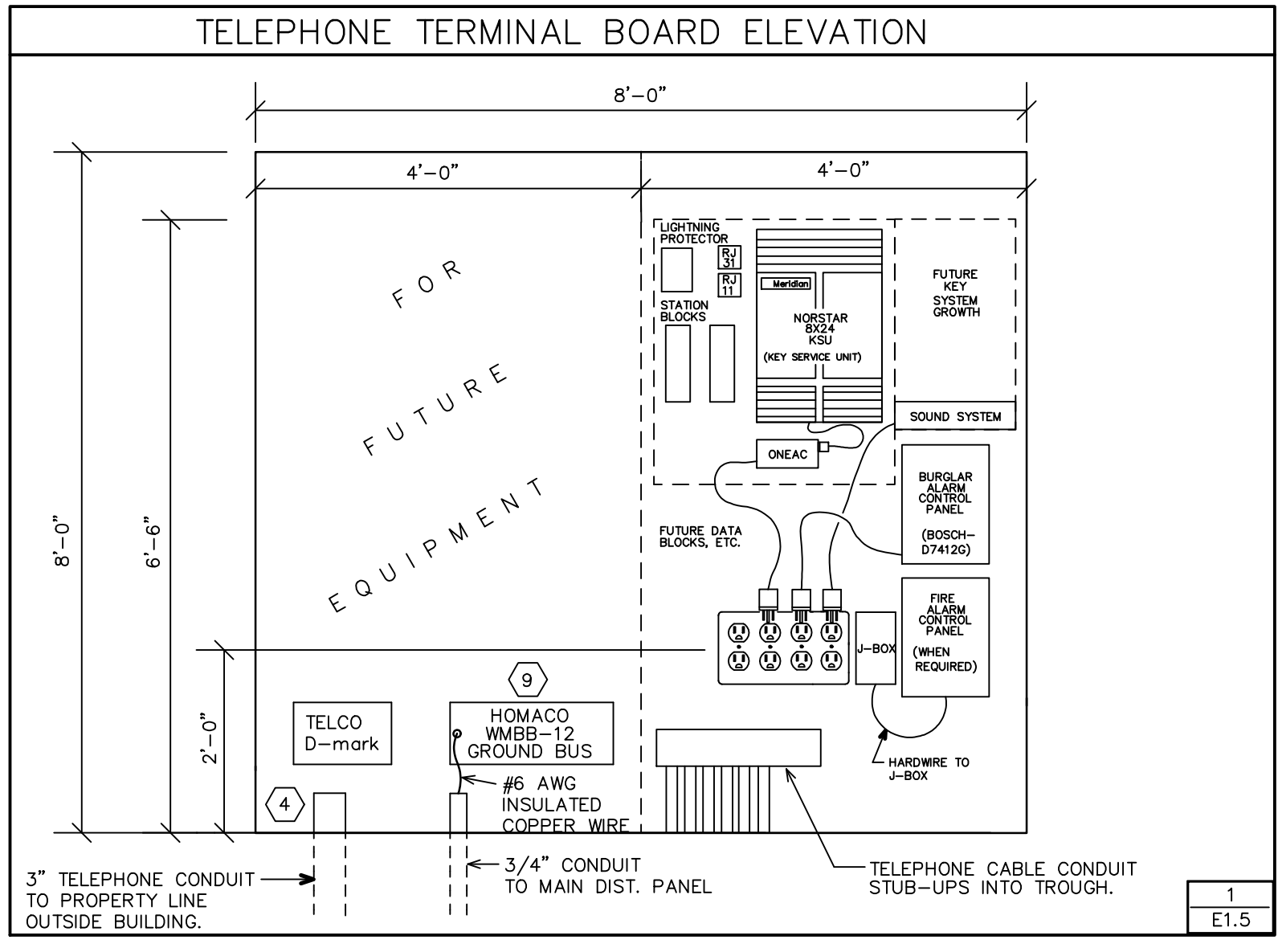

**LEGEND**

	TELEPHONE OUTLET
	JUNCTION BOX IN NEAREST WALL
	JUNCTION BOX UNDERNEATH FIXTURE

**TELEPHONE SYSTEM NOTES**

- THE GENERAL CONTRACTOR/DEVELOPER SHALL COORDINATE THE INSTALLATION OF TELEPHONE CABLE (25 PAIR MINIMUM) TO TELEPHONE BOARD. GENERAL CONTRACTOR SHALL PLACE ORDER WITH THE DOMINANT CARRIER IN THE MARKET (WEST, BELL SOUTH, SBC, VERIZON AND SPRINT) AT LEAST 90 DAYS IN ADVANCE OF FIXTURE DATE. **DO NOT PLACE ORDERS WITH A COMPETITIVE LOCAL EXCHANGE CARRIER (CLEC) AS THIS WILL DELAY COPPER CABLE INSTALLATIONS.** IF THE TELEPHONE COMPANY SUGGESTS TWO (2) SIX-PAIR CABLES OR SEEMS RELUCTANT TO PROCEED WITH THE ORDER IN A TIMELY MANNER, CONTACT WALGREEN'S TELECOMMUNICATIONS DEPARTMENT (847-914-8067), AS SOON AS POSSIBLE.
  - ALL WORK SHOWN SHALL COMPLY WITH ALL NATIONAL, STATE AND LOCAL CODES, ORDINANCES, ETC.
  - TELEPHONE WIRING TO BE FURNISHED AND INSTALLED BY WALGREEN'S CONTRACTOR. CONDUIT AND #12 PULL STRING IS FURNISHED AND INSTALLED BY LANDLORD'S CONTRACTOR.
  - NOT USED
  - TELEPHONE CABLES SHALL NOT BE PLACED OR ROUTED OVER FLUORESCENT FIXTURES OR BALLASTS.
  - NO EXPOSED TELEPHONE CABLES ARE PERMITTED IN THE SALES AREA.
- 3/4" CONDUIT SHALL BE PROVIDED AS REQUIRED PER NOTES AND/OR STATE AND LOCAL CODES.
  - TELEPHONE POWER FAILURE JACKS ARE TELEPHONE OUTLETS WHICH BYPASS THE NORSTAR SYSTEM AND ARE USED DURING ELECTRICAL POWER INTERRUPTIONS. THE TELEPHONE POWER FAILURE JACKS ARE WIRING DIRECTLY TO THE STATION BLOCKS. TELEPHONE POWER FAILURE JACKS ARE LOCATED IN THE PHARMACY AND THE OFFICE.
  - THE LANDLORD'S CONTRACTOR SHALL FURNISH AND INSTALL A 8' X 8', 3/4" A-C GRADE PLYWOOD (TREATED PER CODE) FOR TELEPHONE BOARD MOUNTING.
  - THE LANDLORD'S CONTRACTOR SHALL FURNISH AND INSTALL A 3" CONDUIT FROM THE PROPERTY LINE, OUTSIDE THE BUILDING, AND TERMINATE AT THE TELEPHONE TERMINAL BOARD.
  - NOT USED
  - CABLE LABELED (C) CATEGORY 3 (25 PAIR) FURNISHED AND INSTALLED BY WALGREEN'S CONTRACTOR. FROM RX COMMUNICATION CABINET TO ELECTRICAL EQUIPMENT ROOM. CONDUIT BY LANDLORD'S CONTRACTOR.
  - LANDLORD'S CONTRACTOR SHALL PROVIDE A 1" CONDUIT FROM THE TELEPHONE TERMINAL BOARD TO THE RX COMMUNICATION CABINET. WALGREEN'S CONTRACTOR SHALL FURNISH AND INSTALL THREE (3) PAIR (MIN.) TELEPHONE CABLE AND AN ADDITIONAL #12 PULL STRING (FOR DTR USE) IN THAT CONDUIT. THE THREE (3) PAIR (MIN.) TELEPHONE CABLE WILL BE TERMINATED BY A DTR (DATA TERMINAL REPAIR) TECHNICIAN AT THE TELEPHONE TERMINAL BOARD.
  - UTILITY SERVICE ENTRANCE LOCATION (COORDINATE WITH UTILITY SITE PLAN).
  - ELECTRICAL CONTRACTOR TO FURNISH AND INSTALL "HOMACO" WMBB-12 GROUND BUS. [CALL ANIXTER @ (847) 390-4530].
  - TWO (2) TELEPHONE LINES FOR THE FIRE ALARM SYSTEM (IF REQUIRED BY CODE). FIRE ALARM CONTROL PANEL IS LOCATED AT THE TELEPHONE TERMINAL BOARD. SEE DRAWING E1.6 FOR ADDITIONAL INFORMATION.

**TELEPHONE SYSTEM KEYED NOTES**

- 3/4" CONDUIT SHALL BE PROVIDED AS REQUIRED PER NOTES AND/OR STATE AND LOCAL CODES.
- TELEPHONE POWER FAILURE JACKS ARE TELEPHONE OUTLETS WHICH BYPASS THE NORSTAR SYSTEM AND ARE USED DURING ELECTRICAL POWER INTERRUPTIONS. THE TELEPHONE POWER FAILURE JACKS ARE WIRING DIRECTLY TO THE STATION BLOCKS. TELEPHONE POWER FAILURE JACKS ARE LOCATED IN THE PHARMACY AND THE OFFICE.
- THE LANDLORD'S CONTRACTOR SHALL FURNISH AND INSTALL A 8' X 8', 3/4" A-C GRADE PLYWOOD (TREATED PER CODE) FOR TELEPHONE BOARD MOUNTING.
- THE LANDLORD'S CONTRACTOR SHALL FURNISH AND INSTALL A 3" CONDUIT FROM THE PROPERTY LINE, OUTSIDE THE BUILDING, AND TERMINATE AT THE TELEPHONE TERMINAL BOARD.
- NOT USED
- CABLE LABELED (C) CATEGORY 3 (25 PAIR) FURNISHED AND INSTALLED BY WALGREEN'S CONTRACTOR. FROM RX COMMUNICATION CABINET TO ELECTRICAL EQUIPMENT ROOM. CONDUIT BY LANDLORD'S CONTRACTOR.
- LANDLORD'S CONTRACTOR SHALL PROVIDE A 1" CONDUIT FROM THE TELEPHONE TERMINAL BOARD TO THE RX COMMUNICATION CABINET. WALGREEN'S CONTRACTOR SHALL FURNISH AND INSTALL THREE (3) PAIR (MIN.) TELEPHONE CABLE AND AN ADDITIONAL #12 PULL STRING (FOR DTR USE) IN THAT CONDUIT. THE THREE (3) PAIR (MIN.) TELEPHONE CABLE WILL BE TERMINATED BY A DTR (DATA TERMINAL REPAIR) TECHNICIAN AT THE TELEPHONE TERMINAL BOARD.
- UTILITY SERVICE ENTRANCE LOCATION (COORDINATE WITH UTILITY SITE PLAN).
- ELECTRICAL CONTRACTOR TO FURNISH AND INSTALL "HOMACO" WMBB-12 GROUND BUS. [CALL ANIXTER @ (847) 390-4530].
- TWO (2) TELEPHONE LINES FOR THE FIRE ALARM SYSTEM (IF REQUIRED BY CODE). FIRE ALARM CONTROL PANEL IS LOCATED AT THE TELEPHONE TERMINAL BOARD. SEE DRAWING E1.6 FOR ADDITIONAL INFORMATION.

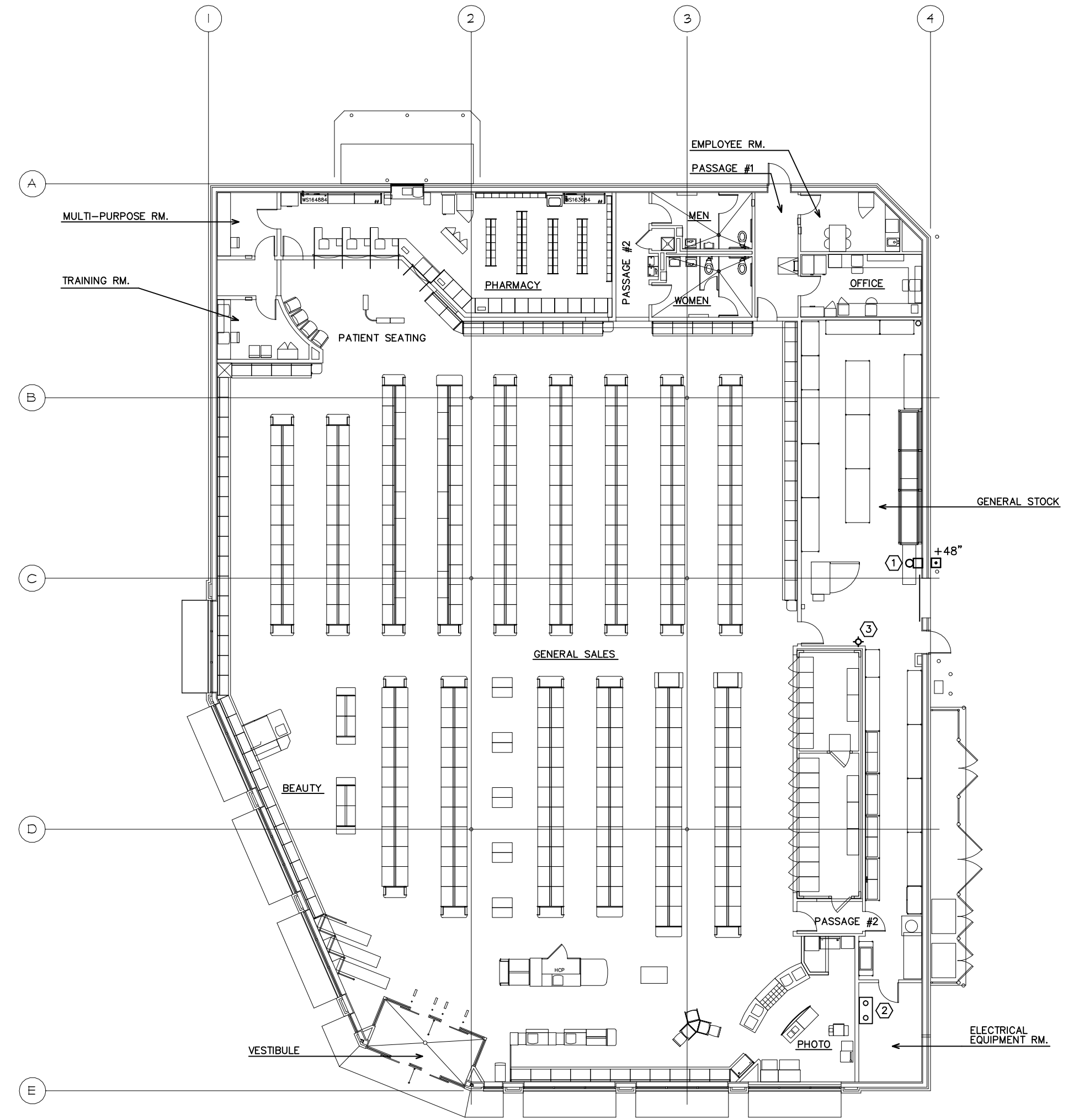

**FLOOR PLAN - SOUND SYSTEM**  
 SCALE: 1/16" = 1'-0"

**SOUND SYSTEM NOTES**

- ALL WORK SHOWN SHALL COMPLY WITH ALL NATIONAL, STATE AND LOCAL CODES, ORDINANCES, ETC.
  - FOR COORDINATION PURPOSES SPEAKER LOCATIONS SHOWN ON REFLECTED CEILING PLAN, DRAWING A1.2.
- SOUND SYSTEM KEYED NOTES**
- LANDLORD'S CONTRACTOR SHALL FURNISH AND INSTALL WEATHER-PROOF PUSHBUTTON (EDWARDS #1785 OR #852) WIRED WITH #18 AWG, ROUTED IN A CONDUIT AND TERMINATED IN A JUNCTION BOX MOUNTED 10'-0" A.F.F., PROVIDE 9'-0" OF CABLE SLACK. MOUNT PUSHBUTTON @ 4'-0" A.F.F. ADJACENT TO ROLL-UP RECEIVING DOOR. FINAL TERMINATION OF INDYME REMOTE RECEIVER BY WALGREEN'S CONTRACTOR/DTR.
  - SOUND SYSTEM RECEIVER, FURNISHED AND INSTALLED BY WALGREENS. SEE DETAIL 1 / E1.5 ABOVE.
  - PROVIDE (2) JUNCTION BOXES, ONE MOUNTED AT 5'-0" A.F.F. (FOR PAGING HORN VOLUME CONTROL, BY WALGREENS) AND THE OTHER JUNCTION BOX MOUNTED AT 9'-0" A.F.F. (FOR PAGING HORN, BY WALGREENS). PROVIDE CONDUIT BETWEEN TWO JUNCTION BOXES FOR CABLE ROUTING MEANS.

**LEGEND**

	PUSHBUTTON
	SOUND SYSTEM (MOUNTED ADJACENT TO TELEPHONE BOARD)
	PAGING HORN (WALL MOUNTED 9'-0" A.F.F.) WITH SEPARATE VOLUME CONTROL UNIT (WALL MOUNTED AT 5'-0" A.F.F.)

NO.	DATE	BY	DESCRIPTION	CONST

**REVISIONS**

**CERTIFICATION AND SEAL**

I HEREBY CERTIFY THAT THIS PLAN AND SPECIFICATION WAS PREPARED BY ME OR UNDER MY DIRECT SUPERVISION AND THAT I AM A DULY REGISTERED ARCHITECT OR ENGINEER UNDER THE LAWS OF THE STATE OF MAINE AS SIGNIFIED BY MY HAND AND SEAL.

**FISCAL 2007 CRITERIA - STORE #12326**

WALGREENS  
 (NWC) WASHINGTON & ALLEN AVES.  
 PORTLAND, MAINE

**TELEPHONE AND SOUND SYSTEM**

CADD PLOT:	SCALE: AS NOTED	DRAWING NO. <b>E1.5</b>
VOID PLOT:	DRAWN BY: TD	
RELEASED TO CONSTRUCTION	DATE: 3-26-09	
	REVIEWED BY: SAM	