

McDonald Maziarz Residence
60 Cypress Street
Portland Maine
Existing First Floor Plan
Scale 3/4" = 1'
BCW 5/21/05

125" 21" 18" 118" 30'

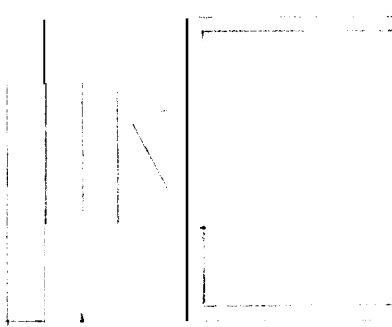
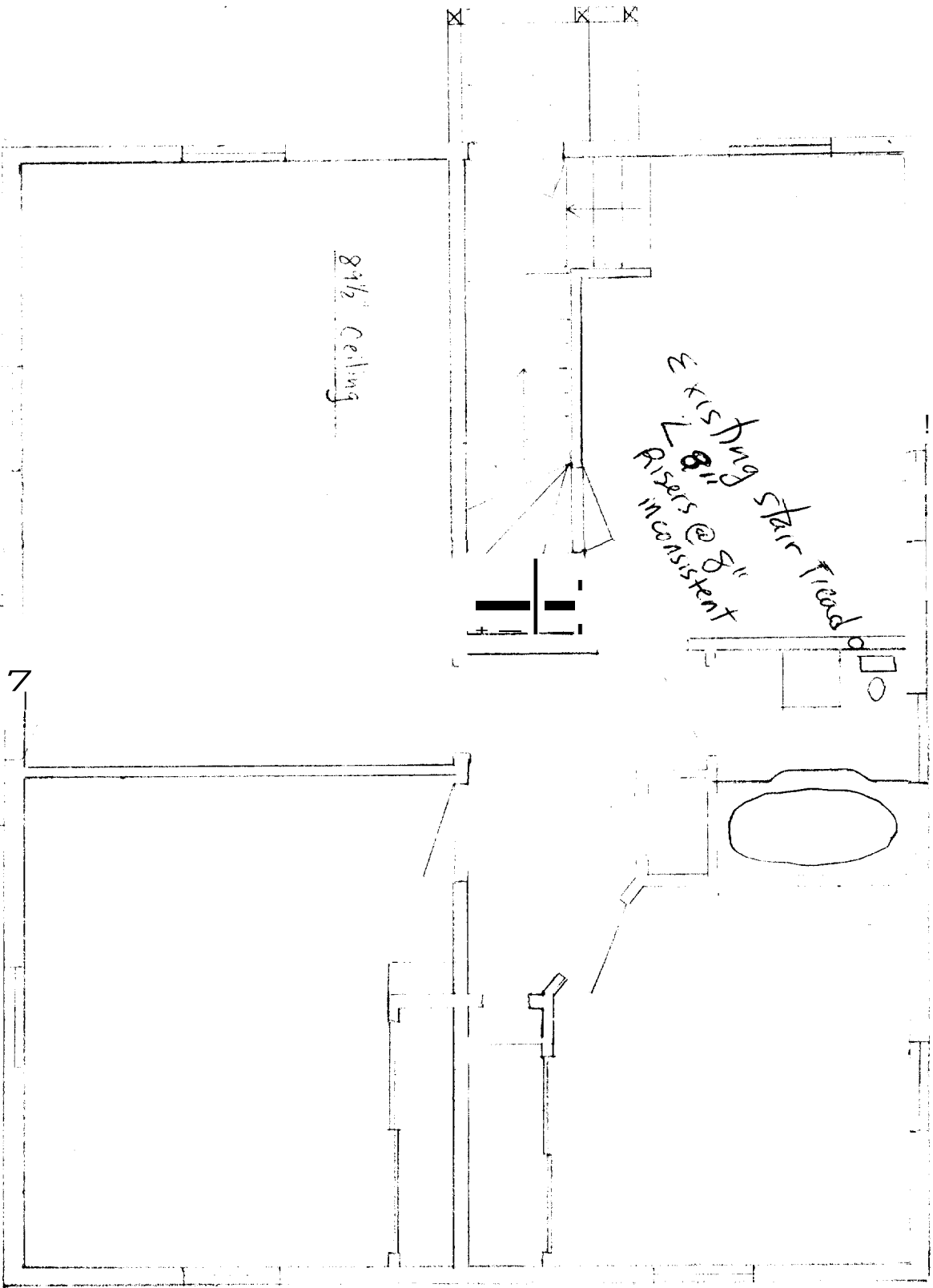

McDonald Maziarz Residence
 60 Cypress Street
 Portland, Maine

Improved First Floor Plan

Scale $1/4" = 1'$

BCW 5/21/05



- New Stair System in no. 7
 7 5/8" Rise and 9 3/4" Run
 - Cellar Steps to be installed.
- New Stair System

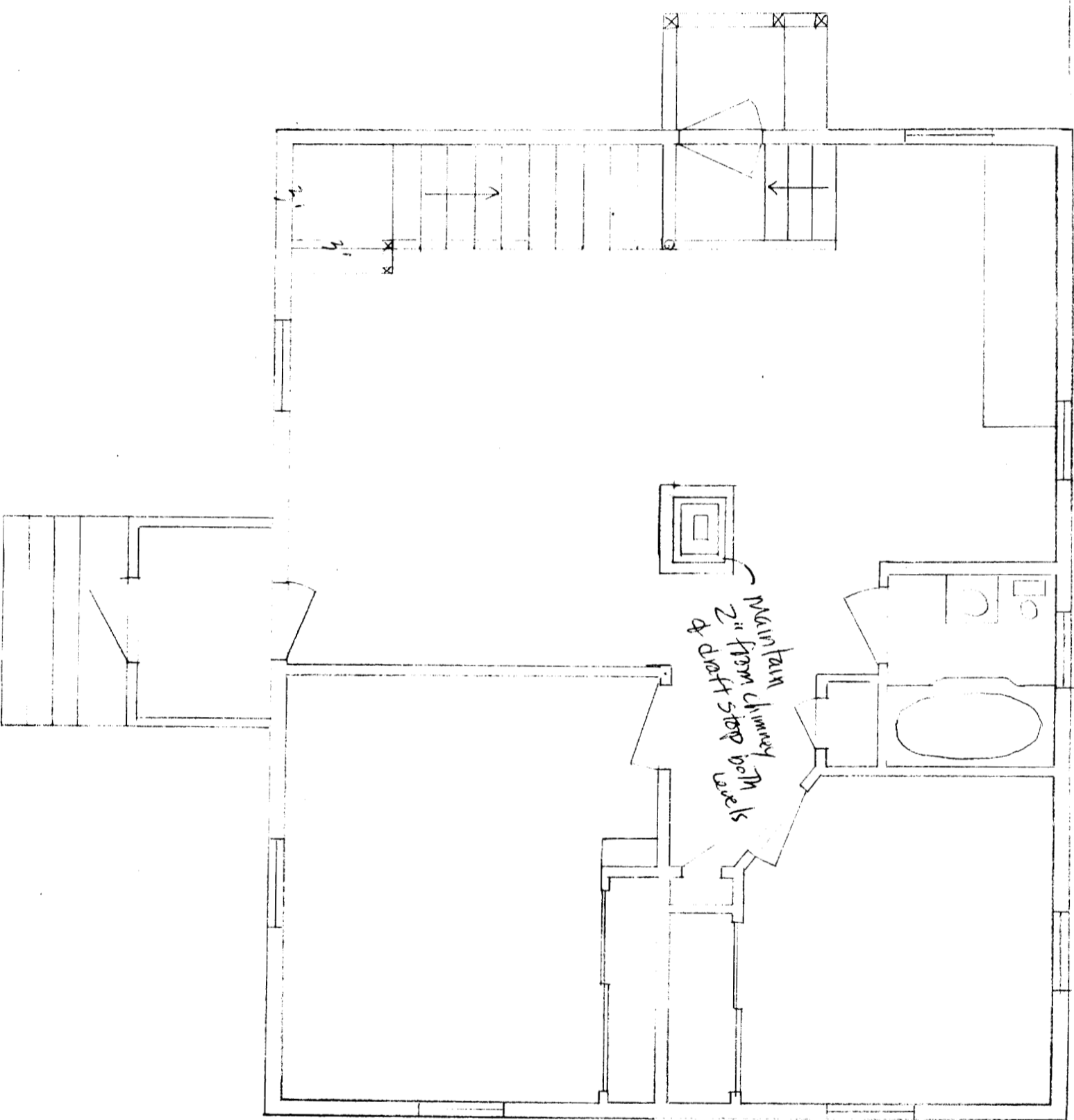

McDonald Maziarz Residence
60 Cypress Street
Portland Maine
Existing Second Floor Plan
Scale $\frac{3}{4}'' = 1'$
BCW 5/22/08

D

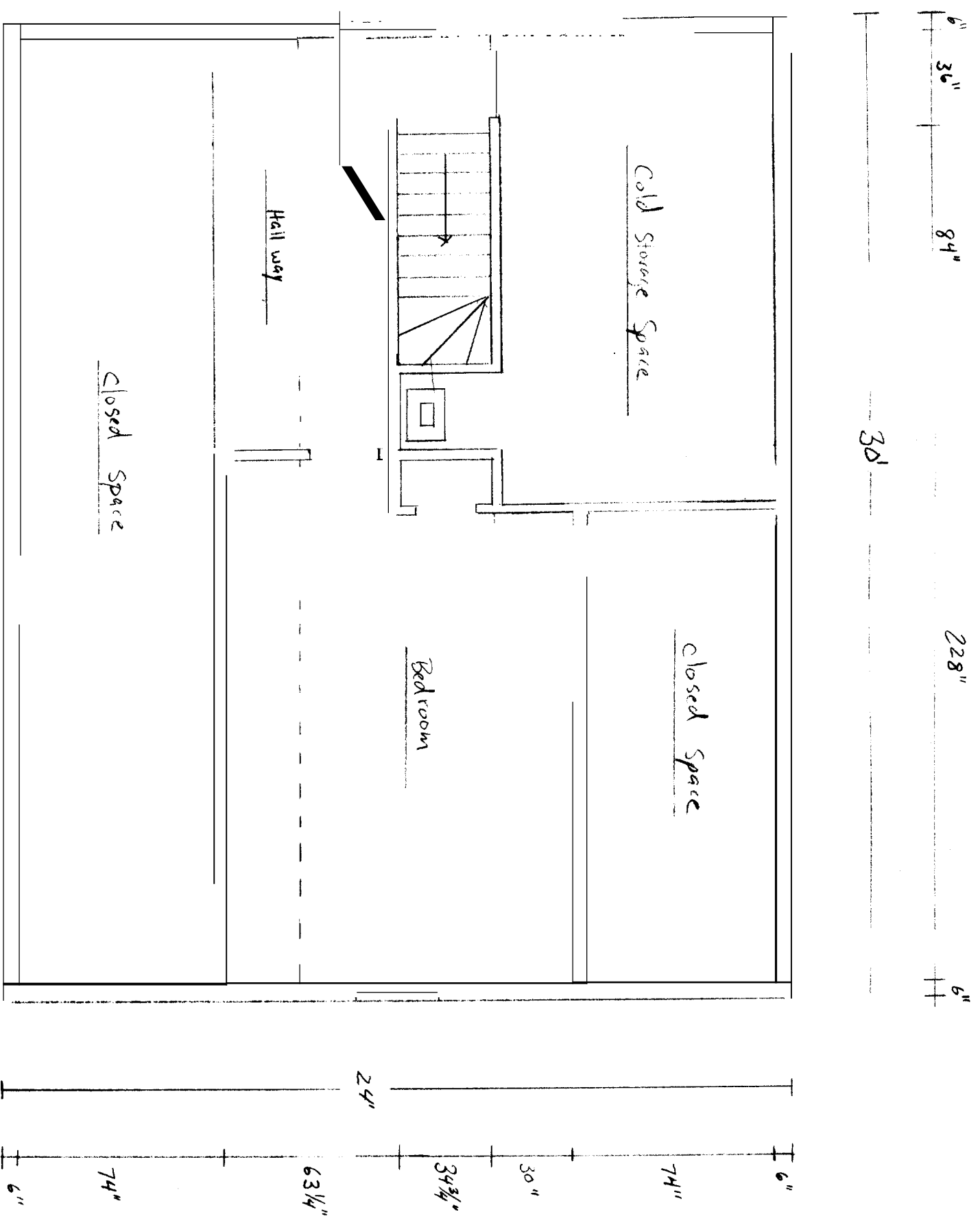

Open Spindle Banister

Cold Storage Space

Closed Space

Bedroom

Hall way

Closed Space

$6''$
 $36''$
 $84''$
 $30'$
 $228''$
 $6''$

$6''$
 $74''$
 $30''$
 $34\frac{3}{4}''$
 $24''$
 $63\frac{1}{4}''$
 $74''$
 $6''$

McDonald Maziarz Residence

60 Cypress Street
Portland, Maine

Improved Second Floor Plan w/ basement

Scale 1/4" = 1'

BCW 5/21/05

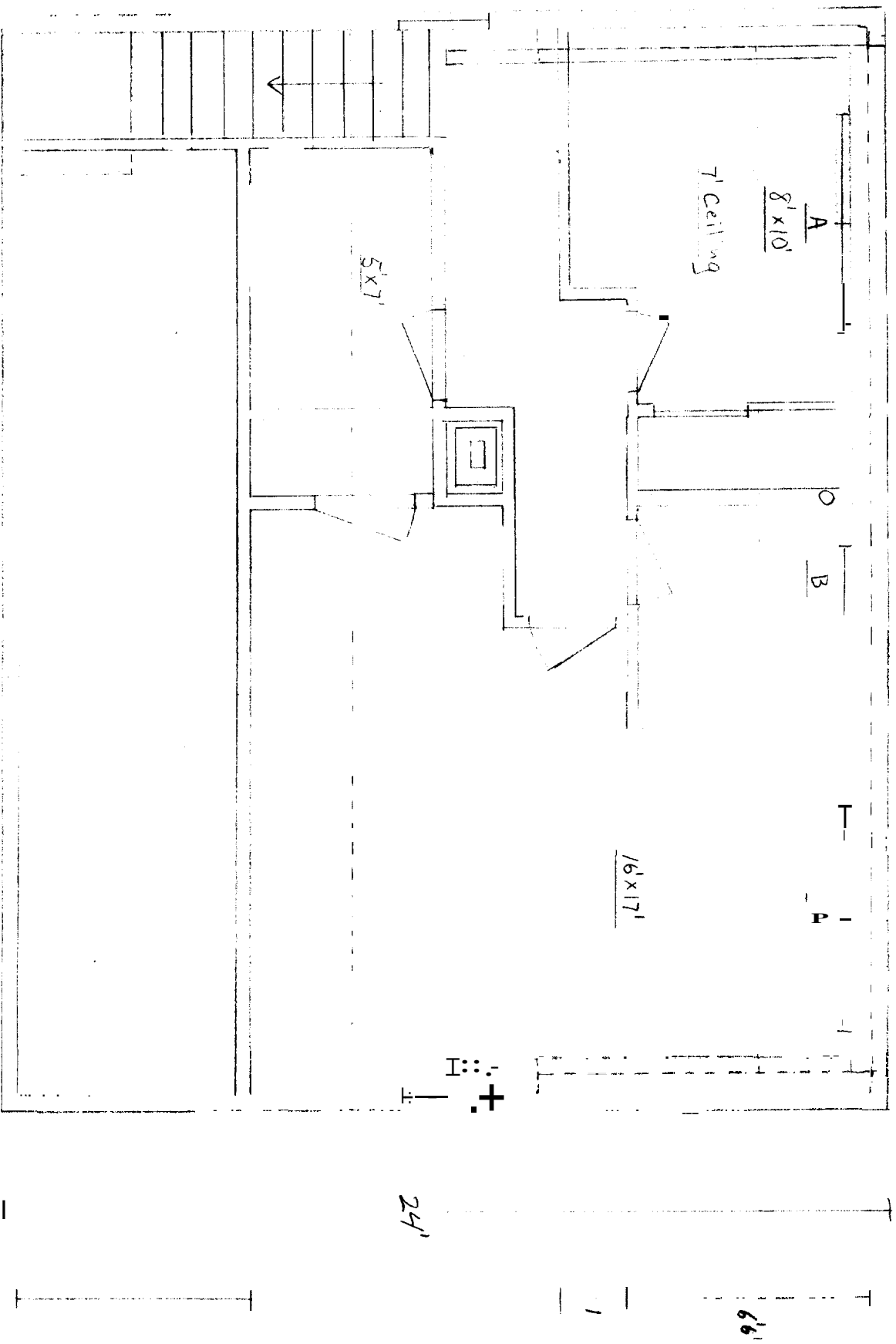
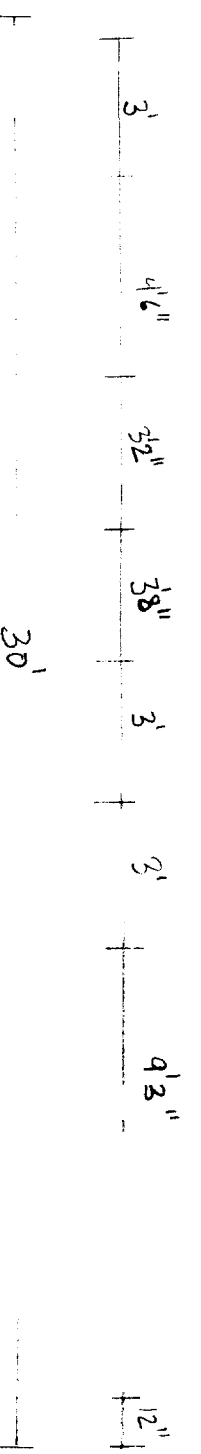

Window Table

- A - Anderson 244DH 3049
200 Series - Boyle milled
- B - Anderson 244DH 2830
21 1/2 2 7 1/2 - 200 Series
- ★ Bedroom Windows 5.7.5.F OKM ✓

McDonald Maziarz Residence

60 Cypress Street

Portland, Maine

Existing South Elevation

Scale 1/4" = 1'

BCW 5/23/05

F

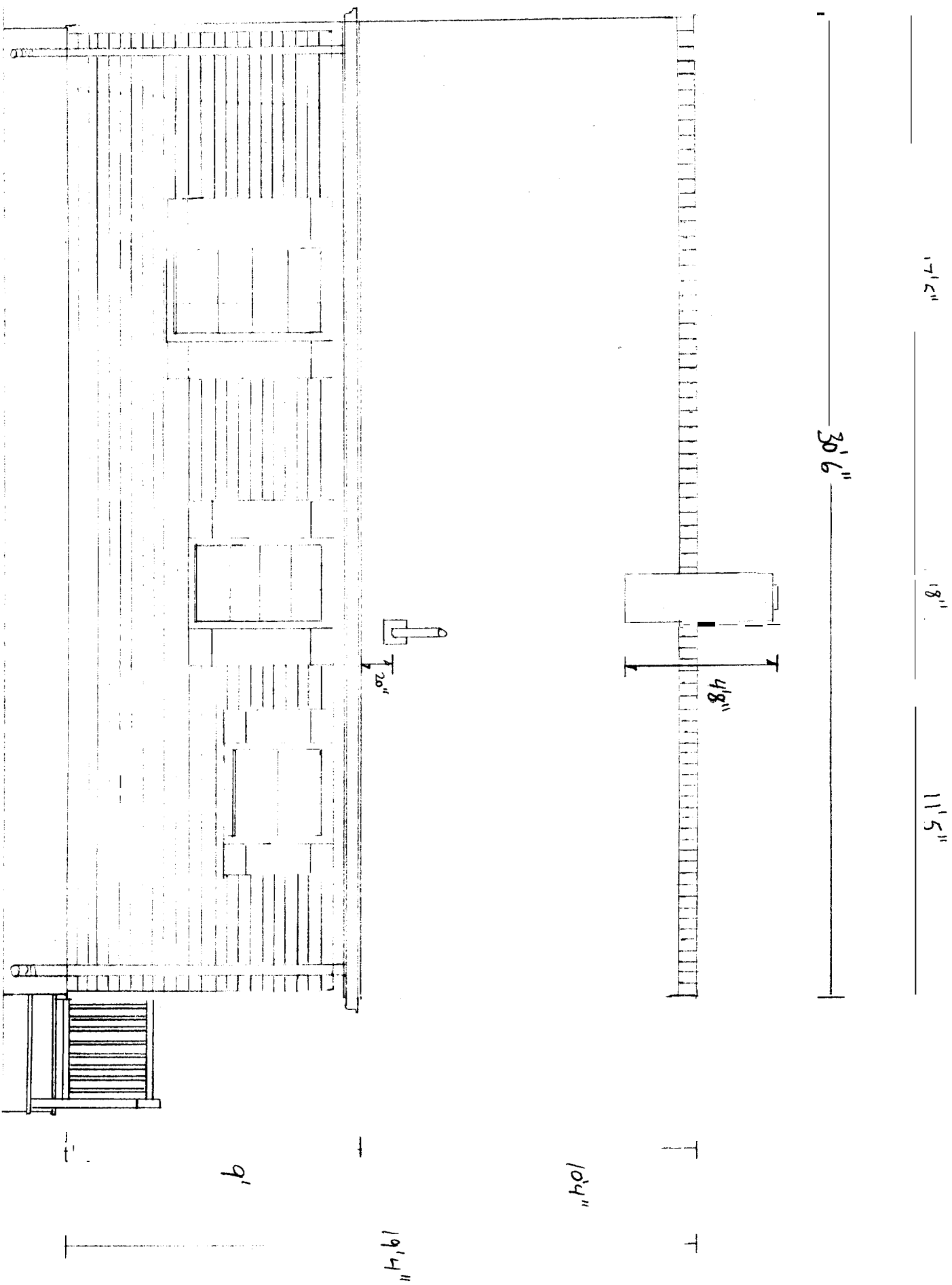

McDonald Maziarz Residence
60 Cypress Street
Portland, Maine
Improved South Elevation
Scale 1/4" = 1'
BCW 5/25/05

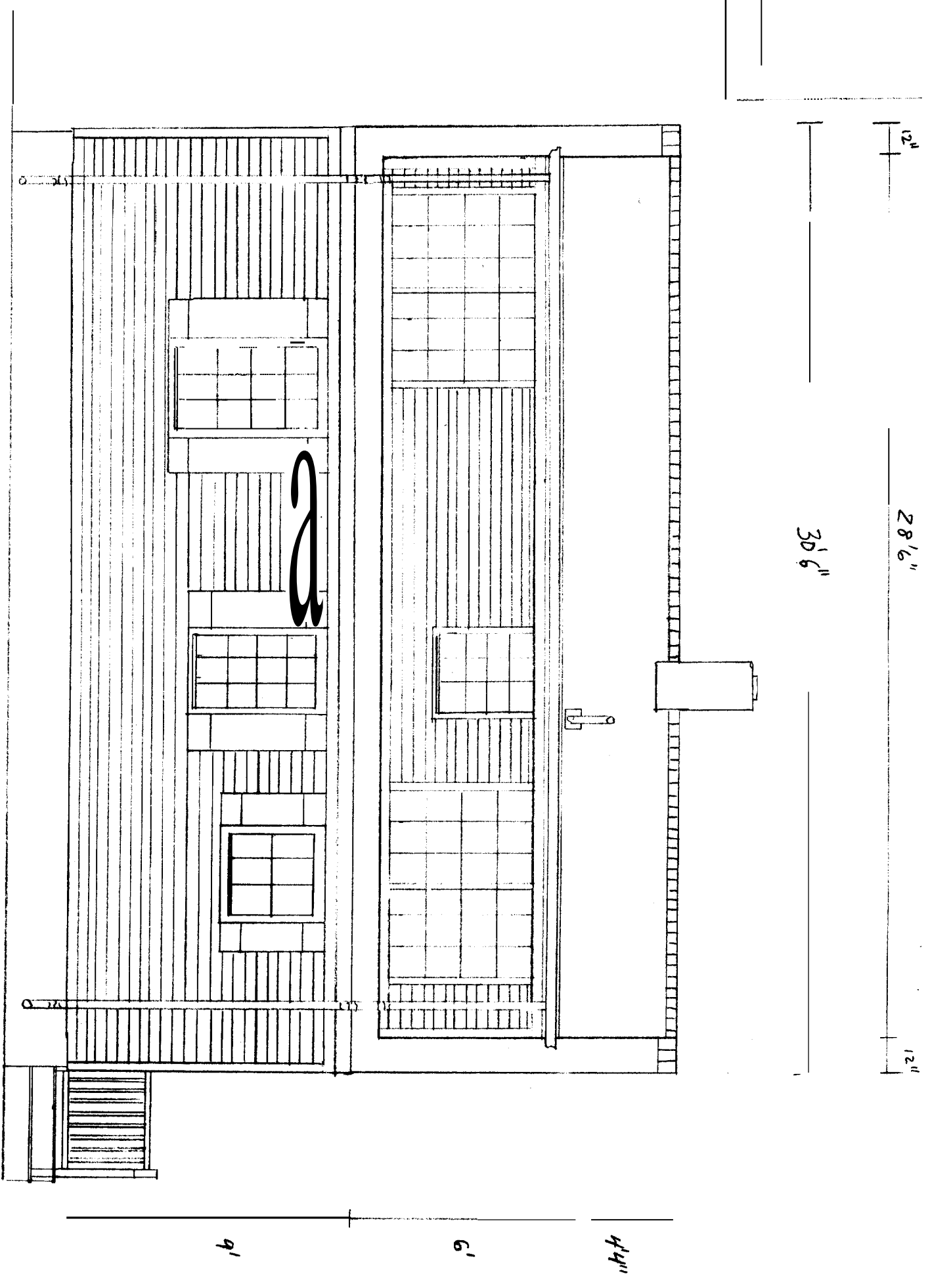

McDonald Maziarz Residence
60 Cypress Street
Portland Maine
Existing West Elevation
Scale $\frac{1}{4}'' = 1'$
BCW 5/25/05

24'

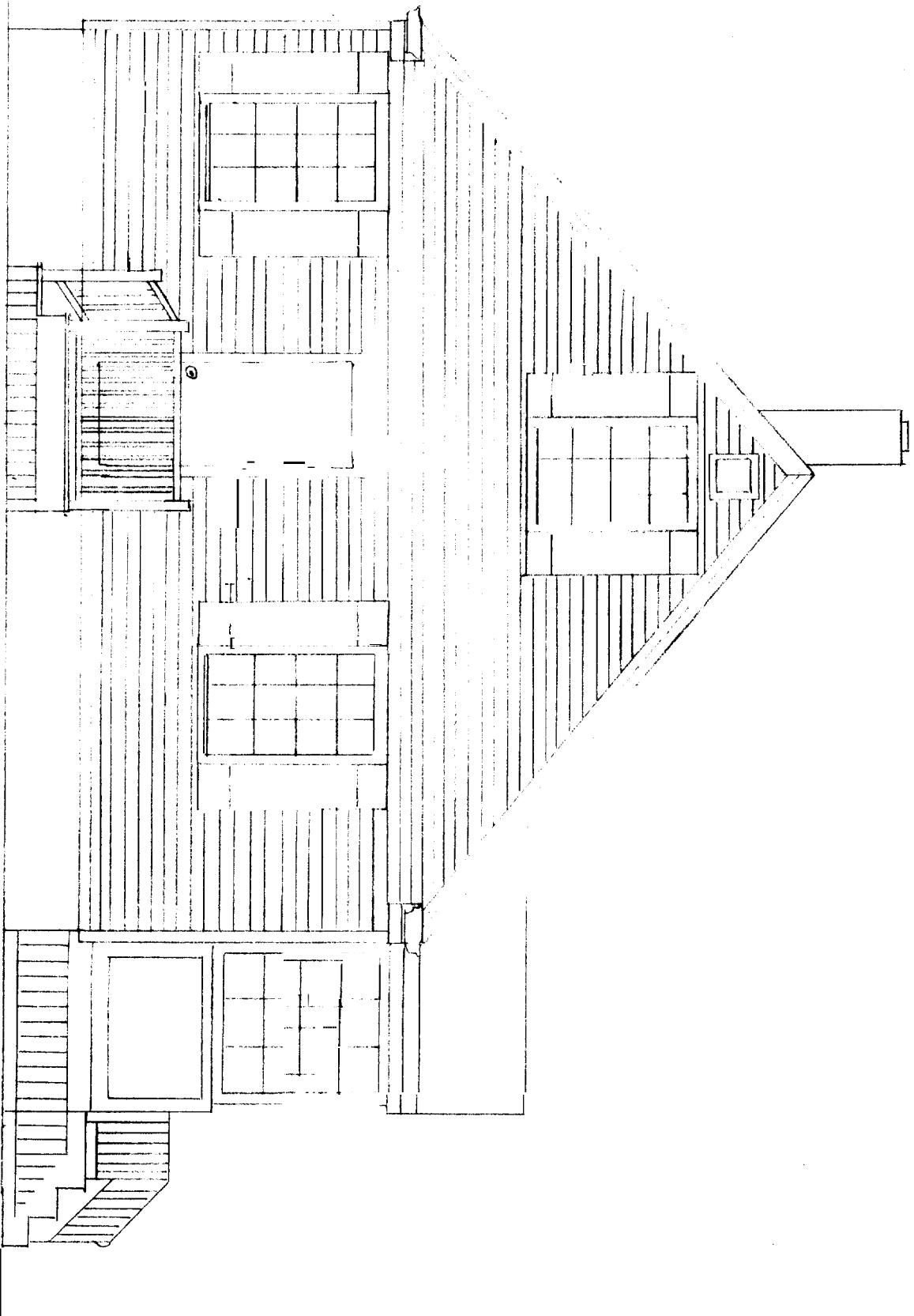

19'4"

±2'

McDonald Maziarz Residence
60 Cypress Street
Portland Maine
Improve West elevation
Scale 1/4" = 1'-0"
BCW 5/26/05

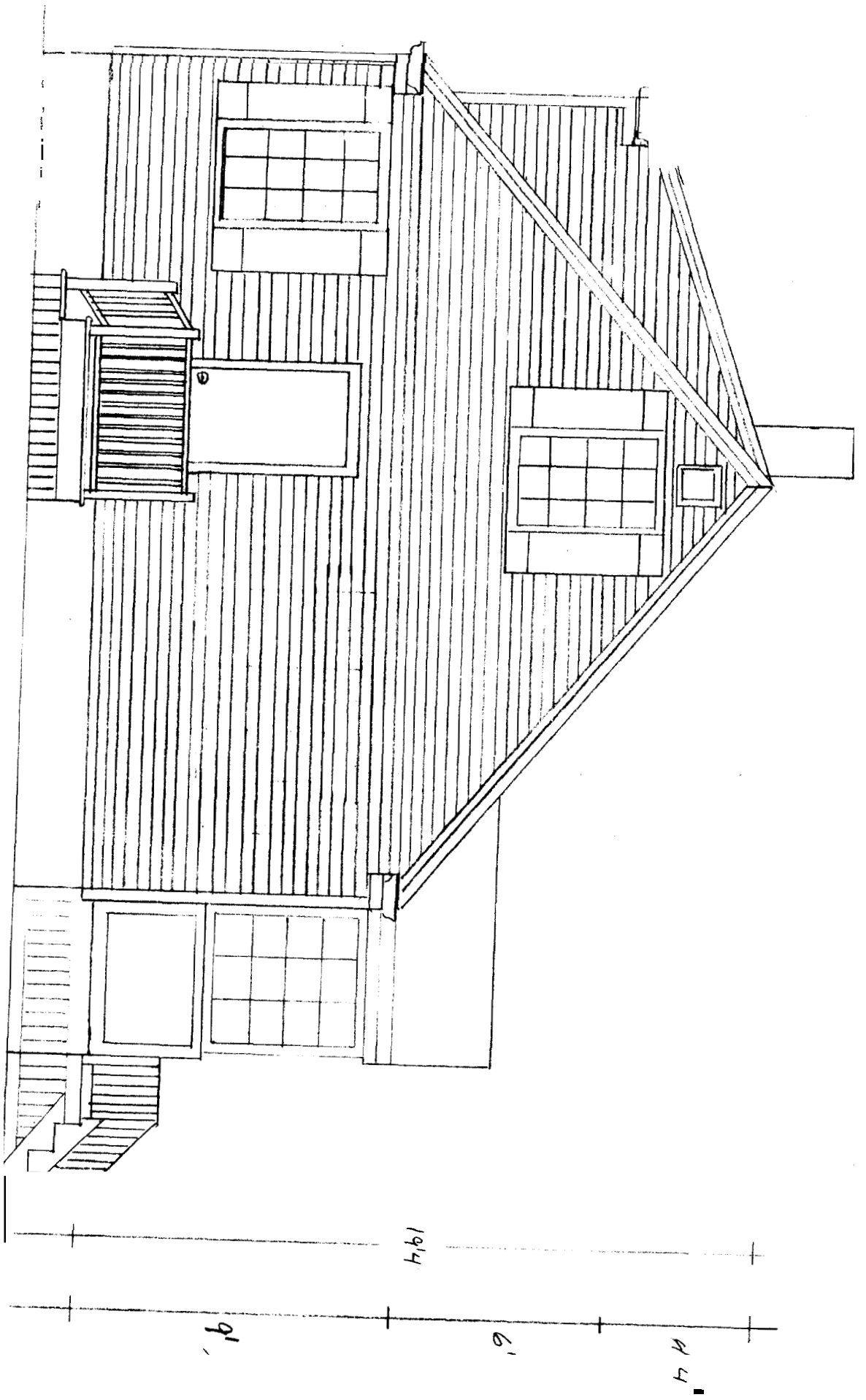

19'4"
11
24'6"

I

McDonald Maziarz Residence
 60 Cypress Street
 Portland Maine
 Framing Detail, Dormer
 Scale $\frac{3}{4}'' = 1'$
 BCW 5/26/05

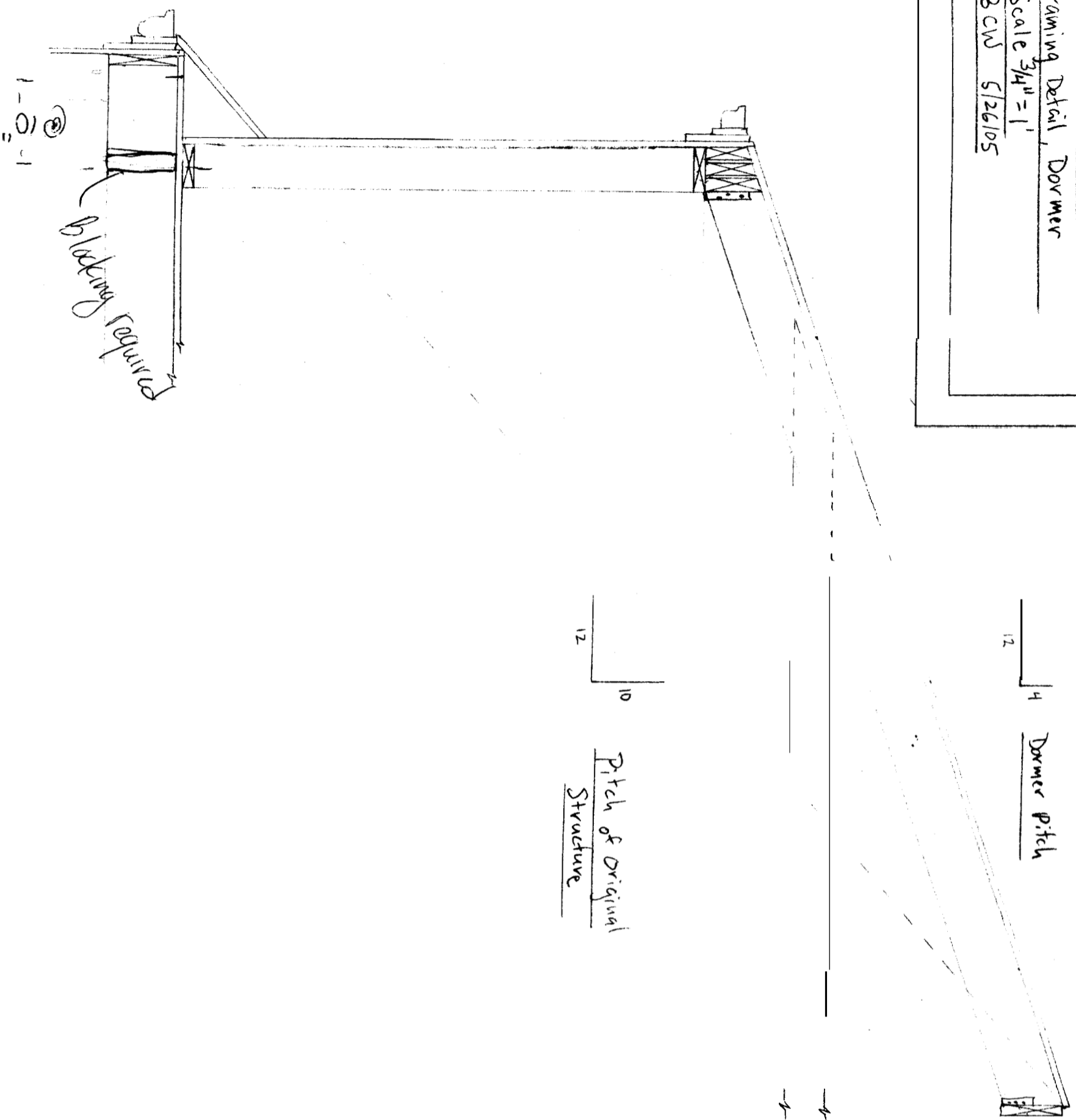

4
12
Dormer Pitch

10
12
Pitch of Original Structure

Framing to be 16" o.c.

Roof Sheathing - $\frac{5}{8}''$ CDX

Roof Rasters ~~2x8~~ 2x10 16 o.c.
 Joist Hang on header
 And at Ridge

Asphalt Architectural Shingles
 Grace Ice and water shield

Collar ties 2x6

Window header 2x8 tripple $\frac{1}{2}''$ plywood spacers

Wall Sheathing - $\frac{1}{2}''$ CDX

Wall Studs 2x6

Siding to match Current
 Vinyl Siding

R19 Batt Insulation - Wall

R30 Batt Insulation - Ceiling

Original Floor Joist 2x10

McDonald Maziarz Residence
 60 Cypress Street
 Portland, Maine

Stair and Hand rail Detail

Scale $3/4" = 1'$
 BCW 5/31/05

Basement Stairs to be
 Beneath new Stairs
 using Existing Stair
 System, Accessed By
 The West Exterior Door.

The stair well to be open
 on the 1st Floor And Walled
 In on the 2nd Floor.

Stair Rise $7\frac{15}{16}$ Run $9\frac{3}{4}$ Contractor will trim to meet $7\frac{3}{4} \times 10"$ depending on ceiling beam

Original Windows
 to be Removed

to 8" min headroom

Ceiling In Living Room

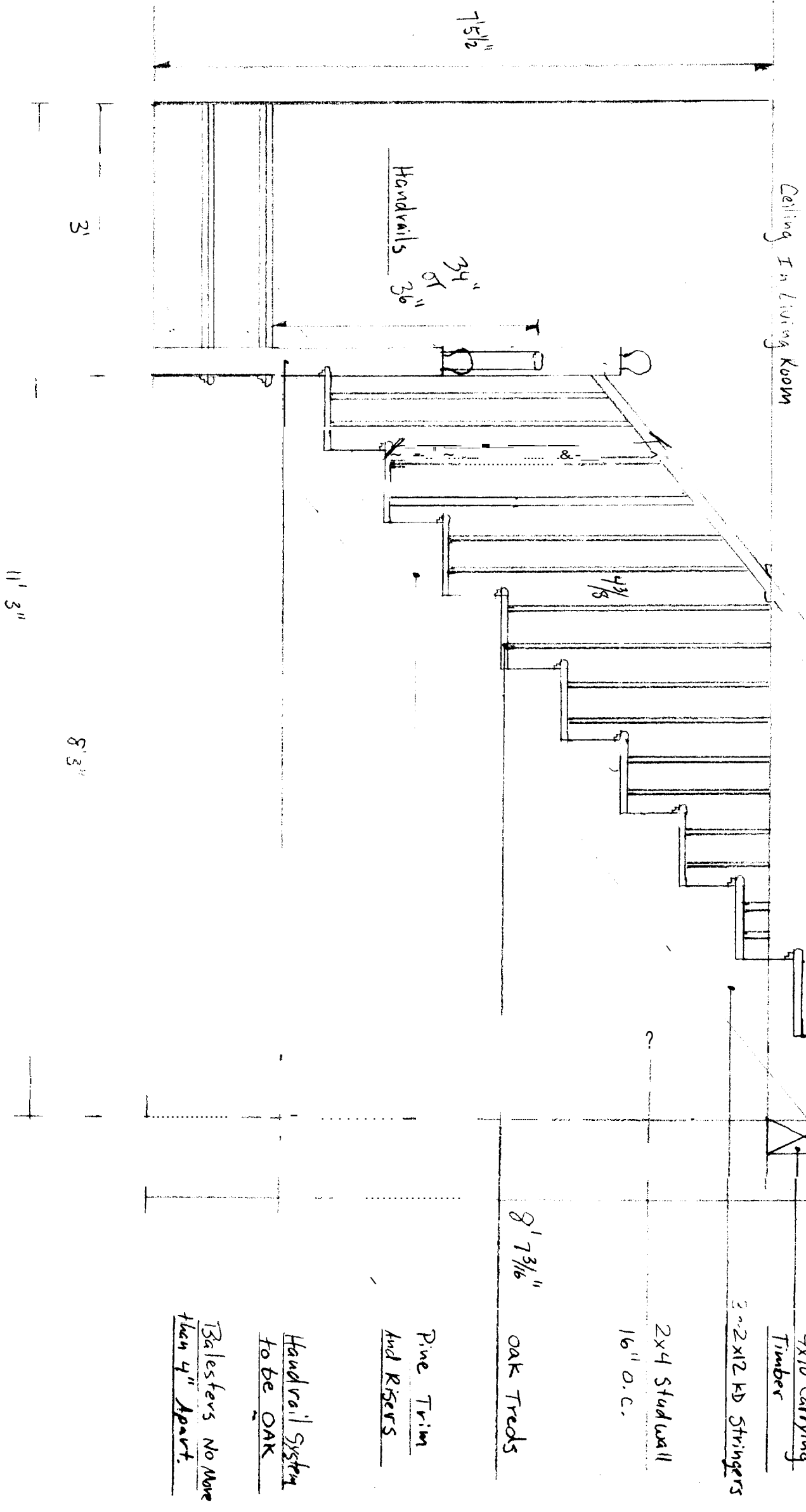

Need details for $3/4"$ CDX Plywood on $16"$ O.C. joists

Pine Trim
 And Risers
 Handrail System
 to be OAK
 Balusters No More
 than 4" Apart.

McDonald Maziarz Residence
 60 Cypress Street
 Portland Maine

Electrical Plan
 Scale 1/4" = 1'
 BCM 5/31/05

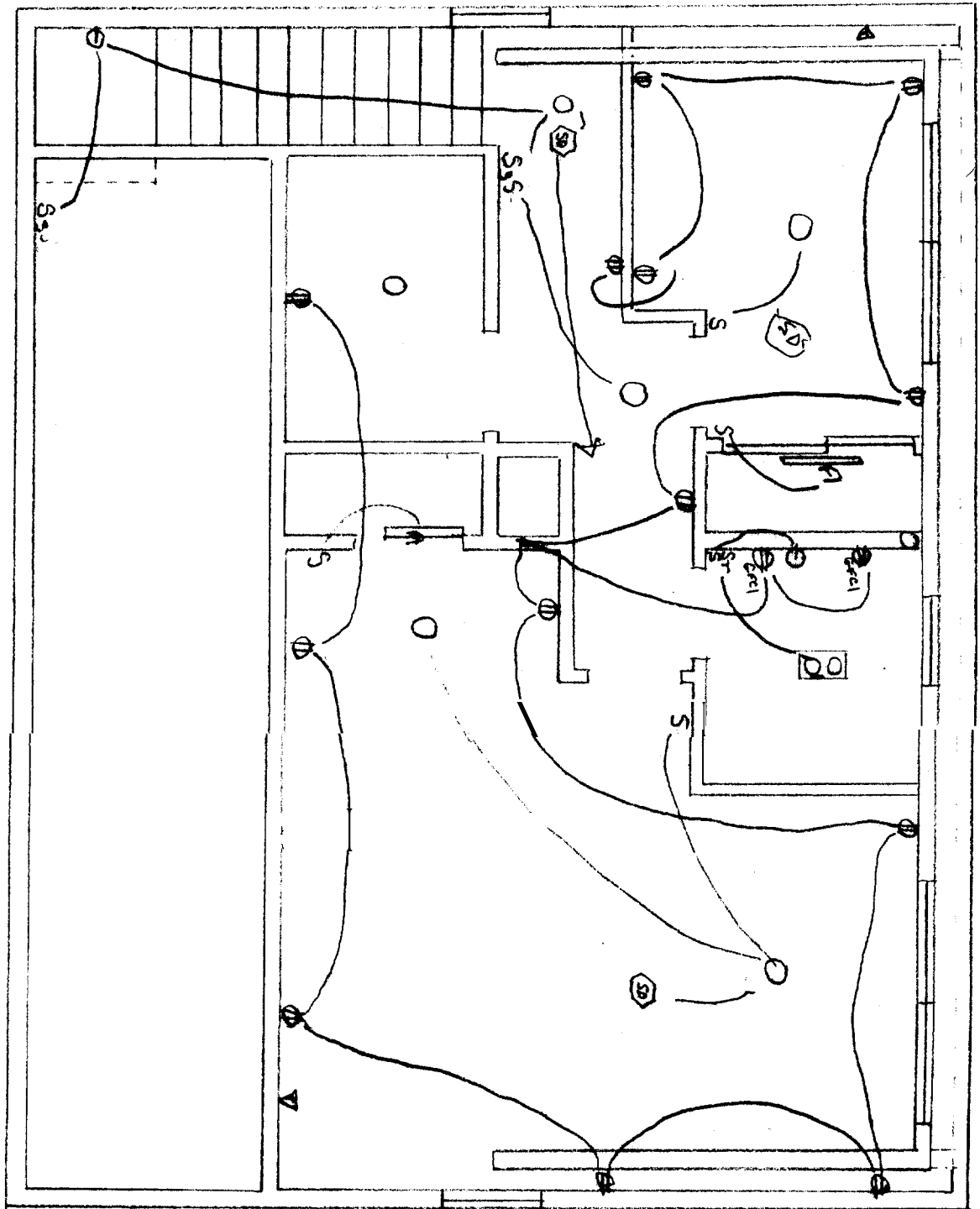

Add 1 min.
 ON 1st
 Floor

Symbol Key

| | |
|----------------|-------------------------------|
| ⊕ | Duplex Recepticle |
| ○ | Surface mounted Light Fixture |
| ⊞ | Light Fan Combination |
| ⊞ | Smoke Detector |
| ⊕ | GFCI - Duplex GFCI Recepticle |
| S | Single pole switch |
| S ₃ | Three way Switch |
| S _T | Timer Switch |
| ⊞ | Flourescent Fixture |
| ⊞ | Wall Mounted Light Fixture |

Note:
 -Electrical Systems
 to be installed
 By Home owner
 -New Service to be
 Installed In Basement