

DISPLAY THIS CARD ON PRINCIPAL FRONTAGE OF WORK
CITY OF PORTLAND

Please Read
 Application And
 Notes, If Any,
 Attached

BU...TION

PERMIT

Permit Number: 090192

PERMIT ISSUED

This is to certify that WOLAK EDWARD /E. Ribeir Corp/Ed Ribeir

has permission to Interior renovations to existing "junkin D...ts"

AT 1370 WASHINGTON AVE

CP... 344 C008001

provided that the person or persons, firm or corporation accepting this permit shall comply with all of the provisions of the Statutes of Maine and of the Ordinances of the City of Portland regulating the construction, maintenance and use of buildings and structures, and of the application on file in this department.

Apply to Public Works for street line and grade if nature of work requires such information.

Notification of inspection must be given and written permission procured before this building or part thereof is lath... or other... ed-in. 24 HOURS NOTICE IS REQUIRED.

A certificate of occupancy must be procured by owner before this building or part thereof is occupied.

OTHER REQUIRED APPROVALS

Fire Dept. CAPT. R. Taiter

Health Dept. _____

Appeal Board _____

Other _____

Department Name

James Burke 4/3/09
 Director - Building & Inspection Services

PENALTY FOR REMOVING THIS CARD

City of Portland, Maine - Building or Use Permit Application

389 Congress Street, 04101 Tel: (207) 874-8703, Fax: (207) 874-8716

Permit No: 09-0192	Issue Date:	CBL: 344 C008001
-----------------------	-------------	---------------------

Location of Construction: 1370 WASHINGTON AVE	Owner Name: WOLAK EDWARD	Owner Address: 65 GRAY RD #4	Phone:
Business Name:	Contractor Name: E. Ribeiro Corp/ Edward Ribeiro	Contractor Address: 26 Jane Howland Place Seekonk	Phone: 5083696392
Lessee/Buyer's Name	Phone:	Permit Type: Alterations - Commercial	Zone: B-2
Past Use: Commercial Coffee Shop "Dunkin Donuts"	Proposed Use: Commercial Coffee Shop "Dunkin Donuts" - Interior renovations to existing "Dunkin Donuts"	Permit Fee: \$320.00	Cost of Work: \$30,000.00
Proposed Project Description: Interior renovations to existing "Dunkin Donuts"		FIRE DEPT: <input checked="" type="checkbox"/> Approved <input type="checkbox"/> Denied * See Conditions	CEO District: 4
		INSPECTION: Use Group: <i>AP-3</i> Type: <i>SB</i>	
		Signature: <i>KG</i>	Signature: <i>AMG 4/3/09</i>
		PEDESTRIAN ACTIVITIES DISTRICT (P.A.D.)	
		Action: <input type="checkbox"/> Approved <input type="checkbox"/> Approved w/Conditions <input type="checkbox"/> Denied	
		Signature: _____ Date: _____	

Permit Taken By: Ldobson	Date Applied For: 03/11/2009	Zoning Approval
-----------------------------	---------------------------------	------------------------

<p>1. This permit application does not preclude the Applicant(s) from meeting applicable State and Federal Rules.</p> <p>2. Building permits do not include plumbing, septic or electrical work.</p> <p>3. Building permits are void if work is not started within six (6) months of the date of issuance. False information may invalidate a building permit and stop all work..</p>	<p>Special Zone or Reviews</p> <p><input type="checkbox"/> Shoreland</p> <p><input type="checkbox"/> Wetland</p> <p><input type="checkbox"/> Flood Zone</p> <p><input type="checkbox"/> Subdivision</p> <p><input type="checkbox"/> Site Plan</p> <p>Maj <input type="checkbox"/> Minor <input type="checkbox"/> MM <input type="checkbox"/></p> <p>Date: <i>3/12/09</i></p>	<p>Zoning Appeal</p> <p><input type="checkbox"/> Variance</p> <p><input type="checkbox"/> Miscellaneous</p> <p><input type="checkbox"/> Conditional Use</p> <p><input type="checkbox"/> Interpretation</p> <p><input type="checkbox"/> Approved</p> <p><input type="checkbox"/> Denied</p> <p>Date: _____</p>	<p>Historic Preservation</p> <p><input checked="" type="checkbox"/> Not in District or Landmark</p> <p><input type="checkbox"/> Does Not Require Review</p> <p><input type="checkbox"/> Requires Review</p> <p><input type="checkbox"/> Approved</p> <p><input type="checkbox"/> Approved w/Conditions</p> <p><input type="checkbox"/> Denied</p> <p>Date: _____</p>
---	---	--	---

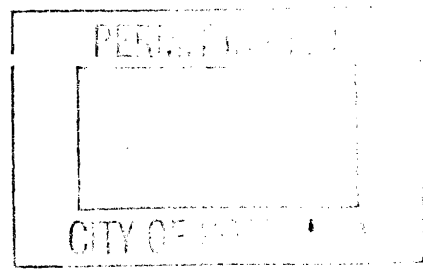

CERTIFICATION

I hereby certify that I am the owner of record of the named property, or that the proposed work is authorized by the owner of record and that I have been authorized by the owner to make this application as his authorized agent and I agree to conform to all applicable laws of this jurisdiction. In addition, if a permit for work described in the application is issued, I certify that the code official's authorized representative shall have the authority to enter all areas covered by such permit at any reasonable hour to enforce the provision of the code(s) applicable to such permit.

SIGNATURE OF APPLICANT	ADDRESS	DATE	PHONE
RESPONSIBLE PERSON IN CHARGE OF WORK, TITLE		DATE	PHONE

City of Portland, Maine - Building or Use Permit

389 Congress Street, 04101 Tel: (207) 874-8703, Fax: (207) 874-8716

Permit No: 09-0192	Date Applied For: 03/11/2009	CBL: 344 C008001
-----------------------	---------------------------------	---------------------

Location of Construction: 1370 WASHINGTON AVE	Owner Name: WOLAK EDWARD	Owner Address: 65 GRAY RD #4	Phone:
Business Name:	Contractor Name: E. Ribeiro Corp/ Edward Ribeiro	Contractor Address: 26 Jane Howland Place Seekonk	Phone: (508) 369-6392
Lessee/Buyer's Name	Phone:	Permit Type: Alterations - Commercial	

Proposed Use: Commercial Coffee Shop "Dunkin Donuts" - Interior renovations to existing "Dunkin Donuts"	Proposed Project Description: Interior renovations to existing "Dunkin Donuts"
---	--

Dept: Zoning	Status: Approved with Conditions	Reviewer: Marge Schmuckal	Approval Date: 03/12/2009	Ok to Issue: <input checked="" type="checkbox"/>
Note:				
1) Separate permits shall be required for any new signage or alterations to existing signage.				
2) This permit is being approved on the basis of plans submitted. Any deviations shall require a separate approval before starting that work.				
Dept: Building	Status: Approved with Conditions	Reviewer: Jeanine Bourke	Approval Date: 04/03/2009	Ok to Issue: <input checked="" type="checkbox"/>
Note:				
1) Separate permits are required for any electrical, plumbing, sprinkler, fire alarm or HVAC or exhaust systems. Separate plans may need to be submitted for approval as a part of this process.				
2) Application approval based upon information provided by applicant. Any deviation from approved plans requires separate review and approval prior to work.				
Dept: Fire	Status: Approved with Conditions	Reviewer: Capt Keith Gautreau	Approval Date: 03/17/2009	Ok to Issue: <input checked="" type="checkbox"/>
Note:				
1) Emergency lights and exit signs are required				
2) All construction shall comply with NFPA 101				

Comments:
3/19/2009-jmb: Left vmsg for Helena for details on where the wall is being extended and the occupancy listed as A-3. Eddie R. Called back and gave me the # for the architect (Taylor). I left a msg with another architect to have him call me.
3/20/2009-jmb: Taylor called back to say he was not the architect, left another vmsg with Helena to call for the correct architect.
3/25/2009-jmb: Received email from Eddie with the architects info, left vmsg with him to call.
4/3/2009-jmb: Left another msg. For the architect for the occupancy classification
4/3/2009-jmb: No response from the architect, will classify as A-3 per stamped plans even though this is a B Occupancy, ok to issue

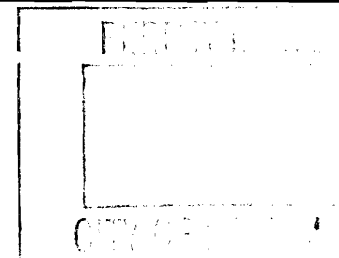



General Building Permit Application

If you or the property owner owes real estate or personal property taxes or user charges on any property within the City, payment arrangements must be made before permits of any kind are accepted.

Location/Address of Construction: <u>1378 Washington Street.</u>		
Total Square Footage of Proposed Structure/Area		Square Footage of Lot
Tax Assessor's Chart, Block & Lot Chart# Block# Lot# <u>344 C 008</u>	Applicant *must be owner, Lessee or Buyer* Name <u>Ed Wolak</u> Address <u>65 Gray Road, Box 4</u> City, State & Zip <u>Falmouth, ME 04105</u>	Telephone: <u>207-797-7600</u>
Lessee/DBA (If Applicable)	Owner (if different from Applicant) Name Address City, State & Zip	Cost Of Work: \$ <u>30,000⁰⁰</u> C of O Fee: \$ _____ Total Fee: \$ _____
Current legal use (i.e. single family) <u>Coffee Shop</u> If vacant, what was the previous use? <u>same</u> Proposed Specific use: <u>same</u> Is property part of a subdivision? _____ If yes, please name _____ Project description: <u>Install new wallpaper, wainscot & wall tile finishes. Frame a wall over the existing wall to the ceiling, Relaminiate the service counters, Replace the stainless steel counter tops. Paint Building Exterior. Build a sign facade.</u>		
Contractor's name: <u>Edward Ribeiro E. Ribeiro Corp.</u> Address: <u>26 Jane Howland Place</u> City, State & Zip: <u>Seabrook, MA 02731</u> Telephone: <u>508-369-6392</u> Who should we contact when the permit is ready: <u>Helen</u> Telephone: <u>508-369-6392</u> Mailing address: <u>26 Jane Howland Place Seabrook, MA 02731</u>		

Please submit all of the information outlined on the applicable Checklist. Failure to do so will result in the automatic denial of your permit.

In order to be sure the City fully understands the full scope of the project, the Planning and Development Department may request additional information prior to the issuance of a permit. For further information or to download copies of this form and other applications visit the Inspections Division on-line at www.portlandmaine.gov, or stop by the Inspections Division office, room 315 City Hall or call 874-8703.

I hereby certify that I am the Owner of record of the named property, or that the owner of record authorizes the proposed work and that I have been authorized by the owner to make this application as his/her authorized agent. I agree to conform to all applicable laws of this jurisdiction. In addition, if a permit for work described in this application is issued, I certify that the Code Official's authorized representative shall have the authority to enter all areas covered by this permit at any reasonable hour to enforce the provisions of the codes applicable to this permit.

Signature: Edward A. Ribeiro Date: 3-10-09

This is not a permit; you may not commence ANY work until the permit is issued

344.C.008

From: "Eddie Ribeiro" <eddie@eribeirocorp.com>
To: <imd@portlandmaine.gov>
Date: 3/24/2009 11:36:02 AM
Subject: Dunkin Donuts 1378 Washington St.

Lisa,

The architects information you are looking for is:

Jayant Rajagopal
Project Manager
JDS Design Services LLC
P.O. Box 583
West Barnstable, MA-02668

Cell: 774-994-2435
Fax: 508-743-0489
Email: juks66@comcast.net

Let me know if you need anything else.

Thanks,
Eddie Ribeiro
E. Ribeiro Corp.
Seekonk, MA
Tel: 774-451-5684
eddie@eribeirocorp.com
www.eribeirocorp.com

3/25/09
left vcmg 9:30 AM
to call -
3/27 left vcmg
returned 4:50
3/31 left vcmg
about see class.
Not really
A-3 occupancy
B use
per sec. 307.1.1
OL 450
508-362-8733
774-994-2435

Fax Cover Sheet



E. Ribeiro Corp.
General Contractor & Millwork Supplier

26 Jane Howland Place
Seekonk, MA 02771
Office: (508)-369-6392
Fax: (508)-336-0089
Email: eddie@eribeirocorp.com
Email: helena@eribeirocorp.com

To: Eddie,

Fax: 207-797-8339

From: Helena

Date: 3-11-09

Re: MDS sheets for Sherwinn, Wilsonart and APA

Total pages (including cover) 17

Eddie,
Let me know if you do not receive all of the 17 pages.

-Helena

**SHERWIN-WILLIAMS.****FAX COVER SHEET**

To: Eddie E. Ribero	From: Kristy
Fax Number: 508-336-0089	Store: 5421
Date:	Phone Number:
Subject: MSDS	Fax Number:
Comments: 3 pages	

PROFESSIONAL

Product Data Sheet

VOV (Vinyl-Over-Vinyl), PRO-555

Base: Modified starch and synthetic polymer

General Properties: VOV[®], PRO-555 is a high tack, low moisture adhesive for new vinyl over existing vinyl. Roman Adhesives' VOV is the most recognized and best selling in the industry.

- Maximum adhesion
- Eliminates priming and sizing
- Excellent slip and open time

Recommended Uses: For vinyl over vinyl applications

Not Recommended For: For hanging over existing wallcovering that is coated with Teflon or Teflon.

Substrates: Clean, dry, firmly attached vinyl wallcovering. On existing, heavily embossed wallcovering, VOV should be applied to both the existing and the new vinyl (VOV on existing wallcovering must dry for one hour before hanging new vinyl).

Compatible Coatings: Not Applicable

SPECIFICATION DATA

Percent Solids:	Approximately 55%
Coverage:	Approximately 160 square feet per gallon
Viscosity:	Approximately 17,000 cps
Drying Time:	Drying time between two vinyls will vary depending on the temperature and humidity of the room.
Storage:	Avoid freezing; keep in cool, dry place.

RA ROMAN ADHESIVES, INC.

The leading manufacturer of wallcovering adhesives, primers and sundries.

Questions? Call 1-800-498-6117



APPLICATION INSTRUCTIONS

Surface Preparation: Surface must be free from grease and other residues, dry, structurally sound. Be certain existing wallcovering is firmly attached to the wall. Be sure to repair or remove all loose wallcovering. Before proceeding with any unusual conditions, consult your adhesive or wallcovering supplier.

Tinting: N/A

Dilution: Do not dilute

Application Methods: Use only when the room temperature is above 50°F. Apply a thin, even coat of adhesive. **IMPORTANT:** A thick coat is less effective than a thin coat. Avoid contact with the surface of embossed or delicate wallcoverings. On existing heavily embossed wallcovering, VOV should be applied to both the existing and the new vinyl.

Drying Time: Drying time between two vinyls will vary depending on the humidity of the room.

Clean Up: Before the adhesive dries, remove the excess with clean water. Additional effort may be required if the adhesive is allowed to contact the surface of embossed or textured vinyls. The adhesive will not clean up after it dries.

CAUTION

Do not freeze. Do not take internally. In case of ingestion, seek medical attention. Avoid contact with skin and eyes. Use of skin and eye protection equipment is recommended at all times. If contact with eye occurs, flush with water for 15 minutes. If skin contact occurs, wash with soap and water. Seek medical attention if rash or other symptoms occur. Do not mix with other chemicals. Use in a well ventilated work area. Close container after each use. Keep out of reach of children.

LIMITED WARRANTY

Roman Adhesives, Inc. warrants that it will replace this product free of charge if within twelve months of manufacture it is defective in material or workmanship. This warranty is in lieu of any other. The exclusive remedy is limited to the replacement of the product and Roman Adhesives, Inc. disclaims liability for consequential damages. Conditions of use are beyond our control.

MSDS-VOV ADHESIVE PRO-555

PROFESSIONAL* VOV (VINYL OVER VINYL) PRO-555

Section 6-Reactivity Data

This product is stable and compatible with all compounds that are compatible with water and water solutions. Hazardous polymerization does not occur.

Section 7-Precautions for Safe Handling and Use

Steps to be taken in case the product is released or spilled:
Small spills of 1-2 gallons or less may be diluted 50:1 and washed down the drain.
Large spills should be recovered as much as possible and disposed of as non-hazardous liquid waste.
Incinerate or landfill in accordance with Federal, State and Local regulations.
Adhesive residues may pose a slip hazard; personnel should be careful during clean-up.

Section 8-Control Measures

Respiratory protection is not usually required, however any room where this product is used should have good ventilation, i.e., open windows, exhaust fans, etc. A good, normal precaution is to wear protective gloves and glasses. No other protection equipment is necessary.

Section 9-Special Precautions

Store at moderate temperatures (50-100 F). Protect from freezing. Keep out of the reach of children. Keep container closed when not in use.

SUPPLEMENTAL INFORMATION

Waste Disposal
This product can be handled as a non-hazardous industrial waste.

REGULATORY INFORMATION

Workplace Classifications
This product is considered non-hazardous under the OSHA Hazard Communication Standard (29CFR 1910.1200). This product is not a "controlled product" under the Canadian Workplace Hazardous Materials Information System (WHMIS).

Transportation Classifications
US DOT Shipping Class — 60
US DOT Description — Adhesive Paste NOI

Emergency Planning and Community Right to Know (SARA Title 3)
Section 311/312 Categorizations (40CFR 370)
This product is not a hazardous chemical under 29CFR 1910.1200, and therefore is not covered by Title III of SARA. Section 313 Information (40CFR 372)
This product does not contain a chemical which is listed in Section 313 above de minimis concentrations.

CERCLA Information (40CFR 302.4)
Releases of this material to air, land or water are not reportable to the National Response Center under the Comprehensive Environmental Response, Compensation and Liability Act or to state and local emergency planning committees under the Superfund Amendments and Reauthorization Act, Title III Section 304.

RCRA Information
When this product becomes a waste, it is classified as a non-hazardous waste under criteria of the Resource Conservation and Recovery Act (40CFR 261).

Chemical Control Law Status
All components of this product are listed on the US-EPA Toxic Substance Control Act (TSCA) Chemical Substance Inventory.
All components of this product are listed on the Canadian Environmental Protection Act Domestic Substances List (CEPA-DSL).

MSDS-VOV ADHESIVE PRO-555

PROFESSIONAL® VOV (VINYL OVER VINYL) PRO-555

MATERIAL SAFETY DATA SHEET

Section 1

Manufacturer's Name:
Roman Decorating Products
824 State Street
Calumet City, Illinois 60409

Emergency Assistance:
1-800-488-6117
HMIS Hazard Rating:

FIRE=0
HEALTH=1
REACTIVITY=1
PERSONAL PROTECTION=8

Least=0
Slight=1
Moderate=2
High=3
Extreme=4

Date: March 29, 1995
Revised: December 18, 2001

Trade name and Synonyms:

PROFESSIONAL® VOV (VINYL OVER VINYL) PRO-555

Chemical Name and Synonyms: Vinyl wallcovering adhesive
Chemical Family: Modified resin emulsion

Section 2-Hazardous Ingredients/Identity Information

CAS No.	Chemical Name(s)	OSHA PEL	ACGIH TLV	max %
No Hazardous Ingredients				

Section 3-Physical/Chemical Characteristics

Appearance and Odor:	Opaque, light tan paste, mild acid odor
Specific Gravity(water=1):	1.12
Percent Solids by Weight:	54-56
by Volume:	48-51
Solubility in Water:	Miscible in all proportions
Boiling Point:	212F
Vapor Density:	same as water
Vapor Pressure:	same as water
Evaporation Point:	same as water
Melting Point:	n.a.
Volatile Organic Compounds (VOC, less water):	max 50g/l;0.42 lb/gal

Section 4-Fire and Explosion Hazard Data

Flash Point(methods used) n.a.
Extinguishing Methods: No unusual procedures required.
Special Fire Fighting Procedures: Self contained breathing apparatus should be worn in fighting all fires involving general chemicals.
Unusual Fire and Explosion Hazards: None

Section 5-Health Hazard Data

Carcinogenicity: NTP: no IARC: no OSHA regulated: no

Overexposure—Under current OSHA criteria this product is considered non-hazardous.

Emergency First Aid Procedures

Eyes- Mild irritant. If contact occurs, flush eyes with water for 15 minutes and seek medical attention.

Skin- If contact occurs, wash from skin at first opportunity. Protective gloves may be indicated for those with sensitivity to mild irritants.

Inhalation-If breathing difficulty is encountered, remove to fresh air.

Ingestion- If ingestion occurs, if conscious, give water to drink and seek medical attention. Do not give anything by mouth to an unconscious person.



FAX COVER SHEET

TO: E Ribeiro
COMPANY: _____
DATE: 3/11/09
FAX #: 508-336-0089
FROM: Dale
#OF PAGES: 6
(INCLUDING COVER SHEET)

MESSAGE: Wallcarey MSOS

**RJF INTERNATIONAL CORPORATION
MATERIAL SAFETY DATA SHEET
VICRTEX® - WALLCOVERING***Wallcoverings***1. CHEMICAL PRODUCT & COMPANY IDENTIFICATION**

RJF INTERNATIONAL CORPORATION 3875 Embassy Parkway Fairlawn, OH 44333 Tel: (330) 668-7680	EMERGENCY TELEPHONE NO. : CHEMTREC: (800) 424-9300
TRADE NAME: VICRTEX® - WALLCOVERING	MSDS NUMBER: AN# 5060 Revision 1
CHEMICAL NAME: Polyvinylchloride	SYNONYMS: Flexible Polyvinylchloride
PREPARED BY: Clayton Group Services	DATE OF ISSUE: 10/17/96 DATE OF LATEST REVISION: 03/31/00

2. INGREDIENTS

<u>Component</u>	<u>CAS #</u>	<u>Percent</u>	<u>ACGIH (TLV)</u>	<u>OSHA (PEL)</u>	<u>Units</u>
The product is defined as an article under OSHA's Hazard Communication Standard, 29 CFR 1910.1200. Product contains antimony, barium and zinc compounds. No significant exposure potential exists for these materials except in possible fire situations.		100	Not Est.	Not Est.	Not Est.

3. HAZARDS IDENTIFICATION**EMERGENCY OVERVIEW**

In its manufactured and shipped state the product is considered non-hazardous. Pick up released materials and place in appropriate containers for reuse or disposal. Product involved in fire situations may release toxic combustion products including hydrochloric acid, organic and inorganic materials of unknown composition and toxicity, and metal oxide fumes. Wear appropriate personal protective equipment and keep unnecessary individuals up wind of the area. Cool product in or near fires with a water spray or fog. Any wastes generated during cleanup operations should be evaluated with respect to hazardous and solid waste regulations and disposed of in a properly permitted facility in accordance with all local, state, and federal regulations.

3. HAZARDS IDENTIFICATION (Continued)

POTENTIAL HEALTH EFFECTS:

In its manufactured and shipped state the product is considered non-hazardous. Dusts and/or particulate matter may be generated by mechanical abrasion excessive temperatures. No adverse health effects are expected under normal and expected conditions of use.

Eye: Particulate matter may cause irritation.

Skin Contact: Particulate matter may cause irritation.

Skin Absorption: Not expected to be a route of entry into the body.

Ingestion: Not expected to be a major route of entry. Ingestion of large quantities of particulate matter may cause gastrointestinal distress.

Inhalation: Particulate matter may cause irritation of the mouth, throat, mucous membranes, and respiratory tract.

Chronic & Carcinogenicity: Prolonged contact with dusts and particulate matter that may be generated by mechanical abrasion may cause dermatitis.

The components of the product have not been identified as carcinogens or potential carcinogens. Prolonged exposures to high concentrations of particulate matter may possibly aggravate pre-existing skin and lung disorders.

4. FIRST AID MEASURES

Inhalation: Remove exposed person to fresh air. If breathing is difficult, oxygen may be administered. If breathing has stopped, artificial respiration should be started immediately. Seek medical attention.

Eyes: Flush with tepid water for at least 20 minutes holding the eyelids wide open. Seek medical attention if irritation develops.

Skin: Wash thoroughly with mild soap and water. Seek medical attention if irritation develops. Remove any contaminated clothing and launder thoroughly before reuse.

Ingestion: Not expected to be an important route of entry into the body. If large amounts of particulate matter are ingested it may cause gastrointestinal distress. Seek medical attention.

5. FIRE FIGHTING MEASURES

FLASH POINT: NA LEL: NA UEL: NA AUTO IGN. TEMP.: NA

Use water, dry chemical, or carbon dioxide to extinguish fires involving the product. Product in or near fires should be cooled with a water spray or fog if compatible with the other materials involved in the fire. A self contained breathing apparatus (SCBA) operating in the positive pressure mode and full fire fighting protective clothing should be worn for combating fires.

6. ACCIDENTAL RELEASE MEASURES

Pick up product and return to original packing if reusable. If not reusable, place in DOT approved containers for disposal. Any wastes generated during cleanup operations should be evaluated with respect to hazardous and solid waste regulations and disposed of in a properly permitted facility in accordance with all local, state, and federal regulations.

7. HANDLING AND STORAGE

Store product at ambient temperatures out of contact with the elements. Keep from contact with strong mineral acids and oxidizers. Dusts and/or particulate matter that may be generated during handling or processing should be cleaned up by vacuuming or wet mopping.

8. EXPOSURE CONTROL - PERSONAL PROTECTION

ENGINEERING CONTROLS: Not generally required. If significant amounts of dusts are generated during processing or handling, the need for local exhaust ventilation (LEV) should be evaluated by a professional industrial hygienist. Design details for local exhaust ventilation systems may be found in the latest edition of "Industrial Ventilation: A Manual of Recommended Practice" published by the ACGIH Committee on Industrial Ventilation, P.O. Box 16153, Lansing, MI 48910. Local exhaust ventilation systems should be designed by a professional engineer.

RESPIRATORY: Respiratory protection is not normally required. If appreciable dusts are generated during handling or processing, the operation should be evaluated by a professional industrial hygienist to determine the need for respiratory protection. If respiratory protection is deemed necessary, use, as a minimum, a NIOSH approved 1/2 facepiece respirator equipped with cartridges approved for particulate matter with an exposure limit of not less than 0.05 mg/M³.

EYE PROTECTION: Where eye contact is possible with particulate matter, safety glasses with side shields are recommended.

PROTECTIVE GLOVES: Polymeric gloves are recommended to prevent irritation.

GENERAL: A polymeric coated apron or other body covering is recommended where there is a possibility of regular work clothing becoming contaminated with product dusts. All soiled or dirty clothing and personal protective equipment should be thoroughly cleaned before reuse.

9. PHYSICAL AND CHEMICAL PROPERTIES

APPEARANCE & PHYSICAL STATE: Various
Colors - Vinyl Wall Covering

MELT POINT: ND

VAPOR DENSITY (AIR=1): NA

OCTANOL/WATER PARTITION COEFFICIENT: NA

VAPOR PRESSURE: NA

EVAPORATION RATE B₁₀QAC = 1: NA

ODOR: None

SPECIFIC GRAVITY/BULK DENSITY: 1.4 - 1.5

† VOLATILE BY VOLUME: Not Volatile

BOILING POINT: NA

† SOLUBILITY (H₂O): Insoluble

pH: NA

OTHER: NA

10. STABILITY AND REACTIVITY

STABILITY & POLYMERIZATION: Product is stable. Hazardous polymerization will not occur.

INCOMPATIBILITY (CONDITIONS TO AVOID): Avoid contact with strong mineral acids and oxidizing agents.

HAZARDOUS DECOMPOSITION PRODUCTS: May produce dense smoke, oxides of carbon, hydrochloric acid, low molecular weight organic and inorganic species whose composition and toxicity has not been characterized, and metal oxide fumes.

SPECIAL SENSITIVITY: Polyvinylchloride (PVC) dusts may form weakly explosive mixtures in air. It is, however, highly unlikely that such mixtures can be formed under normal and expected conditions of use and if normal precautions are taken.

11. TOXICOLOGICAL INFORMATION

PVC materials have a very low acute toxicity. PVC materials have an acute LD₅₀ in rats of greater than 10 grams per kilogram of body weight. The product, as with all PVC materials, contains a small amount, <5 ppm, of residual vinyl chloride monomer which has been identified as a human carcinogen. OSHA has established the following exposure limits for vinyl chloride: a 1 ppm 8 hour TWA PEL, a 5 ppm STEL (15 minutes) and a 0.5 ppm AL. Industrial hygiene studies have shown that under normal and expected conditions of use of PVC materials, exposures are well below applicable limits.

12. ECOLOGICAL INFORMATION

Detailed studies have not been conducted concerning the environmental fate of the product. It is, however, not expected to present a hazard to aquatic and terrestrial flora and fauna.

13. DISPOSAL CONSIDERATIONS

The product is not considered hazardous under current EPA hazardous waste regulations. Disposal by recycling is the preferred method of disposal. Alternatively, the product may be disposed of in an approved landfill. All wastes should be evaluated in conjunction with applicable solid and hazardous waste regulations, Toxicity Characteristic Leaching Procedures (TCLP), and disposed of as appropriate.

Empty containers will contain product residues. Observe proper safety and handling precautions. Do not allow empty containers to be used for any purpose except to store and ship original product.

It is the user's responsibility to dispose of all wastes in accordance with all local, state, and federal regulations at properly permitted or authorized facilities.

14. TRANSPORTATION INFORMATION

DOT Classification: Not currently regulated under Department of Transportation regulations.

15. REGULATORY INFORMATION

OSHA Hazard Communication Classification for dusts and fumes and vapors: Irritant, Skin Hazard, Lung Hazard.

SARA Title III Classification for dusts and fumes and vapors: Acute Health Hazard.

The residual vinyl chloride monomer of less than 5 ppm, CAS # 75-01-4, in the product has been listed as a Substance Known to Cause Cancer by the State of California and as an Extraordinarily Hazardous Substance by the State of Massachusetts.

Exposure to vinyl chloride is regulated by OSHA under 29 CFR 1910.1017. Users of the product are urged to obtain and read these standards to determine how their operations may be affected. See Section 11.

WHMIS Classification: Non-hazardous

16. OTHER INFORMATION

Not Est. = Not Established; NA = Not Applicable; ND = Not Determined

HMIS Classifications: Health = 0; Fire = 1; Reactivity = 0

All components of the formulations are included in the Toxic Substances Control Act (TSCA) inventory.

16. OTHER INFORMATION (Continued)

Notice From RJF International. The data in this Material Safety Data Sheet relates only to the specific material designated herein and does not relate to use in combination with any other material or in any process. The opinions expressed herein are those of qualified experts within RJF International. We believe that the information contained herein is current as of the date of issue of this Material Safety Data Sheet. Since the use of this information and these opinions and the conditions of use of the product are not within the control of RJF International, it is the users obligation to determine conditions of safe use of the product.

RJF International requests the users of this product study this Material Safety Data Sheet and become aware of product hazards and safety information. To promote safe use of this product, users should notify their employees, agents, and contractors of the information on this Material Safety Data Sheet and any product hazards and safety information.

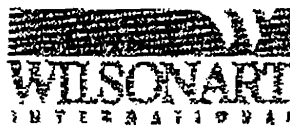

FACSIMILE TRANSMITTAL SHEET

FROM:

Eddie

Jean

COMPANY:

DATE:

3-11-09

FAX NUMBER:

TOTAL NO OF PAGES INCLUDING COVER:

6

PHONE NUMBER:

FAX NUMBER:

RE:

URGENT FOR REVIEW PLEASE COMMENT PLEASE REPLY PLEASE RECYCLE

MSDS *Material Safety Data Sheet*

Wilsonart International



MSDS Number 16439

Wilsonart® High-Pressure Decorative Laminate

Revision Date: 09/15/08

Page 1 of 5

1 PRODUCT AND COMPANY IDENTIFICATION

Common Name Wilsonart® Laminate
 (All Grades and Thicknesses)

Manufacturer WILSONART INTERNATIONAL, INC.
 P. O. BOX 6110 - 2400 WILSON PLACE
 TEMPLE, TX 76603
 INFORMATION PHONE: 800-433-3222 (USA)

Trade Name High-Pressure Decorative Laminate (HPDL)
 (All Grades & Thicknesses Including High-Pressure Backers)

Material Uses Decorative Laminate

Revision # 15

In Case of Emergency Contact:

CHEMTREC: 800-424-9300 (USA)
 703-527-3887 (INTERNATIONAL)

2 HAZARDS IDENTIFICATION

Route of Entry: None for product as sold. For dust or chips generated during fabrication operations: eye contact, skin contact, and inhalation

Target Organs: None

Inhalation: No hazard for product as sold. Fabrication operations such as milling, cutting, grinding, etc., may produce dust or fines that may be irritating.

Skin Contact: Solid sheet may be abrasive to, or cut skin. Fabrication operations such as milling, cutting, grinding, etc., may produce dust or fines that may be irritating.

Eye Contact: No hazard for product as sold. Fabrication operations such as milling, cutting, grinding, etc., may produce dust or fines that may be irritating.

Ingestion: Not an expected route of entry

HMIS (United States):	
Health	0
Flammability	1
REACTIVITY	0
PPE	B

NFPA (United States):

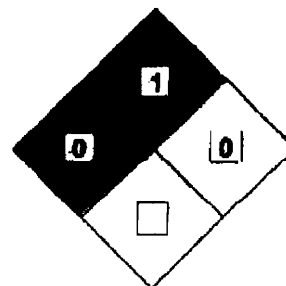

WHMIS (Canada): Not classified as hazardous

MSDS Material Safety Data Sheet

Wilsonart International



MSDS Number: 16439

Wilsonart® High-Pressure Decorative Laminate

Revision Date: 09/15/08

Page 2 of 5

3 COMPOSITION/INFORMATION ON INGREDIENTS

Name	CAS #	% by Weight
Cellulose	9004-34-6	25 – 85
Formaldehyde resins	Not Applicable	10 – 50

4 FIRST AID MEASURES

Inhalation: No hazard for product as sold. Fabrication operations such as milling, cutting, grinding etc., may produce dust or fines that may be irritating to the respiratory tract. If irritation persists, seek medical attention.

Skin Contact: Solid sheet may be abrasive to, or cut skin. Fabrication operations such as milling, cutting, grinding, etc., may produce dust or fines that may be irritating. May aggravate existing skin conditions. Wash with soap and water. If irritation persists, seek medical attention.

Eye Contact: No hazard for product as sold. Fabrication operations such as milling, cutting, grinding, etc. may produce dust or fines that may be irritating to the eyes. Rinse eyes with water for 15 minutes. If irritation persists, seek medical attention.

Ingestion: Not an expected route of entry with normal product use

5 FIRE FIGHTING MEASURES

Flash Point: Not Applicable.

Flash Point Method: Not Applicable

Burning Rate: Not Available.

Autoignition Temperature: Not Available.

Fire and Explosion Hazard: No hazard for product as sold. Fabrication operations such as milling, cutting, grinding, etc., may produce dust. Dust, in adequate concentrations and under certain conditions may present an explosion hazard.

Use extinguishing media appropriate for surrounding fire. Use self-contained breathing apparatus and protective clothing appropriate for surrounding fire.

Hazardous products of combustion include and carbon oxides (CO and CO₂)

6 ACCIDENTAL RELEASE MEASURES

Small Spill or Leak: Not Applicable.

Large Spill or Leak: Not Applicable

7 HANDLING AND STORAGE

Handling Precautions: No specific usage precautions required. Follow normal good hygiene practices. Protect exposed skin from cuts and abrasions.

Storage Requirements: Store in a dry well-ventilated area.

8 EXPOSURE CONTROLS / PERSONAL PROTECTION

Engineering Controls: No special ventilation requirements for product as sold. Provide adequate ventilation to meet exposure guidelines if fabrication operations generate dust or fines.

Protective Equipment: Respirators – No specific recommendations. Respiratory protection must be used if the OSHA Permissible Exposure Limit for laminate dust (Particulate Not Otherwise Regulated – PNOR) is exceeded.

MSDS Material Safety Data Sheet

Wilsonart International



MSDS Number: 16439

Wilsonart® High-Pressure Decorative Laminate

Revision Date: 09/15/08

Page 3 of 5

Protective Gloves – Gloves suitable for protection against cuts and abrasions from sharp edges are recommended

Eye Protection – Wear safety glasses with side shields during fabrication operations that produce chips, fines, or dust.

Exposure Guidelines / Other:

Product Name**Exposure Limits**

Laminate Dust (Particulate Not Otherwise Regulated – PNOR)

OSHA PEL: TWA 5 mg/m³ (respirable) TWA 15 mg/m³ (total)ACGIH TLV: TWA 3 mg/m³ (respirable) TWA 10 mg/m³ (inhalable)

Consult local authorities and regulations for exposure limits.

9 PHYSICAL AND CHEMICAL PROPERTIES

Appearance:	Solid Sheet, various colors and thicknesses		
Physical State:	Solid	Boiling Point:	Not Applicable
Odor:	None	Freezing / Melting point:	Not Applicable
pH:	Not Applicable	Solubility:	Insoluble in water
Vapor Pressure:	Not Applicable	Specific Gravity / Density:	Approx. 85 lbs/ft ³
Vapor Density:	Not Applicable	Viscosity:	Not Applicable
VOC:	Not Applicable		

10 STABILITY AND REACTIVITY

Stability: This product is stable

Conditions to Avoid: None.

Materials to Avoid (Incompatibility): None.

Hazardous Decomposition Products: Carbon Oxides (CO CO₂)

Hazardous Polymerization: Will not polymerize

11 TOXICOLOGICAL INFORMATION

Toxicity to Animals: This product has not been tested for animal effects. This product is not expected to be toxic to animals.

Toxicity to Humans: This product has not been tested for human effects. This product is not expected to be toxic to humans.

12 ECOLOGICAL INFORMATION

Ecotoxicity: Not Available. Not expected to be ecotoxic

BOD5 and COD: Not Available

Biodegradable / OECD: Not Available

Mobility: Not Available

Toxicity of the Products of Biodegradation: Not Available

Special Remarks on the Products of Biodegradation: Not Available

13 DISPOSAL CONSIDERATIONS

Not classified as hazardous waste. Dispose of in accordance with Federal, State, and local regulations.

MSDS *Material Safety Data Sheet*

Wilsonart International



MSDS Number: 16439

Wilsonart® High-Pressure Decorative Laminate

Revision Date: 08/15/08

Page 4 of 6

14 TRANSPORT INFORMATION

Restrictions: None known.

DOT Requirements: Not a DOT controlled material (United States)

ADR Requirements: Not an ADR controlled material (Europe)

IMDG Requirements: Not an IMDG controlled material

IATA Requirements: Not an IATA controlled material

Marine Pollutant: Not a marine pollutant.

15 REGULATORY INFORMATION

U.S. Federal Regulations

TSCA inventory: The chemicals in this product are listed.

SARA 302/304/322/312 Extremely hazardous substances: None

SARA 302/304 Emergency planning and notification: None

SARA 302/304/311/312 Hazardous chemicals: None.

SARA 311/312 MSDS distribution, chemical inventory, hazard identification: None

SARA 313 Toxic chemical notification and release reporting: None

CWA 307: None.

CWA 311: None.

CAA 112 Accidental release prevention: None.

CAA 112 Regulated flammable substances: None

CAA 112 Regulated toxic substances: None.

International Regulations

DSL (Canada): None

EINECS: None.

WHIMS: Not classified as hazardous

State Regulations

Massachusetts RTK: None.

Minnesota RTK: None.

New Jersey RTK: None.

Pennsylvania RTK: None

Rhode Island RTK: None.

California Proposition 65: This product contains the following components known to the state of California to cause cancer, and/or developmental toxicity and/or reproductive toxicity:

Formaldehyde (CAS 50-00-0) in trace amounts

16 OTHER INFORMATION

References

Lewis, R. J., *Rapid Guide to Hazardous Chemicals in the Workplace*, 4th ed., Wiley-Interscience, New York, 2000.

NIOSH Pocket Guide to Chemical Hazards, Department of Health and Human Services, National Institute for Occupational Safety and Health, 2007.

Patty's Toxicology, 5th ed. John Wiley & Sons, Inc. 2001.

TLVs and BEIs, Threshold Limit Values for Chemical Substances and Physical Agents & Biological Exposure Agents, ACGIH Worldwide, Cincinnati, 2007.

Glossary

ACGIH – American Conference of Governmental Industrial Hygienists

MSDS *Material Safety Data Sheet*

Wilsonart International



MSDS Number: 16438

Wilsonart® High-Pressure Decorative Laminate

Revision Date: 09/15/08

Page 5 of 5

ASTM – American Society for Testing and Materials
ADR – Agreement on Dangerous Goods by Road (Europe)
BOD5 – Biological Oxygen Demand in 5 days
CAA – Clean Air Act
CAS – Chemical Abstracts Services
CEPA – Canadian Environmental Protection Act
CERCLA – Comprehensive Environmental Response, Compensations and Liability Act
CFR – Code of Federal Regulations
CWA – Clean Water Act
DOT – Department of Transportation
DSCL – Dangerous Substances Classification and Labeling (Europe)
DSL – Domestic Substance List (Canada)
EEC/EU – European Economic Community/European Union
EINECS – European Inventory of Existing Commercial Chemical Substances
HCS – Hazard Communication System
HMIS – Hazardous Material Information System
IARC – International Agency for Research on Cancer
LD50/LC50 – Lethal Dose/Concentration kill 50%
LDLo/LGLo – Lowest Published Lethal Dose/Concentration
NFPA – National Fire Prevention Association
NIOSH – National Institute for Occupational Safety & Health
NTP – National Toxicology Program
OSHA – Occupational Safety & Health Administration
PEL – Permissible Exposure Limit
RCRA – Resource Conservation and Recovery Act
SARA – Superfund Amendments and Reorganization Act
STEL – Short Term Exposure Limit (15 minutes)
TDG – Transportation of Dangerous Goods (Canada)
TLV-TWA – Threshold Limit Value-Time Weighted Average
TSCA – Toxic Substances Control Act
WHMIS – Workplace Hazardous Material Information System

CHEMTREC:
800-424-9300 (USA)
703-527-3887 (International)

Notice to Reader

To the best of our knowledge, the information contained herein is accurate. However, neither the above named manufacturer nor any of its subsidiaries assumes any liability whatsoever for accuracy or completeness of the information contained herein.

Final determination of suitability of any material is the sole responsibility of the user. All materials may present unknown hazards and should be used with caution. Although certain hazards are described herein, we cannot guarantee that these are the only hazards that exist.

END OF MSDS DOCUMENT

REVIEWED FOR DESIGN CONFORMANCE ONLY

APPROVAL FOR THESE PLANS BY DUNKIN' BRANDS DOES NOT IMPLY THAT DUNKIN' BRANDS HAS REVIEWED THEM FOR CONFORMITY TO APPLICABLE CODES OR REGULATIONS

APPROVED
 APPROVED AS NOTED: Submit Record Copy for Archives
 DISAPPROVED AS NOTED: Revise and Resubmit
 INCOMPLETE INFORMATION: Add requested information and resubmit

DUNKIN' BRANDS QSR
Construction Manager

Notes:

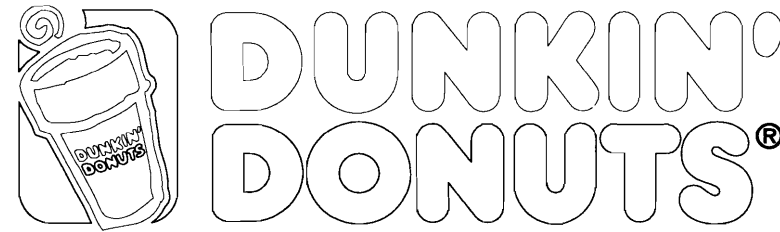

ADDRESS:
1378 WASHINGTON AVENUE
PORTLAND, MAINE

OWNER:
E.S.W. REALTY, LLC
1378 WASHINGTON AVENUE
PORTLAND, MAINE

*Not This Architect
Wrong #
Taylor 978-887-8486*

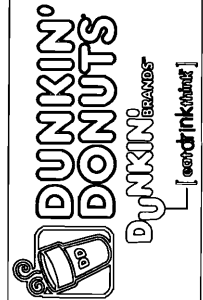

JDS DESIGN SERVICES LLC
860 CANAL STREET
STAMFORD, CT 06902



NO.	DESCRIPTION	BY	DATE
1	INITIAL ISSUE	JS	1/14/09

JOB LOCATION:
PORTLAND, ME
1378 WASHINGTON AVENUE

TITLE SHEET;
ARCHITECTURAL DATA

SHEET
T1

FILE #: 304697 JDS08049
DATE: 01/14/09
PROJ. MGR. J.R.
C.M. W. GLYNN

ABBREVIATION INDEX					
•	AND	GA.	GAUGE	Q.T.	QUARRY TILE
•	AT	GALV.	GALVANIZED	QTY.	QUANTITY
A/C	AIR CONDITIONING	GYP. BD.	GYP. BOARD	R.A.	RADIUS
A.D.	AREA DRAIN	H.W.D.	HARDWOOD	RAD.	RADIUS
A.F.F.	ABOVE FINISH FLOOR	HDR.	HEADER	REF.	REFRIGERATOR
ALUM.	ALUMINUM	H.M.	HOLLOW METAL	RENF.	REINFORCING
ALT.	ALTERNATE	HORIZ.	HORIZONTAL	REV.	REVISION
APPROX.	APPROXIMATE	HGT.	HEIGHT	REQ'D	REQUIRED
BD.	BOARD	I.D.	INSIDE DIAMETER	RESIL.	RESILIENT
BLDG.	BUILDING	INSUL.	INSULATION	RM.	ROOM
BM.	BEAM	INT.	INTERIOR	R.O.	ROUGH OPENING
BSMT.	BASEMENT	JT.	JOINT	SCHED.	SCHEDULE
BTWN.	BETWEEN	KIT.	KITCHEN	SEC.	SECTION
BOT.	BOTTOM	LAM.	LAMINATE	S.F.	SQUARE FOOT
C.L.	CENTER LINE	LAV.	LAVATORY	SHT.	SHEET
C.T.	CERAMIC TILE	LT.	LIGHT	SIM.	SIMILAR
CLG.	CEILING	MAS.	MASONRY	SPEC.	SPECIFICATION
CLOS.	CLOSE	MAX.	MAXIMUM	SQ.	SQUARE
CM	CONSTRUCTION MGR.	MECH.	MECHANICAL	S.S.	STAINLESS STEEL
CMU	CONC. MASONRY UNIT	MFL.	METAL	STD.	STANDARD
COL.	COLUMN	MFR.	MANUFACTURER	STL.	STEEL
CONC.	CONCRETE	MN.	MINIMUM	STRUCT.	STRUCTURAL
CONT.	CONTINUOUS	MISC.	MISCELLANEOUS	SUSP.	SUSPENDED
CONST.	CONSTRUCTION	M.O.	MASONRY OPENING	TEL.	TELEPHONE
DEPT.	DEPARTMENT	MTD.	MOUNTED	THK.	THICK
DTL.	DETAIL	N.I.C.	NOT IN CONTRACT	THRU	THROUGH
D.F.	DRINKING FOUNTAIN	NO.	NUMBER	T.O.P.	TOP OF PLATE
DIA.	DIAMETER	NOM.	NOMINAL	T.O.S.	TOP OF STEEL
DIM.	DIMENSION	N.T.S.	NOT TO SCALE	T.O.SL.	TOP OF SLAB
DISP.	DISPENSER	O.A.	OVERALL	TRT.	TREATED
DN.	DOWN	O.C.	ON CENTER	TYP.	TYPICAL
DR.	DOOR	O.D.	OUTSIDE DIAMETER	V.C.B.	VINYL COMPOSITION BASE
D.S.	DOWN SPOUT	OPNG.	OPENING	V.C.T.	VINYL COMPOSITION TILE
DWG.	DRAWING	OPT.	OPTIONAL	VERT.	VERTICAL
EA.	EACH	PL.	PLATE	V.I.F.	VERIFY IN FIELD
EL.	ELEVATION	P.LAM.	PLASTIC LAMINATE	V.W.C.	VINYL WALL COVERING
ELEC.	ELECTRICAL	PLUMB.	PLUMBING	W/	WITH
EQ.	EQUAL	PL.WOOD.	PLYWOOD	W.C.	WATER CLOSET
EQUIP.	EQUIPMENT	PR.	PAIR	WD.	WOOD
EXIST.	EXISTING	PROP.	PROPERTY	W/O	WITHOUT
EXT.	EXTERIOR	P.S.F.	PER SQUARE FOOT	WP.	WATERPROOFING
F.D.	FLOOR DRAIN	P.S.I.	PER SQUARE INCH	WT.	WEIGHT
FIN.	FINISH	PTD.	PAINTED	WWM.	WELDED WIRE MESH
FL.	FLOOR	P.V.C.	POLY VINYL CHLORIDE		
F.O.	FACE OF				
FT.	FOOT				
FURN.	FURNITURE				

INDEX OF DRAWINGS	
T1	TITLE SHEET/ ARCHITECTURAL DATA
T1.1	NATIONAL ACCOUNT INFO
A1	FLOOR PLAN; SCHEDULE; DETAILS EQUIPMENT SCHEDULE
A2	REFLECTED CEILING PLAN; LEGEND; DETAILS
A3	INTERIOR ELEVATIONS; SCHEDULES; DETAILS
A4	EXTERIOR ELEVATIONS; SCHEDULE

ADA STATEMENT

I HEREBY CERTIFY THAT THE PLANS AND DRAWINGS FOR THIS PROJECT WERE DRAWN IN ACCORDANCE WITH ALL FEDERAL, STATE AND LOCAL LAWS, INCLUDING, BUT NOT LIMITED TO, THE AMERICANS WITH DISABILITIES ACT (THE "ADA"), THE ADA ACCESSIBILITY GUIDELINES AND ANY STATE OR LOCAL ACCESSIBILITY CODES, REGULATIONS, OR STANDARDS

ARCHITECT'S SIGNATURE HERE _____ Date: _____

- DUNKIN' BRANDS REFERENCES
- DUNKIN' BRANDS SPECIFICATION BOOK (ISSUED 1/31/98)
 - NATIONAL ACCOUNT SOURCE INFORMATION BOOKLET (ISSUED 6/13/01)
 - DUNKIN' BRANDS EQUIPMENT SPECIFICATION BINDER (ISSUED 6/97)
 - 1999 FDA FOOD CODE (ISSUED 1999)

EXISTING BUILDING DATA	
USE GROUP:	A3
TYPE OF CONSTRUCTION:	TYPE 5B
STORIES:	1
ALLOWABLE FLOOR AREA:	4200 S.F.
ACTUAL FLOOR AREA:	2196 S.F.
OCCUPANCY LOAD:	
FIXED SEATS:	19 PERSONS
EMPLOYEES:	5 PERSONS
TOTAL OCCUPANCY:	24 PERSONS
FLAME SPREAD:	
FREEZER CORE MATERIAL:	25
FREEZER METAL PANEL:	25
SMOKE DEVELOPMENT RATINGS:	
FREEZER CORE MATERIAL:	250
FREEZER METAL PANEL:	OVER 500
BASED ON THE FOLLOWING CODES	
BOCA NATIONAL CODE - 1996	

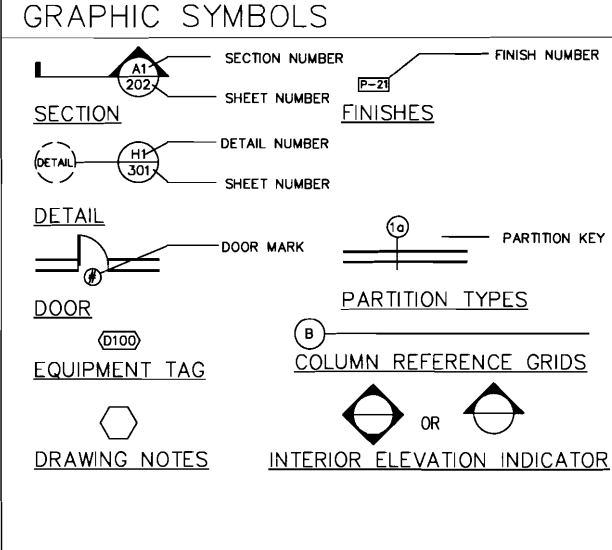

MATERIAL	FLAME SPREAD RATING	SMOKE DEVELOPMENT
FIBERGLASS REINFORCED PANELS	175	135
VINYL WALL COVERING	5	5
PLASTIC LAMINATE	30	200
ENAMEL PAINT (ON TRIM, DOOR FRAMES, WOOD SHELVING)	5	
WOOD STAIN (NATURAL WOOD SURFACES)	5	
CLEAR SEALER (NATURAL WOOD DOORS)	5	
ACOUSTICAL CEILING TILES	23	

DUNKIN' BRANDS DATA	
STORE DIMENSIONS: (EXISTING)	SQ. FOOTAGE
RETAIL SERVICE AREA	# SQ. FT.
SEATING AREA	# SQ. FT.
PREP AREA	# SQ. FT.
STORAGE/ REST ROOM/ OFFICE AREA	# / # / # SQ. FT.
WALK IN FREEZER	# SQ. FT.
WALK IN COOLER AREA	# SQ. FT.
FREEZER/ COOLER COMBO AREA	# SQ. FT.
TOTAL:	#### SQ. FT.
REST ROOMS: (EXISTING)	NUMBER
NUMBER OF RESTROOMS	1
PUBLIC ACCESS TO REST ROOMS	Y N
HANDICAP ACCESSIBLE	Y N
DRIVE-THRU: (EXISTING)	NUMBER
YES/NO	YES
NUMBER OF DRIVE THRU WINDOWS	#
MENU BOARD SIZE (SINGLE, COMBO)	T.B.D.
CAR LENGTHS FROM MENU TO WINDOW	#
STACKING (TOTAL # OF VEHICLES)	SEE SITE BY OTHERS
ESCAPE LANE	BY SITE ENG.
DRIVE THRU TIMER SYSTEM	BY DUNKIN' DONUTS

EXISTING BUILDING DATA	
SEATING: (EXISTING)	
# OF TABLES	5
# OF SEATS	18
# OF BARRIER FREE SEATING UNITS	1
STAND UP COUNTERS (Y/N)	N (Y)
TOTAL # OF SEATS	19
IMAGE TYPE:	
SINGLE BRAND / COMBO	DD BR DD/BR DD
SIGNAGE: (EXISTING SIGNAGE TO BE REMOVED AND REPLACED W/ NEW SIGNS W/ EQUAL SQUARE FOOTAGE)	
TYPE	SQ. FOOTAGE DIMENSIONS
FASCIA STACKED CLOUD	17 S.F. DO NOT EXCEED EXISTING SIGNAGE S.F.
FASCIA STACKED CLOUD	17 S.F. DO NOT EXCEED EXISTING SIGNAGE S.F.
PYLON /MONUMENT	22 S.F. DO NOT EXCEED EXISTING SIGNAGE S.F.
SITE DIRECTIONAL	SEE SITE PLAN BY OTHERS, AND OWNER
NOTE: ALL SIGNAGE SUBJECT TO APPROVAL BY TOWN AND LANDLORD.	
NOTE: OWNERS SIGN MANU. TO FIELD VERIFY ALL EXISTING SIGN SIZES AND MATCH NEW SIGNS W/ EXISTING SQUARE FOOTAGE.	
WALK IN FREEZER/ COOLER: (EXISTING)	
REMOTE COMPRESSORS REQUIRED	Y (N)
DISTANCE FROM COMPRESSOR TO BOX	(EXISTING)

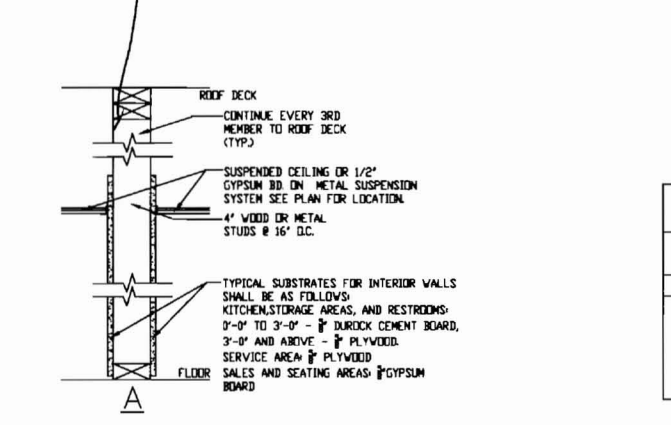
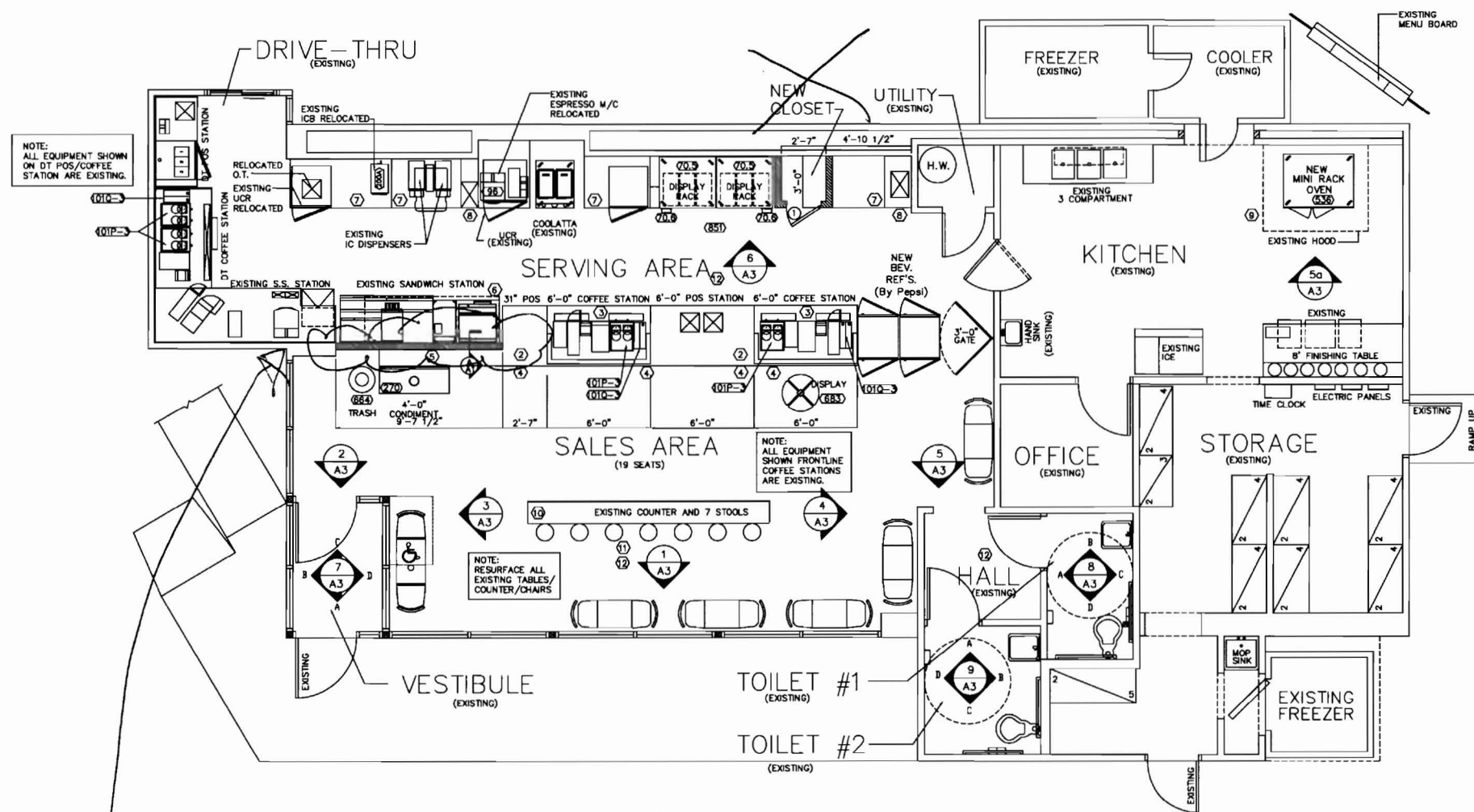

FLOOR PLAN
SCALE: 1/4" = 1'-0"

DOOR SCHEDULE										
NO.	DOOR DATA			FINISH		FRAME DATA		FINISH		NOTES
	LOCATION	SIZE	MATERIAL	TYPE	INT	EXT	MATERIAL	TYPE	INT	
1	CLOSET	2'-0" x 6'-6" x 12"	WOOD	C	NOTE #2	HM.	1	P-63	1,2,3	

1. FINISH TO BE 61-28 OVER 61-27
 2. UNDERCUT DOOR 1"
 3. REFER TO DUNKIN' BRANDS SPECIFICATIONS FOR HARDWARE SCHEDULE FOR ALL DOORS

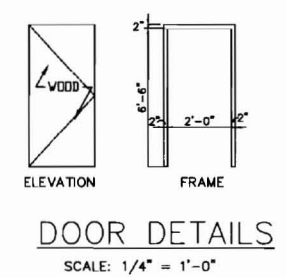

PARTIAL EQUIPMENT SCHEDULE (NEW EQUIPMENT ONLY)																	
ITEM NO.	QTY.	DESCRIPTION	EQUIPMENT			PLUMBING				ELECTRICAL				GENERAL REMARKS			
			MANUFACTURER	MODEL NO.	N.S.F. E.T.L.	U.L. E.T.L.	WATER HW	WASTE CW	DR.	IND.	REMARKS	LOAD			RECEPTACLE SPEC	A.F.F.	REMARKS
				VOLTS	PHASE	AMPS	CIRCUIT SIZE	# BRK BY MINIMUM	WIRE BY CODE & PLAN								
70.5	2	BAKERY DISPLAY RACK (16 BASKETS)	LAKESIDE	DD-3635-78B						120V	1		20			37"W x 33"D x 76"H	
70.6	2	REMOVABLE TISSUE BAG DISPENSER	LAKESIDE	114591													
101P-3	4	AXIOM TWIN COFFEE BREWER	BUNN-O-MATIC	38700.0030				YES		120/208	1	29.6	40	4	NO	NEMA 14-50R OR L14-50R	CORD AND PLUG PROVIDED BY ELECTRICAL CONTRACTOR
101O-3	3	MULTI HOPPER GRINDER AND STORAGE SYSTEM	BUNN-O-MATIC	35600.0011						120	1	11	10	3	NO	NEMA 5-15P	CORD AND PLUG PROVIDED BY ELECTRICAL CONTRACTOR
270	1	48" W X 20" D SELF SERVE CONDIMENT STATION	EQUIPMENT SUPPLIER	DWG #270													
536	1	MINI RACK OVEN, GAS	BAXTER	DV3000				1"	1"			15	20		NO		BOTTOM REAR RT. ELEC. CONNECTION 1" - 120/90/1/15 A DED., HARD WIRED TO DISCONN.
664	1	TRASH RECEPTACLE	UNITED RECEPTACLE	A0135SA PL													
683	1	ROUND DISPLAY MERCHANDISER	EQUIPMENT SUPPLIER	DWG #683													
851	1	28" MAIN ST MENU 6 PANEL 4 PANELS + 2 COMBO FLIP FRAMES	POSTERLOID	DD-NGN-28-6													

- ### GENERAL NOTES
- GENERAL CONTRACTOR SHALL REFER TO WRITTEN SPECIFICATIONS FOR ADDITIONAL INFORMATION NOT CONTAINED IN THE DRAWINGS.
 - REFER TO THE 'K' DRAWING(S) FOR INFORMATION REGARDING THE EQUIPMENT AND EQUIPMENT LAYOUT.
 - GENERAL CONTRACTOR TO PROVIDE FOR P.O.S SYSTEM AS SHOWN ON ELECTRICAL DRAWINGS OR, AT A MINIMUM THE FOLLOWING CONDUITS:
 - 2 1/2" I.D. CONDUIT FROM 44443 JUNCTION BOX LOCATED BEHIND OFFICE DESK UP WALL TO ABOVE CEILING.
 - FROM A HUB IN THE FRONT LINE CHASE UNDER SLAB TO BACK WALL PROVIDE A 2 1/2" CONDUIT WITH 2"-0" SWEEPS AT ENDS. TERMINATE ABOVE THE CEILING.
 - 1" I.D. CONDUIT FROM BEHIND THE DRIVE THRU CASH STATION UP WALL TO ABOVE CEILING, USE 2"-0" SWEEPS AT BOTTOM TO SIDE NEAREST FRAME WALL IF WINDOW BEHIND PROVIDING CHASE AS REQUIRED SO NO WIRING BENDS LESS THAN 2"-0" RADIUS.
 - 2"x4" ELECTRICAL BOX 6'-0" A.F.F. WITH 1" CONDUIT IN WALL TO ABOVE CEILING, CENTER 32"x32"x3/4" PLYWOOD BLOCKING IN WALL FOR YOU UNIT. NOTE THAT THE MAXIMUM CONNECTION LENGTH BETWEEN A WOU(S) AND ITS DEDICATED CPU IS 75'-0" AND ONE TELEPHONE JACK IN OFFICE TO BE AN ISDN LINE. NOTIFY DUNKIN' DONUTS IF NOT REGIONALLY AVAILABLE.
 - NOTE: 12-0" I.D. ALL POWER OUTLETS FOR P.O.S. DEVICES ARE REQUIRED TO BE 12-0" I.D. STRUT CHANNEL DESIGN, ADA COMPLIANCE REQUIREMENTS FROM ALL OTHER GROUND WIRES, RUNNING BACK TO THE BUILDING MAIN OR COMPLEX POWER PANEL. NEMA STANDARD L5-15R I.G. FOR RECEPTACLE AND PLUG. USE OF 10 DUPLEX OR 10 COMPLEX OUTLETS: (I.E., HUBBELL IG-5262, IG-5362 OR EQUIVALENT).
 - PROVIDE WATER FILTRATION SYSTEM (BRANCH OFF MAIN LINE) FOR COFFEE BREWING EQUIPMENT, ICE MACHINES, POST MIX.
 - ALL TABLES TO BE FREE STANDING EXCEPT FOR THOSE SHOWN w/ TABLE BASES, WHICH SHALL BECOME DRILLED. SEE DETAIL.
 - THESE PLANS ARE BASED ON MINIMUM DUNKIN' BRANDS CORPORATE DESIGN REQUIREMENTS FOR STRUCTURAL DESIGN, FOOTING DESIGN, ADA COMPLIANCE AND GENERAL BUILDING REQUIREMENTS HAVE BEEN EVALUATED TO MEET ALL ADA STATE AND LOCAL CODES.
 - OWNER'S MECHANICAL CONTRACTOR SHALL BE RESPONSIBLE FOR REVIEWING EXISTING HVAC EQUIPMENT AND MODIFYING AS REQUIRED BY NEW HEATING & COOLING LOADS. SUBMIT SHOP DRAWINGS FOR ARCHITECT APPROVAL BEFORE ORDERING EQUIPMENT OR BEGINNING WORK.

- ### FLOOR PLAN KEY NOTES
- NOT USED.
 - EXISTING FRONT LINE POS/CASH STATION TO REMAIN. RESURFACE W/ NEW FINISH SEE FINISH MATERIAL SCHEDULE.
 - EXISTING FRONT LINE COFFEE STATIONS TO REMAIN. RESURFACE TOPS W/ STAINLESS STEEL BY OWNERS MILLWORK SUPPLIER.
 - RESIN & RELAMINATE EXISTING CASH AND POS STATIONS BY SPECTRUM AS PER NEW 2008 DESIGN RELEASE.
 - NEW FULL HEIGHT WALL UP TO ABOVE EXISTING SUSPENDED CEILING. BRACE WALL TO ABOVE STRUCTURE, FINISH WITH NEW DD MURAL. SEE A3 SHEET.
 - NEW HOOD ABOVE EXISTING SANDWICH STATION LOCATION.
 - EXISTING MILLWORK BASE TO REMAIN. RESURFACE W/ NEW SS TOPS BY OWNERS MILLWORK SUPPLIER. MILLWORK CONTRACTOR TO VERIFY ALL EXISTING SS TOPS TO BE RESURFACED.
 - EXISTING HAND SINK LOCATIONS TO REMAIN. RESURFACE W/ NEW SS TOPS MILLWORK SUPPLIER. MILLWORK CONTRACTOR TO VERIFY ALL EXISTING SS TOP TO BE RESURFACED.
 - NO WORK IN KITCHEN EXCEPT REPLACING BAGEL OVEN WITH NEW MINI RACK OVEN.
 - RESURFACE EXISTING HIGH SEATING COUNTER TOP TO MATCH NEW TABLE TOP FINISH AND RE-UPHOLSTER STOOLS. SEE FINISH MATERIAL SCHEDULE.
 - EXISTING SOOL BASES TO REMAIN REUPOLSTER EXISTING STOOL TOPS
 - EXISTING FLOOR TILE TO REMAIN, PATCH AND MATCH DAMAGES AREAS

WALL FINISH MATERIAL SCHEDULE

CODE	MATERIAL	MANUFACTURER	PRODUCT NO.	DESCRIPTION/REMARKS
B-41	COVE BASE	CREATIVE MATERIALS CORP.	107 BOULEVARD	6"x6"
B-50	VINYL COVE BASE	ARMSTRONG WORLD INDUSTRIES	08 BUTTERCREAM	STANDARD INSTALL 6" H. USE WITH T-50
B-50 ALT.	TILE BASE	CREATIVE MATERIALS CORP.	COFFEE	SECOND PREFERRED INSTALL: 12"x12" FLOOR TILE CUT IN HALF. USE WITH T-50
B-50 ALT. 2	COVE BASE	CREATIVE MATERIALS CORP.	COFFEE	THIRD PREFERRED INSTALL: 6"x6" - USE WITH T-50 BEHIND REFRIG.
B-63	VINYL COVE BASE	ARMSTRONG WORLD INDUSTRIES	71 MID GRAY	REMODELS ONLY: 6" H. 1/2" GAUGE. USE WITH EX. GRAY TILE
FRP-22	FRP PANELS	CRANE/REMUTE	85	KITCHEN, STORAGE, AND OFFICE WALLS
FRP-22 ALT.	FRP PANELS	MARLITE	P-100 WHITE	KITCHEN, STORAGE, AND OFFICE WALLS
FRP-33	FRP PANELS	CRANE/REMUTE	866 PARCHMENT	4" X 4" SCORED PANELS: 7'-4 1/2" FOR UPGRADE
FRP-33 ALT.	FRP PANELS	MARLITE	C118-G44 ALMOND	4" X 4" SCORED PANELS: 7'-4 1/2" FOR UPGRADE
G-31	GROUT	LATICRETE	#43	CHOCOLATE TRUFFLE; USE T-36
G-38	GROUT	HYDROMENT	#179	BAMBOO; USE W/ T-45 IN SERVICE AREA ONLY
P-67	PAINT	BENJAMIN MOORE	FRUIT PUNCH #140	SOFFITS
P-67 ALT.	PAINT	SHERWIN WILLIAMS	INVIGORATE SW6886	SOFFITS
P-68	PAINT	BENJAMIN MOORE	IMPERIAL YELLOW	ENTRY FASCIA/VESTIBULE/SOFFITS
P-68 ALT.	PAINT	SHERWIN WILLIAMS	BUTTERFIELD SW6676	ENTRY FASCIA/VESTIBULE/SOFFITS
P-69	PAINT	BENJAMIN MOORE	FRESH BREW #1232	DOOR FRAME
P-69 ALT.	PAINT	SHERWIN WILLIAMS	FRENCH ROAST SW6082	DOOR FRAME
PX-30	PAINT	BENJAMIN MOORE	REGAL AD. GLOW #333	BMO1 READY MIX WHITE-FLAT
PX-30 ALT.	PAINT	SHERWIN WILLIAMS	EXTRA WHITE SW2008	FLAT
PL-26	PLASTIC LAMINATE	FORMICA	459-58	BRITE WHITE - MILLWORK
PL-43	PLASTIC LAMINATE	WILSONART	7922-7	BRIGHTON WALNUT-MILLWORK ONLY
ST-26	POLYURETHANE	BENJAMIN MOORE (BENMOO)	#423-LOW LUSTRE	3 COATS OVER ST-27
ST-26 ALT.	POLYURETHANE	SHERWIN WILLIAMS	A68 SERIES	3 COATS OVER ST-27
ST-27	STAIN	BENJAMIN MOORE	MATCH PL-43	OVER FINISH TRIM, CHAIR RAIL, NO. DOORS (2 COATS)
ST-27 ALT.	STAIN	SHERWIN WILLIAMS	SW-BW	OVER FINISH TRIM, CHAIR RAIL, NO. DOORS (2 COATS)
T-45	WALL TILE	CREATIVE MATERIALS CORP.	7770 ROYAL WOSA: 6"x6" 1/2" GAUGE	OVER FINISH TRIM, CHAIR RAIL, NO. DOORS (2 COATS) ALT TO FR-33 6" H. USE W/ T-38 IN SERVICE AREA
T-57	WALL TILE	CREATIVE MATERIALS CORP.	7770 ROYAL WOSA: 6"x6" 1/2" GAUGE	ALTERNATE ACENT TILE - UPGRADE
WC-30	WALL COVERING	APA COLOR GRAPHICS	ORANGE JUMBLE	SALES AREA ABOVE CHAIR RAIL
WC-30S	WALL COVERING	APA COLOR GRAPHICS	ORANGE JUMBLE	BEHIND MENU BOARDS
WC-31	WALL COVERING	APA COLOR GRAPHICS	BROWN JUMBLE	BELOW CHAIR RAIL ONLY
WC-34	WALL COVERING	APA COLOR GRAPHICS	DO MURAL	4 PANEL SET ABOVE CHAIR RAIL ON FOCAL WALL
WC-34X	WALL COVERING	APA COLOR GRAPHICS	DO MURAL X	EXTENDED 4 PANEL SET FOR CEILING
WC-35	WALL COVERING	APA COLOR GRAPHICS	YELLOW JUMBLE	SALES AREA ABOVE CHAIR RAIL AND IN RESTROOMS
WC-35S	WALL COVERING	APA COLOR GRAPHICS	YELLOW JUMBLE	SALES AREA ABOVE CHAIR RAIL AND IN RESTROOMS
WC-36	WALL COVERING	APA COLOR GRAPHICS	PICK UP STATION COGRAPHIC	TO BE INSTALLED ON FRONT FACE OF PICK UP STATION. CENTER OVER HORIZONTAL CENTER LINE. SEE DETAIL.

ARCHITECT MUST PROVIDE A COMPLETE SET OF FINISH ELEVATIONS DEPICTING ALL WALLS INCLUDING ALL RETURN, SOFFIT, ETC. WALL WALL COORDINATIONS. ALL ELEVATIONS TO BE DRAWN TO SCALE, WITH NO BREAK LINES.
 NOTE: PROVIDE BRUSHED ALUM. CORNER GUARDS AT ALL OUTSIDE CORNERS OF SALES AREA WALLS.
 SEE: FOR LOCATION OF SPECIFIC COLORS AND MATERIALS ON SEE WALL COVER SCHEDULES SHEET A-111.
 SEE THE FINISH DESIGN GUIDELINES FOR EQUIPMENT BOX TO MOUNT.

DUNKIN' DONUTS
 [Logo]
 JDS DESIGN SERVICES LLC
 880 CANAL STREET, STAMFORD, CT 06902

REVISIONS
 NO. DESCRIPTION BY DATE
 INITIAL ISSUE IS 1/14/09

JOB LOCATION:
 PORTLAND, ME
 1378 WASHINGTON AVENUE

FLOOR PLAN
 SHEET
 A1
 FILE#: 304697 JDS08049
 DATE: 01/14/09
 PROJ. MGR. J.R.
 C.M. W. GLYNN

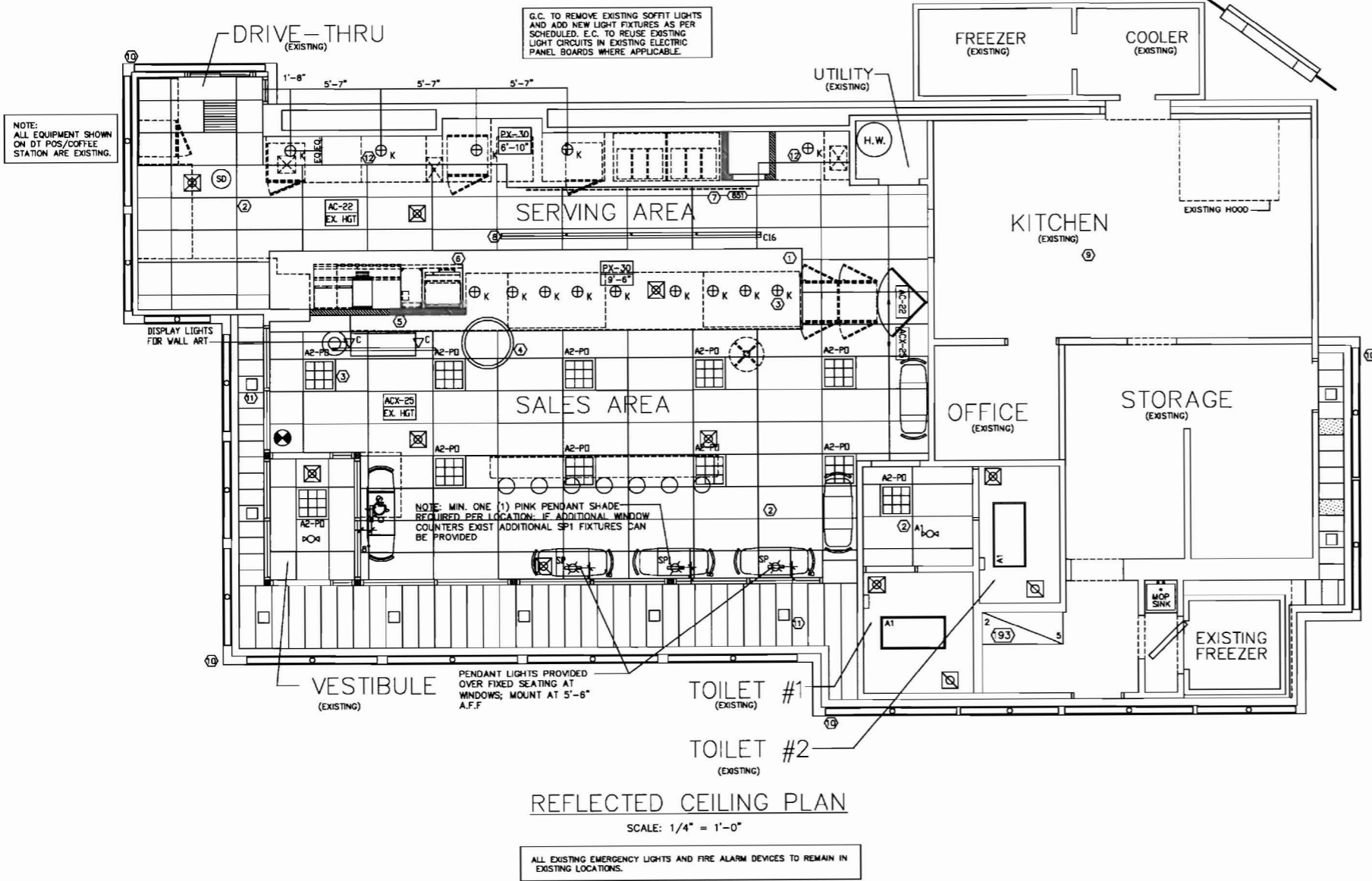

REFLECTED CEILING PLAN
SCALE: 1/4" = 1'-0"

NOTE: ALL EQUIPMENT SHOWN ON DT POS/COFFEE STATION ARE EXISTING.

NOTE: MIN. ONE (1) PINK PENDANT SHADE REQUIRED PER LOCATION. IF ADDITIONAL WINDOW COUNTERS EXIST ADDITIONAL SP1 FIXTURES CAN BE PROVIDED

PENDANT LIGHTS PROVIDED OVER FIXED SEATING AT WINDOWS; MOUNT AT 5'-8" A.F.F.

- ### CEILING PLAN KEY NOTES
- EXISTING FRONT CLOUD TO REMAIN, REPAINT AS PER FINISH SCHEDULE
 - EXISTING CEILING GRID TO REMAIN, REPLACE EXISTING CEILING TILES AS PER CEILING FINISH SCHEDULE
 - REMOVE AND REPLACE W/ NEW LIGHT FIXTURES AS PER CEILING LEGEND, E.C. TO VERIFY EXACT NUMBER OF LIGHTS TO REPLACE.
 - PICK-UP "TRIM" BY SIGN VENDOR @ 8'-0" CENTERED OVER HAND-OFF STATION SUPPLIED AND INSTALLED BY MILLWORK SUPPLIER
 - NEW FULL HEIGHT WALL UP TO ABOVE EXISTING SUSPENDED CEILING, BRACE WALL TO ABOVE STRUCTURE, FINISH WAS PER INTERIOR FINISH SCHEDULE
 - NEW HOOD ABOVE EXISTING SANDWICH STATION LOCATION.
 - MENU BOARDS TO BE CENTERED ON POS STATION AT FRONT LINE
 - SURFACE MOUNTED LIGHT FOR MENU BOARDS - CENTER LIGHTS ON MENU BOARDS
 - NO CEILING WORK
 - EXISTING EXTERIOR LIGHTS TO REMAIN
 - EXISTING EXTERIOR SOFFIT LIGHTS AND SOFFIT PANELS TO REMAIN REPAINT AS PER FINISH SCHEDULE
 - EXISTING SOFFIT TO REMAIN, REMOVE EXISTING LIGHT FIXTURES AND REPLACE W/ NEW LIGHT FIXTURES AS PER LIGHT FIXTURE SCHEDULE

CEILING FINISH SCHEDULE

CODE	MATERIAL	MANUF.	PRODUCT #	DESCRIPTION/REMARKS
AC-22	VINYL PANEL CEILING	ARMSTRONG	870	2' X 4', VINYL CLAD
ACX-25	ACOUSTIC PANEL CLG.	ARMSTRONG	1761 WH	2 1/4" FINE FISSED SECONDLOOK 1 WHITE
P-68	PAINTED GYP. BD.	BENJAMIN MOORE	314	IMPERIAL YELLOW
P-68HL	PAINTED GYP. BD.	SHERWIN WILLIAMS	6676	BUTTERFIELD
PX-30	PAINTED GYP. BD.	BENJAMIN MOORE	REGAL AQ GLOW #33	BM01 READY MIX WHITE-FLAT
PX-30HL	PAINTED GYP. BD.	SHERWIN WILLIAMS	SW 7006 EXTRA WHITE	FLAT

NOTE: OPTIONAL UPGRADE FOR PUBLIC AREA CEILING TILE & GRID (ACX-25 & AC-23) SHALL BE: AC-26, #1732 BY ARMSTRONG, 2'x2', COLOR: CAMEL; GRID TO BE AC-27, #7301 BY ARMSTRONG (CAMEL)

LIGHTING SCHEDULE

CODE	DESCRIPTION	MANUF.	PRODUCT #
INTERIOR			
A1	2x4 REC. FLUOR. W/ACRYLIC LENSE & WM TB	MET	2GRB-332A-UNV-ADV-EEX
A1PD	2x4 PARABOLIC W/ OVERLAY & TBWM	MET	2EP3GX32S361-UNV-ADV-EEX-DM
A2PD	2x2 PARABOLIC W/ TBWM	MET	2EP3GX2U6-S331-UNV-DL
B	42W COMPACT FLUOR. DOWNLIGHT	HALO	H880E-670C
BL	2x2 DIR-INDIR. REC. BATHROOM LIGHT	LDL	CFS-2GPF2T-120CD
C	TRACK HEAD - OPEN STYLE	HALO	L703MB
C16	MENU BOARD LIGHT TSHD - 16'	ELLIPTIPAR	F144-V16B S22-122-LXX W/LENS
JL	INCAND. DOWNLIGHT W/ WHITE TRIM	LEV	9675
K	42W COMPACT FLUOR. DOWNLIGHT W/ LENS	HALO	PD7/V142E/7VLIC
SP	APRICOT PEND. 9.5" SHADE	WILSHIRE	DD/APR/CONE
SP-1	PINK PENDANT 9.5" SHADE	WILSHIRE	DD/PNK/CONE

- ### LIGHTING SCHEDULE NOTES
- PROVIDE ALL FIXTURES COMPLETE WITH LAMPS. REFER TO NATIONAL ACCOUNT SOURCE INFO FOR LAMP
 - BI-COLOR INCANDESCENT LAMPS SHALL BE RATED 130 VOLTS.
 - ALL BALLASTS SHALL BE HIGH POWER FACTOR. FLUORESCENT BALLASTS FOR T8 LAMPS TO BE ADVANCED MANUFACTURED OPTIMUM WATT RISER, EXCEPT OUTDOOR FIXTURES TO BE ZERO-DEGREE MAGNETIC BALLASTS.
 - PROVIDE HOLD DOWN CLIPS FOR EACH CORNER OF FLUORESCENT GRID TRUFFERS.
 - PROVIDE ALL REQUIRED MOUNTING OR HANGING HARDWARE.
 - COORDINATE AND VERIFY ALL FIXTURE INFORMATION, TYPES AND FINAL LOCATIONS WITH THE REFLECTED CEILING PLAN
 - LAMPS SHALL BE AS MANUFACTURED BY SYLVANIA, WESTINGHOUSE, GENERAL ELECTRIC, OR APPROVED EQUAL.

CEILING LEGEND

A2PD	2x2 LAY-IN LIGHT FIXTURE W/ OVERLAY (TYP.)	SPEAKER (BY MUSIC VENDOR)
A1PD	2x4 LAY-IN LIGHT FIXTURE W/ OVERLAY (TYP.)	DOWN LIGHT
A1	2x4 LAY-IN LIGHT FIXTURE W/ ACRYLIC LENS (TYP.)	EXIT SIGN
∇ C	HALOGEN TRACK +HD	RETURN
CB,C12,C16,C24	SURFACE MTD. WALL-WASH LIGHT FIXTURE	CEILING EXHAUST REGISTER
SP, SP1	PENDANT LIGHT FIXTURE	SUPPLY AIR DIFFUSER
		CEILING GRID

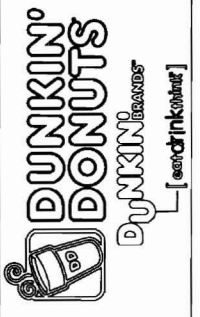

JDS DESIGN SERVICES LLC
860 CANAL STREET
STAMFORD, CT 06902



NO.	DESCRIPTION	BY	DATE
1	INITIAL ISSUE	JS	1/14/09

JOB LOCATION:
PORTLAND, ME
1378 WASHINGTON AVENUE
REFLECTED CEILING PLAN

SHEET
A2
FILE #: 304697 JDS08049
DATE: 01/14/09
PROJ. MGR. J.R.
C.M. W. GLYNN