

DISPLAY THIS CARD ON PRINCIPAL FRONTAGE OF WORK

CITY OF PORTLAND

BUILDING INSPECTION

Please Read Application And Notes, If Any, Attached

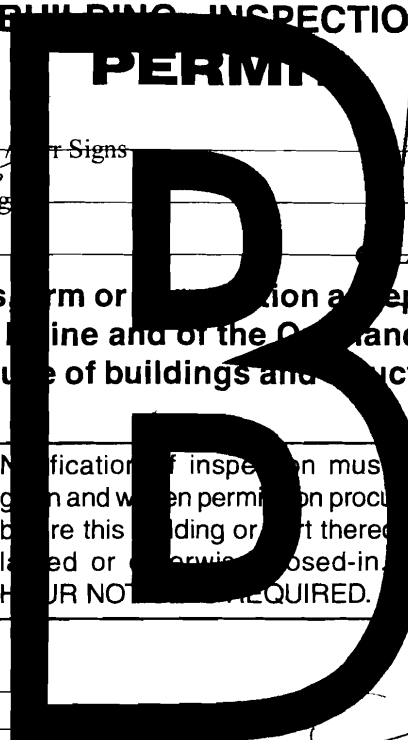

Permit Number: 080351
PERMIT ISSUED
APR 25 2008
344 C005001
CITY OF PORTLAND

This is to certify that BOLDUC CATHERINE A Signs

has permission to Erect Freestanding Signs

AT 1350 WASHINGTON AVE

provided that the person or persons who accept this permit shall comply with all of the provisions of the Statutes of the State and of the Ordinances of the City of Portland regulating the construction, maintenance and use of buildings and structures, and of the application on file in this department.

Apply to Public Works for street line and grade if nature of work requires such information.

Notification of inspection must be given and when permission procured before this building or part thereof is altered or otherwise closed-in. 4 HOUR NOTIFICATION REQUIRED.

A certificate of occupancy must be procured by owner before this building or part thereof is occupied.

OTHER REQUIRED APPROVALS

Fire Dept. _____
Health Dept. _____
Appeal Board _____
Other _____
Department Name

[Signature] 4/29/08
Director Building & Inspection Services

PENALTY FOR REMOVING THIS CARD

City of Portland, Maine - Building or Use Permit Application

389 Congress Street, 04101 Tel: (207) 874-8703, Fax: (207) 874-8716

Permit No: 08-0351	Issue Date:	CBL: 344 C005001
-----------------------	-------------	---------------------

Location of Construction: 1350 WASHINGTON AVE	Owner Name: BOLDUC CATHERINE A	Owner Address: 71 LESTER DR	Phone:
Business Name:	Contractor Name: Burr Signs	Contractor Address: 50 DownEast Drive Yarmouth	Phone: 2078467622
Lessee/Buyer's Name	Phone:	Permit Type: Signs - Permanent	Zone: R-P

Past Use: Commercial - Plummers Insurance	Proposed Use: Commercial- Plummers Insurance / Erect Freestanding 4.5' x 6.5' sign on a base	Permit Fee: \$114.00	Cost of Work: \$0.00	CEO District: 4
		FIRE DEPT: <input checked="" type="checkbox"/> Approved <input type="checkbox"/> Denied <i>N/A</i> Signature:	INSPECTION: Use Group: <i>U</i> Type: <i>Sign</i> <i>IBC 2003</i> Signature:	

Proposed Project Description:
Erect Freestanding 4.5' x 6.5' sign on a base.

PEDESTRIAN ACTIVITIES DISTRICT (P.A.D.)

Action: Approved Approved w/Conditions Denied

Signature: _____ Date: _____

Permit Taken By: lmd	Date Applied For: 04/14/2008	Zoning Approval	
-------------------------	---------------------------------	------------------------	--

- This permit application does not preclude the Applicant(s) from meeting applicable State and Federal Rules.
- Building permits do not include plumbing, septic or electrical work.
- Building permits are void if work is not started within six (6) months of the date of issuance. False information may invalidate a building permit and stop all work..

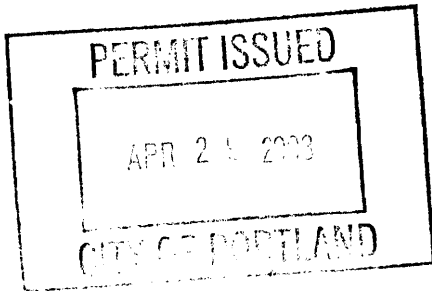

Special Zone or Reviews	Zoning Appeal	Historic Preservation
<input type="checkbox"/> Shoreland <input checked="" type="checkbox"/> Wetland <i>ILLEGAL WALL signs Added without permits - see conditions</i> <input type="checkbox"/> Flood Zone <input type="checkbox"/> Subdivision <input type="checkbox"/> Site Plan Maj <input type="checkbox"/> Minor <input type="checkbox"/> MM <input checked="" type="checkbox"/>	<input type="checkbox"/> Variance <input type="checkbox"/> Miscellaneous <input type="checkbox"/> Conditional Use <input type="checkbox"/> Interpretation <input type="checkbox"/> Approved <input type="checkbox"/> Denied	<input checked="" type="checkbox"/> Not in District or Landmark <input type="checkbox"/> Does Not Require Review <input type="checkbox"/> Requires Review <input type="checkbox"/> Approved <input type="checkbox"/> Approved w/Conditions <input type="checkbox"/> Denied
Date: <i>3/4/22/08</i>	Date: _____	Date: _____

CERTIFICATION

I hereby certify that I am the owner of record of the named property, or that the proposed work is authorized by the owner of record and that I have been authorized by the owner to make this application as his authorized agent and I agree to conform to all applicable laws of this jurisdiction. In addition, if a permit for work described in the application is issued, I certify that the code official's authorized representative shall have the authority to enter all areas covered by such permit at any reasonable hour to enforce the provision of the code(s) applicable to such permit.

SIGNATURE OF APPLICANT	ADDRESS	DATE	PHONE
RESPONSIBLE PERSON IN CHARGE OF WORK, TITLE		DATE	PHONE

SIGNAGE/AWNING PRE-APPLICATION QUESTIONNAIRE

PLEASE ANSWER ALL QUESTIONS

ADDRESS: 1350 WASHINGTON AVE ZONE: _____

CBL: _____

SINGLE TENANT LOT? YES X NO _____ MULTIPLE TENANT LOT? YES _____ NO X
MORE THAN ONE SIGN TOTAL WITH PROPOSED SIGN? YES _____ NO X

INFORMATION ON PROPOSED SIGN(S):

FREESTANDING (e.g., pole) SIGN? YES X NO _____ DIMENSIONS PROPOSED: Actual 6.5' x 6.5' on base 8' x 6' 6"
BLDG. WALL SIGN? (attached to bldg) YES _____ NO X DIMENSIONS PROPOSED: _____

INFORMATION ON ALREADY EXISTING AND PERMITTED SIGN(S):

FREESTANDING (e.g., pole) SIGN? YES _____ NO X DIMENSIONS: _____
BLDG. WALL SIGN(attached to bldg) ? YES _____ NO X DIMENSIONS: _____
AWNING? YES _____ NO X DIMENSIONS: _____

LOT FRONTAGE (FEET): 80'
TENANT/ALLOCATED BUILDING SPACE FRONTAGE (FEET): _____

AWNING YES _____ NO X IS AWNING PERMITTED? YES _____ NO _____
HEIGHT OF AWNING: _____ LENGTH OF AWNING: _____ DEPTH: _____

IS THERE ANY COMMUNICATION, MESSAGE, TRADEMARK OR SYMBOL ON IT? YES _____ NO _____
IF YES, TOTAL S.F. OF PANELS WITH COMMUNICATIONS/MESSAGES/TRADEMARK/SYMBOL? _____ s.f.

A SITE SKETCH AND BUILDING SKETCH SHOWING EXACTLY WHERE EXISTING AND PROPOSED SIGNAGE IS LOCATED MUST BE PROVIDED WITH THIS APPLICATION. DIMENSIONS AND/OR PICTURES OF PROPOSED SIGNAGE ARE ALSO REQUIRED.

SIGNATURE OF APPLICANT: [Signature] DATE: 04/09/08

***** FOR OFFICE USE ONLY

ACORD™ CERTIFICATE OF LIABILITY INSURANCE		DATE (MM/DD/YYYY) 04/08/2008
PRODUCER (207) 797-8840 Plummer's Insurance Agency 1350 Washington Avenue Portland ME 04103-		THIS CERTIFICATE IS ISSUED AS A MATTER OF INFORMATION ONLY AND CONFERS NO RIGHTS UPON THE CERTIFICATE HOLDER. THIS CERTIFICATE DOES NOT AMEND, EXTEND OR ALTER THE COVERAGE AFFORDED BY THE POLICIES BELOW.
INSURED Plummer's Insurance Agency, LLC 1350 Washington Avenue Portland ME 04103-		
		INSURERS AFFORDING COVERAGE
		NAIC #
		INSURER A: Middlesex Mutual
		INSURER B:
		INSURER C:
		INSURER D:
		INSURER E:

COVERAGES

THE POLICIES OF INSURANCE LISTED BELOW HAVE BEEN ISSUED TO THE INSURED NAMED ABOVE FOR THE POLICY PERIOD INDICATED. NOTWITHSTANDING ANY REQUIREMENT, TERM OR CONDITION OF ANY CONTRACT OR OTHER DOCUMENT WITH RESPECT TO WHICH THIS CERTIFICATE MAY BE ISSUED OR MAY PERTAIN, THE INSURANCE AFFORDED BY THE POLICIES DESCRIBED HEREIN IS SUBJECT TO ALL THE TERMS, EXCLUSIONS AND CONDITIONS OF SUCH POLICIES. AGGREGATE LIMITS SHOWN MAY HAVE BEEN REDUCED BY PAID CLAIMS.

INSR	ADD'L	TYPE OF INSURANCE	POLICY NUMBER	POLICY EFFECTIVE DATE (MM/DD/YY)	POLICY EXPIRATION DATE (MM/DD/YY)	LIMITS
A		GENERAL LIABILITY	CB0100005066	01/01/2008	01/01/2009	EACH OCCURRENCE \$ 2,000,000
	<input checked="" type="checkbox"/>	COMMERCIAL GENERAL LIABILITY				DAMAGE TO RENTED PREMISES (Ea occurrence) \$ 100,000
	<input type="checkbox"/>	CLAIMS MADE <input checked="" type="checkbox"/> OCCUR				MED EXP (Any one person) \$ 5,000
						PERSONAL & ADV INJURY \$ 2,000,000
						GENERAL AGGREGATE \$ 2,000,000
						PRODUCTS - COM/OP AGG \$ 2,000,000
		GEN'L AGGREGATE LIMIT APPLIES PER: <input type="checkbox"/> POLICY <input type="checkbox"/> PRO-JECT <input type="checkbox"/> LOC				
		AUTOMOBILE LIABILITY				COMBINED SINGLE LIMIT (Ea accident) \$
		<input type="checkbox"/> ANY AUTO				BODILY INJURY (Per person) \$
		<input type="checkbox"/> ALL OWNED AUTOS				BODILY INJURY (Per accident) \$
		<input type="checkbox"/> SCHEDULED AUTOS				PROPERTY DAMAGE (Per accident) \$
		<input type="checkbox"/> HIRED AUTOS				
		<input type="checkbox"/> NON-OWNED AUTOS				
		GARAGE LIABILITY				AUTO ONLY - EA ACCIDENT \$
		<input type="checkbox"/> ANY AUTO				OTHER THAN EA ACC \$
						AUTO ONLY: AGG \$
		EXCESS/UMBRELLA LIABILITY				EACH OCCURRENCE \$
		<input type="checkbox"/> OCCUR <input type="checkbox"/> CLAIMS MADE				AGGREGATE \$
		<input type="checkbox"/> DEDUCTIBLE				\$
		<input type="checkbox"/> RETENTION \$				\$
		WORKERS COMPENSATION AND EMPLOYERS' LIABILITY				WC STATU-TORY LIMITS <input type="checkbox"/> OTH-ER <input type="checkbox"/>
		ANY PROPRIETOR/PARTNER/EXECUTIVE OFFICER/MEMBER EXCLUDED? If yes, describe under SPECIAL PROVISIONS below				E.L. EACH ACCIDENT \$
						E.L. DISEASE - EA EMPLOYEE \$
						E.L. DISEASE - POLICY LIMIT \$
		OTHER				

DESCRIPTION OF OPERATIONS/LOCATIONS/VEHICLES/EXCLUSIONS ADDED BY ENDORSEMENT/SPECIAL PROVISIONS

CERTIFICATE HOLDER () - () - City of Portland 389 Congress Street Portland ME 04101-	CANCELLATION SHOULD ANY OF THE ABOVE DESCRIBED POLICIES BE CANCELLED BEFORE THE EXPIRATION DATE THEREOF, THE ISSUING INSURER WILL ENDEAVOR TO MAIL <u>10</u> DAYS WRITTEN NOTICE TO THE CERTIFICATE HOLDER NAMED TO THE LEFT, BUT FAILURE TO DO SO SHALL IMPOSE NO OBLIGATION OR LIABILITY OF ANY KIND UPON THE INSURER, ITS AGENTS OR REPRESENTATIVES. AUTHORIZED REPRESENTATIVE 
---	--

Table 2.3

Residence-Professional (R-P) Zone

Freestanding Signs

Area	30 sq. ft.
Height	8'
Setback	5'
# Permitted Per Lot	1 (a)

- (a) Lots fronting on two or more streets are allowed one freestanding sign of equivalent size for each street frontage with vehicular entry, provided such signs are not readily concurrently visible.

Building Signs

None allowed, other than incidental and/or directory signs.

1350 washington ave., portland, maine

SIGN LOCATION
5' SET BACK



© 2008 Tele Atlas
Image © 2008 Maine GeoLibrary

© 2005 Google

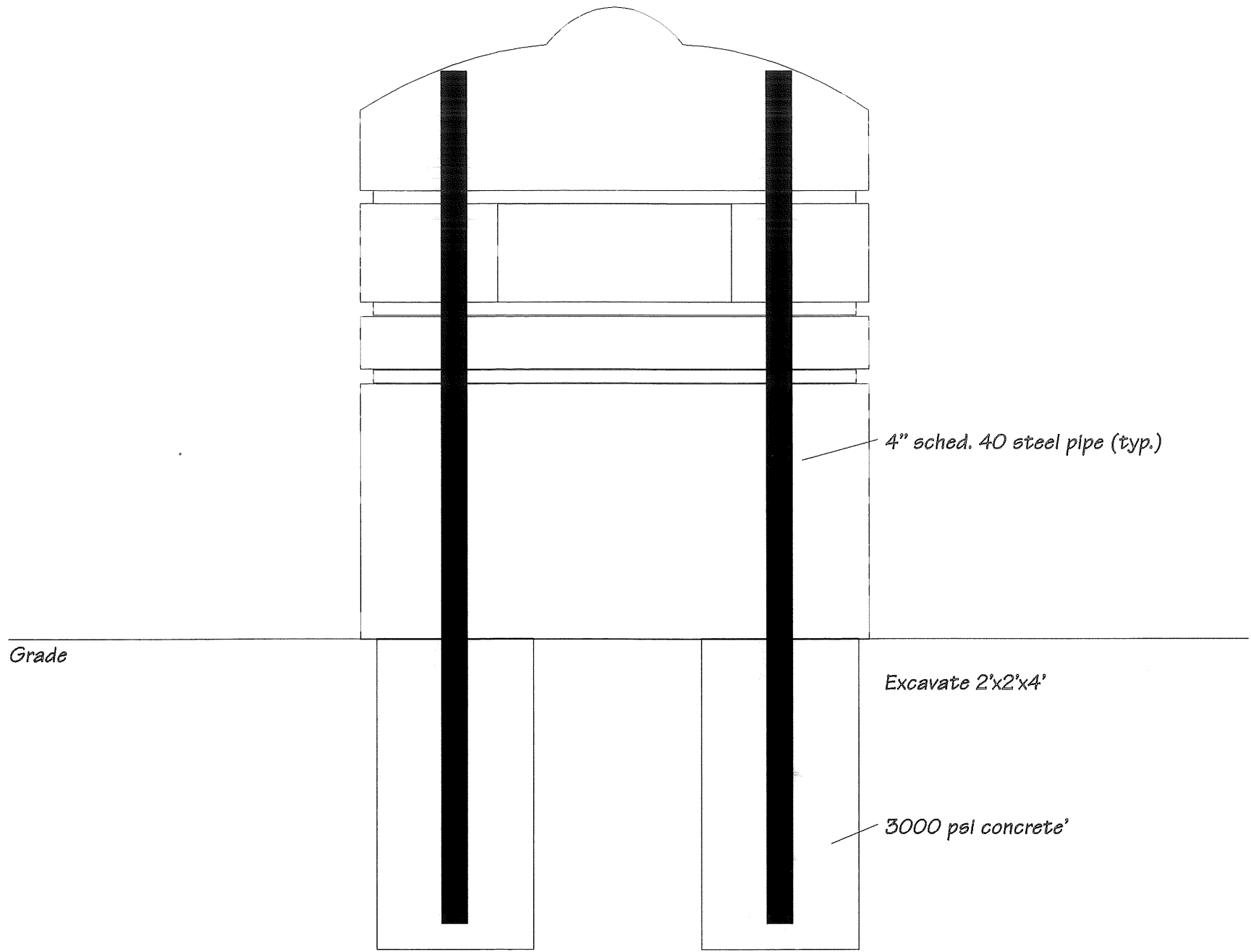

50 DownEast Drive
 Yarmouth, Maine 04096
 PH: 207-846-7622 Fax: 207-846-7623
 www.burrsgns.com

THIS DESIGN IS THE EXCLUSIVE PROPERTY OF BURR SIGNS. ALL PRODUCTION AND REPRODUCTION RIGHTS ARE RESERVED BY US.
 THIS PRINT HAS BEEN DESIGNED FOR YOUR PERSONAL USE. IT MAY NOT BE REPRODUCED, COPIED, OR EXHIBITED OUTSIDE OF YOUR COMPANY OR ORGANIZATION WITHOUT THE EXPRESSED WRITTEN PERMISSION OF BURR SIGNS.

© Copyright

CLIENT
PIA INSURANCE

LOCATION
PORTLAND, ME

SALES PERSON
R. BURR

DRAWN BY
A. DION

SCALE
1" = 10"

DATE
03/12/08

ACCEPTANCE SIGNATURE

DATE

DRAWING NO
pia insurance3.cdl

COLORS SHOWN HERE MAY NOT REPRESENT ACTUAL COLORS. COLOR MATCH NUMBERS MAY BE REQUIRED.



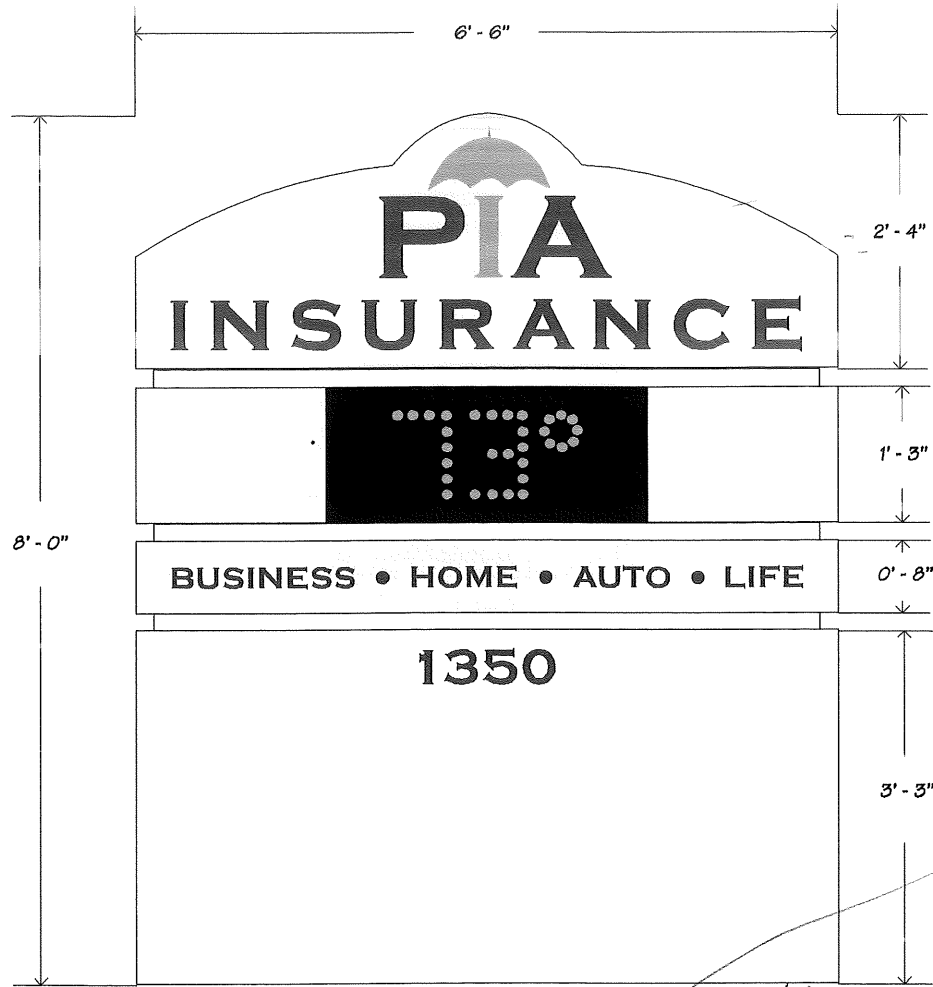

Note: Address Numbers Are Not Illuminated

$4.5 \times 6.5 = 29.25$

$$\begin{array}{r} 8 \\ - 3.25 \\ \hline 4.75 \end{array}$$

$4.75' \times 6.5' = 30.875 \#$

30# max Allowed
The "overage" is OK because
1" = 20"

of the form of the top - the measurements were to the very top, as if squared off -

max height = 8' - 8' show

min 5' setback - 5' setback show

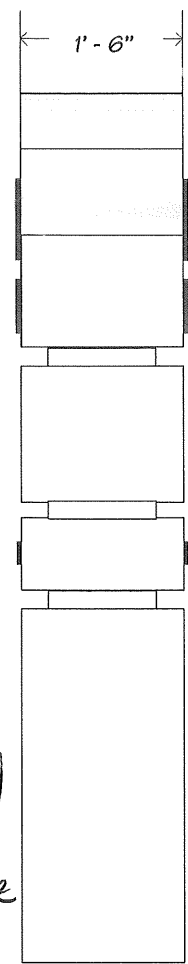

Side View



50 DownEast Drive
Yarmouth, Maine 04098
PH: 207-848-7622 Fax: 207-848-7623
www.burrsgns.com

THIS DESIGN IS THE EXCLUSIVE PROPERTY OF BURR SIGNS. ALL PRODUCTION AND REPRODUCTION RIGHTS ARE RESERVED BY US.
THIS PRINT HAS BEEN DESIGNED FOR YOUR PERSONAL USE. IT MAY NOT BE SUBMITTED, USED OR EXHIBITED OUTSIDE OF YOUR COMPANY OR ORGANIZATION WITHOUT THE EXPRESSED WRITTEN PERMISSION OF BURR SIGNS.

© Copyright

CLIENT
PIA INSURANCE

LOCATION
PORTLAND, ME

SALES PERSON
R. BURR

DRAWN BY
R. BURR

SCALE
AS NOTED

DATE
03/21/08

ACCEPTANCE SIGNATURE

DATE

DRAWING NO
pia insurance2.cdl



COLORS SHOWN HERE MAY NOT REPRESENT ACTUAL COLORS. COLOR MATCH NUMBERS MAY BE REQUIRED.



40" x 48"



40" x 48"

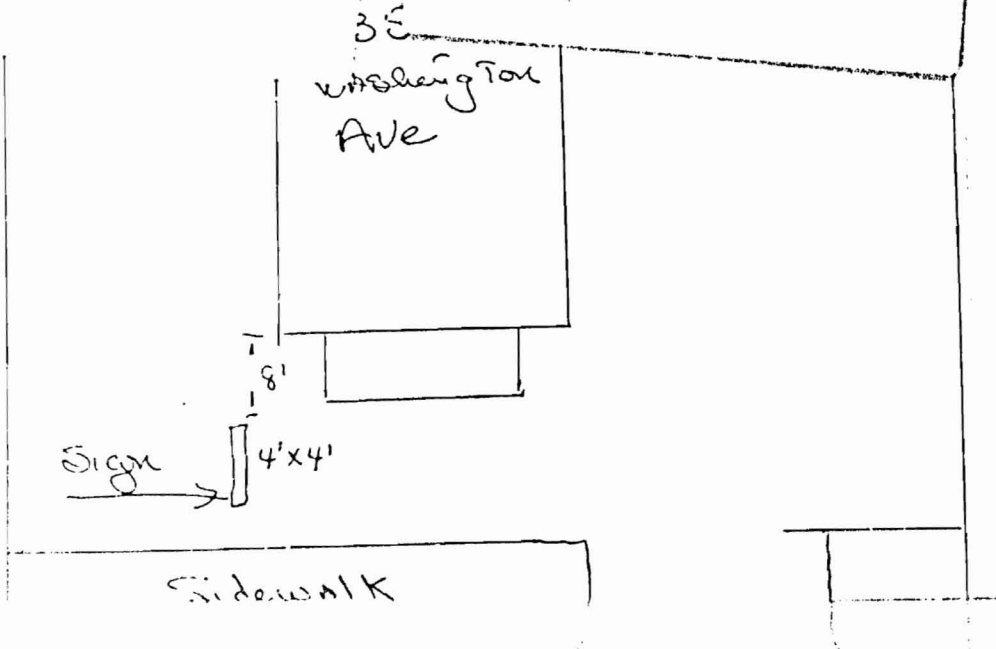

Permit 93-413

344-C-5

APR 18 1963



Sign on Bldg

No permit on

File 4/18/08

yes - There is a permit still there

Also one attached to the building along Washington Ave

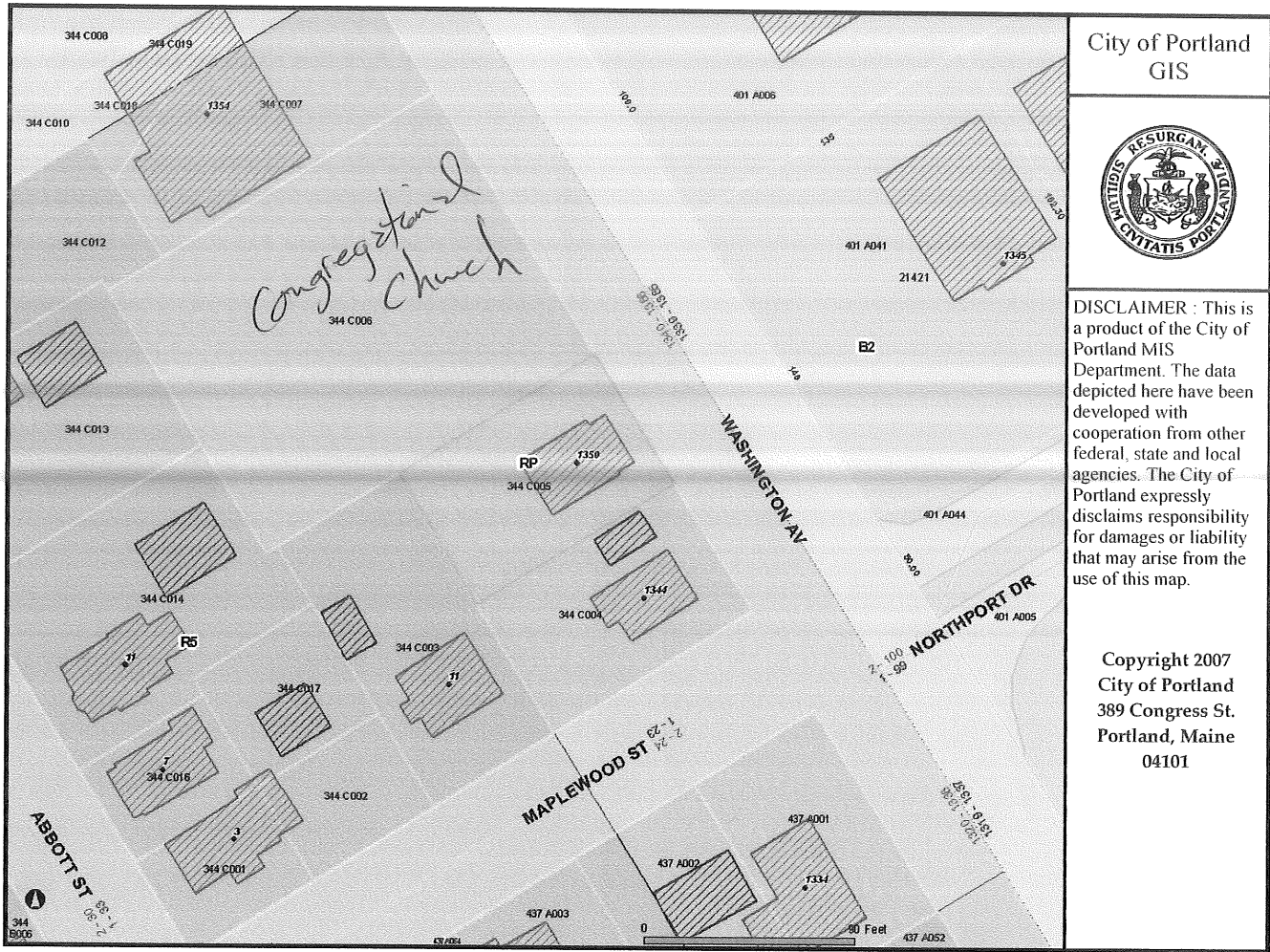

Plummer's Insurance
1350 Washington Ave

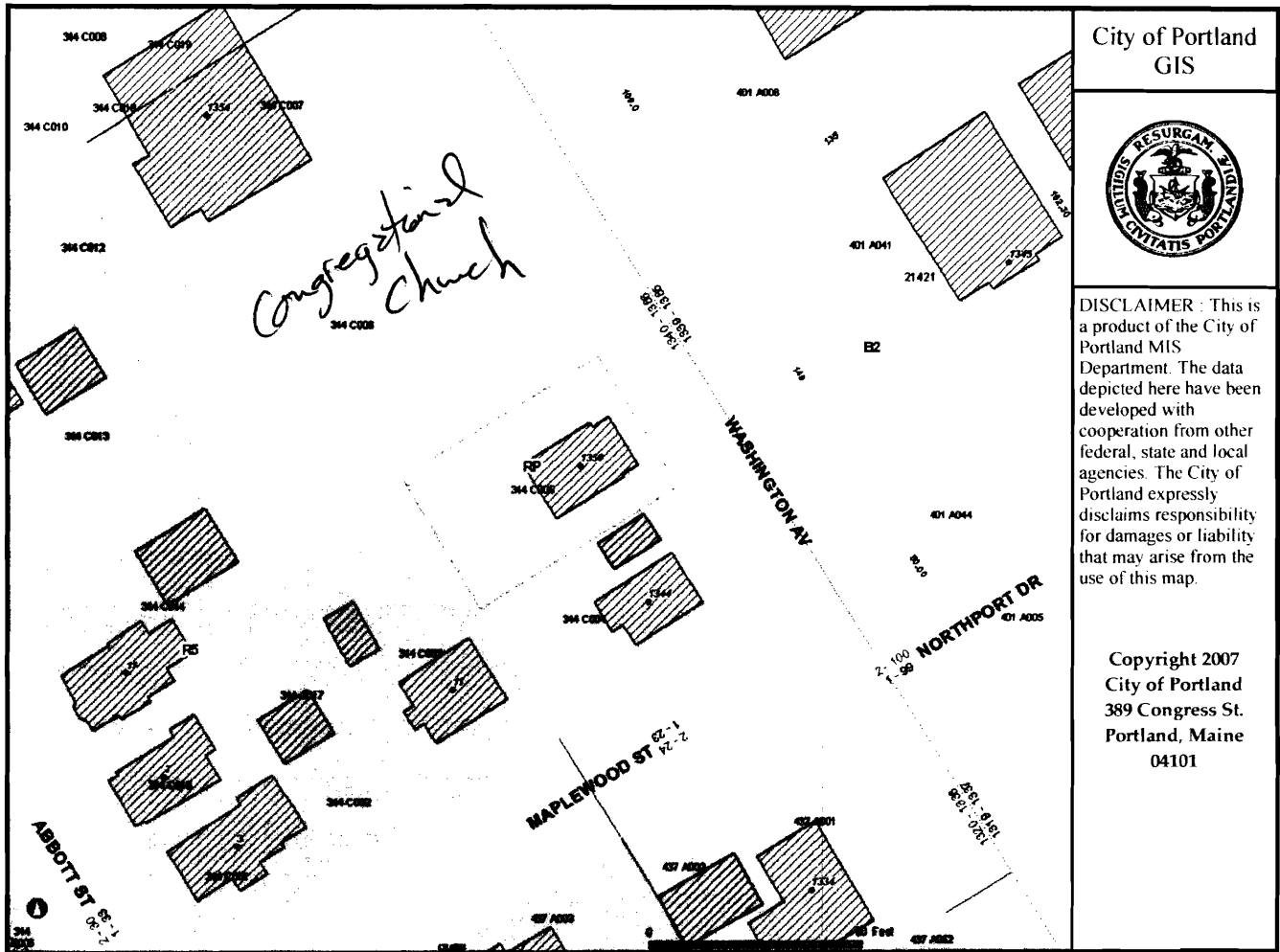

Plummer's Insurance
 1350 WASHINGTON AVE