

**FIRST & SECOND FLOOR PLAN  
DUPLIX HOME  
WASHINGTON CROSSING**

**A.L.C. DEVELOPMENT**  
258 BLACK POINT ROAD  
SCARBOROUGH, ME. 04074  
PHONE: (207) 883-1992

REVISIONS
CODE: BOCA 1999
PORTLAND, ME.

DATE:	11/06/02
SCALE:	1/4"=1'-0"
DRAWN:	FMC/R
FILE:	01-0431M
SHEET:	A3

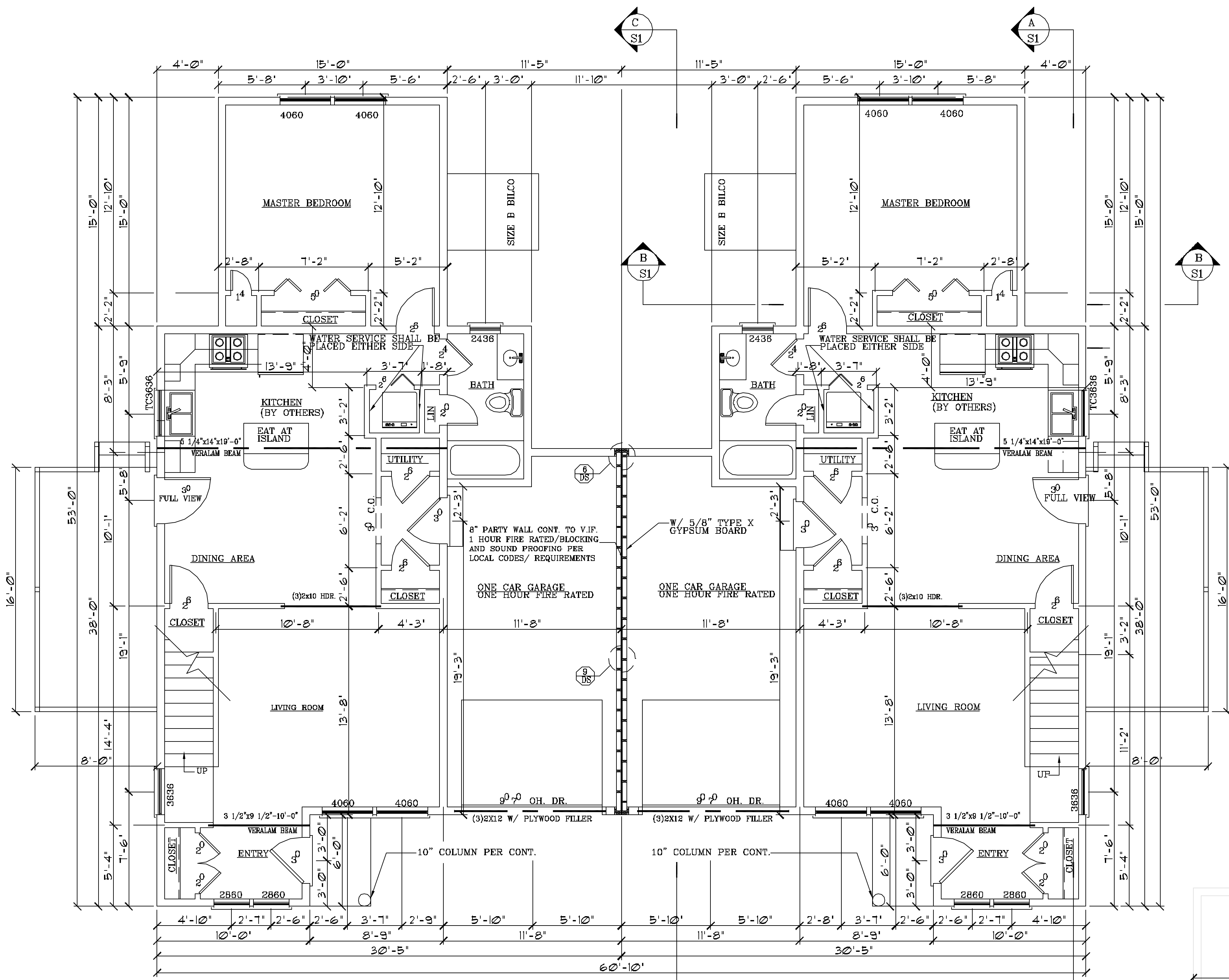

**FIRST FLOOR PLAN**  
SCALE: 1/4" = 1'-0"

NOTE:  
1. ALL DOUBLE AND TRIPLE WINDOWS ARE TO BE FACTORY MULLED  
2. WINDOWS LISTED BELOW MEET OR EXCEED EGRESS REQUIREMENTS FOR BOCA 1999  
4060 DOUBLE HUNG  
C3048 CASEMENT WITH EGRESS HARDWARE

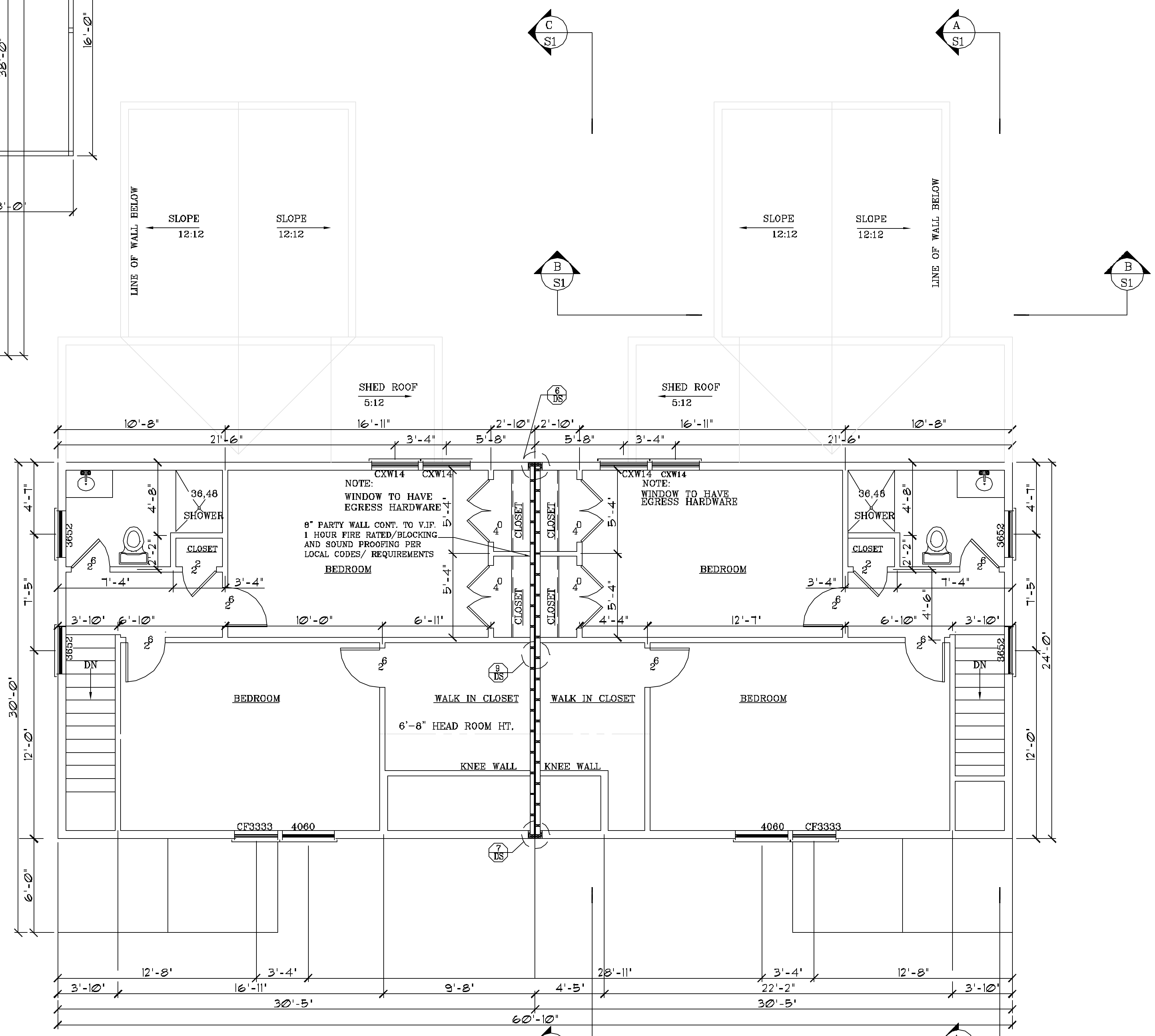

**SECOND FLOOR PLAN**  
SCALE: 1/4" = 1'-0"

NOTE:  
1. ALL DOUBLE AND TRIPLE WINDOWS ARE TO BE FACTORY MULLED  
2. WINDOWS LISTED BELOW MEET OR EXCEED EGRESS REQUIREMENTS FOR BOCA 1999  
4060 DOUBLE HUNG  
C3048 CASEMENT WITH EGRESS HARDWARE

**NOTE:**  
THIS DRAWING IS PROVIDED FOR INFORMATIONAL PURPOSES ONLY. IF USED FOR CONSTRUCTION, THE CONTRACTOR ASSUMES ALL RESPONSIBILITY FOR LOCAL CODE COMPLIANCE. ALL DRAWINGS, PLANS, SPECIFICATIONS, ETC. ARE PROVIDED TO OUR CLIENTS BASED UPON INFORMATION PROVIDED BY THE CLIENT. WE DO NOT AND CANNOT GUARANTEE THE ACCURACY OF THE INFORMATION PROVIDED. FMC CADD ENGINEERING & SURVEY CENTER, INC. IS A REGISTERED ARCHITECTURAL ENGINEERING OR LAND SURVEYING FIRM. ALL OPERATIONS AND SPECIFICATIONS SHOULD BE VERIFIED BY CLIENT AND/OR CONTRACTOR BEFORE ACTUAL CONSTRUCTION. DESIGN, DIMENSIONS AND SPECIFICATIONS ARE NOT WARRANTED. FMC CADD ENGINEERING & SURVEY CENTER, INC. SHALL BE HELD HARMLESS FROM ANY AND ALL CLAIMS, DAMAGES, LOSSES AND EXPENSES, INCLUDING REASONABLE ATTORNEY'S FEES, ARISING OUT OF OR FROM THIS AGREEMENT. FMC CADD ENGINEERING & SURVEY CENTER, INC. ASSUMES NO LIABILITY FOR CHANGES AND/OR REVISIONS MADE TO PLANS BY CLIENT AND/OR CONTRACTOR.