

3/7/16/2017 5:12 PM T:\02 PROJECTS - MAINE\1010-4200\11000\1000\PROJECTS\FIRE ALARM UPGRADES\DESIGN\DWGS\BUILDINGS\FIRE ALARM REMOVAL PLAN BUILDING B.DWG - STEPHANE LAPLANT



NOTE:
 EXISTING SPEAKERS, BEACONS + OTHER FIRE ALARM NOTIFICATION DEVICES TO REMAIN. CONNECT TO BUILDING 'A' SIGNAL LINE CIRCUIT. EXISTING INITIATING DEVICES TO REMAIN. INSTALL ZONE MODULE(S) AT FACI TO MONITOR DEVICES ON EXISTING ZONE(S). NEW DEVICES NOTED SHALL BE ADDRESSABLE.

TECHNICAL NOTES:

- SPRINKLER SYSTEM TAMPER, FLOW + PRESSURE SWITCH LOCATIONS DERIVED FROM FIELD OBSERVATIONS + CONVERSATION WITH SPRINKLER SYSTEM INSPECTION CO. ADDITIONAL CONNECTIONS TO THE FIRE ALARM SYSTEM MAY BE NECESSARY AS FLOWS + TAMPER ARE LIKELY LOCATED ABOVE ACCESSIBLE CEILING THROUGHOUT THE FACILITY. CONTRACTOR SHALL INCLUDE 25% SPARE CONNECTIONS TO EACH TYPE OF DEVICE FOR UNLABELED LOCATIONS THAT MAY BE ENCOUNTERED.
- MULTICRITERIA DETECTOR - ENABLE HEAT + CO DETECTION.

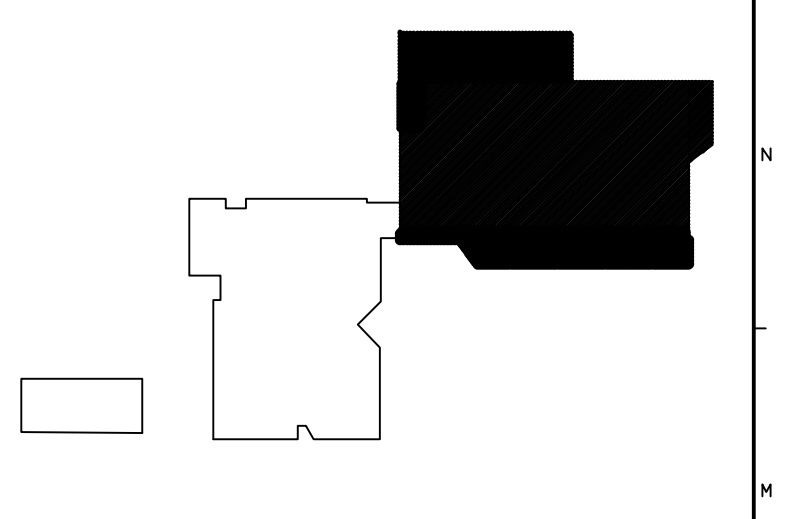

KEY PLAN

- LEGEND:**
- E EXISTING TO REMAIN
 - ER EXISTING RELOCATED
 - NR NEW TO REPLACE EXISTING IN EXISTING LOCATION
 - R EXISTING TO BE REMOVED
 - RR REMOVE & RELOCATE EXISTING
 - HA FIRE ALARM HORN / LIGHT
 - MS MULTI-CANDELA STROBE
 - MMS MULTI-CANDELA HORN/STROBE
 - FT CEILING MOUNTED MULTI-CANDELA HORN/STROBE
 - FT1 FIRE ALARM SYSTEM CEILING MOUNTED HEAT DETECTOR - 'EL' FOR ELEVATOR SHUNT TRIP
 - FT2 FIRE ALARM SYSTEM CEILING MOUNTED SMOKE DETECTOR - 'EL' FOR ELEVATOR RECALL
 - MSM WALL MOUNTED FIRE ALARM SYSTEM MANUAL PULL STATION
 - KB KNOX BOX
 - DOOR DOOR HOLD-OPEN DEVICE CONNECTION
 - FS FIRE ALARM SYSTEM/SPRINKLER SYSTEM PRESSURE SWITCH
 - FS1 FIRE ALARM SYSTEM/SPRINKLER SYSTEM FLOW SWITCH
 - FS2 FIRE ALARM SYSTEM/SPRINKLER SYSTEM TAMPER SWITCH
 - FTD FIRE ALARM SYSTEM DUCT MOUNTED SMOKE DETECTOR
 - FACP FIRE ALARM SYSTEM CONTROL PANEL
 - FACI FIRE ALARM ANNUNCIATOR
 - GS GAS SHUT-OFF
 - RTS RADIO TRANSMITTER BOX
 - MM MONITOR MODULE
 - TS TEST STATION
 - RM RELAY MODULE
 - AGT ANSUL GAS TANK

REV.	DESCRIPTION	DATE
0	ISSUE FOR BID	03.14.17

PROJECT NORTH

03.14.17

WBRC
 ARCHITECTS • ENGINEERS
 WWW.WBRC-ARCH.COM
 BANGOR, MAINE 207-647-4511
 PORTLAND, MAINE 207-828-4511
 SUWANEEVILLE, FLORIDA 941-556-0075

PORTLAND ARTS AND TECHNICAL
 HIGH SCHOOL FIRE ALARM
 UPGRADES
 PORTLAND, ME

PROJECT:
FIRST FLOOR FIRE ALARM PLAN BUILDING B

SHEET TITLE:	4145.00 - FA101B
WBRC CAD FILE:	4145.00
PROJECT No.:	AS NOTED
SCALE:	GRAPHIC SCALE: 0"
PROJECT MANAGER:	SJL
DRAWN BY:	DVS
CHECKED BY:	SJL
FA101B	

A1 FIRST FLOOR FIRE ALARM PLAN BUILDING B

1/8" = 1'-0"