

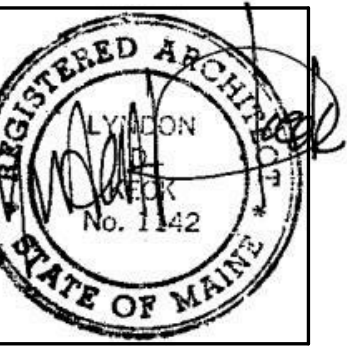

49 DARTMOUTH STREET
PORTLAND, MAINE 04101
207-775-1059
www.pdtarchts.com

**COPYRIGHT 2014
PDT Architects**
Reuse or reproduction of the
contents of this document is not
permitted without written
permission of PDT Architects.

**Minor Interior Renovations at 196 Allen Avenue for
CASCO BAY HIGH SCHOOL**
196 Allen Avenue, Portland Maine

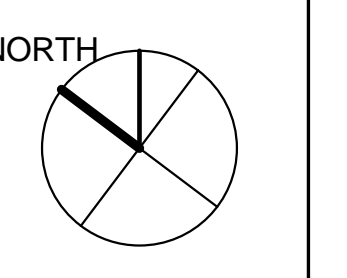

JOB NO.
14036

DRWN. CHK
Checker

SCALE:
As indicated

ISSUE STATUS
CONSTRUCTION
ISSUE DATE
APRIL 18, 2014

TITLE
REFLECTED
CEILING PLAN

SHEET
A103

CEILING GENERAL NOTES

- Ceiling plans do not show every fixture or component. Refer to electrical, plumbing, mechanical and structural drawings for extent of all ceiling penetrations and installations and coordinate prior to installation.
- Center grid layout in all rooms unless noted otherwise.
- All components mounted in or below a suspended acoustic ceiling shall be centered in the ceiling tile or in the 2x2 portion of regular tiles. This shall include, but not be limited to, light fixtures, diffusers, speakers, and sprinkler heads.
- Prior to the installation of ceilings, allow for an above-ceiling inspection of components that will not be visible when the ceilings have been installed.
- Coordinate new ceiling grid size and layout with the size and quantity of Salvaged ceiling tile.

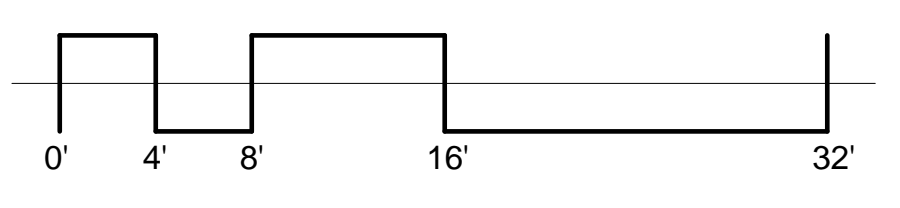
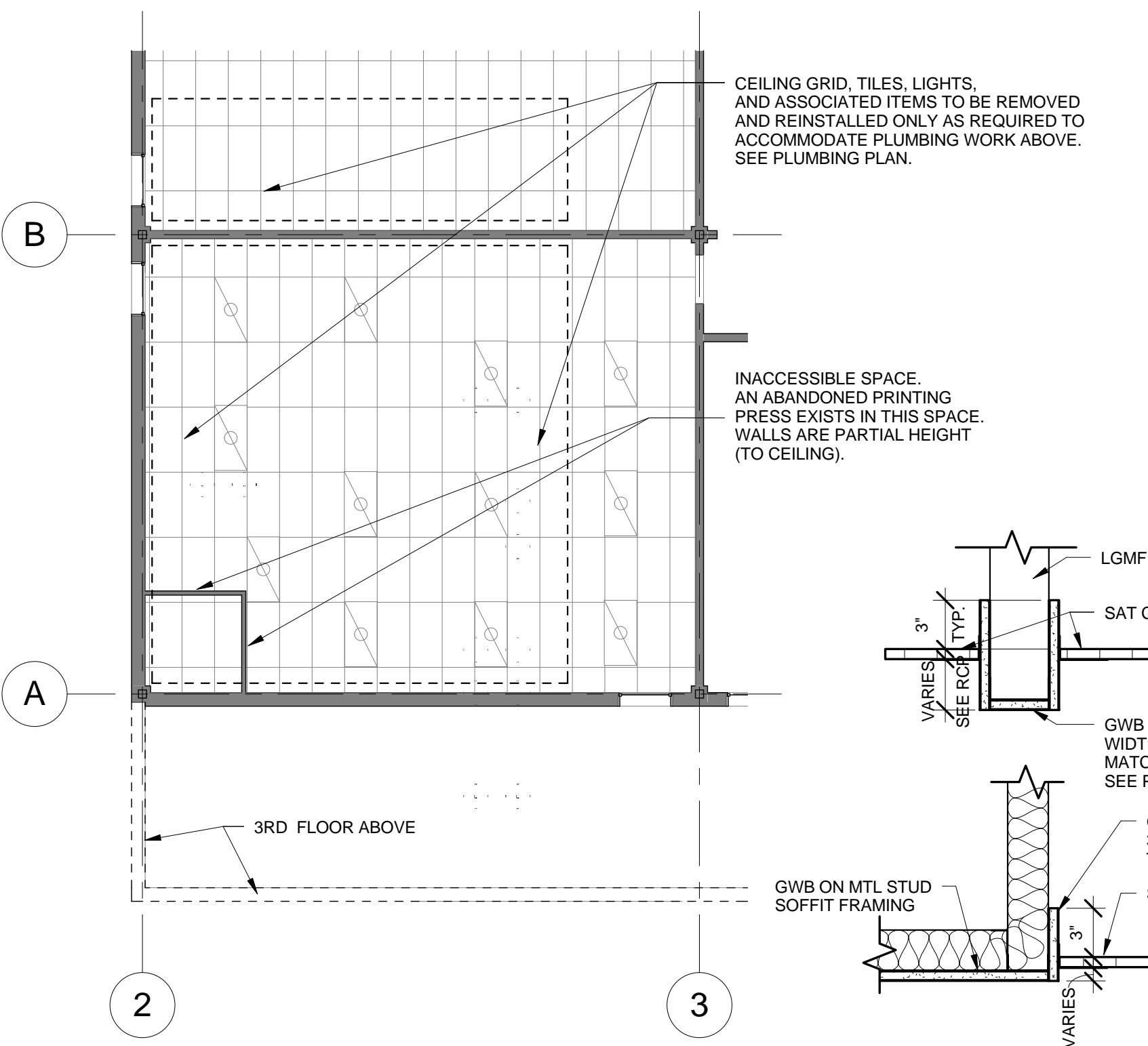
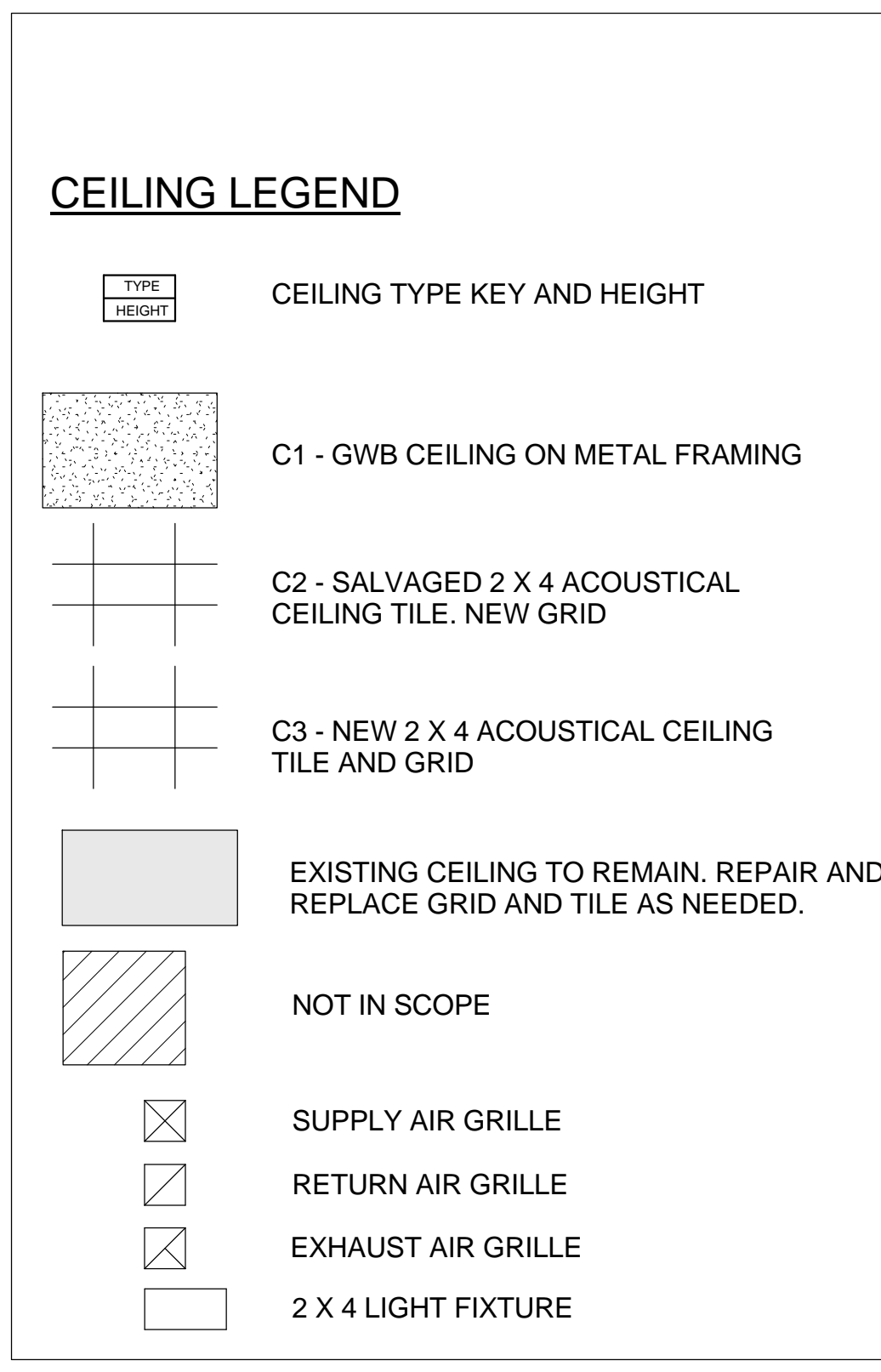
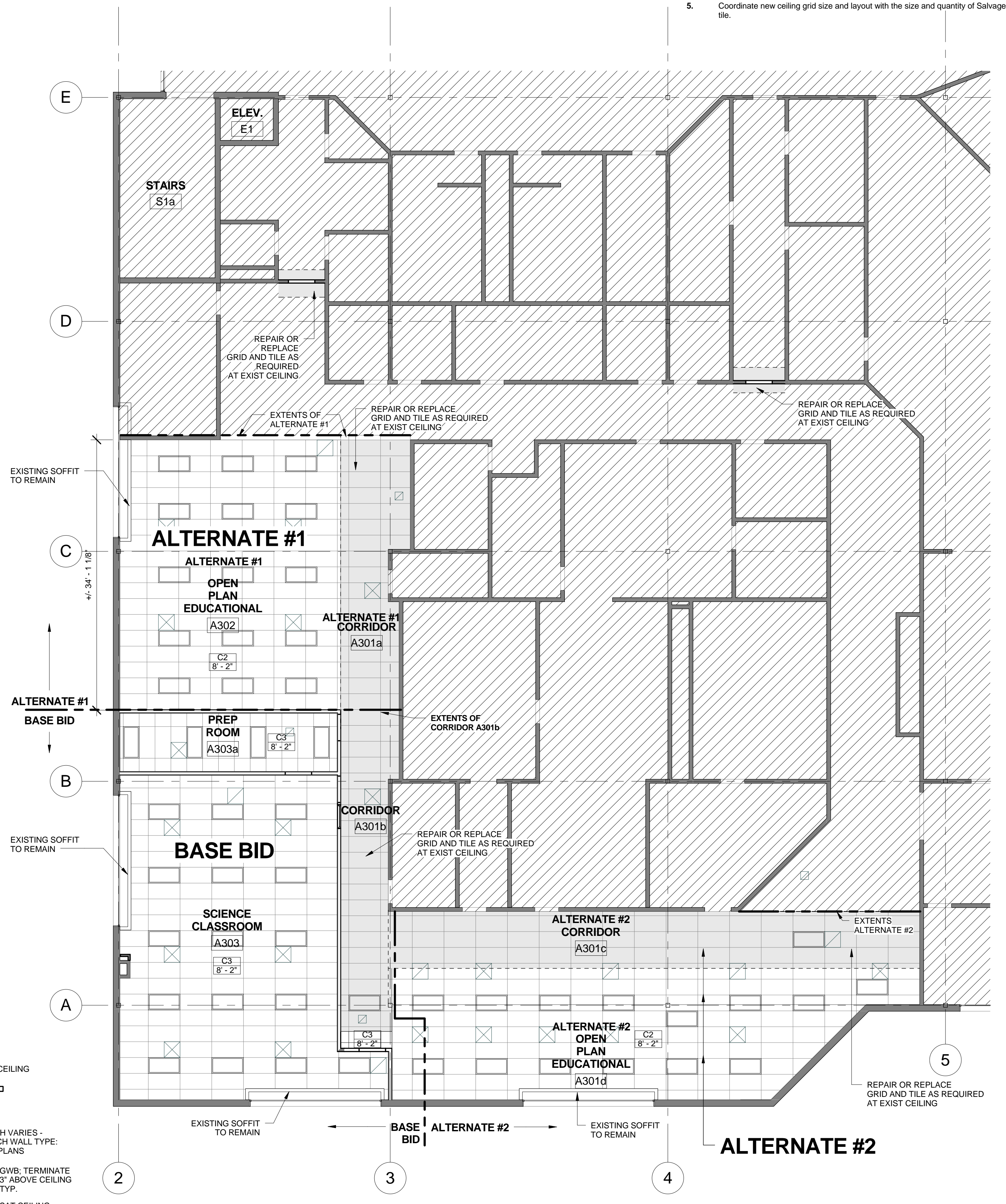

D
C
B
A

5

4

3

2

1

5

4

3

2

1