

DISPLAY THIS CARD ON PRINCIPAL FRONTAGE OF WORK

CITY OF PORTLAND

Please Read
Application And
Notes, If Any,
Attached

BUILDING INSPECTION

PERMIT

Permit Number: 101506

PERMIT ISSUED

This is to certify that CITY OF PORTLAND /City of Portland /Trades Divisionhas permission to Classrooms 220B & 220A - change floor plan to create better air flowAT 196 ALLEN AVE

CBL 343 C013001

DEC 17 1990

provided that the person or persons, firm or corporation accepting this permit shall comply with all of the provisions of the Statutes of Maine and of the Ordinances of the City of Portland regulating the construction, maintenance and use of buildings and structures, and of the application on file in this department.

Apply to Public Works for street line and grade if nature of work requires such information.

Notification of inspection must be given and written permission procured before this building or part thereof is lathed or otherwise closed-in. 24 HOUR NOTICE IS REQUIRED.

A certificate of occupancy must be procured by owner before this building or part thereof is occupied.

OTHER REQUIRED APPROVALS

Fire Dept. *[Signature]* (58)

Health Dept. _____

Appeal Board _____

Other _____

Department Name

 Director - Building & Inspection Services

PENALTY FOR REMOVING THIS CARD

City of Portland, Maine - Building or Use Permit Application

389 Congress Street, 04101 Tel: (207) 874-8703, Fax: (207) 874-8716

Permit No: 10-1506	Issue Date:	CBL: 343 C013001
-----------------------	-------------	---------------------

Location of Construction: 196 ALLEN AVE	Owner Name: CITY OF PORTLAND	Owner Address: 389 CONGRESS ST	Phone:
Business Name:	Contractor Name: City of Portland /Trades Division	Contractor Address:	Phone
Lessee/Buyer's Name	Phone:	Permit Type: Alterations - Commercial	Zone: R-3

Past Use: Portland Arts and Technology High School -Classrooms 220B & 220A <i>second floor</i>	Proposed Use: Portland Arts and Technology High School - Classrooms 220B & 220A - change floor plan to create better air flow - <i>recalifier.</i>	Permit Fee: \$120.00	Cost of Work: \$10,000.00	CEO District: 5
		FIRE DEPT: <i>w/conditions</i> <input checked="" type="checkbox"/> Approved <input type="checkbox"/> Denied <i>12/14/10</i>	INSPECTION: Use Group: <i>E</i> Type: <i>2B</i> <i>IBC, 2009</i>	

Proposed Project Description: Classrooms 220B & 220A - change floor plan to create better air flow	Signature: <i>[Signature]</i>	Signature: <i>[Signature]</i>
PEDESTRIAN ACTIVITIES DISTRICT (P.A.D.)		
Action: <input type="checkbox"/> Approved <input type="checkbox"/> Approved w/Conditions <input type="checkbox"/> Denied		
Signature: _____ Date: _____		

Permit Taken By: Idobson	Date Applied For: 12/09/2010	Zoning Approval		
-----------------------------	---------------------------------	------------------------	--	--

<p>1. This permit application does not preclude the Applicant(s) from meeting applicable State and Federal Rules.</p> <p>2. Building permits do not include plumbing, septic or electrical work.</p> <p>3. Building permits are void if work is not started within six (6) months of the date of issuance. False information may invalidate a building permit and stop all work..</p>	<p align="center">Special Zone or Reviews</p> <input type="checkbox"/> Shoreland <input type="checkbox"/> Wetland <input type="checkbox"/> Flood Zone <input type="checkbox"/> Subdivision <input type="checkbox"/> Site Plan <p>Maj <input type="checkbox"/> Minor <input type="checkbox"/> MM <input type="checkbox"/></p> <p><i>OK w/conditions</i> Date: <i>12/17/10 ABM</i></p>	<p align="center">Zoning Appeal</p> <input type="checkbox"/> Variance <input type="checkbox"/> Miscellaneous <input type="checkbox"/> Conditional Use <input type="checkbox"/> Interpretation <input type="checkbox"/> Approved <input type="checkbox"/> Denied <p>Date: _____</p>	<p align="center">Historic Preservation</p> <input checked="" type="checkbox"/> Not in District or Landmark <input type="checkbox"/> Does Not Require Review <input type="checkbox"/> Requires Review <input type="checkbox"/> Approved <input type="checkbox"/> Approved w/Conditions <input type="checkbox"/> Denied <p><i>ABM</i> Date: _____</p>
	<p>PERMIT ISSUED</p> <p>DEC 17 2010</p> <p>City of Portland</p>		

CERTIFICATION

I hereby certify that I am the owner of record of the named property, or that the proposed work is authorized by the owner of record and that I have been authorized by the owner to make this application as his authorized agent and I agree to conform to all applicable laws of this jurisdiction. In addition, if a permit for work described in the application is issued, I certify that the code official's authorized representative shall have the authority to enter all areas covered by such permit at any reasonable hour to enforce the provision of the code(s) applicable to such permit.

SIGNATURE OF APPLICANT _____ ADDRESS _____ DATE _____ PHONE _____

RESPONSIBLE PERSON IN CHARGE OF WORK, TITLE _____ DATE _____ PHONE _____

BUILDING PERMIT INSPECTION PROCEDURES

Please call 874-8703 or 874-8693 (ONLY)
or email: buildinginspections@portlandmaine.gov

With the issuance of this permit, the owner, builder or their designee is required to provide adequate notice to the City of Portland Inspection Services for the following inspections. Appointments must be requested 48 to 72 hours in advance of the required inspection. The inspection date will need to be confirmed by this office.

- Please read the conditions of approval that is attached to this permit!! Contact this office if you have any questions.
- Permits expire in 6 months, if the project is not started or ceases for 6 months.
- If the inspection requirements are not followed as stated below additional fees may be incurred due to the issuance of a "Stop Work Order" and subsequent release to continue with construction.

Framing/Rough Plumbing/Electrical: Prior to Any Insulating, drywalling or covering.

Final inspection required at completion of work.

The project cannot move to the next phase prior to the required inspection and approval to continue, REGARDLESS OF THE NOTICE OR CIRCUMSTANCES.

IF THE PERMIT REQUIRES A CERTIFICATE OF OCCUPANCY, IT MUST BE PAID FOR AND ISSUED TO THE OWNER OR DESIGNEE BEFORE THE SPACE MAY BE OCCUPIED.

PERMIT ISSUED

DEC 17 2010

City of Portland

City of Portland, Maine - Building or Use Permit

389 Congress Street, 04101 Tel: (207) 874-8703, Fax: (207) 874-8716

Permit No: 10-1506	Date Applied For: 12/09/2010	CBL: 343 C013001
-----------------------	---------------------------------	---------------------

Location of Construction: 196 ALLEN AVE	Owner Name: CITY OF PORTLAND	Owner Address: 389 CONGRESS ST	Phone:
Business Name:	Contractor Name: City of Portland /Trades Division	Contractor Address:	Phone
Lessee/Buyer's Name	Phone:	Permit Type: Alterations - Commercial	

Proposed Use: Portland Arts and Technology High School - Classrooms 220B & 220A - change floor plan to create better air flow	Proposed Project Description: Classrooms 220B & 220A - change floor plan to create better air flow
--	---

Dept: Zoning **Status:** Approved with Conditions **Reviewer:** Ann Machado **Approval Date:** 12/09/2010

Note: **Ok to Issue:** ✓

- 1) This permit is being approved on the basis of plans submitted. Any deviations shall require a separate approval before starting that work.

Dept: Building **Status:** Approved with Conditions **Reviewer:** Jonathan Rioux **Approval Date:** 12/17/2010

Note: **Ok to Issue:** ✓

- 1) Separate permits are required for any electrical, plumbing, sprinkler, fire alarm HVAC systems, heating appliances, including pellet/wood stoves, commercial kitchen exhaust hood systems and fuel tanks. Separate plans may need to be submitted for approval as a part of this process

Dept: Fire **Status:** Approved with Conditions **Reviewer:** Ben Wallace Jr. **Approval Date:** 12/14/2010

Note: **Ok to Issue:** ✓

- 1) A separate Suppression System Permit is required for all new suppression systems or sprinkler work effecting more than 20 heads.
- 2) A separate Fire Alarm Permit is required for new systems; or for work effecting more than 5 fire alarm devices; or replacement of a fire alarm panel with a different model .
- 3) Fire extinguishers required. Installation per NFPA 10
- 4) Walls in structure are to be labeled according to fire resistance rating.
IE;) hr. / 2 hr. / smokeproof.
- 5) Emergency lights and exit signs are required Emergency lights and exit signs are required to be labeled in relation to the panel and circuit.
- 6) The new corridor shall be smoke partitions
- 7) All construction shall comply with City Code Chapter 10.

PERMIT ISSUED

DEC 17 2010

City of Portland

All Purpose Building Permit Application

If you or the property owner owes real estate or personal property taxes or user charges on any property within the City, payment arrangements must be made before permits of any kind are accepted.

Location/Address of Construction: <u>1800 PATHS 196 ALLEN AVE</u>		
Total Square Footage of Proposed Structure		Square Footage of Lot
Tax Assessor's Chart, Block & Lot Chart# Block# Lot#	Owner: <u>CITY OF PORTLAND</u>	Telephone: <u>874-8893</u>
Lessee/Buyer's Name (If Applicable)	Applicant name, address & telephone: <u>CITY OF PORTLAND 389 CONGRESS ST PTLD, ME 04101</u>	Cost Of Work: \$ <u>10,000</u> Fee: \$
Current use: <u>STORAGE / CLASSROOM</u>		
If the location is currently vacant, what was prior use: _____		
Approximately how long has it been vacant: _____		
Proposed use: <u>CLASSROOM</u>		
Project description: <u>TO CREATE BETTER AIR FLOW INTO THE CLASSROOM</u>		
Contractor's name, address & telephone: <u>CITY OF PORTLAND 389 CONGRESS ST PTLD, ME 04101</u> <u>874-8893</u>		
Who should we contact when the permit is ready: <u>KATHY ALVES</u>		
Mailing address: _____		
We will contact you by phone when the permit is ready. You must come in and pick up the permit and review the requirements before starting any work, with a Plan Reviewer. A stop work order will be issued and a \$100.00 fee if any work starts before the permit is picked up. PHONE: <u>333-8523</u>		

RECEIVED
DEC - 9 2010
Dept. of Building Inspections
City of Portland, Maine

IF THE REQUIRED INFORMATION IS NOT INCLUDED IN THE SUBMISSIONS THE PERMIT WILL BE AUTOMATICALLY DENIED AT THE DISCRETION OF THE BUILDING/PLANNING DEPARTMENT, WE MAY REQUIRE ADDITIONAL INFORMATION IN ORDER TO APPROVE THIS PERMIT.

I hereby certify that I am the Owner of record of the named property, or that the owner of record authorizes the proposed work and that I have been authorized by the owner to make this application as his/her authorized agent. I agree to conform to all applicable laws of this jurisdiction. In addition, if a permit for work described in this application is issued, I certify that the Code Official's authorized representative shall have the authority to enter all areas covered by this permit at any reasonable hour to enforce the provisions of the codes applicable to this permit.

Signature of applicant: <u>Kathy Alves</u>	Date: <u>10/2/10</u>
--	----------------------

This is NOT a permit, you may not commence ANY work until the permit is issued.
If you are in a Historic District you may be subject to additional permitting and fees with the Planning Department on the 4th floor of City Hall

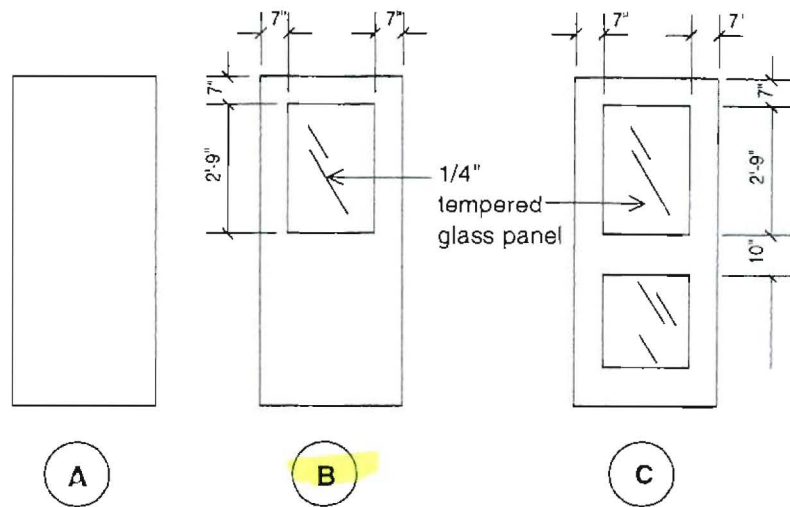

DOOR TYPES

1/4" = 1' 0"

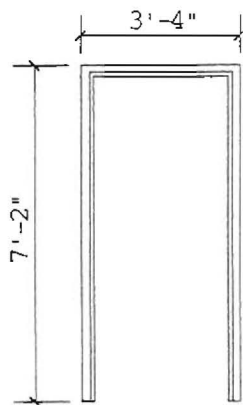

F1

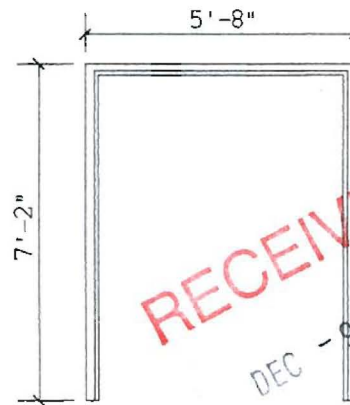

F2

FRAME TYPES

RECEIVED

DEC - 9 2010

Dept. of Building Inspections
City of Portland Maine

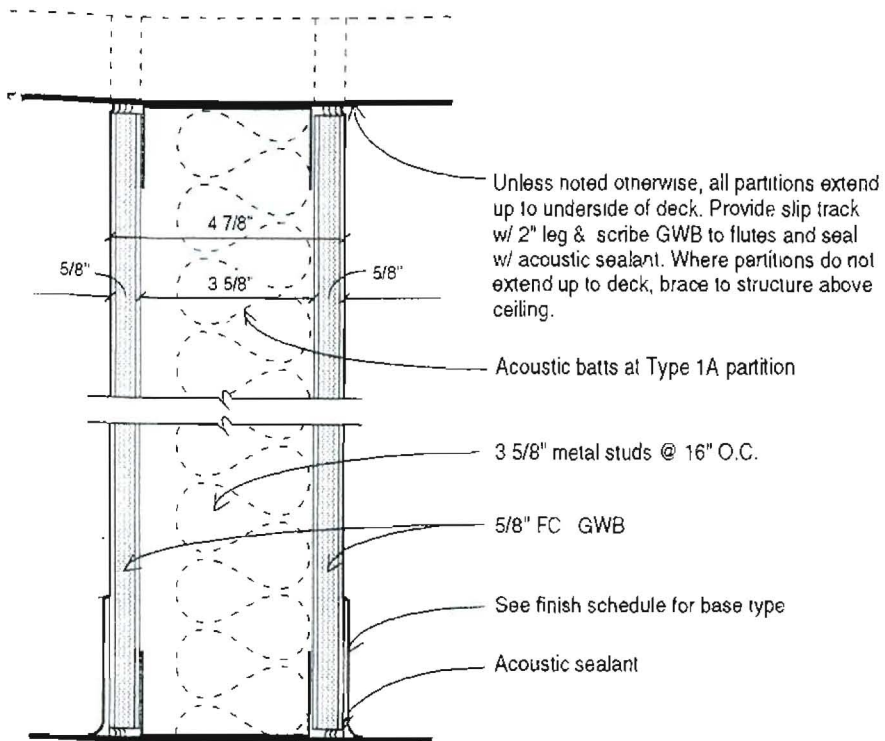

1
TYPE

1

AS DRAWN

1A

WITH ACOUSTIC BATTS

RECEIVED

-9 200

rections
re

Proposed

1705 Sq Ft

Non-load bearing



NEW DOOR

CBHS
NEW
CLASS ROOM
#11

24'-0"

TRAVEL
DISTANCE:
44'-0"

REMOVE DOOR
AND WALL

EXISTING
CORRIDOR

EXIT

3
4

PROPOSED AREA FOR RENOVATION 1705 Sq FT

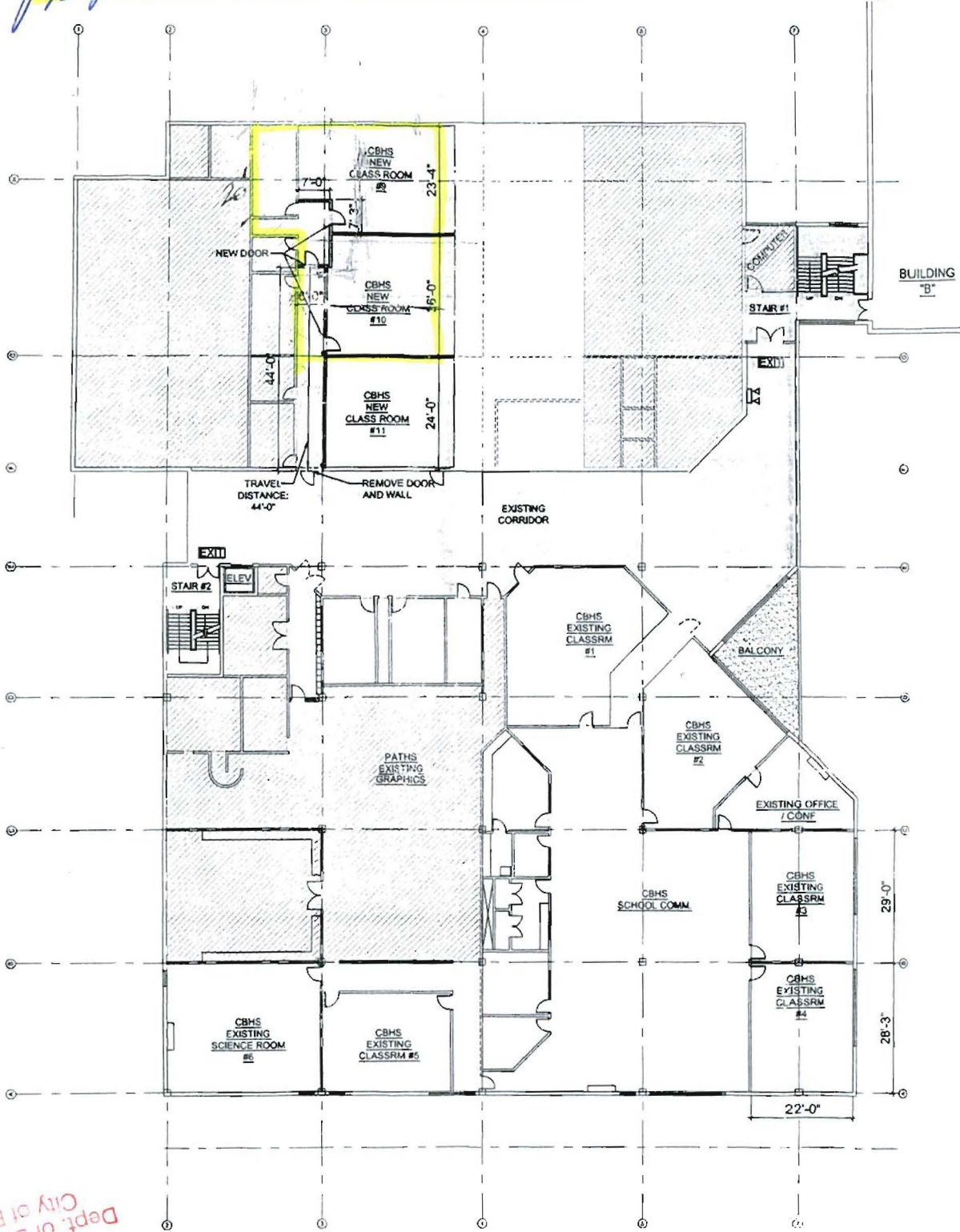

- KEY**
- GENERAL CIRCULATION
 - EXISTING PATHS
 - EXISTING CBHS
 - NEW CBHS
 - NEW WALL



PATHS & CBHS
196 ALLEN AVE, PORTLAND, ME

SEMPLE & DRANE ARCHITECTS
AUGUST 2007

LIFE SAFETY PLAN
SECOND FLOOR

Dept. of Building Inspections
City of Portland Maine

RECEIVED
DEC - 9 2007