

DISPLAY THIS CARD ON PRINCIPAL FRONTAGE OF WORK CITY OF PORTLAND

BUILDING INSPECTION

Please Read Application And Notes, If Any, Attached

Permit Number 08063
PERMIT ISSUED
JUN - 9 2008
CITY OF PORTLAND

This is to certify that LI XI HONG & LI DONG LIMITED

has permission to add 10' x 13' deck on back

AT 65 RUBY LN 342 B032001

provided that the person or persons, firm or corporation accepting this permit shall comply with all of the provisions of the Statutes of the State and of the Ordinances of the City of Portland regulating the construction, maintenance and use of buildings and structures, and of the application on file in this department.

Apply to Public Works for street line and grade if nature of work requires such information.

Notification of inspection must be given and when permission procured before this building or part thereof is lashed or closed-in. 24 HOUR NOTICE IS REQUIRED.

A certificate of occupancy must be procured by owner before this building or part thereof is occupied.

OTHER REQUIRED APPROVALS

Fire Dept. _____
Health Dept. _____
Appeal Board _____
Other _____
Department Name

Director - Building & Inspection Services

PENALTY FOR REMOVING THIS CARD

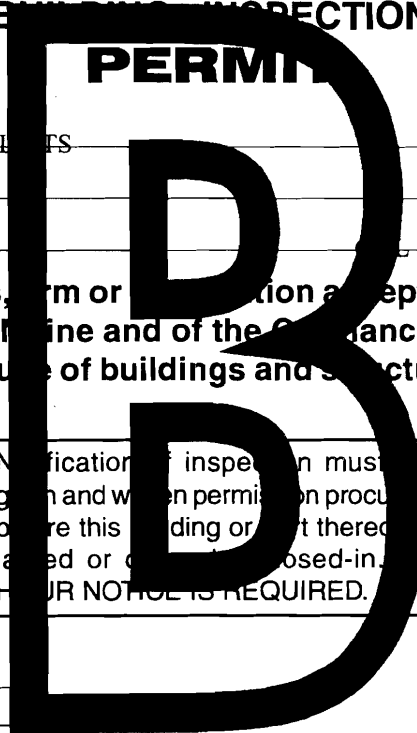

City of Portland, Maine - Building or Use Permit Application

389 Congress Street, 04101 Tel: (207) 874-8703, Fax: (207) 874-8716

Permit No: 08-0633	Issue Date:	CBL: 342 B032001
------------------------------	--------------------	----------------------------

Location of Construction: 65 RUBY LN	Owner Name: LI XI HONG & LI DONG LI JTS	Owner Address: 65 RUBY LN	Phone:
Business Name:	Contractor Name:	Contractor Address:	Phone:
Lessee/Buyer's Name	Phone:	Permit Type: Additions - Dwellings	Zone:

Past Use: Single Family Home	Proposed Use: Single Family Home - add 10' x 13' deck on back	Permit Fee: \$40.00	Cost of Work: \$2,000.00	CEO District: 5
		FIRE DEPT: <input type="checkbox"/> Approved <input type="checkbox"/> Denied	INSPECTION: Use Group: Type:	

Proposed Project Description: add 10' x 13' deck on back	Signature:	Signature:
PEDESTRIAN ACTIVITIES DISTRICT (P.A.D.)		
Action: <input type="checkbox"/> Approved <input type="checkbox"/> Approved w/Conditions <input type="checkbox"/> Denied		
Signature:	Date:	

Permit Taken By: Idobson	Date Applied For: 06/03/2008	Zoning Approval	
------------------------------------	--	------------------------	--

<ol style="list-style-type: none"> This permit application does not preclude the Applicant(s) from meeting applicable State and Federal Rules. Building permits do not include plumbing, septic or electrical work. Building permits are void if work is not started within six (6) months of the date of issuance. False information may invalidate a building permit and stop all work.. 	Special Zone or Reviews <input type="checkbox"/> Shoreland <input type="checkbox"/> Wetland <input type="checkbox"/> Flood Zone <input type="checkbox"/> Subdivision <input type="checkbox"/> Site Plan Maj <input type="checkbox"/> Minor <input type="checkbox"/> MM <input type="checkbox"/> Date:	Zoning Appeal <input type="checkbox"/> Variance <input type="checkbox"/> Miscellaneous <input type="checkbox"/> Conditional Use <input type="checkbox"/> Interpretation <input type="checkbox"/> Approved <input type="checkbox"/> Denied Date:	Historic Preservation <input type="checkbox"/> Not in District or Landmark <input type="checkbox"/> Does Not Require Review <input type="checkbox"/> Requires Review <input type="checkbox"/> Approved <input type="checkbox"/> Approved w/Conditions <input type="checkbox"/> Denied Date:
---	---	---	---

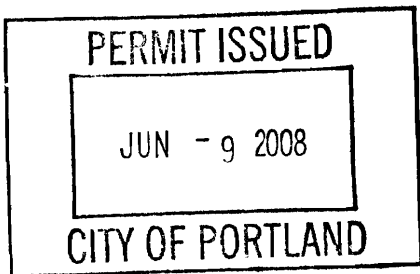

CERTIFICATION

I hereby certify that I am the owner of record of the named property, or that the proposed work is authorized by the owner of record and that I have been authorized by the owner to make this application as his authorized agent and I agree to conform to all applicable laws of this jurisdiction. In addition, if a permit for work described in the application is issued, I certify that the code official's authorized representative shall have the authority to enter all areas covered by such permit at any reasonable hour to enforce the provision of the code(s) applicable to such permit.

SIGNATURE OF APPLICANT _____ ADDRESS _____ DATE _____ PHONE _____

RESPONSIBLE PERSON IN CHARGE OF WORK, TITLE _____ DATE _____ PHONE _____

City of Portland, Maine - Building or Use Permit

389 Congress Street, 04101 Tel: (207) 874-8703, Fax: (207) 874-8716

Permit No: 08-0633	Date Applied For: 06/03/2008	CBL: 342 B032001
------------------------------	--	----------------------------

Location of Construction: 65 RUBY LN	Owner Name: LI XI HONG & LI DONG LI JTS	Owner Address: 65 RUBY LN	Phone:
Business Name:	Contractor Name:	Contractor Address:	Phone:
Lessee/Buyer's Name	Phone:	Permit Type: Additions - Dwellings	

Proposed Use: Single Family Home - add 10' x 13' deck on back	Proposed Project Description: add 10' x 13' deck on back
---	--

Dept: Zoning	Status: Approved	Reviewer: Chris Hanson	Approval Date: 06/09/2008	Ok to Issue: <input checked="" type="checkbox"/>
Note:				
Dept: Building	Status: Approved with Conditions	Reviewer: Chris Hanson	Approval Date: 06/09/2008	Ok to Issue: <input checked="" type="checkbox"/>
Note:				
1) Open risers are permitted, provided that the opening between treads does not permit the passage of a 4" diameter sphere.				
2) As discussed during the review process, ballusters must be spaced with less than a 4" opening between each.				
3) Application approval based upon information provided by applicant. Any deviation from approved plans requires separate review and approval prior to work.				



General Building Permit Application

If you or the property owner owes real estate or personal property taxes or user charges on any property within the City, payment arrangements must be made before permits of any kind are accepted.

Location/Address of Construction: 65 RUBY LANE		
Total Square Footage of Proposed Structure/Area 130 SQ. FT.		Square Footage of Lot .026 ACRE
Tax Assessor's Chart, Block & Lot Chart# 342 Block# B Lot# 32		Applicant * must be owner, Lessee or Buyer * Name XI HONG LI Address 65 RUBY LANE City, State & Zip PORTLAND, ME .04103
Telephone: 207-797-7625 AM.		
Lessee/DBA (If Applicable) N/A	Owner (if different from Applicant) Name (SAME) Address City, State & Zip	Cost Of Work: \$ 2000.+- C of O Fee: \$ _____ Total Fee: \$ 2000.+-
Current legal use (i.e. single family) SINGLE FAMILY If vacant, what was the previous use? N/A Proposed Specific use: SINGLE FAMILY Is property part of a subdivision? YES If yes, please name OAKRIDGE SUBDIVISION Project description: 10X13 DECK ON BACK		
Contractor's name: HOME OWNER		
Address: _____		
City, State & Zip _____		Telephone: _____
Who should we contact when the permit is ready: HOME OWNER		Telephone: _____
Mailing address: _____		

Please submit all of the information outlined on the applicable Checklist. Failure to do so will result in the automatic denial of your permit.

In order to be sure the City fully understands the full scope of the project, the Planning and Development Department may request additional information prior to the issuance of a permit. For further information or to download copies of this form and other applications visit the Inspections Division on-line at www.portlandmaine.gov, or stop by the Inspections Division office, room 315 City Hall or call 874-8703.

I hereby certify that I am the Owner of record of the named property, or that the owner of record authorizes the proposed work and that I have been authorized by the owner to make this application as his/her authorized agent. I agree to conform to all applicable laws of this jurisdiction. In addition, if a permit for work described in this application is issued, I certify that the Code Official's authorized representative shall have the authority to enter all areas covered by this permit at any reasonable hour to enforce the provisions of the codes applicable to this permit.

Signature: *Xi Hong Li* Date: 06/03/08

This is not a permit; you may not commence ANY work until the permit is issue

(A)

XI HONG LI
65 RUBY LANE
PORTLAND, ME
797-7625

— FOUNDATION SYSTEM —

1 SEE ATTACHMENT LABELED ①

2a. FOUNDATION FOR DECK WILL BE 3
12" CONCRETE FILLED TUBES

2b. TUBES WILL BE 4' IN THE
GROUND

2c. COLUMNS WILL BE IN POST
HOLDERS BOLTED TO CONCRETE
WITH $\frac{3}{8}$ " BOLTS IN HILTI
EXPANDABLE ANCHORS

2d. SEE ATTACHMENT LABELED ②d.
— FRAMING MEMBERS —

3a. COLUMNS WILL BE 6x6
PRESSURE TREATED SITTING ON
CONCRETE FILLED TUBES. SEE
ATTACHMENT ②d.

3b. LEDGER SIZE WILL BE 2"x10"x13'
PRESSURE TREATED WITH FLASHING
OVER THE TOP

3c. FASTER SIZE IS $\frac{3}{8}$ " x 4" LAG
BOLTS SPACED 16" ON CENTER AND
10' GALVANIZED NAILS

(13)

XI HONG LI
65 RUBY LANE
PORTLAND, ME
797-7625

3d. GIRDER SIZE FOR THE DECK WILL BE 3 - 2"x8"x13' PRESSURE TREATED NAILED TOGETHER

3e. FLOOR JOISTS FOR THE DECK WILL BE 2"x8"x10' SPACED 16" O.C. WITH BRIDGING ACROSS THE CENTER. THEY WILL SPAN 10'.

3f. FLOOR JOISTS WILL BE NAILED AND SUPPORTED BY JOIST HANGERS ON EACH END.

— GUARD RAILS & HAND RAILS —

4a. GUARD RAIL HEIGHT WILL BE 36"~~36"~~

4b. BALUSTER SPACING WILL BE 4" OR LESS CENTER TO CENTER

4c. HAND RAIL HEIGHT WILL BE 37½"

©

XI HONG LI
65 RUBY LANE
PORTLAND, ME.
797-7625

— STAIR DETAILS —

4a. TREAD DEPTH WILL BE 11"

4b. RISER HEIGHT WILL BE 7"

4c. NOSING ON TREAD WILL BE
1" OR LESS

4d. WIDTH OF STAIRS WILL BE
36"

①

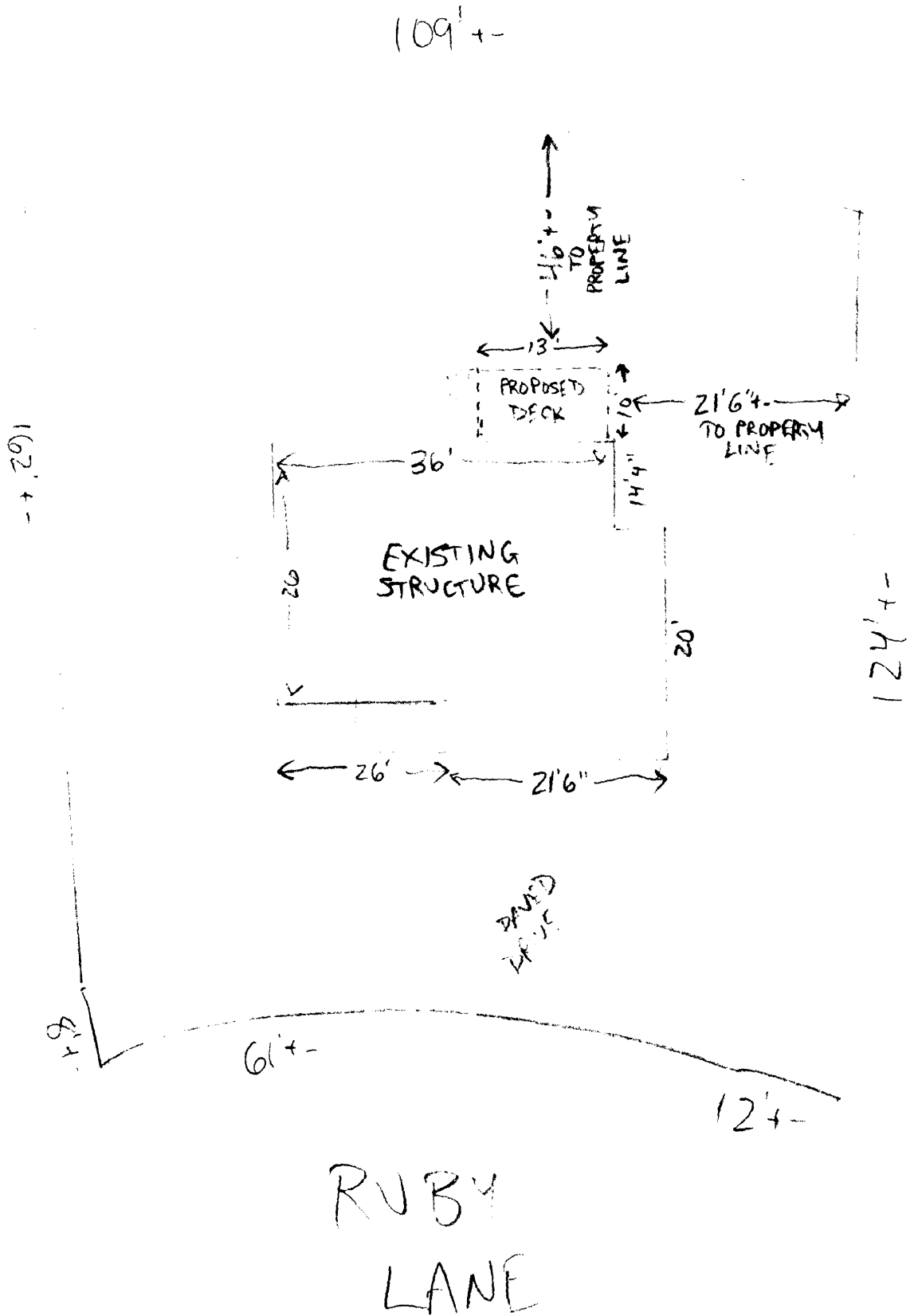

2d)

SPRINKLER

TUBES / PIPES

2d

13

16

STAIRS

170

17

18

PROPOSED

EXISTING STAIRS

BUILDING PERMIT INSPECTION PROCEDURES

Please call 874-8703 or 874-8693 (ONLY)

to schedule your inspections as agreed upon

Permits expire in 6 months, if the project is not started or ceases for 6 months.

The Owner or their designee is required to notify the inspections office for the following inspections and provide adequate notice. Notice must be called in 48-72 hours in advance in order to schedule an inspection:

By initializing at each inspection time, you are agreeing that you understand the inspection procedure and additional fees from a "Stop Work Order" and "Stop Work Order Release" will be incurred if the procedure is not followed as stated below.

A Pre-construction Meeting will take place upon receipt of your building permit.

 X **Footing/Building Location Inspection: Prior to pouring concrete or setting precast piers**

 X **Framing/Rough Plumbing/Electrical: Prior to Any Insulating or drywalling**

 X **Final inspection required at completion of work.**

Certificate of Occupancy is not required for certain projects. Your inspector can advise you if your project requires a Certificate of Occupancy. All projects DO require a final inspection.

If any of the inspections do not occur, the project cannot go on to the next phase, REGARDLESS OF THE NOTICE OR CIRCUMSTANCES.

CERIFICATE OF OCCUPANICES MUST BE ISSUED AND PAID FOR, BEFORE THE SPACE MAY BE OCCUPIED.



Signature of Applicant/Designee

 06/29/08
Date

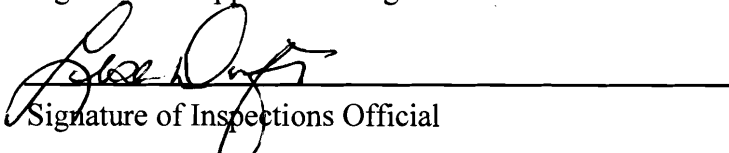

Signature of Inspections Official

 6/09/08
Date