



342 B 029
 PERMIT ISSUED
 DEC 29 2005
 CITY OF PORTLAND

Installer's name and address

Biddisford m

South

3

Location of appliance:

- Basement
- Attic
- Floor
- Roof

Type of Fuel:

- Gas
- Oil
- Solid

Appliance Name:

U.L. Approved Yes No

Will appliance be installed in accordance with the manufacture's installation instructions? Yes No

IF NO Explain:

The Type of License of Installer:

- Master Plumber # 175 9000 9184
- Solid Fuel #
- Oil #
- Gas #
- Other

Type of Chimney:

- Masonry Lined
- Metal
- Direct Vent

Factory built _____

Factory Built U.L. Listing # _____

Type _____ UL# _____

Type of Fuel Tank

- Oil
- Gas

Size of Tank 275

Number of Tanks 1

Distance from Tank to Center of Flame 18 ft feet.

Cost of Work: \$ 4,500.00

Permit Fee: \$ ~~66~~ 66

DEPT. OF BUILDING INSPECTION
 CITY OF PORTLAND, ME
 DEC 29 2005
 RECEIVED

Approved

Approved with Conditions

Fire: _____

Ele.: _____

Bldg.: _____

- See attached letter or requirement

[Signature]
 Inspector's Signature

12/29/05
 Date Approved

Signature of Installer _____

Lot 11 & 10

40-0

40-4

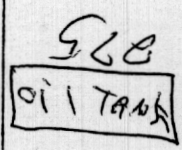
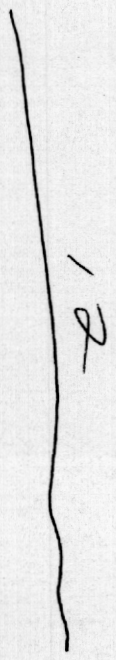
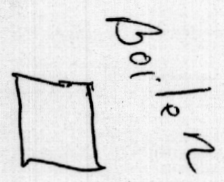

24

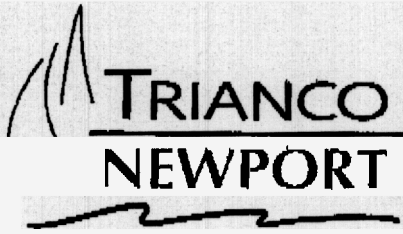

OIL FIRED BOILER

Setting

The Standard

In Vertical

Tube Boilers

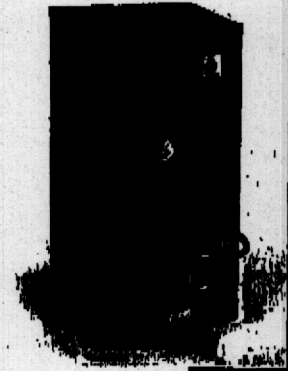

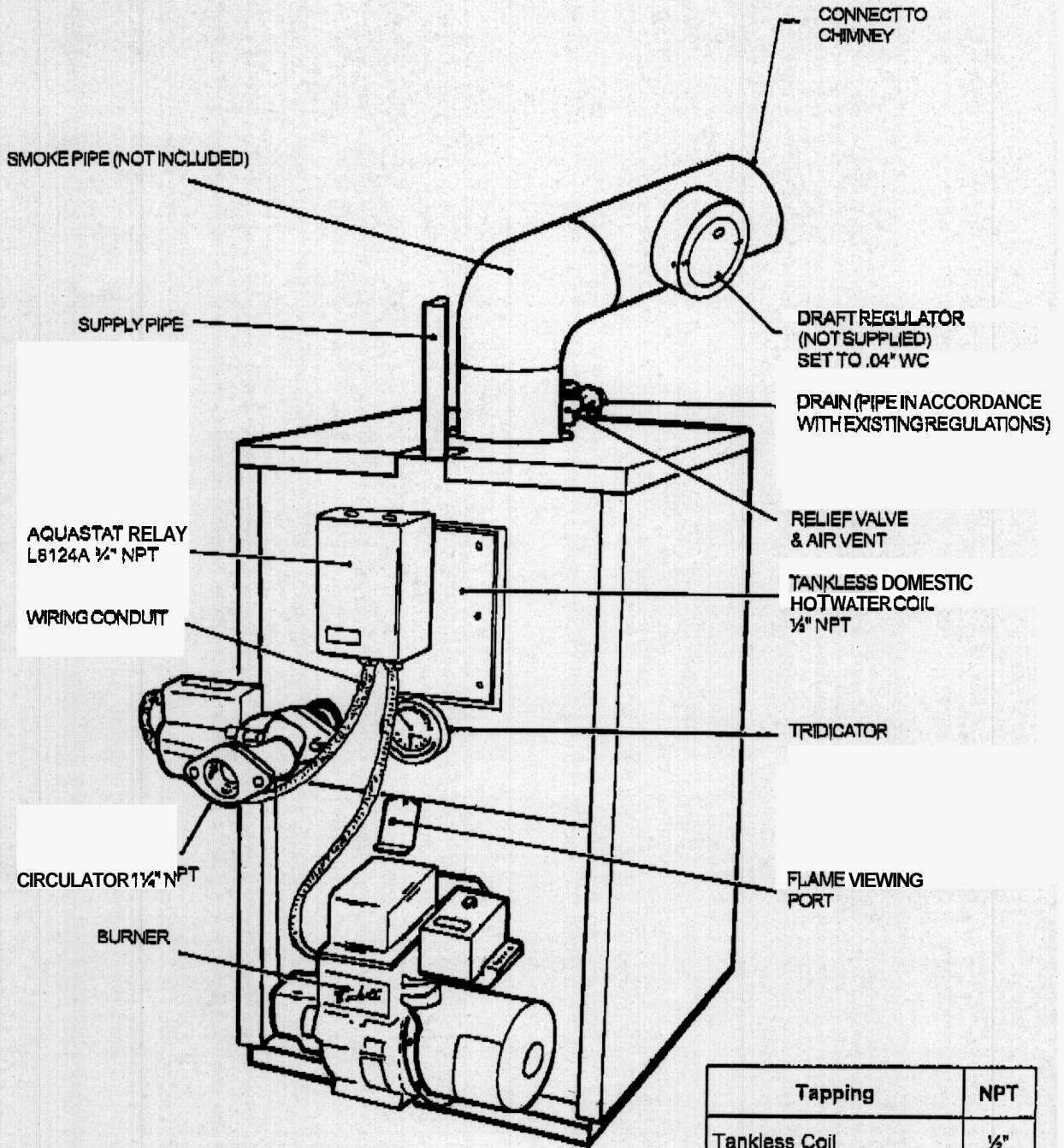

AQUASTAT RELAY
 L8124A 1/2" NPT

WIRING CONDUIT

CIRCULATOR 1 1/4" NPT

BURNER

CONNECT TO
 CHIMNEY

DRAFT REGULATOR
 (NOT SUPPLIED)
 SET TO .04" WC

DRAIN (PIPE IN ACCORDANCE
 WITH EXISTING REGULATIONS)

RELIEF VALVE
 & AIR VENT

TANKLESS DOMESTIC
 HOT WATER COIL
 1/2" NPT

TRIDICATOR

FLAME VIEWING
 PORT

Tapping	NPT
Tankless Coil	1/2"
Tridicator	1/4"
Hydronic Return	1 1/4"
Hydronic Supply	1 1/4"
Aquastat Well	3/8"
Relief Valve Fitting	3/4"

Figure 2. Components Location.



The highly efficient Newport from Trianco has

AFUE's of 83% plus at every single firing rate without incurring the additional cost of vent dampers, (compare this to other vertical tube boilers).

Our quality constructed Newport boiler consists of an ASME tested vessel, a raised flange for the domestic hot water coil and a front accessible combustion chamber for ease of service.

At Trianco we are proud to offer quality products such as the Newport and our confidence is reflected in our non-prorated lifetime warranty covering all Trianco steel vessels.

Try the Trianco Advantage!

Standard Features

- Limited Lifetime Non-Prorated Warranty
- Powder coated steel jacket
- Heavy duty insulation & inspection port
- Heavy gauge combustion chamber
- Circulator (mounted)
- Honeywell Aquastat L8124A
- Raised coil flange with plated nuts
- Flue turbulators
- Tridicator
- Beckett burner
- Pressure relief valve
- Units are completely packaged

YOUR TRIANCO EXPERT:

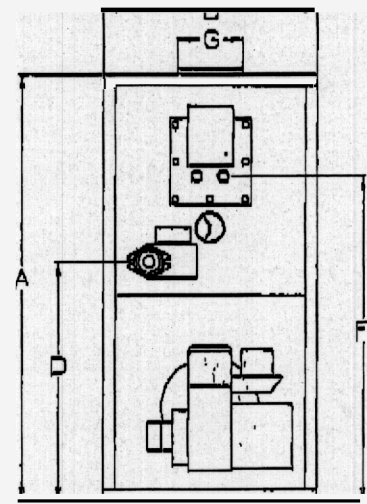
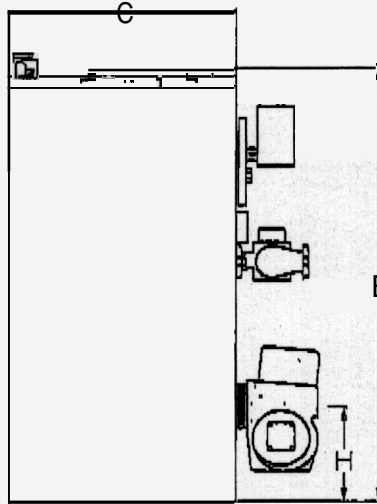

Specifications	NP 75	NP 85	NP 100	NP 110	NP 125	NP 135	NP 150
Firing Rate GPH	.75	.85	1	1.1	1.25	1.35	1.5
DOE Output (BTU/hr)	85	108.8	120	133.2	150	160.2	177.6
Efficiency % (AFUE)	83.2	83.6	83.1	83.1	83.7	83.0	83.0
Net Stack Temp.	375	312	353	371	351	366	417
Shipping Weight	285	310	310	310	368	368	368
Water Content	9.75	11.6	11.6	11.6	15.4	15.4	15.4
Coil Size (GPM)	4	4	5	5	5	5	5

Dimensions	Ref	NP 75	NP 85	NP 100	NP 110	NP 125	NP 135	NP 150
Jacket Height	A	33	35 1/2	35 1/2	35 1/2	41	41	41
Jacket Width	B	19 1/4	19 1/4	19 1/4	19 1/4	20 1/2	20 1/2	20 1/2
Jacket Depth	C	20	20	20	20	21 1/2	21 1/2	21 1/2
Return Tapping Height	D	19 1/2	19 1/2	19 1/2	19 1/2	22	22	22
Supply Tapping Height	E	31 1/2	33 1/2	33 1/2	33 1/2	38	38	38
Coil Supply Height	F	25	27 1/2	27 1/2	27 1/2	31 1/2	31 1/2	31 1/2
Smoke Outlet Diameter	G	6	6	6	6	6	6	6
Burner Center Line	H	8 1/2	8 1/2	8 1/2	8 1/2	10 1/2	10 1/2	10 1/2
Tankless Coil NPT		1/2	1/2	1/2	1/2	1/2	1/2	1/2
Return NPT		1/4	1/4	1/4	1/4	1/4	1/4	1/4



TRIANCO HEATMAKER

Trianco-Heatmaker, Inc., 111 York Avenue
 Randolph, MA 02368 Tel: (781) 986-9100 • Fax: (781) 986-9907

Trianco Heatmaker reserves the right to make product changes or improvements at any time without notice.