

120 Allen Avenue, Portland Dimensioned Floor Plan

File No. 231-1056352 Page #12

Building Sketch (Page - 1)

Borrower/Client	GRECO, Michaela D		
Property Address	120 Allen Avenue		
City	Portland	County	Cumberland
		State	ME
		Zip Code	D4103-3806
Lender	Residential Mortgage Services		

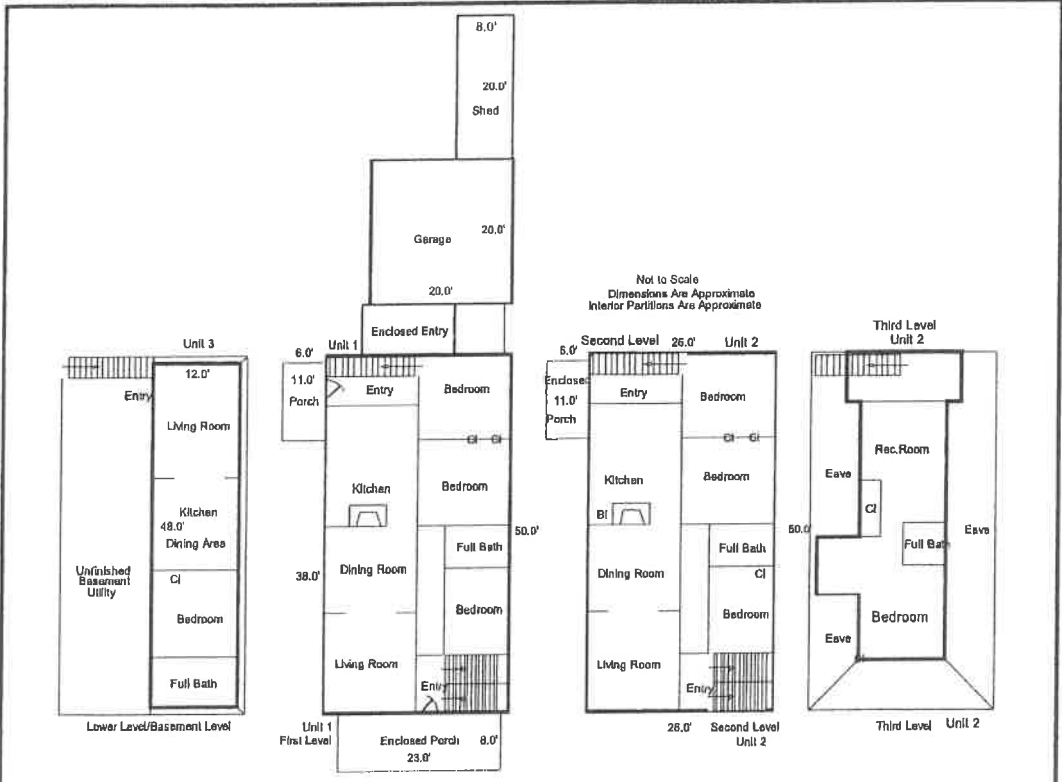

Sketch by Apex™

Comments:

AREA CALCULATIONS SUMMARY			
Code	Description	Net Size	Net Totals
GLA1	First Floor/Unit 1	1300.0	1300.0
GLA2	Second Floor/Unit 2	1300.0	1300.0
GLA3	Basement/Unit 3	576.0	576.0
GLA4	Third Floor/Unit 2	592.0	592.0
F/P	Porch	66.0	
	Enclosed Porch	184.0	
	Enclosed Forch	66.0	316.0
GAR	Garage	400.0	400.0
OTH	Enclosed Entry	91.0	
	Attached Shed	160.0	251.0
Net LIVABLE Area (Rounded)			3768

LIVING AREA BREAKDOWN	
Breakdown	Subtotals
First Floor/Unit 1	1300.0
Second Floor/Unit 2	1300.0
Basement/Unit 3	576.0
Third Floor/Unit 2	592.0
6 Items (Rounded)	3768