

**NOTES:**

1. LOT LAYOUT AND GRADING CONFIGURATIONS SHOWN ON THIS PLAN REPRESENT THE INTENDED FINAL DEVELOPMENT OF THE LOT FOR BUILDING PERMIT PURPOSES AS APPROVED BY THE CITY OF PORTLAND PLANNING BOARD ON FEBRUARY 24, 2004. ANY DEVIATION FROM THESE PLANS, BE IT EITHER BUILDING SIZE, PARKING CONFIGURATION, GRADING CHANGES, ETC. SHALL REQUIRE REVIEW AND APPROVAL FROM THE CITY OF PORTLAND PLANNING BOARD, AS WELL AS REVIEW BY THE SUBDIVISION DEVELOPER.
2. TOPOGRAPHIC DATA AND EXISTING CONDITIONS ARE BASED UPON A GROUND SURVEY CONDUCTED BY TITCOMB ASSOCIATES IN 2002.
3. THE CONTRACTOR IS SPECIFICALLY CAUTIONED THAT THE LOCATION AND/OR THE ELEVATION OF THE EXISTING UTILITIES AS SHOWN ON THESE PLANS IS BASED ON RECORDS OF THE VARIOUS UTILITY COMPANIES AND WHERE POSSIBLE MEASUREMENTS TAKEN IN THE FIELD. THIS INFORMATION IS NOT TO BE RELIED ON AS BEING EXACT OR COMPLETE. THE CONTRACTOR MUST CALL THE APPROPRIATE UTILITY COMPANY AND DIG SAFE AT LEAST 72 HOURS PRIOR TO ANY EXCAVATION TO REQUEST EXACT FIELD LOCATION OF UTILITIES. IT SHALL BE THE RESPONSIBILITY OF THE CONTRACTOR TO RELOCATE ALL EXISTING UTILITIES WHICH CONFLICT WITH THE PROPOSED IMPROVEMENTS SHOWN ON THE PLANS.
4. MAINTENANCE OF EROSION CONTROL MEASURES IS OF PARAMOUNT IMPORTANCE TO THE OWNER AND THE CONTRACTOR IS RESPONSIBLE FOR COMPLYING WITH BEST MANAGEMENT PRACTICES EROSION CONTROL MEASURES. ADDITIONAL EROSION CONTROL MEASURES SHALL BE INSTALLED IF DEEMED NECESSARY BY ON-SITE INSPECTIONS OF THE SUBDIVISION DEVELOPER OR THEIR REPRESENTATIVES AT NO ADDITIONAL COST TO THE OWNER.
5. ALL WATER UTILITY MATERIALS AND INSTALLATION METHODS SHALL CONFORM TO PORTLAND WATER DISTRICT STANDARDS. DISINFECTION OF WATER LINES SHALL CONFORM TO AWWA STANDARD C651, LATEST REVISION.
6. ALL SEWER MATERIALS SHALL CONFORM TO THE REQUIREMENTS OF THE CITY OF PORTLAND TECHNICAL AND DESIGN STANDARDS AND GUIDELINES.
7. ALL MATERIALS AND CONSTRUCTION METHODS SHALL CONFORM TO CITY OF PORTLAND TECHNICAL AND DESIGN STANDARDS AND GUIDELINES.
8. LOT DEVELOPER SHALL BE RESPONSIBLE FOR DRIVEWAY CONSTRUCTION BEYOND THE DRIVEWAY APRON AND SIDEWALK.

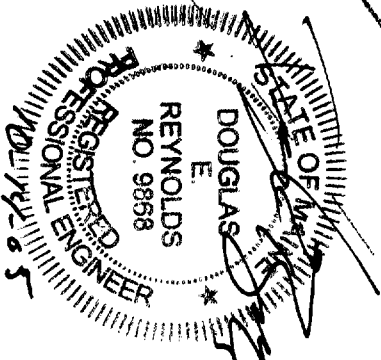

CITY OF PORTLAND  
 APPROVED SITE PLAN  
 Subject to Dept. Conditions  
 Date of Approval: 10-20-05



Design:	DER	Date:	4/04
Draft:	CAH	Job No.:	632
Checked:	DER	Scale:	1"=20'
File Name:	632-LOTS		

**GP**  
 Gorrill-Palmer Consulting Engineers, Inc.  
 Traffic and Civil Engineering Services

P.O. Box 1237  
 13 Stoker Road  
 Gray, ME 04039  
 207-657-6910  
 Fax: 207-657-6912  
 E-Mail: mrobbox@gorrillpalmer.com

Drawing Name: **Lot 12 Lot Layout and Utility Plan**

Project: **CARRIAGE FEE**

Figure No. **2**

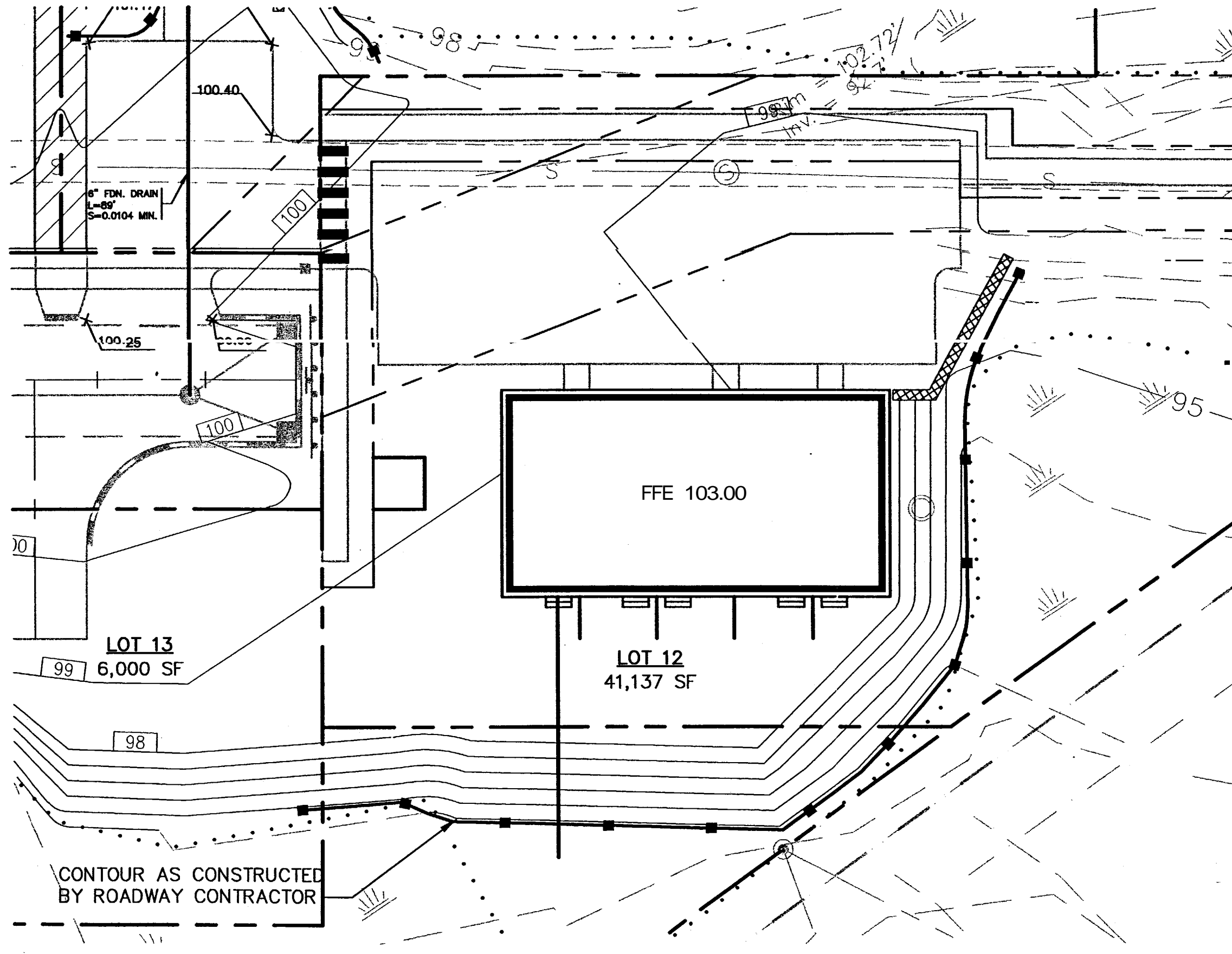

**NOTES:**

1. ALL DISTURBED AREAS NOT SUBJECT TO PAVEMENT OR BUILDING *SHALL* RECEIVE 4" OF LOAM AND SEED.
2. LOT LAYOUT AND GRADING CONFIGURATIONS SHOWN ON THIS PLAN REPRESENT THE INTENDED FINAL DEVELOPMENT OF THE LOT FOR BUILDING PERMIT PURPOSES. ANY DEVIATION FROM **THESE** PLANS, BE IT EITHER BUILDING SIZE, PARKING CONFIGURATION, GRADING CHANGES, ETC. *SHALL* REQUIRE REVIEW AND APPROVAL FROM THE CITY OF PORTLAND PLANNING BOARD, AS WELL AS REVIEW BY THE SUBDIVISION DEVELOPER.
3. ADDITIONAL EROSION CONTROL MEASURES OVER AND ABOVE THOSE USED BY ROADWAY CONTRACTOR MAY BE REQUIRED TO MEET EROSION CONTROL BEST MANAGEMENT PRACTICES.
4. LOT DEVELOPER *SHALL* BE RESPONSIBLE FOR RESTORING FINAL GRADES TO ELEVATIONS PROVIDED BY ROADWAY DEVELOPER. GRADES ADJACENT TO BUILDING *SHALL* BE ADJUSTED TO DIRECT FLOW AWAY FROM STRUCTURES.

CITY OF PORTLAND  
 APPROVED SITE PLAN  
 Subject to Dept. Conditions  
 Date of Approval: 10-20-05

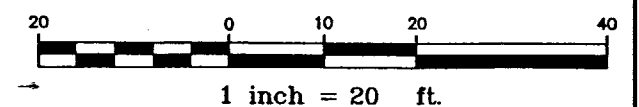
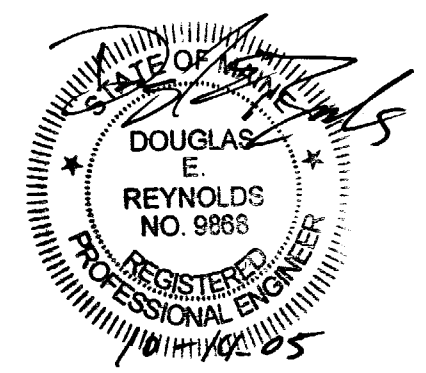

Rev.	Date	Revision

Design: DER	Date: 4/04
Draft: CAH	Job No: 632
Checked: DER	Scale: 1"=20'
File Name: 632-LOTS	

**GP** Gorrill-Palmer Consulting Engineers, Inc.  
 Traffic and Civil Engineering Services

PO Box 1237  
 15 Shaker Road  
 Gray, ME 04039

207-657-6910  
 FAX: 207-657-6012  
 E-Mail: mailbox@gorrillpalmer.com

Drawing Name:	Lot 12 Grading Plan
Project:	CARRIAGE LANE

Figure No.  
**3**

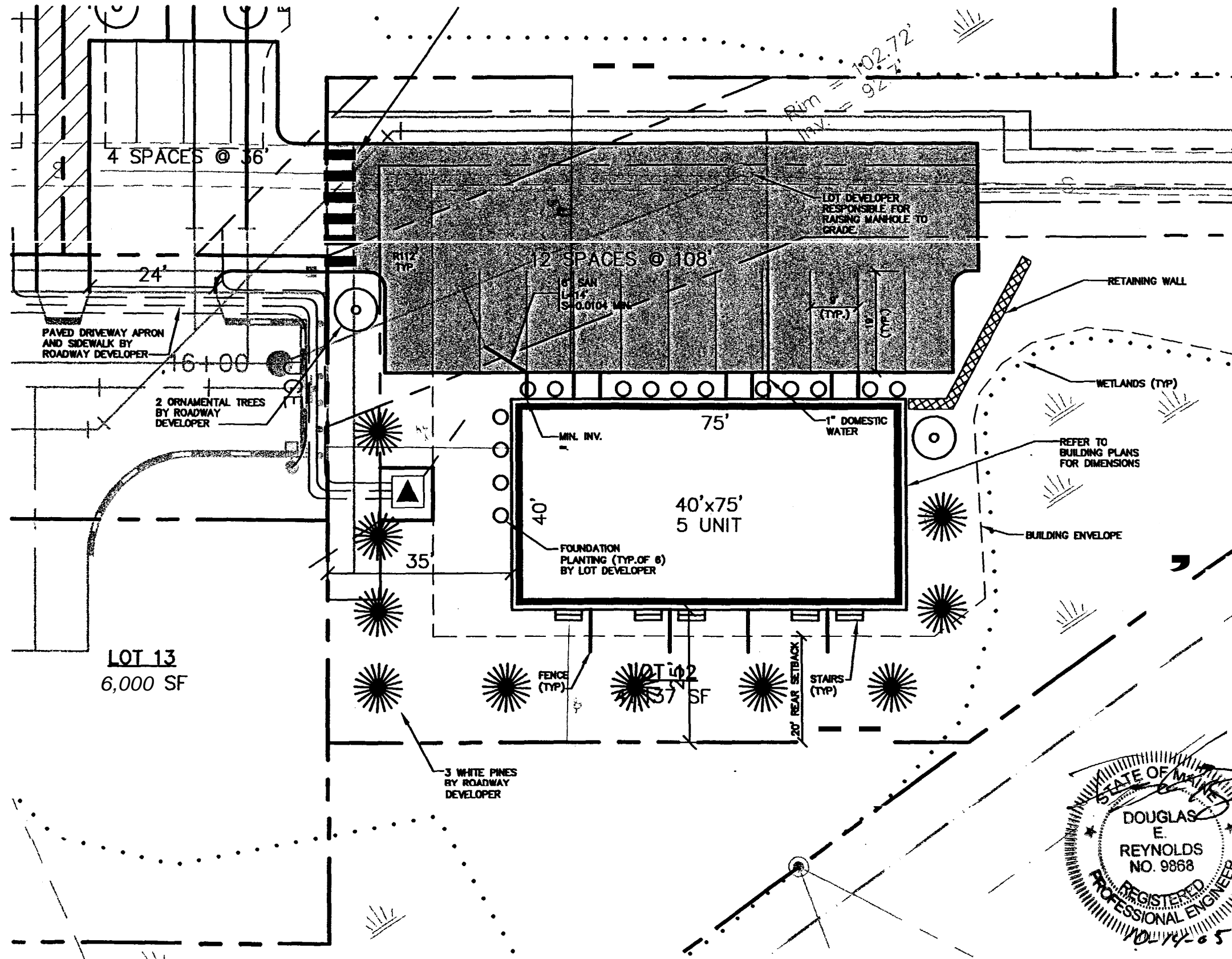

**NOTES:**

1. LOT LAYOUT AND GRADING CONFIGURATIONS SHOW ON M I S PLAN REPRESENT M E INTENDED FINAL DEVELOPMENT OF THE LOT FOR BUILDING PERMIT PURPOSES AS APPROVED BY THE CITY OF PORTLAND PLANNING BOARD ON FEBRUARY 24, 2004. ANY DEVIATION FROM THESE PLANS, BE IT EITHER BUILDING SIZE, PARKING CONFIGURATION, GRADING CHANGES, ETC. SHALL REWIRE REVIEW AND APPROVAL FROM THE CITY OF PORTLAND PLANNING BOARD, AS WELL AS REVIEW BY M E SUBDIVISION DEVELOPER.
2. TOPOGRAPHIC DATA AND EXISTING CONDITIONS ARE BASED UPON A GROUND SURVEY CONDUCTED BY TITCOMB ASSOCIATES IN 2002.
3. THE CONTRACTOR IS SPECIFICALLY CAUTIONED THAT THE LOCATION AND/OR THE ELEVATION OF THE EXISTING UTILITIES AS SHOWN ON THESE PLANS IS BASED ON RECORDS OF THE VARIOUS UTILITY COMPANIES AND WHERE POSSIBLE MEASUREMENTS TAKEN IN THE FIELD. THIS INFORMATION IS NOT TO BE RELIED ON AS BEING EXACT OR COMPLETE. THE CONTRACTOR MUST CALL THE APPROPRIATE UTILITY COMPANY AND DIG SAFE AT LEAST 72 HOURS PRIOR TO ANY EXCAVATION TO REQUEST EXACT FIELD LOCATION OF UTILITIES. IT SHALL BE THE RESPONSIBILITY OF THE CONTRACTOR TO RELOCATE ALL EXISTING UTILITIES WHICH CONFLICT WITH THE PROPOSED IMPROVEMENTS SHOWN ON M E PLANS.
4. MAINTENANCE OF EROSION CONTROL MEASURES IS OF PARAMOUNT IMPORTANCE TO M E OWNER AND THE CONTRACTOR IS RESPONSIBLE FOR COMPLYING WITH BEST MANAGEMENT PRACTICES EROSION CONTROL MEASURES. ADDITIONAL EROSION CONTROL MEASURES SHALL BE INSTALLED IF DEEMED NECESSARY BY ON-SITE INSPECTIONS OF M E SUBDIVISION DEVELOPER OR THEIR REPRESENTATIVES AT NO ADDITIONAL COST TO M E OWNER.
5. ALL WATER UTILITY MATERIALS AND INSTALLATION METHODS SHALL CONFORM TO PORTLAND WATER DISTRICT STANDARDS. DISINFECTION OF WATER UNES SHALL CONFORM TO AWWA STANDARD C651, LATEST REVISION.
6. ALL SEWER MATERIALS SHALL CONFORM TO THE REQUIREMENTS OF THE CITY OF PORTLAND TECHNICAL AND DESIGN STANDARDS AND GUIDELINES.
7. ALL MATERIALS AND CONSTRUCTION METHODS SHALL CONFORM TO CITY OF PORTLAND TECHNICAL AND DESIGN STANDARDS AND GUIDELINES.

8. LOT DEVELOPER SHALL BE RESPONSIBLE FOR DRIVEWAY CONSTRUCTION BEYOND THE DRIVEWAY APRON AND SIDEWALK.

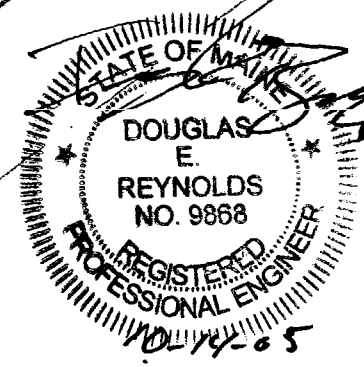

CITY OF PORTLAND  
 APPROVED SITE PLAN  
 Subject to Dept. Conditions  
 Date of Approval: 10-20-06

Rev.	Date	Revision

Design: DER	Date: 4/04
Draft: CAH	Job No.: 632
Checked: DER	Scale: 1"=20'
File Name: 632-LOTS	

**GP** Gorrill-Palmer Consulting Engineers, Inc.  
 Traffic and Civil Engineering Services

PO Box 1237  
 15 Shaker Road  
 Gray, ME 04039

207-657-6910  
 FAX: 207-657-6912  
 E-Mail: mailbox@gorrillpalmer.com

Drawing Name: **Lot 12 Lot Layout and Utility Plan**

Project: **CARRIAGE LANE**

figure No.  
**2**

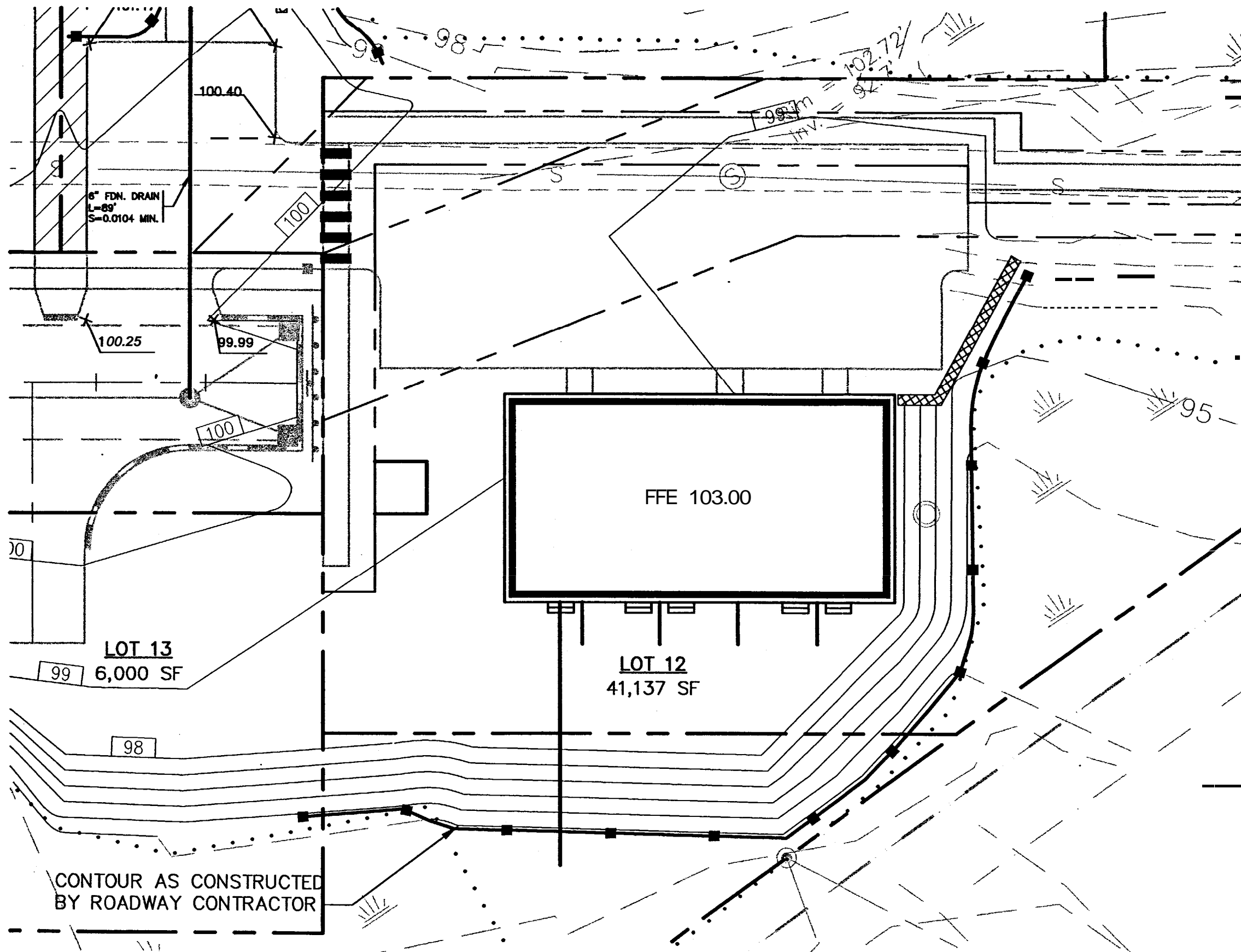

**NOTES:**

- 1. ALL DISTURBED AREAS NOT SUBJECT TO PAVEMENT OR BUILDING SHALL RECEIVE 4" OF LOAM AND SEED.
- 2. LOT LAYOUT AND GRADING CONFIGURATIONS SHOWN ON THIS PLAN REPRESENT THE INTENDED FINAL DEVELOPMENT OF **ME** LOT FOR BUILDING PERMIT PURPOSES. ANY MODIFICATION FROM THESE PLANS, BE IT EITHER BUILDING SIZE, PARKING CONFIGURATION, GRADING CHANGES, ETC. SHALL REQUIRE REVIEW AND APPROVAL FROM THE CITY OF PORTLAND PLANNING BOARD, AS WELL AS REVIEW BY THE SUBDIVISION DEVELOPER.
- 3. ADDITIONAL EROSION CONTROL MEASURES OVER AND ABOVE THOSE USED BY ROADWAY CONTRACTOR MAY BE REQUIRED TO MEET EROSION CONTROL BEST MANAGEMENT PRACTICES.
- 4. LOT DEVELOPER SHALL BE RESPONSIBLE FOR RESTORING FINAL GRADES TO ELEVATIONS PROVIDED BY ROADWAY DEVELOPER. GRADES ADJACENT TO BUILDING SHALL BE ADJUSTED TO DIRECT FLOW AWAY FROM STRUCTURES.

CITY OF PORTLAND  
 APPROVED SITE PLAN  
 Subject to Dept. Conditions  
 Date of Approval: 10-28-05

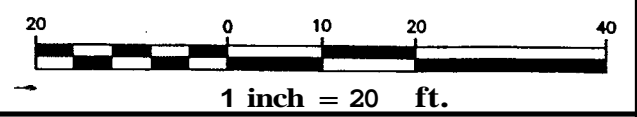
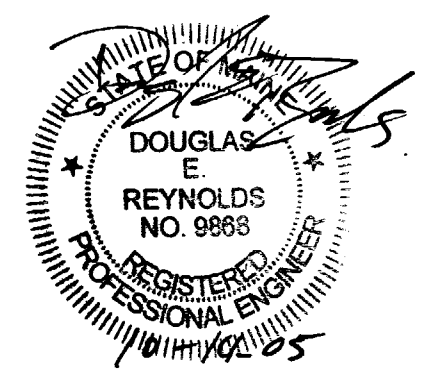

Rev.	Date	Revision

Design: DER	Date: 4/04
Draft: CAH	Job No.: 632
Checked: DER	Scale: 1"=20'
File Name: 632-LOTS	

**GP** Gorrill-Palmer Consulting Engineers, Inc.  
*Traffic and Civil Engineering Services*

PO Box 1237  
 15 Shaker Road  
 Gray, ME 04039

207-657-6910  
 FAX: 207-657-6912  
 E-mail: [info@gorrillpalmer.com](mailto:info@gorrillpalmer.com)

Drawing Name:	Lot 12 Grading Plan
Project:	CARRIAGE LANE

Figure No.  
**3**