

DISPLAY THIS CARD ON PRINCIPAL FRONTAGE OF WORK CITY OF PORTLAND

Please Read Application And Notes, If Any, Attached

BUILDING INSPECTION PERMIT

PERMIT ISSUED

Permit Number: 100571

JUN 1 2010

CITY OF PORTLAND

This is to certify that LAWRENCE DESIREE A & THOMAS E ALLAN ITS/property ow
has permission to Add a 14' x 16' Deck on side of house
AT 49 WALL ST CBL 340 K001001

provided that the person or persons, firm or corporation accepting this permit shall comply with the provisions of the Statutes of Maine and of the Ordinances of the City of Portland relating to the construction, maintenance and use of buildings and structures, and of the application to this department.

Apply to Public Works for street line and grade if nature of work requires such information.

Notification of inspection must be given and written permission procured before this building or part thereof is lathed or otherwise closed-in. 24 HOUR NOTICE IS REQUIRED.

A certificate of occupancy must be procured by owner before building or part thereof is occupied.

OTHER REQUIRED APPROVALS

Fire Dept. _____
Health Dept. _____
Appeal Board _____
Other _____
Department Name

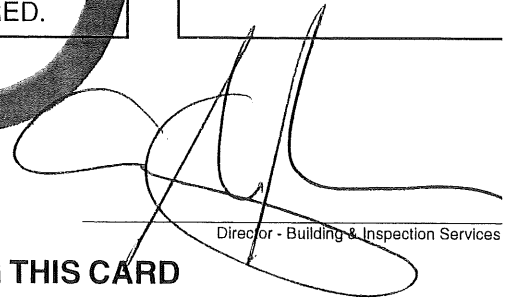

Director - Building & Inspection Services

PENALTY FOR REMOVING THIS CARD

City of Portland, Maine - Building or Use Permit Application

389 Congress Street, 04101 Tel: (207) 874-8703, Fax: (207) 874-8716

Permit No: 10-0571	Issue Date:	CBL: 340 K001001
-----------------------	-------------	---------------------

Location of Construction: 49 WALL ST	Owner Name: LAWRENCE DESIREE A & THO	Owner Address: 51 WALL ST	Phone:
Business Name:	Contractor Name: property owner	Contractor Address:	Phone:
Lessee/Buyer's Name	Phone:	Permit Type: Additions - Dwellings	Zone: R-3

Past Use: Single Family Home	Proposed Use: Single Family Home - Add a 14' x 16' Deck on side of house	Permit Fee: \$40.00	Cost of Work: \$1,400.00	CEO District: 5	9500 ⁰⁰
---------------------------------	---	------------------------	-----------------------------	--------------------	--------------------

Proposed Project Description: Add a 14' x 16' Deck on side of house	FIRE DEPT: <input type="checkbox"/> Approved <input checked="" type="checkbox"/> Denied Signature: <i>[Signature]</i>	INSPECTION: Use Group: R-3 Type: 5B IRC 2003 Signature: <i>[Signature]</i>
PEDESTRIAN ACTIVITIES DISTRICT (P.A.D.) Action: <input type="checkbox"/> Approved <input type="checkbox"/> Approved w/Conditions <input type="checkbox"/> Denied Signature: _____ Date: _____		

Permit Taken By: Idobson	Date Applied For: 05/25/2010	Zoning Approval
-----------------------------	---------------------------------	------------------------

- This permit application does not preclude the Applicant(s) from meeting applicable State and Federal Rules.
- Building permits do not include plumbing, septic or electrical work.
- Building permits are void if work is not started within six (6) months of the date of issuance. False information may invalidate a building permit and stop all work..

Special Zone or Reviews <input type="checkbox"/> Shoreland <input type="checkbox"/> Wetland <input type="checkbox"/> Flood Zone <input type="checkbox"/> Subdivision <input type="checkbox"/> Site Plan Maj <input type="checkbox"/> Minor <input type="checkbox"/> MM <input type="checkbox"/> <input checked="" type="checkbox"/> Denied Date: <i>5/26/10</i>	Zoning Appeal <input type="checkbox"/> Variance <input type="checkbox"/> Miscellaneous <input type="checkbox"/> Conditional Use <input type="checkbox"/> Interpretation <input type="checkbox"/> Approved Date: _____	Historic Preservation <input checked="" type="checkbox"/> Not in District or Landmark <input type="checkbox"/> Does Not Require Review <input type="checkbox"/> Requires Review <input type="checkbox"/> Approved <input type="checkbox"/> Approved w/Conditions <input type="checkbox"/> Denied Date: _____
--	---	---

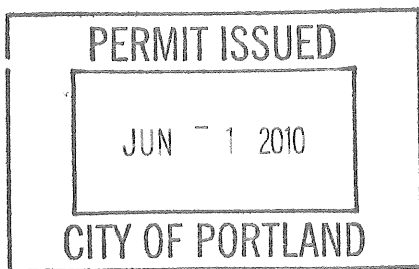

CERTIFICATION

I hereby certify that I am the owner of record of the named property, or that the proposed work is authorized by the owner of record and that I have been authorized by the owner to make this application as his authorized agent and I agree to conform to all applicable laws of this jurisdiction. In addition, if a permit for work described in the application is issued, I certify that the code official's authorized representative shall have the authority to enter all areas covered by such permit at any reasonable hour to enforce the provision of the code(s) applicable to such permit.

SIGNATURE OF APPLICANT	ADDRESS	DATE	PHONE
RESPONSIBLE PERSON IN CHARGE OF WORK, TITLE		DATE	PHONE

City of Portland, Maine - Building or Use Permit

389 Congress Street, 04101 Tel: (207) 874-8703, Fax: (207) 874-8716

Permit No: 10-0571	Date Applied For: 05/25/2010	CBL: 340 K001001
-----------------------	---------------------------------	---------------------

Location of Construction: 49 WALL ST	Owner Name: LAWRENCE DESIREE A & THO	Owner Address: 51 WALL ST	Phone:
Business Name:	Contractor Name: property owner	Contractor Address:	Phone
Lessee/Buyer's Name	Phone:	Permit Type: Additions - Dwellings	

Proposed Use: Single Family Home - Add a 14' x 16' Deck on side of house	Proposed Project Description: Add a 14' x 16' Deck on side of house
---	--

Dept: Zoning Status: Approved with Conditions Reviewer: Marge Schmuckal Approval Date: 05/26/2010 Note: Ok to Issue: <input checked="" type="checkbox"/> 1) Separate permits shall be required for future decks, sheds, pools, and/or garages. 2) This is NOT an approval for an additional dwelling unit. You SHALL NOT add any additional kitchen equipment including, but not limited to items such as stoves, microwaves, refrigerators, or kitchen sinks, etc. Without special approvals. 3) This property shall remain a single family dwelling. Any change of use shall require a separate permit application for review and approval. 4) This permit is being approved on the basis of plans submitted. Any deviations shall require a separate approval before starting that work. All required setbacks are ALWAYS measured from property lines for which the property owner is responsible for knowing.
Dept: Building Status: Approved with Conditions Reviewer: Tammy Munson Approval Date: 05/28/2010 Note: Ok to Issue: <input checked="" type="checkbox"/> 1) The minimum tread size is 10". Please note, you must cut your stringer to 10" in order to obtain this.

BUILDING PERMIT INSPECTION PROCEDURES

Please call 874-8703 or 874-8693 (ONLY)
or email: buildinginspections@portlandmaine.gov

With the issuance of this permit, the owner, builder or their designee is required to provide adequate notice to the City of Portland Inspection Services for the following inspections. Appointments must be requested 48 to 72 hours in advance of the required inspection. The inspection date will need to be confirmed by this office.

- Please read the conditions of approval that is attached to this permit!! Contact this office if you have any questions.
- Permits expire in 6 months, if the project is not started or ceases for 6 months.
- If the inspection requirements are not followed as stated below additional fees may be incurred due to the issuance of a "Stop Work Order" and subsequent release to continue with construction.

Footing/Building Location Inspection: Prior to pouring concrete or setting precast piers

Framing inspection required.

Final inspection required at completion of work.

The project cannot move to the next phase prior to the required inspection and approval to continue, REGARDLESS OF THE NOTICE OR CIRCUMSTANCES.

IF THE PERMIT REQUIRES A CERTIFICATE OF OCCUPANCY, IT MUST BE PAID FOR AND ISSUED TO THE OWNER OR DESIGNEE BEFORE THE SPACE MAY BE OCCUPIED.



General Building Permit Application

If you or the property owner owes real estate or personal property taxes or user charges on any property within the City, payment arrangements must be made before permits of any kind are accepted.

Location/Address of Construction: <u>51 WALL ST. PORTLAND 04103</u>		
Total Square Footage of Proposed Structure/Area	Square Footage of Lot	Number of Stories
Tax Assessor's Chart, Block & Lot Chart# Block# Lot# <u>340 - K - 001/002</u>	Applicant * <u>must</u> be owner, Lessee or Buyer* Name <u>TOM ALLAN</u> Address <u>51 WALL ST.</u> City, State & Zip <u>PORTLAND, ME</u>	Telephone: <u>8787695</u>
Lessee/DBA (If Applicable)	Owner (if different from Applicant) Name Address City, State & Zip	Cost Of Work: \$ <u>1400⁰⁰</u> C of O Fee: \$ _____ Total Fee: \$ <u>40⁰⁰</u>
Current legal use (i.e. single family) <u>SINGLE FAMILY</u> Number of Residential Units _____ If vacant, what was the previous use? _____ Proposed Specific use: _____ Is property part of a subdivision? _____ If yes, please name _____ Project description: <u>ADD 14' X 16' DECK - SIDE OF HOUSE</u>		
Contractor's name: <u>TOM ALLAN</u> Address: <u>51 WALL ST.</u> <u>MAIL</u> City, State & Zip <u>PORTLAND</u> Telephone: <u>8787695</u> Who should we contact when the permit is ready: <u>SAME</u> Telephone: _____ Mailing address: <u>SAME</u>		

Please submit all of the information outlined on the applicable Checklist. Failure to do so will result in the automatic denial of your permit.

In order to be sure the City fully understands the full scope of the project, the Planning and Development Department may request additional information prior to the issuance of a permit. For further information or to download copies of this form and other applications visit the Inspections Division on-line at www.portlandmaine.gov, or stop by the Inspections Division office, room 315 City Hall or call 874-8703.

I hereby certify that I am the Owner of record of the named property, or that the owner of record authorizes the proposed work and that I have been authorized by the owner to make this application as his/her authorized agent. I agree to conform to all applicable laws of this jurisdiction. In addition, if a permit for work described in this application is issued, I certify that the Code Official's authorized representative shall have the authority to enter all areas covered by this permit at any reasonable hour to enforce the provisions of the codes applicable to this permit.

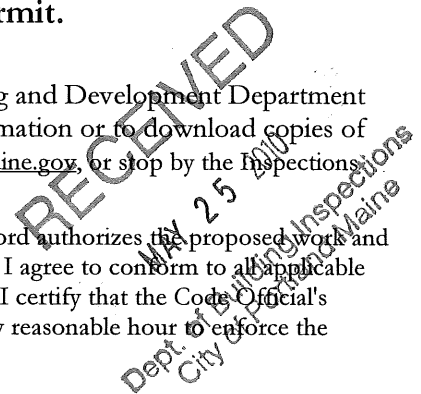

Signature: [Handwritten Signature] Date: 5/25/10

This is not a permit; you may not commence ANY work until the permit is issued

EXISTING HOUSE 16'

2"x8"x15' PT LEDGER (FLASHED)

SIMPSON JOIST HANGARS

1/2" GALV LAG SCREWS

2"x8"x14' PT JOISTS

3/4"x6" BULLDOSE PT DECKING

3 STAIR STRINGERS

2"x8"x16' PT DOUBLE SUPPORT HEADER

2" x 4" Tread
STAIRS
3 STEPS
8" TREAD
7" RISE
48"

2"x8"x16' PT DOUBLE HEADER

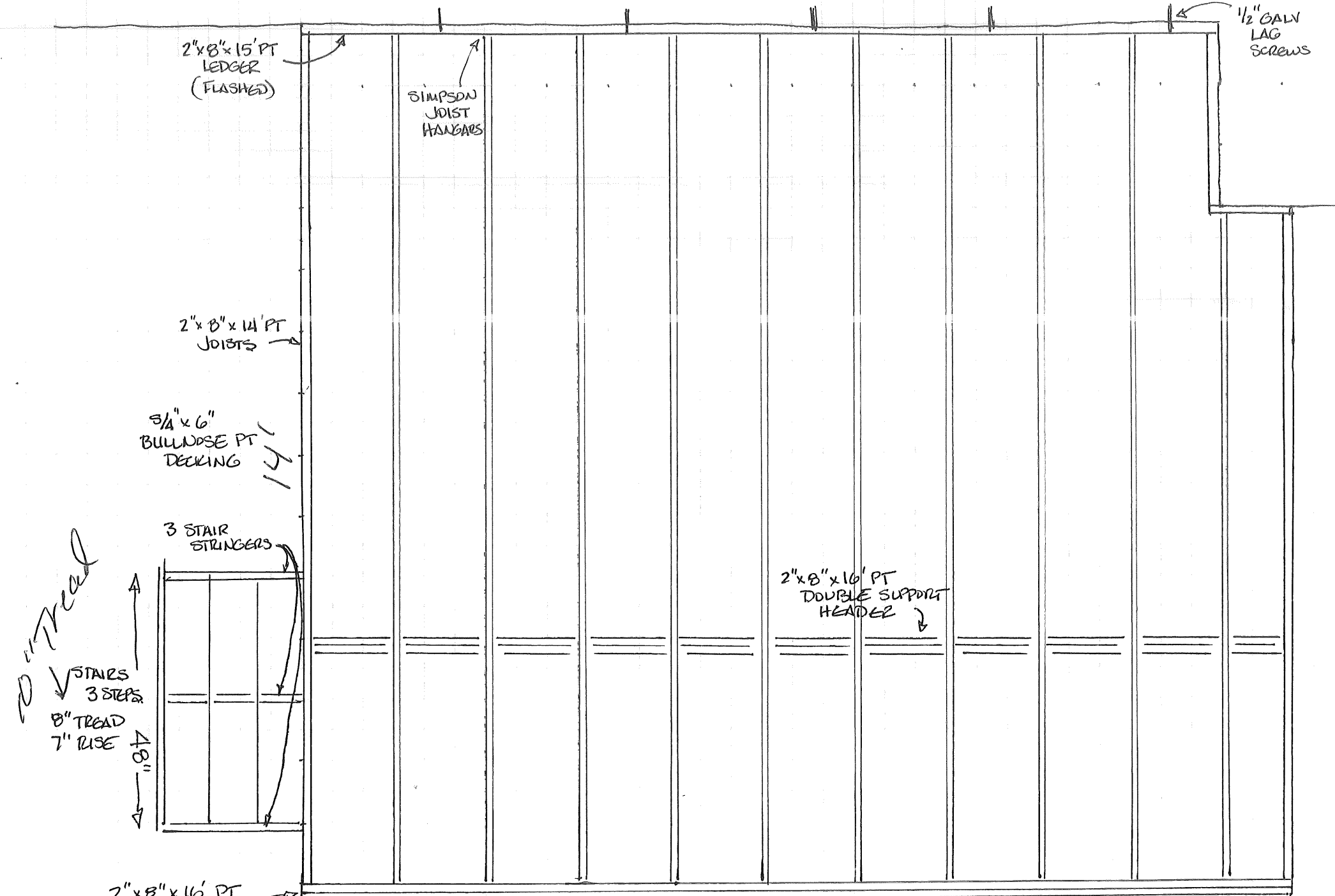

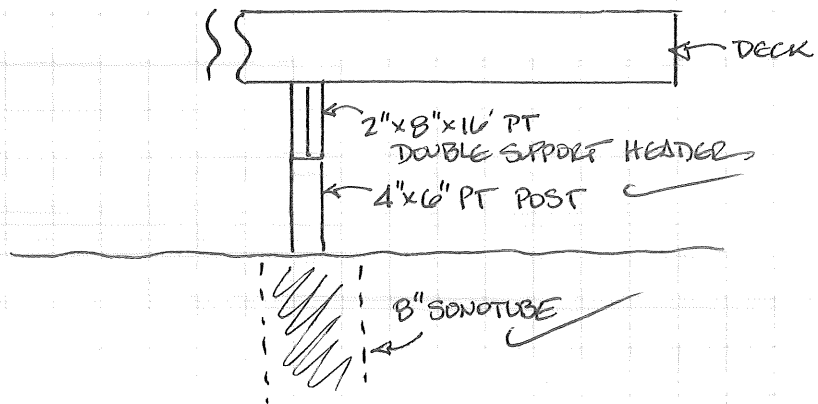

SIDE VIEW

LANDSCAPE VIEW

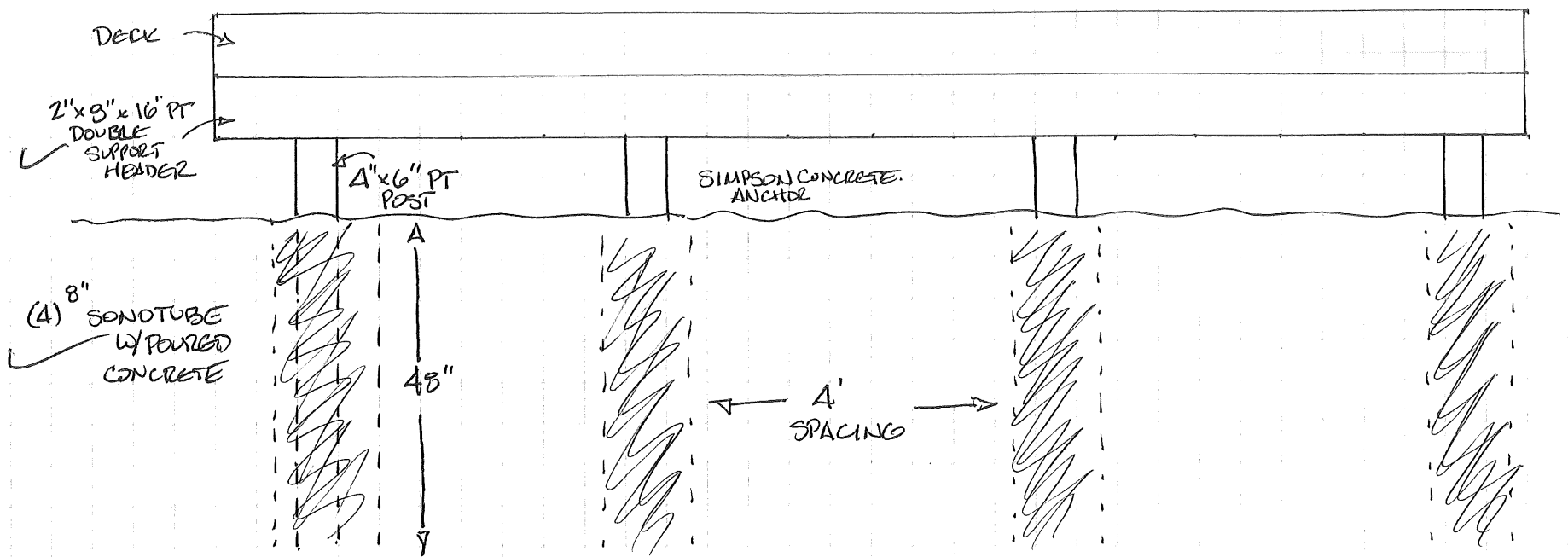

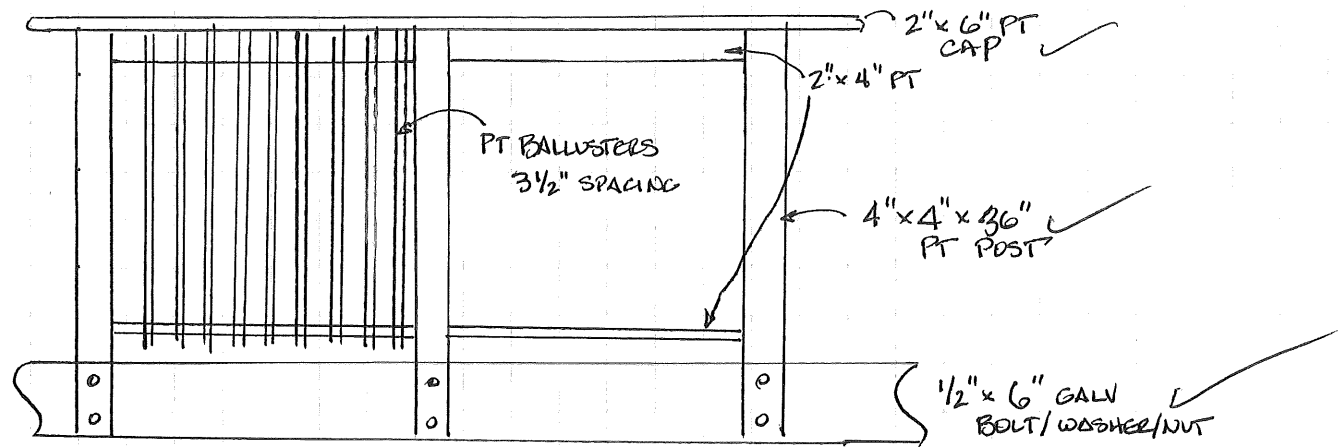

RAILING DETAIL

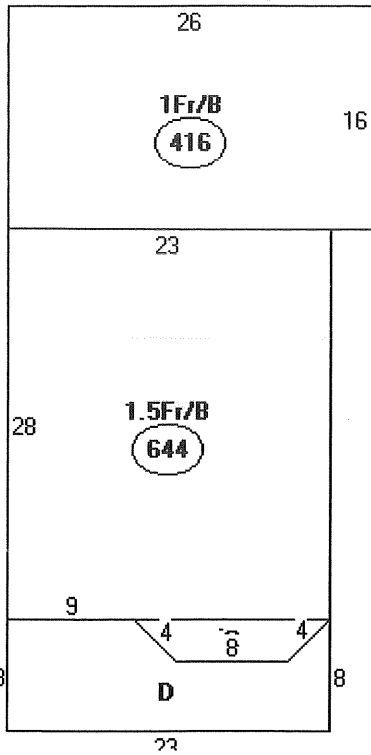

Descriptor/Area	
A:	1.5Fr/B 644 sqft
B:	1Fr/B 416 sqft
C:	FBAY 33 sqft
D:	OFF 151 sqft

R-3 Zone

REAR: 25' min req - 33' given
 Side yard on side ST: 20' min req - 33' given
 Front: 25' min req - 240' given

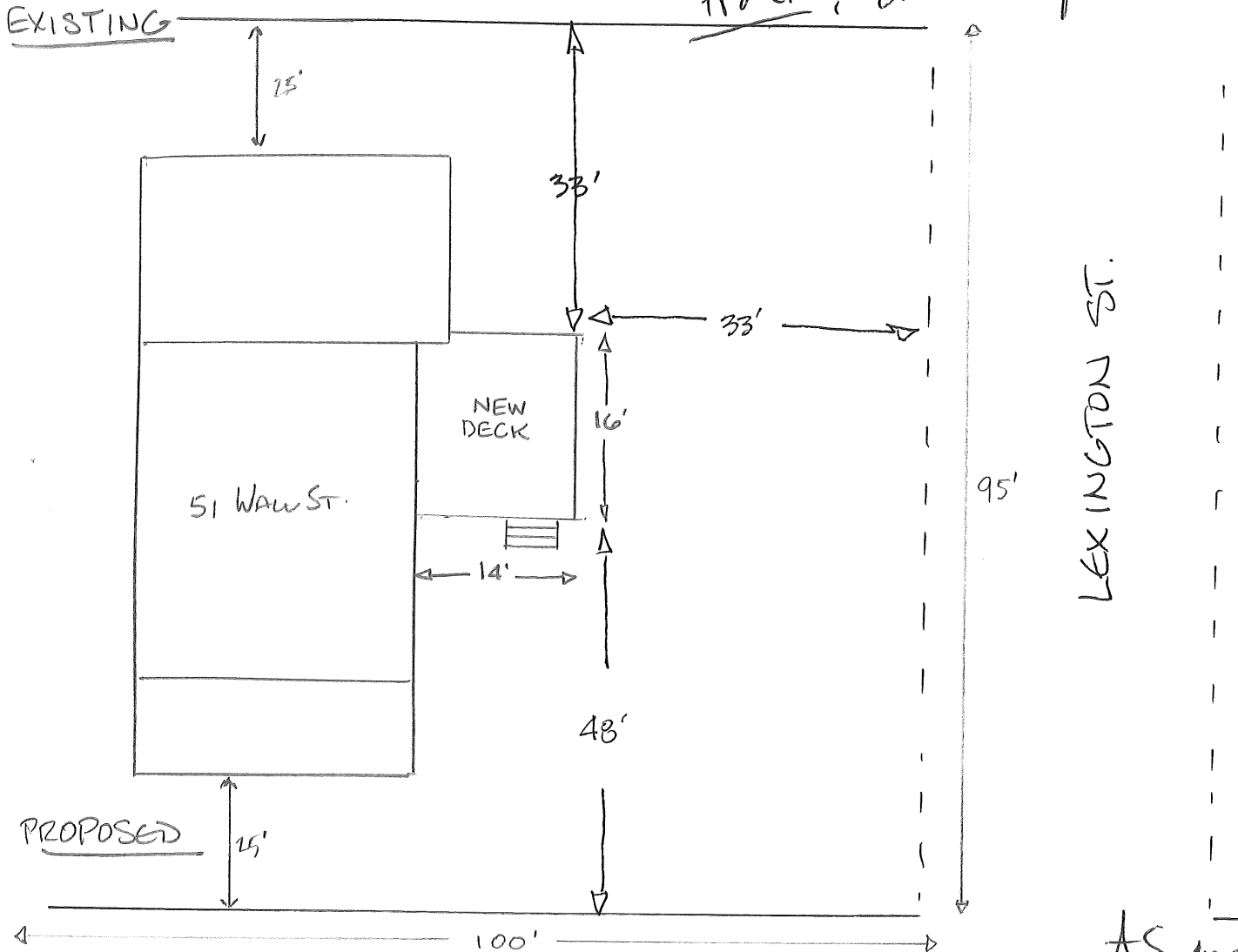

All measurements are WALL ST. required from Property lines

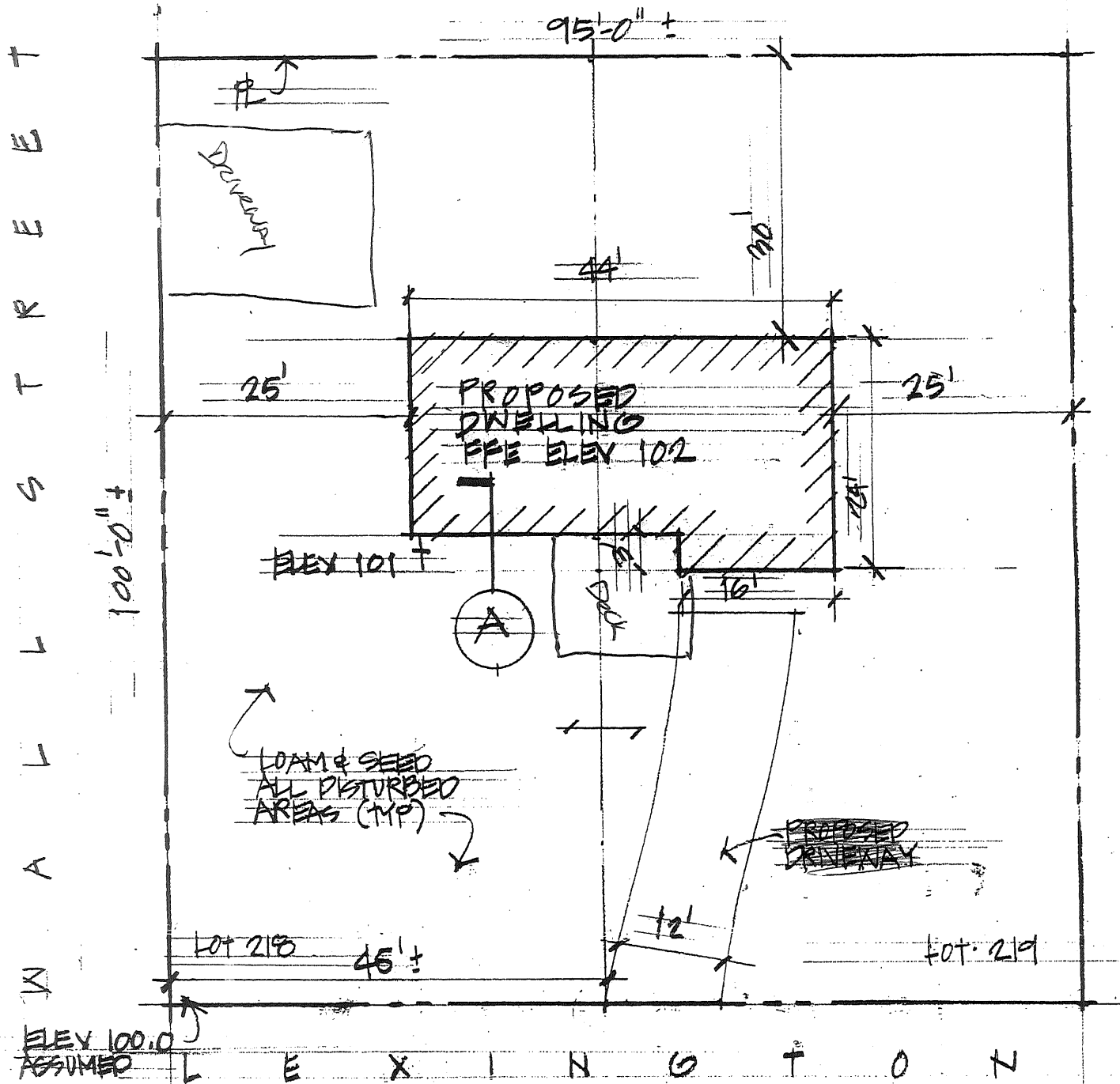

SITE LAYOUT PLAN

1/16" = 1'-0"

TABULATION

MAP 240-K1+2 BOOK 10073
PAGE 174

TOTAL AREA: 9,975 SF ±
BUILDING FOOTPRINT: 972 SF

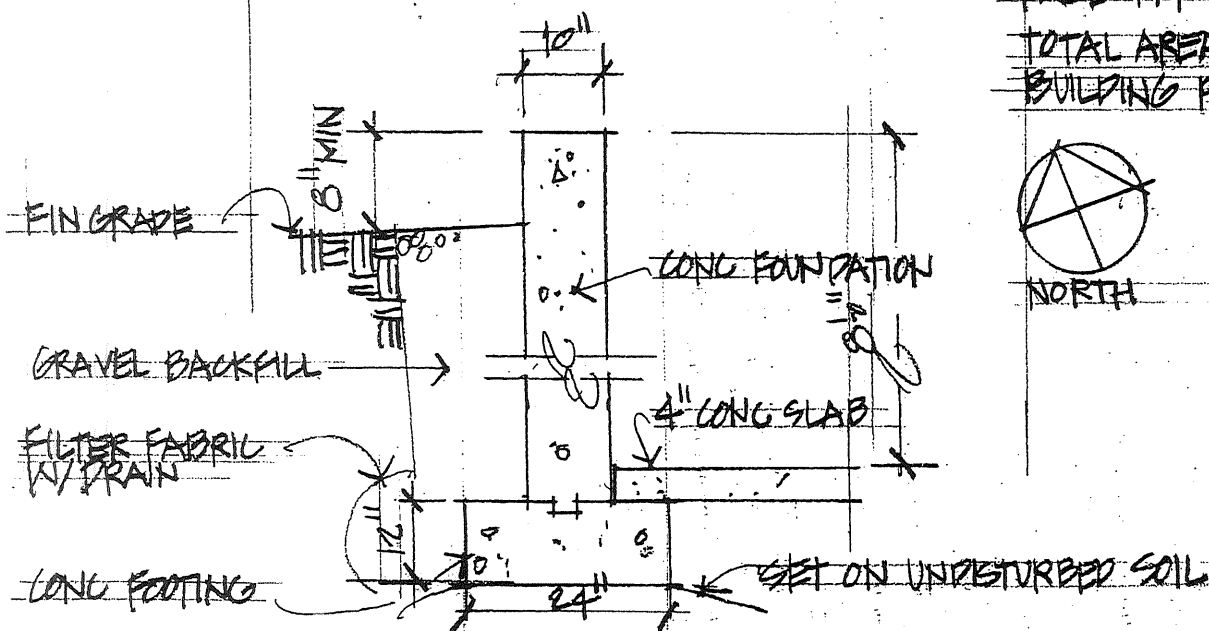
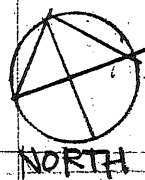

SECTION THROUGH FOUNDATION-A

1/2" = 1'-0"

PROPOSED DWELLING, 47 WALL STREET, PORTLAND, MAINE
GREG W. DAYTON, APPLICANT, 276 BRACKETT ST. PORTLAND, MAINE 8 MAY 1990