

Portland, Maine



Yes. Life's good here.

Permitting and Inspections Department  
Michael A. Russell, MS, Director

### General Building Permit Application

Project Address: 1435 Forest Ave

Tax Assessor's CBL: 340 D004 001 Cost of Work: \$ 4000,00  
Chart # Block # Lot #

Proposed use (e.g., single-family, retail, restaurant, etc.): \_\_\_\_\_

Current use: TAKE OUT REST Past use, if currently vacant: \_\_\_\_\_

Commercial       Multi-Family Residential       One/Two Family Residential

Type of work (check all that apply):

- |   |   |   |
|---|---|---|
| <input type="checkbox"/> New Structure          | <input type="checkbox"/> Fence                    | <input type="checkbox"/> Change of Ownership - Condo Conversion |
| <input type="checkbox"/> Addition               | <input type="checkbox"/> Pool - Above Ground      | <input type="checkbox"/> Change of Use                          |
| <input checked="" type="checkbox"/> Alteration  | <input type="checkbox"/> Pool - In Ground         | <input type="checkbox"/> Change of Use - Home Occupation        |
| <input type="checkbox"/> Amendment              | <input type="checkbox"/> Retaining Wall           | <input type="checkbox"/> Radio/Telecommunications Equipment     |
| <input type="checkbox"/> Shed                   | <input type="checkbox"/> Replacement Windows      | <input type="checkbox"/> Radio/Telecommunications Tower         |
| <input type="checkbox"/> Demolition - Structure | <input type="checkbox"/> Commercial Hood System   | <input type="checkbox"/> Tent/Stage                             |
| <input type="checkbox"/> Demolition - Interior  | <input type="checkbox"/> Tank Installation/       | <input type="checkbox"/> Wind Tower                             |
| <input type="checkbox"/> Garage - Attached      | <input type="checkbox"/> Replacement Tank Removal | <input type="checkbox"/> Solar Energy Installation              |
| <input type="checkbox"/> Garage - Detached      |   | <input type="checkbox"/> Site Alteration                        |

Project description/scope of work (attach additional pages if needed): EMERGENCY CONSTRUCTION WORK

Auto ran into existing front cast concrete stairs, need to be replaced, extensive damage. Needs to be done ASAP as location is a TAKE OUT RESTAURANT. MASON WILL BE POURING

Applicant Name: Filomena Russell Phone: (207) 232-7392

Address: 27 Winslow Road, Gorham Me Email: filorussell@gmail.com

Lessee/Owner Name (if different): \_\_\_\_\_ Phone: ( ) - \_\_\_\_\_

Address: \_\_\_\_\_ Email: \_\_\_\_\_

Contractor Name (if different): The Step Guys - Brian Brown Phone: (207) 433-6010

Address: 192 Biddeford Road, Alfred Me Email: BBrown@stepguys.com

*I hereby certify that I am the owner of record of the named property, or that the owner of record authorizes the proposed work and that I have been authorized by the owner to make this application as his/her authorized agent. I agree to conform to all applicable laws of this jurisdiction. In addition, if a permit for work described in this application is issued, I certify that the Code Official's authorized representative shall have the authority to enter all areas covered by this permit at any reasonable hour to enforce the provisions of the codes applicable to this permit.*

Signature: [Signature] Date: 6/3/2017

*This is a legal document and your electronic signature is considered a legal signature per Maine state law.*

Review of this application will not begin until the permit payment is received. This is not a permit. Work may not commence until the permit is issued.

389 Congress Street/Portland, Maine 04101/ <http://portlandmaine.gov> /tel: (207) 874-8703/fax: (207) 874-8716

\* See work description on page 2 & 3 of Application

A FOOTING LEVEL WITH GROUND (concrete) SAME ELEVATION AS SIDEWALK

②

All brick will be removed from around base of existing stairs, and brick buildout behind stairs will be removed in order for new stairs to be set up against building.

Could not get the landing to be up to code due to the space limitation. The new stairs will be flush with the threshold (which is currently a stepdown). It will project 7 1/2" with a 30" landing.

The mason will be putting a brick wall behind the stairs giving it approx another 3" for a total of 33" for landing.

Current steps sit in between brick walls on each side of front of building.

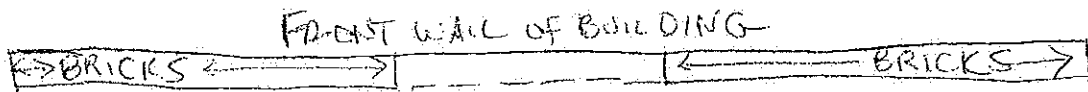

↑ WILL BE JOINING  
the 2 brick walls  
on front of building

③

This accident occurred 3/23/17 during the night sometime. I have been dealing with multiple people from the City of Portland to try and figure this out. I would love to be grandfathered on the landing due to the fact that the existing stairs are many years old and I would not have the footage to my property line with the landing to code.

Please let me know if you need any additional info. Would love to get this done ASAP.

Thank you

Filomena Russell  
(207) 232-7392

Please call. Thank you.

Portland, Maine



Yes. Life's good here.

Permitting and Inspections Department  
Michael A. Russell, MS, Director

**Electronic Signature and Fee Payment Confirmation**

This is a legal document and your electronic signature is considered a legal signature per Maine state law. You will receive an e-mailed invoice from our office which signifies that your electronic permit application has been received and is ready for payment. Please pay by one of the following:

- Electronic check or credit card: [portlandmaine.gov/payyourpermit](http://portlandmaine.gov/payyourpermit)
- Over the phone at (207) 874-8703
- Drop off to Room 315, City Hall
- Mail to:

City of Portland  
Permitting and Inspections Department  
389 Congress Street, Room 315  
Portland, Maine 04101

By signing below, I understand the review process starts once my payment has been received. After all approvals have been completed, my permit will be issued via e-mail. Work may not commence until permit is issued.

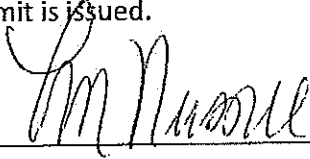
Applicant Signature:  Date: 6/3/17

I have provided electronic copies and sent them on: \_\_\_\_\_ Date: 6/3/17

**NOTE:** All electronic paperwork must be delivered to [permitting@portlandmaine.gov](mailto:permitting@portlandmaine.gov) or with a thumb drive to the office.

**If you or the property owner owes taxes or user charges on property within the City, payment arrangements must be made before a permit application is accepted.**