

# DISPLAY THIS CARD ON PRINCIPAL FRONTAGE OF WORK CITY OF PORTLAND

## BUILDING INSPECTION

### PERMIT

Permit Number: 030848

Please Read Application And Notes, If Any, Attached

This is to certify that Russo James G /n/a

has permission to Amendment to permit # 021 to change \_\_\_\_\_ or to 10' 6'.

AT 30 Hampton St \_\_\_\_\_ 339 C011001

provided that the person or persons, firm or corporation accepting this permit shall comply with all of the provisions of the Statutes of Maine and of the Ordinances of the City of Portland regulating the construction, maintenance and use of buildings and structures, and of the application on file in this department.

Apply to Public Works for street line and grade if nature of work requires such information.

Notification of inspection must be given and work on permit must be completed before this building or part thereof is occupied or otherwise used-in. **NO OTHER NOTICES REQUIRED.**

A certificate of occupancy must be procured by owner before this building or part thereof is occupied.

#### OTHER REQUIRED APPROVALS

- Fire Dept. \_\_\_\_\_
- Health Dept. \_\_\_\_\_
- Appeal Board \_\_\_\_\_
- Other \_\_\_\_\_  
Department Name

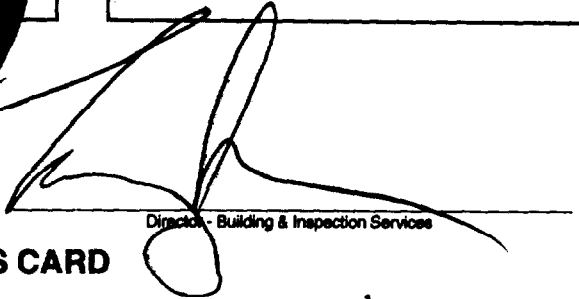
  
Director - Building & Inspection Services

**PENALTY FOR REMOVING THIS CARD**

**City of Portland, Maine - Building or Use Permit Application**  
 389 Congress Street, 04101 Tel: (207) 874-8703, Fax: (207) 874-8716

Permit No: 03-0848	Issue Date:	CBL: 339 C011001
-----------------------	-------------	---------------------

Location of Construction: 30 Hampton St	Owner Name: Russo James G	Owner Address: 30 Luke St	Phone: 207-878-9870
Business Name: n/a	Contractor Name: n/a	Contractor Address: n/a Portland	Phone:
Lessee/Buyer's Name n/a	Phone: n/a	Permit Type: Amendment to Single Family	Zone: <b>R-3</b>

Past Use: Single Family	Proposed Use: Single Family / amendment to permit # 021103; change garage door to 10' x 16'.	Permit Fee: \$30.00	Cost of Work: \$30.00	CEO District: 1
		FIRE DEPT: <i>N/A</i> <input type="checkbox"/> Approved <input type="checkbox"/> Denied	INSPECTION: Use Group: <b>R-3</b> Type: <b>SB</b> <b>BOA 99</b>	

Proposed Project Description:  
 Amendment to permit # 021103 to change garage door to 10' x 16'.

Signature: \_\_\_\_\_  
 Signature: \_\_\_\_\_  
 PEDESTRIAN ACTIVITIES DISTRICT (P.A.D.)  
 Action:  Approved  Approved w/Conditions  Denied  
 Signature: \_\_\_\_\_ Date: \_\_\_\_\_

Permit Taken By: gg	Date Applied For: 07/16/2003	<b>Zoning Approval</b>	
------------------------	---------------------------------	------------------------	--

1. This permit application does not preclude the Applicant(s) from meeting applicable State and Federal Rules. 2. Building permits do not include plumbing, septic or electrical work. 3. Building permits are void if work is not started within six (6) months of the date of issuance. False information may invalidate a building permit and stop all work..	Special Zone or Reviews <input type="checkbox"/> Shoreland <input type="checkbox"/> Wetland <input type="checkbox"/> Flood Zone <input type="checkbox"/> Subdivision <input type="checkbox"/> Site Plan Maj <input type="checkbox"/> Minor <input type="checkbox"/> MM <input type="checkbox"/> Date: <i>7/22/03</i>	Zoning Appeal <input type="checkbox"/> Variance <input type="checkbox"/> Miscellaneous <input type="checkbox"/> Conditional Use <input type="checkbox"/> Interpretation <input type="checkbox"/> Approved <input type="checkbox"/> Denied Date: _____	Historic Preservation <input checked="" type="checkbox"/> Not in District or Landmark <input type="checkbox"/> Does Not Require Review <input type="checkbox"/> Requires Review <input type="checkbox"/> Approved <input type="checkbox"/> Approved w/Conditions <input type="checkbox"/> Denied Date: <i>7/22/03</i>
--	---	--	--

**CERTIFICATION**

I hereby certify that I am the owner of record of the named property, or that the proposed work is authorized by the owner of record and that I have been authorized by the owner to make this application as his authorized agent and I agree to conform to all applicable laws of this jurisdiction. In addition, if a permit for work described in the application is issued, I certify that the code official's authorized representative shall have the authority to enter all areas covered by such permit at any reasonable hour to enforce the provision of the code(s) applicable to such permit.

SIGNATURE OF APPLICANT \_\_\_\_\_ ADDRESS \_\_\_\_\_ DATE \_\_\_\_\_ PHONE \_\_\_\_\_

RESPONSIBLE PERSON IN CHARGE OF WORK, TITLE \_\_\_\_\_ DATE \_\_\_\_\_ PHONE \_\_\_\_\_

# All Purpose Building Permit Application

If you or the property owner owes real estate or personal property taxes or user charges on any property within the City, payment arrangements must be made before permits of any kind are accepted.

Location/Address of Construction: <b>30 Hampton St / Luke St</b>		
Total Square Footage of Proposed Structure <b>1024 SF</b>	Square Footage of Lot <b>17 230 SF</b>	
Tax Assessor's Chart, Block & Lot Chart#      Block#      Lot# <b>339 - C - 001 - 001</b>	Owner: <b>JAMES RUSSO</b>	Telephone: <b>8789870</b>
Lessee/Buyer's Name (if Applicable)	Applicant name, address & telephone: <b>JAMES RUSSO 30 LUKE ST 8789870</b>	Cost Of Work: \$ <del>9000.00</del> Fee: \$ <b>30.00</b>
Current use: _____		
If the location is currently vacant, what was prior use: <b>R-3</b>		
Approximately how long has it been vacant: _____		
Proposed use: <b>Amendment to permit</b>		
Project description: <b>Garage door 10' x 16' # 2 1103 Hxcal</b>		
Contractor's name, address & telephone: <b>JAMES RUSSO / 30 LUKE ST 8789870</b>		
Who should we contact when the permit is ready: _____		
Mailing address: _____		
<p>We will contact you by phone when the permit is ready. You must come in and pick up the permit and review the requirements before starting any work, with a Plan Reviewer. A stop work order will be issued and a \$100.00 fee if any work starts before the permit is picked up.      PHONE: _____</p>		

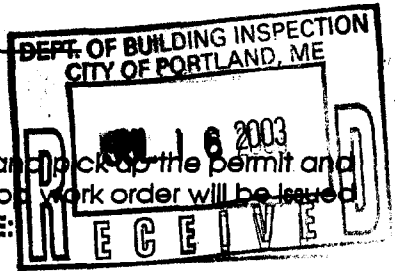

**IF THE REQUIRED INFORMATION IS NOT INCLUDED IN THE SUBMISSIONS THE PERMIT WILL BE AUTOMATICALLY DENIED AT THE DISCRETION OF THE BUILDING/PLANNING DEPARTMENT, WE MAY REQUIRE ADDITIONAL INFORMATION IN ORDER TO APPROVE THIS PERMIT.**

*I hereby certify that I am the Owner of record of the named property, or that the owner of record authorizes the proposed work and that I have been authorized by the owner to make this application as his/her authorized agent. I agree to conform to all applicable laws of this jurisdiction. In addition, if a permit for work described in this application is issued, I certify that the Code Official's authorized representative shall have the authority to enter all areas covered by this permit at any reasonable hour to enforce the provisions of the codes applicable to this permit.*

Signature of applicant: <b>James Russo</b>	Date: <b>9/25/02</b>
--	----------------------

**This is NOT a permit, you may not commence ANY work until the permit is issued.  
If you are in a Historic District you may be subject to additional permitting and fees with the Planning Department on the 4th floor of City Hall**

30 Luke st Amendment

32' x 32' Garage

Installed entrance  
Door in front  
Not on the  
side

Did not install

9' x 8' Garage  
Door in front

Just one  
10' x 16'

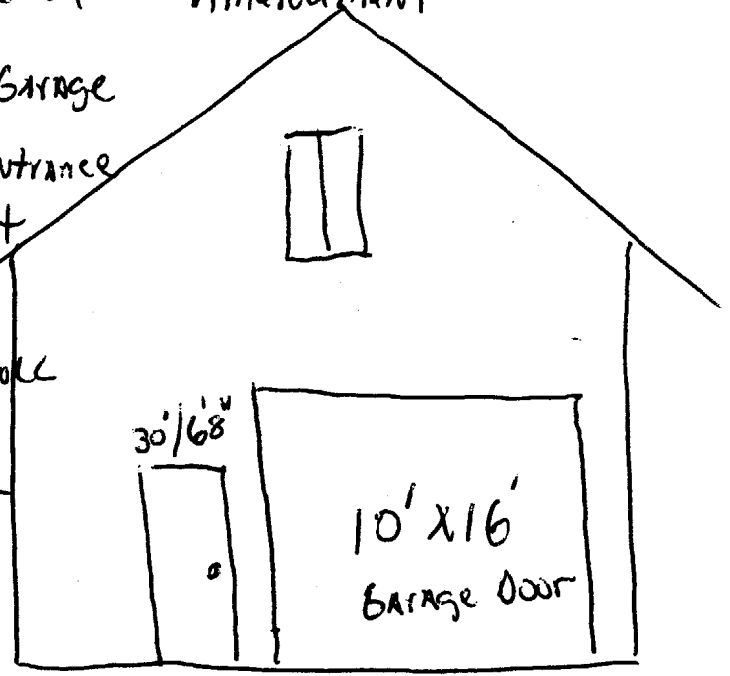



# CITY OF PORTLAND, MAINE

Department of Building Inspections

July 16 2003

Received from J & R Inc

Location of Work 30 Hanover

Cost of Construction \$ \_\_\_\_\_

Permit Fee \$ 30.00

Building (IL) \_\_\_ Plumbing (I5) \_\_\_ Electrical (I2) \_\_\_ Site Plan (U2) \_\_\_

Other amendment to # 021103

CBL: 339 C 011

Check #: 6494 Total Collected \$ 30.00

## THIS IS NOT A PERMIT

No work is to be started until PERMIT CARD is actually posted upon the premises. Acceptance of fee is no guarantee that permit will be granted. PRESERVE THIS RECEIPT. In case permit cannot be granted the amount of the fee will be refunded upon return of the receipt less \$10.00 or 10% whichever is greater.

WHITE - Applicant's Copy  
YELLOW - Office Copy  
PINK - Permit Copy

*[Handwritten signature]*