

Form # P 04

DISPLAY THIS CARD ON PRINCIPAL FRONTAGE OF WORK
CITY OF PORTLAND

Please Read
Application And
Notes, If Any,
Attached

**BUILDING INSPECTION
PERMIT**

Permit Number: 041354

This is to certify that Bedard Kami L / Sheds, U.S.A.

has permission to Build 8'x8' shed to be installed at rear of property

AT 39 Barclay Ave CBL 339 D011001

provided that the person or persons, firm or corporation accepting this permit shall comply with all of the provisions of the Statutes of Maine and of the Ordinances of the City of Portland regulating the construction, maintenance and use of buildings and structures, and of the application on file in this department.

Apply to Public Works for street line and grade if nature of work requires such information.

Notification of inspection must be given and written permission procured before this building or part thereof is lathed or otherwise closed-in. 24 HOUR NOTICE IS REQUIRED.

A certificate of occupancy must be procured by owner before this building or part thereof is occupied.

OTHER REQUIRED APPROVALS

Fire Dept. _____

Health Dept. _____

Appeal Board _____

Other _____

Department Name

Jamie Banke 9/22/04
Director - Building & Inspection Services

PENALTY FOR REMOVING THIS CARD

City of Portland, Maine - Building or Use Permit Application

389 Congress Street, 04101 Tel: (207) 874-8703, Fax: (207) 874-8716

Permit No: 04-1354	Issue Date:	CBL: 339 D011001
-----------------------	-------------	---------------------

Location of Construction: 39 Barclay Ave	Owner Name: Bedard Kami L	Owner Address: 39 Barclay Ave	Phone: 797-4128
Business Name:	Contractor Name: Sheds, U.S.A.	Contractor Address: P.O.Box 6622 Portsmouth	Phone: 6038681300
Lessee/Buyer's Name	Phone:	Permit Type: Sheds	Zone: R3

Past Use: Single Family Home	Proposed Use: Single family home w/ 8'x8' unattached shed	Permit Fee: \$39.00	Cost of Work: \$1,715.00	CEO District: 5
---------------------------------	--	------------------------	-----------------------------	--------------------

FIRE DEPT: <input type="checkbox"/> Approved <input type="checkbox"/> Denied INSPECTION: Use Group: R3 Type: accessory BOCA 1999 Signature: JMB 9/22/04	Signature:
--	------------

See permit # 030360

Proposed Project Description:
Build 8'x8' shed to be installed at rear of property

PEDESTRIAN ACTIVITIES DISTRICT (P.A.D.)		
Action: <input type="checkbox"/> Approved <input type="checkbox"/> Approved w/Conditions <input type="checkbox"/> Denied	Signature:	Date:

Permit Taken By: dmm	Date Applied For: 09/10/2004	Zoning Approval	
-------------------------	---------------------------------	------------------------	--

1. This permit application does not preclude the Applicant(s) from meeting applicable State and Federal Rules. 2. Building permits do not include plumbing, septic or electrical work. 3. Building permits are void if work is not started within six (6) months of the date of issuance. False information may invalidate a building permit and stop all work..	Special Zone or Reviews <input type="checkbox"/> Shoreland <input type="checkbox"/> Wetland <input type="checkbox"/> Flood Zone <input type="checkbox"/> Subdivision <i>OK</i> <input type="checkbox"/> Site Plan Maj <input type="checkbox"/> Minor <input type="checkbox"/> MM <input type="checkbox"/> Date: <i>JMB 9/22/04</i>	Zoning Appeal <input type="checkbox"/> Variance <input type="checkbox"/> Miscellaneous <input type="checkbox"/> Conditional Use <input type="checkbox"/> Interpretation <input type="checkbox"/> Approved <input type="checkbox"/> Denied Date:	Historic Preservation <input checked="" type="checkbox"/> Not in District or Landmark <input type="checkbox"/> Does Not Require Review <input type="checkbox"/> Requires Review <input type="checkbox"/> Approved <input type="checkbox"/> Approved w/Conditions <input type="checkbox"/> Denied Date: <i>JMB</i>
--	---	--	--

CERTIFICATION

I hereby certify that I am the owner of record of the named property, or that the proposed work is authorized by the owner of record and that I have been authorized by the owner to make this application as his authorized agent and I agree to conform to all applicable laws of this jurisdiction. In addition, if a permit for work described in the application is issued, I certify that the code official's authorized representative shall have the authority to enter all areas covered by such permit at any reasonable hour to enforce the provision of the code(s) applicable to such permit.

SIGNATURE OF APPLICANT	ADDRESS	DATE	PHONE
RESPONSIBLE PERSON IN CHARGE OF WORK, TITLE		DATE	PHONE

City of Portland, Maine - Building or Use Permit

389 Congress Street, 04101 Tel: (207) 874-8703, Fax: (207) 874-8716

Permit No: 04-1354	Date Applied For: 09/10/2004	CBL: 339 D011001
------------------------------	--	----------------------------

Location of Construction: 39 Barclay Ave	Owner Name: Bedard Kami L	Owner Address: 39 Barclay Ave	Phone: () 797-4128
Business Name:	Contractor Name: Sheds, U.S.A.	Contractor Address: P.O.Box 6622 Portsmouth	Phone: (603) 868-1300
Lessee/Buyer's Name	Phone:	Permit Type: Sheds	

Proposed Use: Single family home w/ 8'x8' unattached shed	Proposed Project Description: Build 8'x8' shed to be installed at rear of property
---	--

Dept: Zoning **Status:** Approved **Reviewer:** Jeanine Bourke **Approval Date:** 09/22/2004

Note: **Ok to Issue:**

1) It is the responsibility of the owner to delineate the property lines for the setback inspection.

Dept: Building **Status:** Approved **Reviewer:** Jeanine Bourke **Approval Date:** 09/22/2004

Note: **Ok to Issue:**

Sheds USA Inc. Mill Store specs

Delivered - Built - Guaranteed

Roof Construction

1/2" 5-ply plywood
 2x4 trusses w/TPI plates, 24" on center
 3ft, 3-tab, self-sealing asphalt shingles
 All Peak roof pitches are 5/12
 Gambrel roof pitch is 12/12 at bottom
 changing to 5/12 pitch at the top

Roof Height

6ft wide peak - 8'
 8ft wide peak - 8'3"
 8ft wide gambrel - 9'
 10ft wide peak - 8'11"
 10ft wide gambrel - 9'5"
 12ft wide peak - 9'6"
 12ft wide gambrel - 9'10"

Walls

2x4 construction, 24" on center
 Siding Types:
 Primed shed panel
 Pine (tongue & groove)
 Cedar (tongue & groove)
 Maintenance Free Vinyl on 1/2" plywood
 Peak/ Gambrel wall height - 71-1/2"
 Extended Peak front wall height - 75"

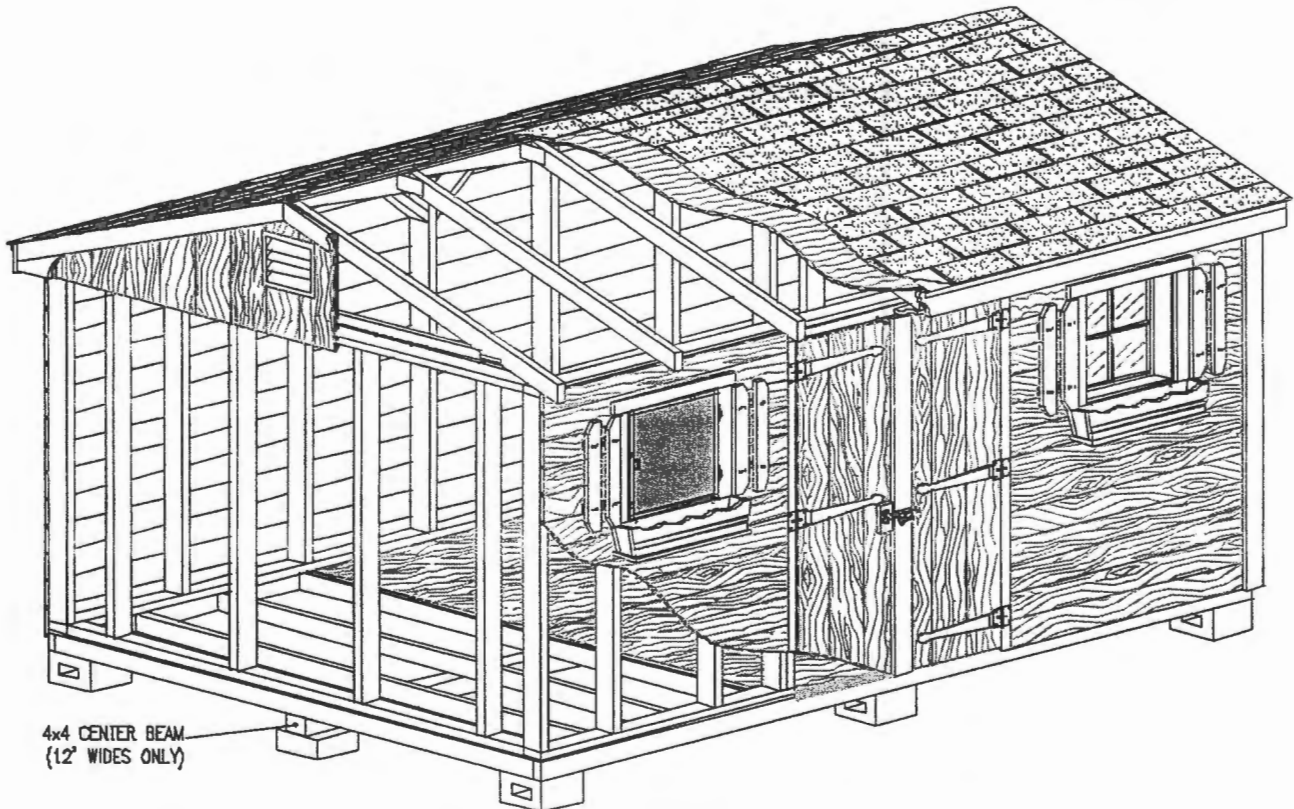

4x4 CENTER BEAM
 (12' WIDES ONLY)

Windows

Size: 18" wide x 22" tall (approx)
 Includes flower box & shutters
 Optional window screens
 Wooden Sheds – functional windows
 Vinyl Sheds – non-functional windows
 With optional upgrade to functional

Doors

Standard 40" double door (except 6'x6' shed)
 Optional 54", 66", & 78" double door
 Optional 26" single door
 Door height 69", opening height 67-1/2"

Floor

5/8" plywood
 optional 5/8" PT plywood
 Floor joists - 16" on center
 2x4* - 6' & 8' wide sheds
 (*optional upgrade to 2x6)
 2x6 - 10' & 12' wide sheds
 pressure-treated joists optional
 Concrete block supports
 PT 4x4 runner under 12' wide sheds

Note: Options may not be available for all sheds. Call your Distributor or Sheds USA for more information.

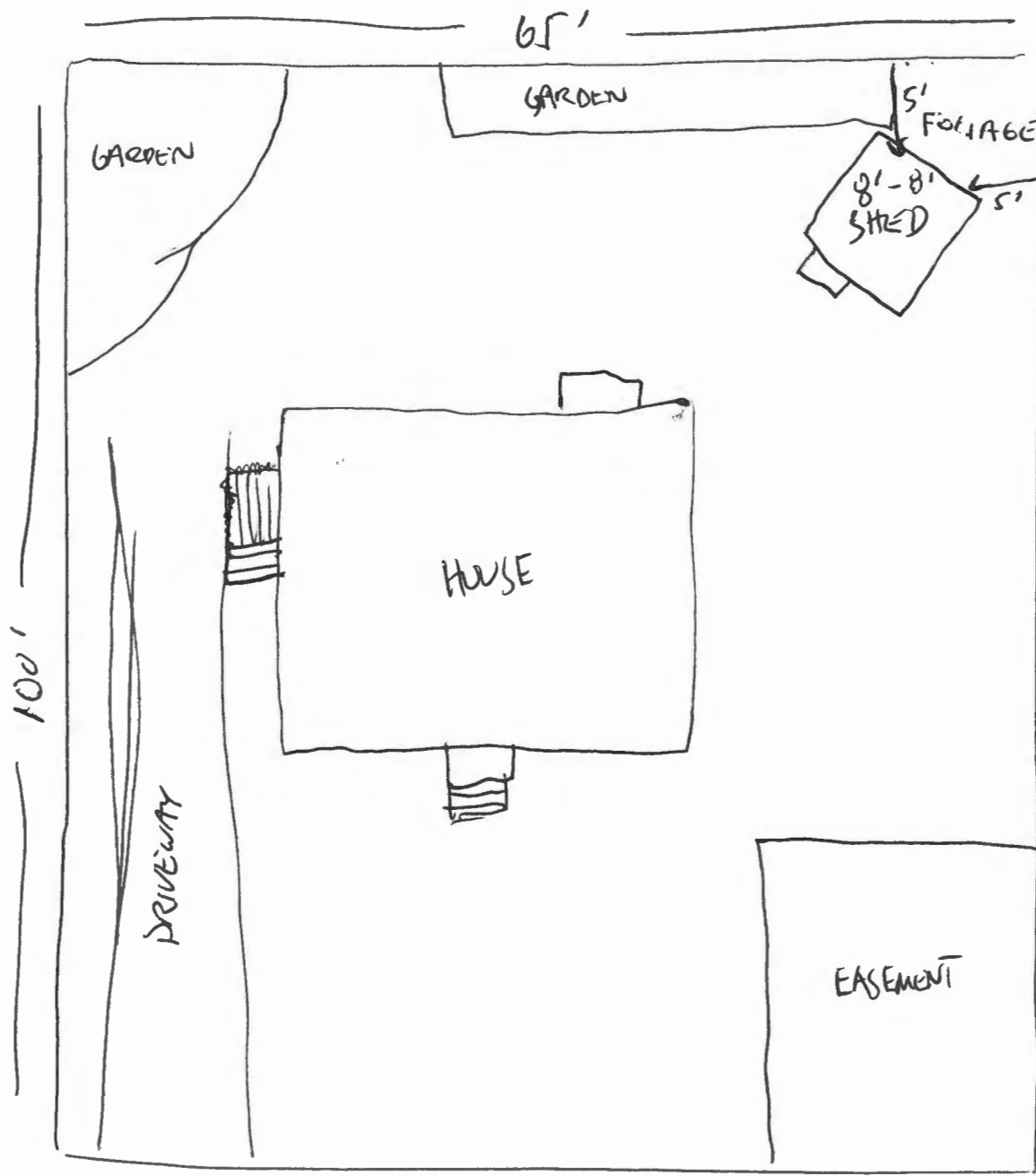

R3 Zone
 \$100 SF or less
 min. 5' from
 Rear & Side
 Property Lines

For: Kami Bedard
 39 Barclay Ave.
 Portland, ME 04103
 791-1142



BUILDING PERMIT INSPECTION PROCEDURES

Please call 874-8703 or 874-8693 to schedule your inspections as agreed upon

Permits expire in 6 months, if the project is not started or ceases for 6 months.

The Owner or their designee is required to notify the inspections office for the following inspections and provide adequate notice. Notice must be called in 48-72 hours in advance in order to schedule an inspection:

By initializing at each inspection time, you are agreeing that you understand the inspection procedure and additional fees from a "Stop Work Order" and "Stop Work Order Release" will be incurred if the procedure is not followed as stated below.

A Pre-construction Meeting will take place upon receipt of your building permit.

NA Footing/Building Location Inspection: Prior to pouring concrete

NA Re-Bar Schedule Inspection: Prior to pouring concrete

~~Call~~ Foundation Inspection: Prior to placing ANY backfill

Call Install Framing/Rough Plumbing/Electrical: Prior to any insulating or drywalling

Call Final/Certificate of Occupancy: Prior to any occupancy of the structure or use. NOTE: There is a \$75.00 fee per inspection at this point.

Certificate of Occupancy is not required for certain projects. Your inspector can advise you if your project requires a Certificate of Occupancy. All projects DO require a final inspection

 If any of the inspections do not occur, the project cannot go on to the next phase, REGARDLESS OF THE NOTICE OR CIRCUMSTANCES.

 CERIFICATE OF OCCUPANICES MUST BE ISSUED AND PAID FOR, BEFORE THE SPACE MAY BE OCCUPIED

Ku Jh
Signature of Applicant/Designee
Paula [unclear]
Signature of Inspections Official

9/24/04
Date
9/24/04
Date

CBL: 339 D 011 Building Permit #: 041354



CITY OF PORTLAND, MAINE
Department of Building Inspections

9.9 2007

Received from Karen Pedard

Location of Work 39 Parody

Cost of Construction \$ _____

Permit Fee \$ 3000

Building (IL) Plumbing (I5) Electrical (I2) Site Plan (U2)

Other _____

CSL: 339 D11

Check #: 1328

Total Collected \$ 3000

THIS IS NOT A PERMIT

No work is to be started until PERMIT CARD is actually posted upon the premises. Acceptance of fee is no guarantee that permit will be granted. PRESERVE THIS RECEIPT. In case permit cannot be granted the amount of the fee will be refunded upon return of the receipt less \$10.00 or 10% whichever is greater.

WHITE - Applicant's Copy
YELLOW - Office Copy
PINK - Permit Copy