

DISPLAY THIS CARD ON PRINCIPAL FRONTAGE OF WORK



CITY OF PORTLAND

BUILDING PERMIT

This is to certify that GOOWIL INDUSTRIES

Located At 135 NEWTON ST

Job ID: 2012-09-5004-ALTCOMM

CBL: 339- B-005-001

has permission to add 15' x 15' deck with stairs to existing deck
provided that the person or persons, firm or corporation accepting this permit shall comply with all of the provisions of the Statues of Maine and of the Ordinances of the City of Portland regulating the construction, maintenance and use of the buildings and structures, and of the application on file in the department.

Notification of inspection and written permission procured before this building or part thereof is ~~lath~~ or otherwise closed-in. 48 HOUR NOTICE IS REQUIRED.

A final inspection must be completed by owner before this building or part thereof is occupied. If a certificate of occupancy is required, it must be

Fire Prevention Officer

Code Enforcement Officer / Plan Reviewer

09-27-12

**THIS CARD MUST BE POSTED ON THE STREET SIDE OF THE PROPERTY
PENALTY FOR REMOVING THIS CARD**

BUILDING PERMIT INSPECTION PROCEDURES

Please call 874-8703 or 874-8693 (ONLY)

or email: buildinginspections@portlandmaine.gov

With the issuance of this permit, the owner, builder or their designee is required to provide adequate notice to the city of Portland Inspections Services for the following inspections. Appointments must be requested 48 to 72 hours in advance of the required inspection. The inspection date will need to be confirmed by this office.

- **Please read the conditions of approval that is attached to this permit!! Contact this office if you have any questions.**
- **Permits expire in 6 months. If the project is not started or ceases for 6 months.**
- **If the inspection requirements are not followed as stated below additional fees may be incurred due to the issuance of a "Stop Work Order" and subsequent release to continue.**

Footings/Setbacks prior to pouring concrete

Close In Elec/Plmb/Frame prior to insulate or gyp

Final Inspection

The project cannot move to the next phase prior to the required inspection and approval to continue, REGARDLESS OF THE NOTICE OF CIRCUMSTANCES.

IF THE PERMIT REQUIRES A CERTIFICATE OF OCCUPANCY, IT MUST BE PAID FOR AND ISSUED TO THE OWNER OR DESIGNEE BEFORE THE SPACE MAY BE OCCUPIED.



PORTLAND MAINE

Strengthening a Remarkable City, Building a Community for Life • www.portlandmaine.gov

Director of Planning and Urban Development
Jeff Levine

Job ID: 2012-09-5004-ALTCOMM

Located At: 135 NEWTON ST

CBL: 339- B-005-001

Conditions of Approval:

Building

PLEASE READ:

The carrying beam must be 2 – 2" x 10"-s minimum.

City of Portland, Maine - Building or Use Permit Application

389 Congress Street, 04101 Tel: (207) 874-8703, FAX: (207) 8716

Job No: 2012-09-5004-ALTCOMM	Date Applied: 9/20/2012	CBL: 339- B-005-001	
Location of Construction: 135-137 NEWTON ST	Owner Name: GOOWIL INDUSTRIES OF NORTHERN NE -Curtis Hamilton	Owner Address: 33 CUMBERLAND AVENUE PORTLAND, MAINE 04104	Phone: 347-7365 X 6287
Business Name:	Contractor Name: Great Falls Construction - Valerie Paquin-Gould	Contractor Address: 20 MECHANIC ST GORHAM MAINE 04038	Phone: (207) 839-2744 615-3034 VP-G
Lessee/Buyer's Name:	Phone:	Permit Type: BLDG ADD	Zone: R-3
Past Use: Handicapped Family Unit with 8 or less individuals	Proposed Use: Same: Handicapped Family Unit with 8 or less individuals - to add 15' x 15' deck with stairs to existing deck on rear	Cost of Work: \$8,000.00	CEO District:
		Fire Dept: <input checked="" type="checkbox"/> Approved <input type="checkbox"/> Denied <input type="checkbox"/> N/A	Inspection: Use Group: R-3 Type: SB IRC 09
Proposed Project Description: Construct deck exist deck structure		Pedestrian Activities District (P.A.D.)	
Permit Taken By: Brad		Zoning Approval	

<p>1. This permit application does not preclude the Applicant(s) from meeting applicable State and Federal Rules.</p> <p>2. Building Permits do not include plumbing, septic or electrical work.</p> <p>3. Building permits are void if work is not started within six (6) months of the date of issuance. False informatin may invalidate a building permit and stop all work.</p>	<p>Special Zone or Reviews</p> <p><input type="checkbox"/> Shoreland</p> <p><input type="checkbox"/> Wetlands</p> <p><input type="checkbox"/> Flood Zone</p> <p><input type="checkbox"/> Subdivision</p> <p><input type="checkbox"/> Site Plan</p> <p><input type="checkbox"/> Maj <input type="checkbox"/> Min <input type="checkbox"/> MM</p> <p>Date: 9/20/12</p>	<p>Zoning Appeal</p> <p><input type="checkbox"/> Variance</p> <p><input type="checkbox"/> Miscellaneous</p> <p><input type="checkbox"/> Conditional Use</p> <p><input type="checkbox"/> Interpretation</p> <p><input type="checkbox"/> Approved</p> <p><input type="checkbox"/> Denied</p> <p>Date:</p>	<p>Historic Preservation</p> <p><input checked="" type="checkbox"/> Not in Dist or Landmark</p> <p><input type="checkbox"/> Does not Require Review</p> <p><input type="checkbox"/> Requires Review</p> <p><input type="checkbox"/> Approved</p> <p><input type="checkbox"/> Approved w/Conditions</p> <p><input type="checkbox"/> Denied</p> <p>Date:</p>
	CERTIFICATION		

I hereby certify that I am the owner of record of the named property, or that the proposed work is authorized by the owner of record and that I have been authorized by the owner to make this application as his authorized agent and I agree to conform to all applicable laws of this jurisdiction. In addition, if a permit for work described in the appication is issued, I certify that the code official's authorized representative shall have the authority to enter all areas covered by such permit at any reasonable hour to enforce the provision of the code(s) applicable to such permit.

SIGNATURE OF APPLICANT	ADDRESS	DATE	PHONE
RESPONSIBLE PERSON IN CHARGE OF WORK, TITLE		DATE	PHONE



General Building Permit Application

Entered 9/20/12

(85)

If you or the property owner owes real estate or personal property taxes or user charges on any property within the City, payment arrangements must be made before permits of any kind are accepted.

#2012-09-5004-Alt 135

R-3

Location/Address of Construction: <u>737 Newton St, Portland</u>		
Total Square Footage of Proposed Structure/Area <u>203 SF DECK</u>	Square Footage of Lot <u>1/4 Acre (10,890 SF)</u>	Number of Stories <u>1</u>
Tax Assessor's Chart, Block & Lot Chart# Block# Lot# <u>339 B 005</u>	Applicant: (must be owner, lessee or buyer) Name <u>Goodwill Industries of North NE</u> Address <u>Curtis Hamilton</u> City, State & Zip <u>353 Cumberland Ave Portland, ME 04101</u>	Telephone: <u>207-347-7365</u> <u>x 6287</u>
Lessee/DBA RECEIVED SEP 19 2012 Dept. of Building Inspections City of Portland Maine	Owner: (if different from applicant) Name Address City, State & Zip	Cost of Work: <u>\$8,000</u> C of O Fee: \$ Historic Review: \$ Planning Amin.: <u>\$100</u> Total Fee: \$
Current legal use (i.e. single family) <u>single family</u> Number of Residential Units <u>1</u> If vacant, what was the previous use? <u>-</u> Proposed Specific use: <u>same</u> Is property part of a subdivision? <u>NO</u> If yes, please name _____ Project description: <u>Approx 15'x15' Deck to attach to existing Deck structure</u>		
Contractor's name: <u>Great Falls Construction</u> Email: <u>vpaquin@greatfallsinc.com</u> Address: <u>20 Mechanic St.</u> City, State & Zip <u>Gorham, ME 04038</u> Telephone: <u>off: 207-839-2744</u> Who should we contact when the permit is ready: <u>Valerie Paquin-Gould</u> Telephone: <u>cell 207-615-3034</u> Mailing address: <u>20 Mechanic St, Gorham, ME 04038</u>		

Please submit all of the information outlined on the applicable checklist. Failure to do so will result in the automatic denial of your permit.

In order to be sure the City fully understands the full scope of the project, the Planning and Development Department may request additional information prior to the issuance of a permit. For further information or to download copies of this form and other applications visit the Inspections Division on-line at www.portlandmaine.gov, or stop by the Inspections Division office, room 315 City Hall or call 874-8703.

and I hereby certify that I am the Owner of record of the named property, or that the owner of record authorizes the proposed work and that I have been authorized by the owner to make this application as his/her authorized agent. I agree to conform to all applicable laws of this jurisdiction. In addition, if a permit for work described in this application is issued, I certify that the Code Official's authorized representative shall have the authority to enter all areas covered by this permit at any reasonable hour to enforce the provisions of the codes applicable to this permit.

Signature: _____ Date: 9/11/12

This is not a permit; you may not commence ANY work until the permit is issued



PORTLAND MAINE

Strengthening a Remarkable City, Building a Community for Life • www.portlandmaine.gov

Receipts Details:

Tender Information: Check , Check Number: 24601

Tender Amount: 100.00

Receipt Header:

Cashier Id: bsaucier

Receipt Date: 9/20/2012

Receipt Number: 48435

Receipt Details:

Referance ID:	8081	Fee Type:	BP-Constr
Receipt Number:	0	Payment Date:	
Transaction Amount:	100.00	Charge Amount:	100.00
Job ID: Job ID: 2012-09-5004-ALTCOMM - Construct deck exist deck structure			
Additional Comments: 135 Newton			

Thank You for your Payment!

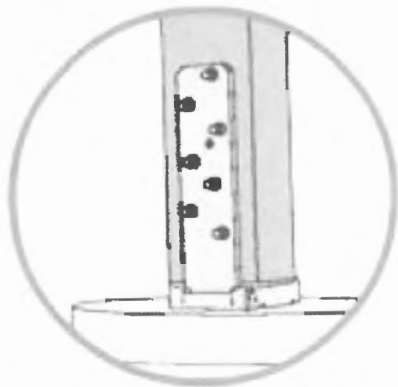

8. Post-to-Concrete

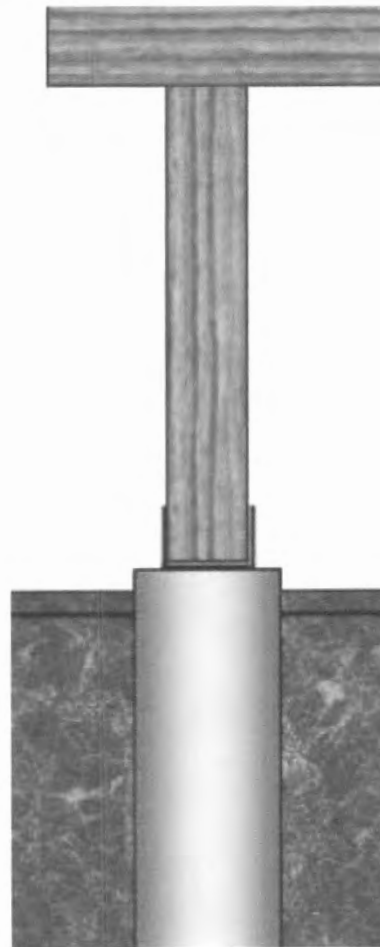

4' Deep

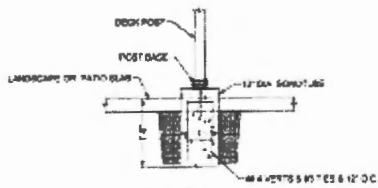

DETAIL 10
© all-concrete-cement.com

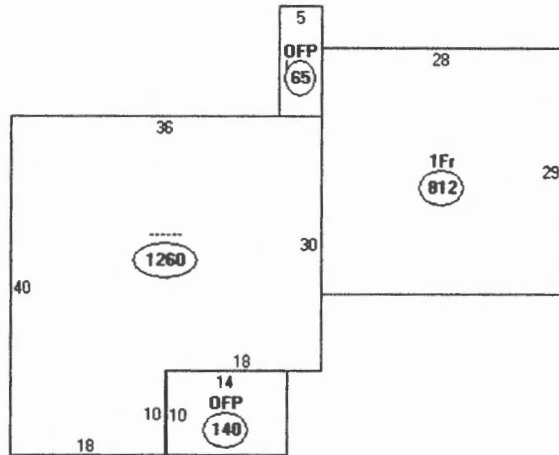

Descriptor/Area	Area
A: -----	1260 sqft
B: OFF	65 sqft
C: 1Fr	812 sqft
D: OFF	140 sqft
	225 - 15x15
	2502 \$

OK

$$9033 \times 35\% = 3161.55 \text{ $ MAX}$$



Dedham St

Dedham St

Newton St

137 Newton St.

A

Newton St

Existing Deck
New Deck

Min. 10' to property lines

See Deck Plot

Newton St

Harris Ave



CITY OF PORTLAND, MAINE
Department of Building Inspection

Certificate of Occupancy

LOCATION 137-139 Newton Street

Issued to Goodwill Industries of Maine

Date of Issue March 9, 1988

This is to certify that the building, premises, or part thereof, at the above location, built—altered—changed as to use under Building Permit No. 86-1288, has had final inspection, has been found to conform substantially to requirements of Zoning Ordinance and Building Code of the City, and is hereby approved for occupancy or use, limited or otherwise, as indicated below.

PORTION OF BUILDING OR PREMISES

entire

APPROVED OCCUPANCY

community living for 8 or less
handicapped individuals

Limiting Conditions:

This certificate supersedes
certificate issued

Approved:

3/9/88
(Date)

K. Taylor
Inspector

[Signature]
Inspector of Building

Quinn
#

Notice: This certificate identifies lawful use of building or premises, and ought to be transferred from owner to owner when property changes hands. Copy will be furnished to owner or lessee for one dollar.

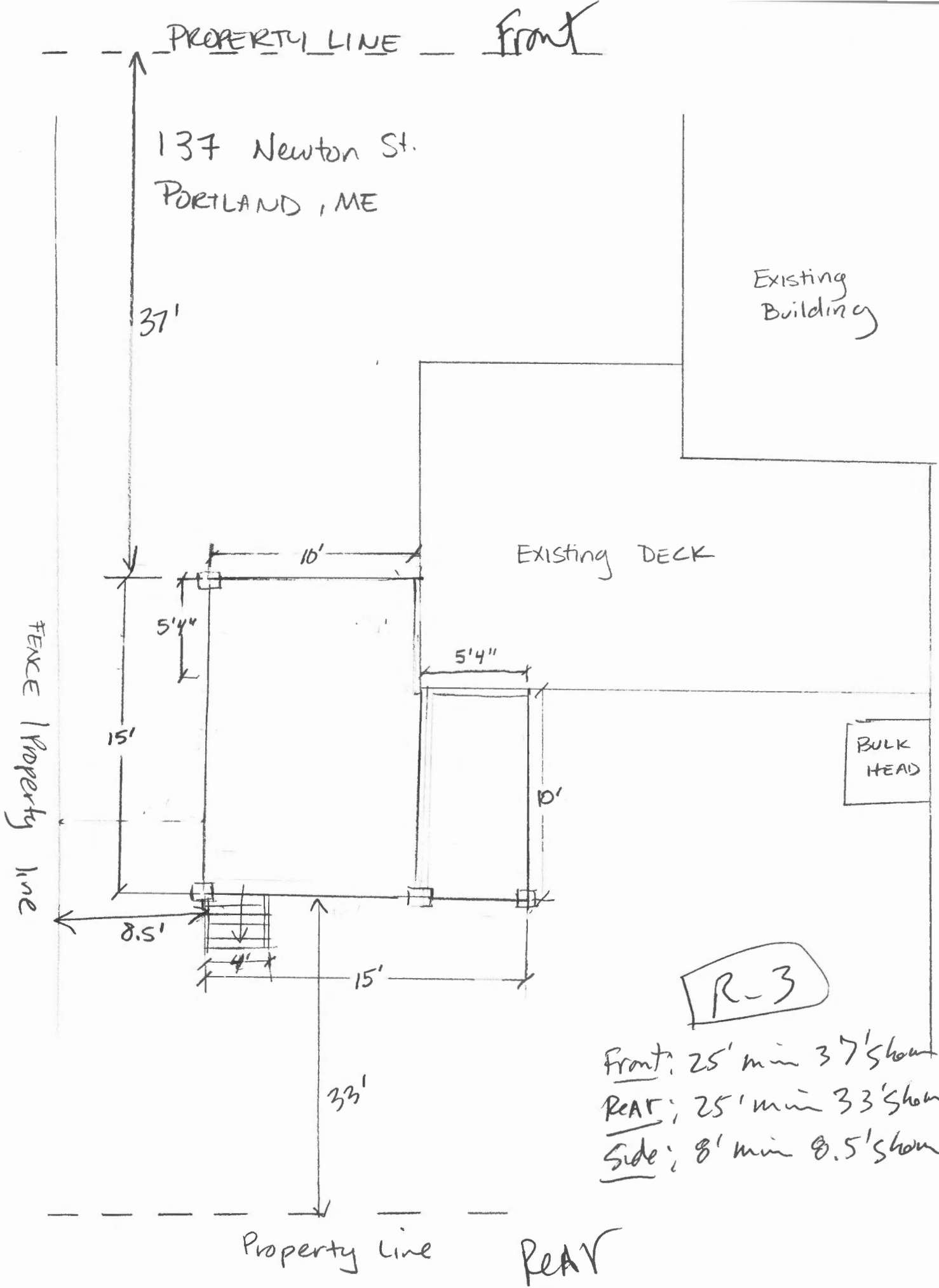

R-3

Front: 25' min 37' shown
 Rear: 25' min 33' shown
 Side: 8' min 8.5' shown

*Need
2-2x10's*

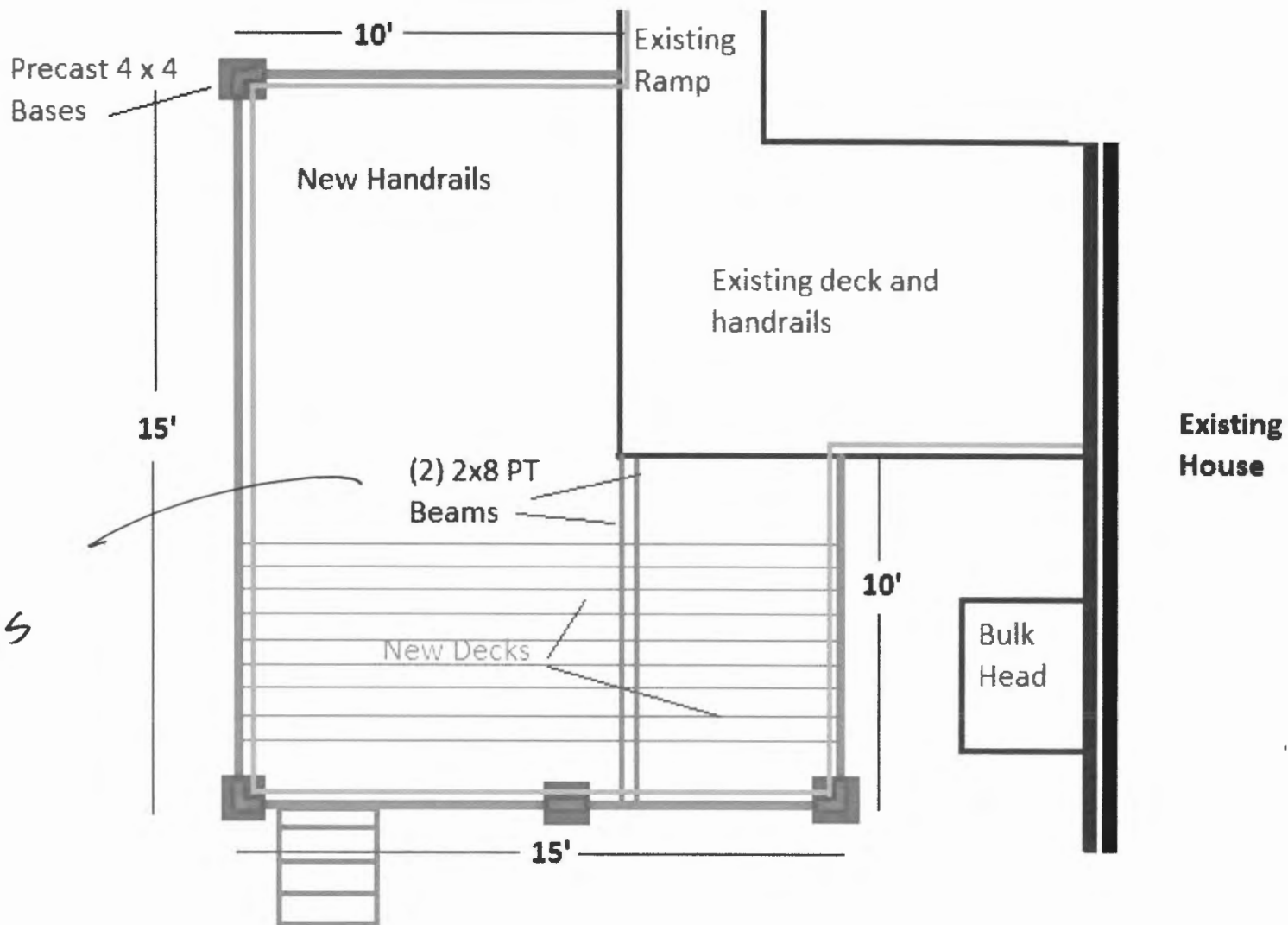

**137 Newton Street, Portland Maine
Deck Project Details**

1. A complete PLOT PLAN showing all structures & proposed structures with distances to all property lines labeled.

- Please see attached plot plan. Please not distances to all property lines is a minimum of 10'

2. Type of foundation system

- Precast concrete pier size: tapered precast
- Depth below grade: 4'
- Anchorage of column to footing: metal post bases into footing
- Spacing and location of tubes/piers: at each corner: 7.5'

3. Framing members

- Columns: 4x4
- Ledger size attached to building: 2x10 PT to attach to existing deck
- Fastener size and spacing attaching ledger: 12 D Framing Nails
- Girder size and spans carrying floor system: no girders
- Joist size, span, and spacing: 2x10 max span of 10' 16 OC
- Joist hangers or ledger: Joist hangers

4. Guardrails & handrail details

- Guardrail height: match existing rail height 42"
- Baluster spacing: 3.5"
- Handrail height: 36"

5. Stair details

- Tread depth (measured nosing to nosing): 11"
- Riser height: 7"
- Nosing on tread: bull nose
- Width of stairs: 4'