

REED SCHOOL APARTMENTS
19 LIBBY STREET
PORTLAND, MAINE

REED SCHOOL, LLC
P.O. BOX 6038, FALMOUTH, MAINE
PORTLAND, MAINE

LEGEND	
EXISTING	PROPOSED
--- PROPERTY LINE	--- EDGE OF PAVEMENT
--- BUTTERS PROPERTY	--- BUILDING ENTRY/EGRESS
--- EDGE OF PAVEMENT	--- SIGN
--- CONTOURS	--- CHAINLINK FENCE
--- BUILDING	--- FULL DEPTH BITUMINOUS PAVEMENT
--- BUILDING DOORS	--- BITUMINOUS OVERLAY, SHIM & SHAPE BASE
--- CURB	--- SLOPED BITUMINOUS CURB
--- CHAINLINK FENCE	--- SURFACE DRAINAGE
--- GAS LINE	--- CONTOURS
--- SANITARY SEWER	--- GRASS BERM
--- STORMDRAIN	
--- OHU	
--- OVERHEAD UTILITY	
--- UGU	
--- UNDERGROUND UTILITY	
--- WATER LINE	
--- CATCH BASIN	
--- DRAIN MANHOLE	
--- TRANSFORMER	
--- SEWER MANHOLE	
--- UTILITY POLE	
--- UTILITY POLE W/ GUY WIRE	
--- IRON PIPE FOUND	
--- IRON ROD FOUND	
--- MONUMENT FOUND	
--- GATE VALVE	
--- GAS VALVE	
--- CONIFEROUS TREE	
--- DECIDUOUS TREE	
PAINTED PAVEMENT SYMBOLS	
--- HANDICAP PARKING	
--- "STOP" LINE	
--- "NO PARKING" AREA	
--- VAN ACCESSIBLE PARKING SPACE	
	--- PREVIOUSLY APPROVED, CURRENTLY UNDER CONSTRUCTION BY CHILDREN'S ODYSSEY.

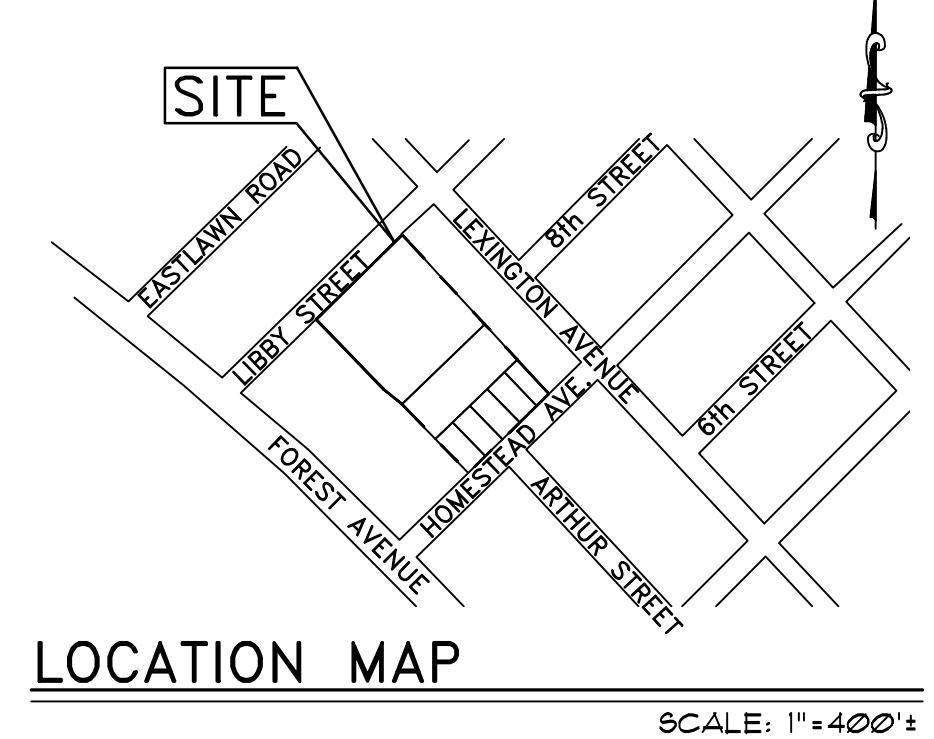

- GENERAL NOTES**
- OWNER: REED SCHOOL, LLC, P.O. BOX 6038, FALMOUTH, ME. CUMBERLAND COUNTY REGISTRY OF DEEDS BK. 34830, PG 100, FILING DATE MAY 9, 2018.
 - APPLICANT: DC REED, LLC, P.O. BOX 6038, FALMOUTH, ME.
 - ENGINEER: WALSH ENGINEERING ASSOCIATES, INC., ONE KAREN DRIVE, SUITE 2A, WESTBROOK, MAINE, 04092.
 - ARCHITECT: ARCHETYPE ARCHITECTS, 48 UNION WHARF, PORTLAND, MAINE 04101.
 - TOPOGRAPHIC AND BOUNDARY INFORMATION: MAINE SURVEY CONSULTANTS, INC., HARRISON, MAINE. COORDINATE SYSTEM IS MAINE WEST 1983 DERIVED FROM STATIC GPS OBSERVATION ON SITE. BENCHMARKS: AS SHOWN ON PLAN.
 - SOILS MAPPING PROVIDED BY MARK HAMPTON ASSOCIATES, INC., PORTLAND, MAINE.
 - ZONE: R-3 RESIDENTIAL, PROPOSED USE: RESIDENTIAL UNITS
 - TAX MAP REFERENCE: MAP 338/LOTS A046-A050, A055 & K004.
 - TOTAL PARCEL = 2.51 acres±
 - WAIVERS: NONE REQUESTED.
 - CALL DIG-SAFE PRIOR TO COMMENCING WORK, 811 OR 1-888-DIG-SAFE.
 - EXISTING BUILDING IS SERVICED BY PUBLIC WATER AND SEWER.
 - POWER, TELEPHONE AND CABLE ARE EXISTING, NO CHANGE IS PLANNED.
 - ALL CONSTRUCTION AND SITE ALTERATIONS SHALL BE DONE IN ACCORDANCE WITH THE "MAINE EROSION AND SEDIMENT CONTROL BMP'S" PUBLISHED BY THE BUREAU OF LAND AND WATER QUALITY, MAINE DEPARTMENT OF ENVIRONMENTAL PROTECTION, LATEST EDITION, MARCH 2016.

SUBDIVISION PLAN, REED SCHOOL APARTMENTS, APPROVED BY THE CITY OF PORTLAND PLANNING BOARD

Rev.	Date	Description	Drawn	Check

Sheet Title:
SUBDIVISION RECORDING PLAT SHEET 1 of 2

Job No.: 478 Sheet No.:
Date: JUNE 19, 2018
Scale: AS SHOWN
Drawn: JDC
Checked: TSG

DATE

C1.1