

BUILDING AREA = 16,509 SF

- NOTES:
 1. PROVIDE SPRINKLER SYSTEM
 2. REFURBISH EXISTING WINDOWS AND PROVIDE NEW INTERIOR STORM WINDOWS
 2a. (ALT) PROVIDE NEW WOOD WINDOWS TO MATCH HISTORIC PROFILE.
 3. PROVIDE NEW ROOFTOP HVAC SYSTEM AND DUCTS.

TYPICAL FINISHES
 FLOOR: NEW VCT
 CEILING: NEW 2x2 ACT
 WALLS: PAINT EXG CMU

NEW WALL - STUD & GYP. BD.	[Symbol]
EXISTING WALL OR FLOOR	[Symbol]
DEMO AND REMOVE	[Symbol]
EXISTING DOOR	[Symbol] DEMO [Symbol] E.T.R.
NEW DOOR	[Symbol]

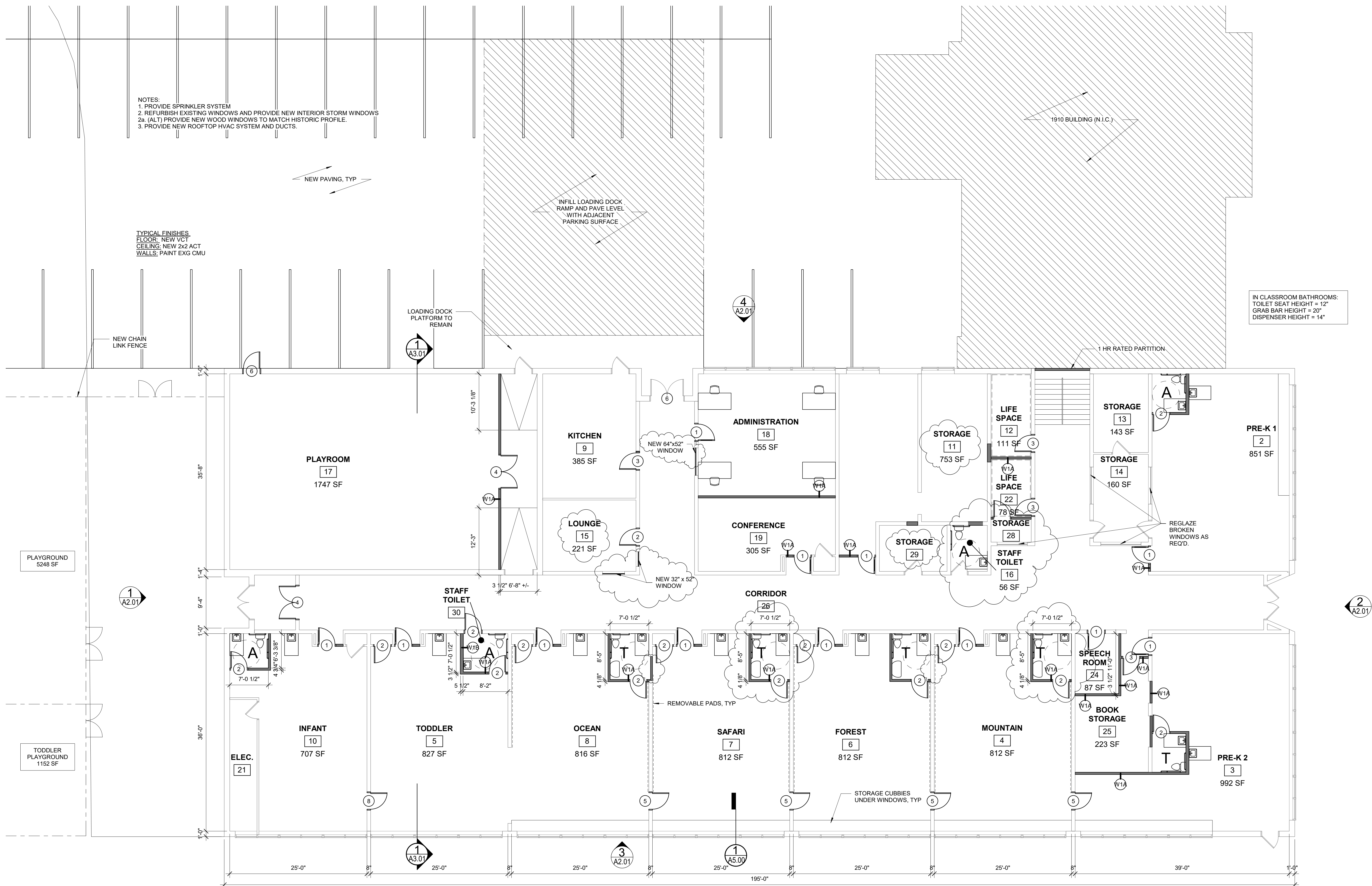

IN CLASSROOM BATHROOMS:
 TOILET SEAT HEIGHT = 12"
 GRAB BAR HEIGHT = 20"
 DISPENSER HEIGHT = 14"

Prepared For: **Owner**

Consultant: **ARCHETYPE architects**
 48 Union Wharf Portland, Maine 04101
 (207) 772-0023 ARCHETYPE@ARCHETYPEPA.COM

Project: **REED SCHOOL**
 28 HOMESTEAD AVE.
 PORTLAND, ME 04103

Revisions:
 1 Date 1 Revision 1

Date: **DEC. 7, 2016** Scale: **1/8" = 1'-0"**

FLOOR PLAN

A1.01