

Prepared For:  
**Children's Odyssey**

Consultant:

**ARCHETYPE**  
architects  
48 Union Wharf Portland, Maine 04101  
(207) 772-6022 ARCHETYPE@ARCHETYPEPA.COM

Project:  
**CHILDREN'S ODYSSEY**  
19 LIBBY STREET  
PORTLAND, ME 04103

Revisions:  
1 | Date 1 | Revision 1

Date:  
OCT, 2016  
Scale:  
1/8" = 1'-0"  
**LIFE SAFETY**

**LS1.0**

NEW WALL - 1 HOUR	
EXIT ACCESS	
TRAVEL DISTANCE	
DEAD END CORR.	
TRAVEL LENGTH	
COMMON PATH OF TRAVEL LENGTH	
EXIT ENTRANCE	
EXIT ENTRANCE	
FIRE EXTINGUISHER	
SMOKE PARTITION	

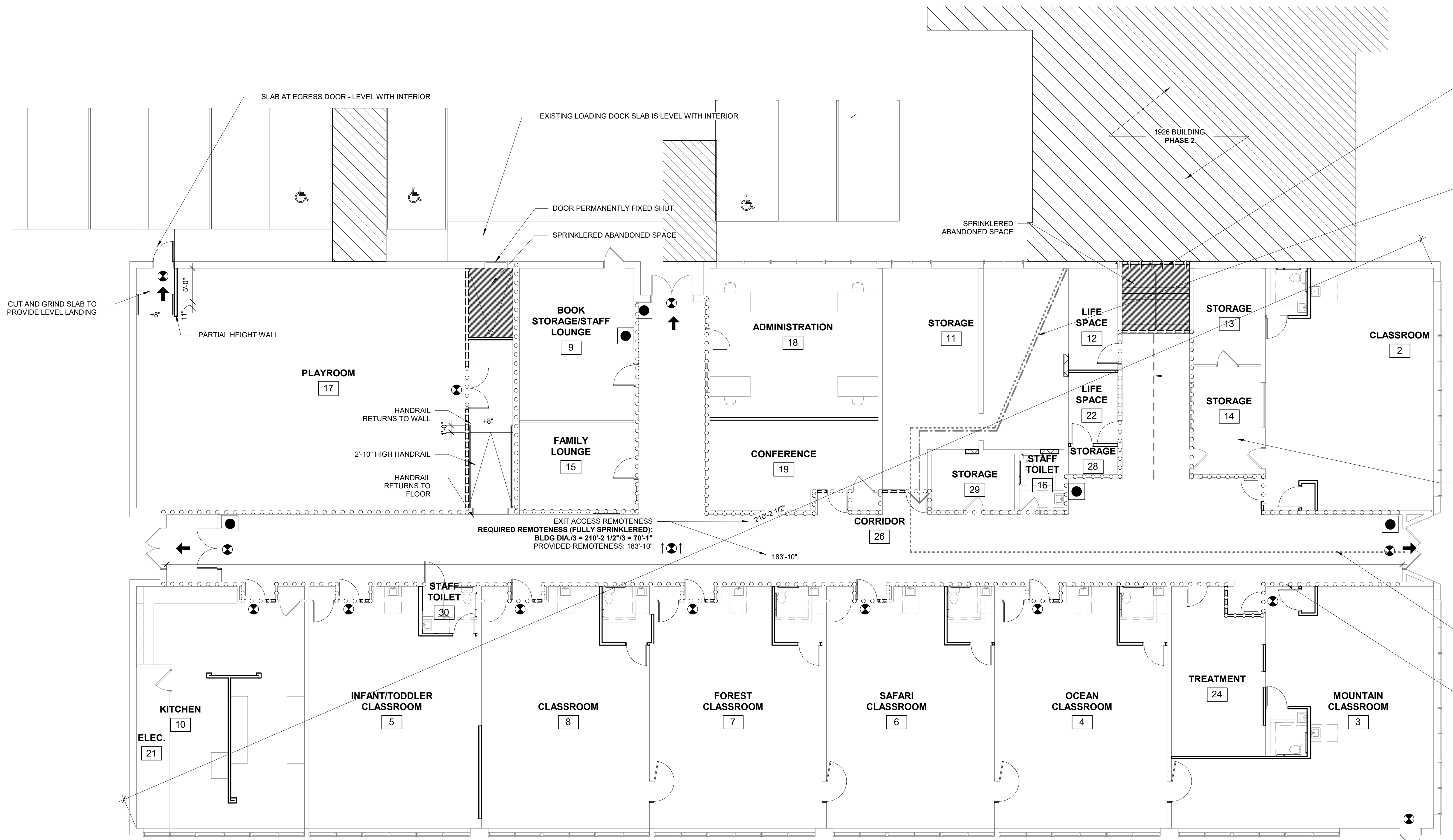

Per NFPA 101 table 6.1.14.4.1 (b), the separation is to be 2 hours. This rating is permitted to be reduced by one hour due to the building being protected by an approved automatic sprinkler system in accordance with 9.7.1.1 (1) and supervised in accordance with 9.7.2.

DISTANCE TO COMMON PATH OF TRAVEL = 48'-6"  
(distance not to exceed 75'-0")  
**1014.3 2009 IBC (most restrictive)**

DEAD END CORRIDOR DISTANCE = 21'-6"  
(length < 2.5 x 10' = 25')  
**1018.4 Ex. 3 2009 IBC (most restrictive)**

Aggregate storage area = 1,428 SF < 1,650 SF = (16,509 x 10%)  
Aggregate storage area is less than 10% of this story's area and does not exceed the tabular values in Table 503.

MAXIMUM TRAVEL DISTANCE TO EXIT = 130'-8"  
(1-4 not to exceed 200' sprinklered)  
**1016.1 2009 IBC, NFPA 16.2.6.2-16.2.6.3**

SEAL ALL PENETRATIONS IN SMOKE BARRIER  
  
Per NFPA 101 16.3.6, Corridors shall be 1 hr rated unless permitted by the following:  
(2) In buildings protected throughout by an approved, supervised automatic sprinkler system, corridor walls shall not be required to be rated, provided that such walls form smoke partitions.

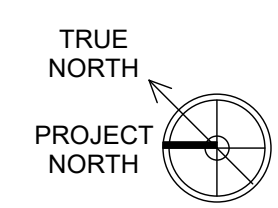

**1 | 1ST FLOOR - LIFESAFETY**  
1/8" = 1'-0"