

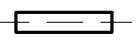



Prepared For:
Children's Odyssey

Address
City, State

-  4' LED FIXTURE
-  8' LED FIXTURE
-  NEW LED FIXTURE
-  NEW LED FIXTURE

NOTE:
ALL CEILINGS TO BE 12"x12" ACT UNLESS NOTED OTHERWISE

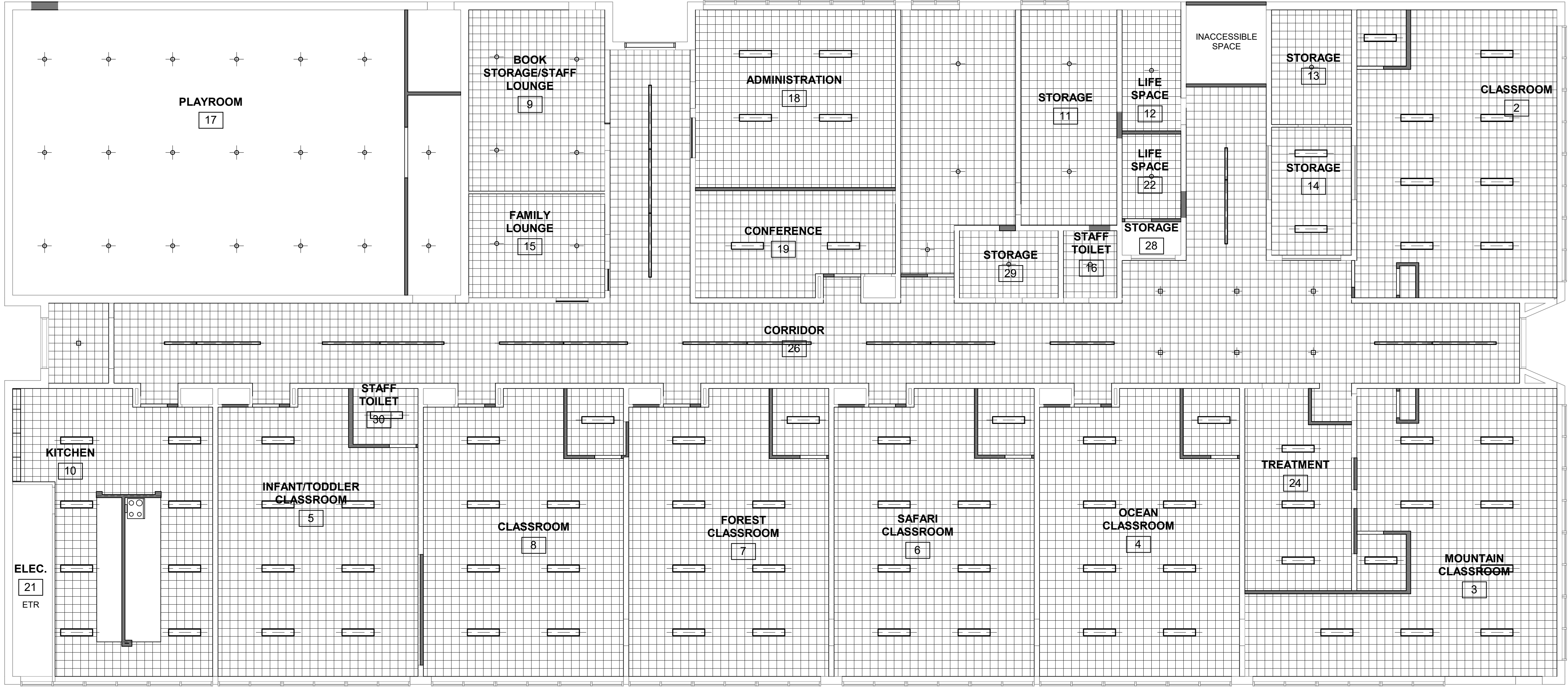

1 | 1ST FLOOR - NEW
1/8" = 1'-0"

Consultant:

ARCHETYPE
architects
48 Union Wharf Portland, Maine 04101
(207) 772-6022 ARCHETYPE@ARCHETYPEPA.COM

Architect:

Project:
CHILDREN'S ODYSSEY
19 LIBBY STREET
PORTLAND, ME 04103

Revisions:

Date:
OCT, 2016

Scale:
1/8" = 1'-0"

RCP

A7.01