

BUILDING AREA = 16,509 SF

- NOTES:
 1. PROVIDE SPRINKLER SYSTEM
 2. REFURBISH EXISTING WINDOWS AND PROVIDE NEW INTERIOR STORM WINDOWS
 2a. (ALT) PROVIDE NEW WOOD WINDOWS TO MATCH HISTORIC PROFILE.
 3. PROVIDE NEW ROOFTOP HVAC SYSTEM AND DUCTS.

TYPICAL FINISHES
 FLOOR: NEW VCT
 CEILING: NEW 2x2 ACT
 WALLS: PAINT EXG CMU

NEW WALL - STUD & GYP. BD.	
EXISTING WALL OR FLOOR	
DEMO AND REMOVE	
EXISTING DOOR	
NEW DOOR	

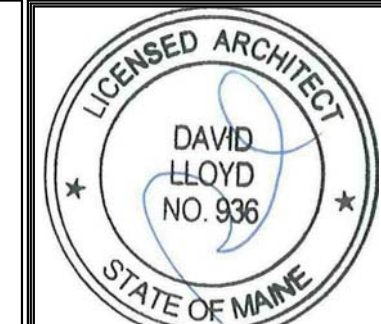

Prepared For:
Children's Odyssey

Consultant:
ARCHETYPE architects
 48 Union Wharf Portland, Maine 04101
 (207) 772-6023 ARCHETYPE@ARCHETYPEPA.COM

Project:
CHILDREN'S ODYSSEY
 19 LIBBY STREET
 PORTLAND, ME 04103

Revisions:

Date	Date	Revision
1		Revision 1

Date: OCT, 2016
 Scale: 1/8" = 1'-0"
FLOOR PLAN

A1.01

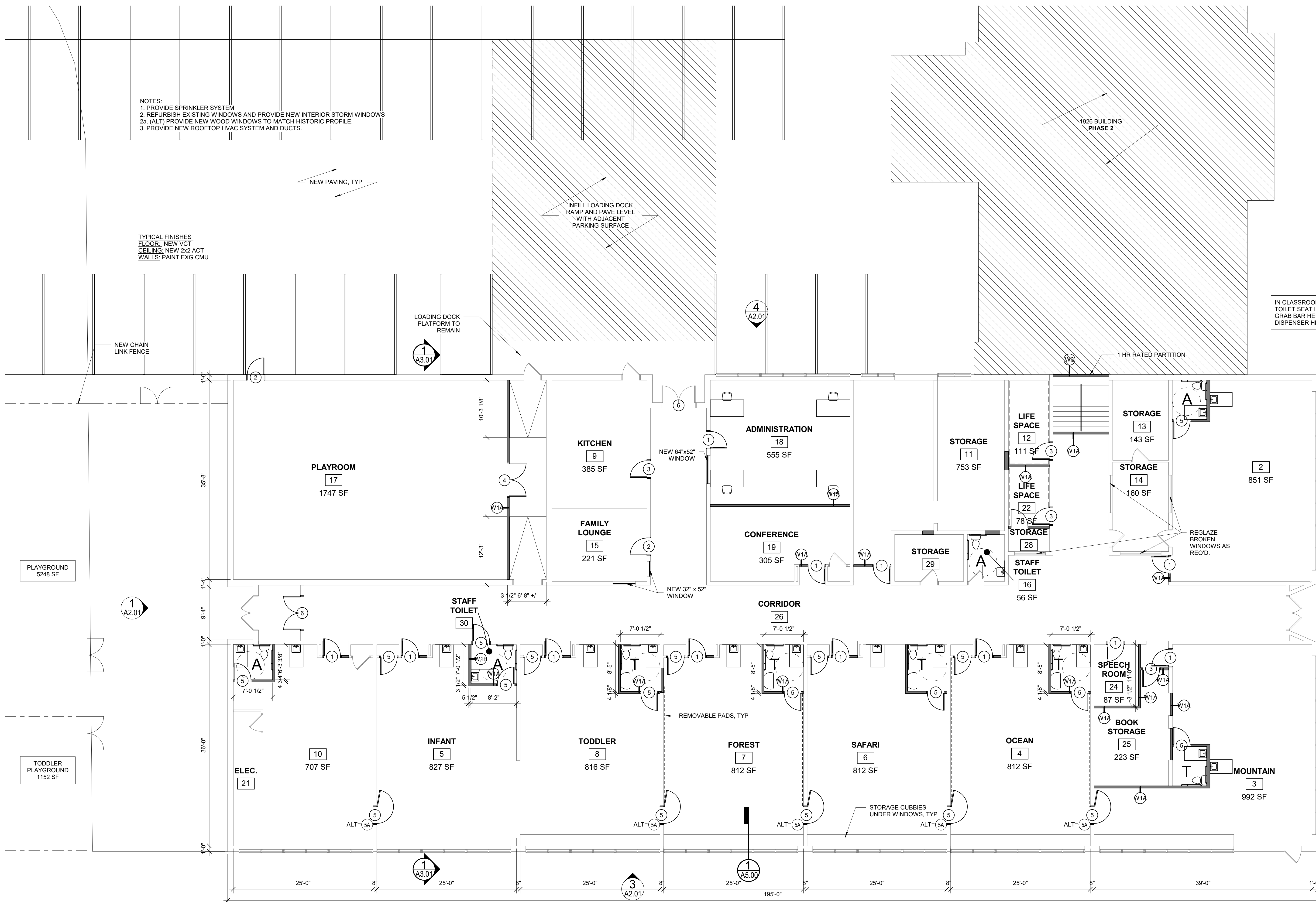

1 | 1ST FLOOR - NEW
 1/8" = 1'-0"

