

DISPLAY THIS CARD ON PRINCIPAL FRONTAGE OF WORK

# CITY OF PORTLAND

Please Read Application And Notes, If Any, Attached

DEPARTMENT OF BUILDING INSPECTION  
**PERMIT**

PERMIT ISSUED  
Permit Number: 041747  
DEC 16 2004  
CITY OF PORTLAND

This is to certify that Courtois Anne

has permission to 12x9 shed

AT 38 Libby St

338 J013001

provided that the person or persons, firm or corporation accepting this permit shall comply with all of the provisions of the Statutes of Maine and of the Ordinances of the City of Portland regulating the construction, maintenance and use of buildings and structures, and of the application on file in this department.

Apply to Public Works for street line and grade if nature of work requires such information.

Notification inspection must be given and work in progress must be reported before this building or part thereof is closed-in. 24 HOUR NOTICE IS REQUIRED.

A certificate of occupancy must be procured by owner before this building or part thereof is occupied.

OTHER REQUIRED APPROVALS

Fire Dept. Permit Number: 041746

Health Dept. \_\_\_\_\_

Appeal Board \_\_\_\_\_

Other \_\_\_\_\_  
Department Name

*James Bonke* 12/15/04  
Director - Building & Inspection Services

PENALTY FOR REMOVING THIS CARD

389 Congress Street, 04101 Tel: (207) 874-8703, Fax: (207) 874-8716

Permit	04-1747	338 J013001
--------	---------	-------------

Location of Construction: 38 Libby St	Owner Name: Courtois Anne	Owner Address: 38 Libby St	Phone:
Business Name:	Contractor Name:	Contractor Address:	Phone:
Lessee/Buyer's Name	Phone:	Permit Type: <del>Alterations - Dwellings</del> <b>Sheds</b>	Zone: <b>R3</b>

Past Use: single family	Proposed Use: single family shed	Permit Fee: \$30.00	Cost of Work: \$1,000.00	GEO District: 5
----------------------------	-------------------------------------	------------------------	-----------------------------	--------------------

Proposed Project Description: <b>12x9 shed</b>	FIRE DEPT: <input type="checkbox"/> Approved <input type="checkbox"/> Denied	INSPECTION: Use Group: <b>R3</b> Type: <b>accessory</b>
	Signature: <b>JMB 12/15/04</b>	

PEDESTRIAN ACTIVITIES DISTRICT (P.A.D.)

Action:  Approved  Approved w/Conditions  Denied

Signature: \_\_\_\_\_ Date: \_\_\_\_\_

Permit Taken By: dmartin	Date Applied For: 11/24/2004	<b>Zoning Approval</b>		
-----------------------------	---------------------------------	------------------------	--	--

<ol style="list-style-type: none"> <li>This permit application does not preclude the Applicant(s) from meeting applicable State and Federal Rules.</li> <li>Building permits do not include plumbing, septic or electrical work.</li> <li>Building permits are void if work is not started within <b>six (6)</b> months of the date of issuance. False information may invalidate a building permit and stop all work..</li> </ol>	<b>Special Zone or Reviews</b> <input type="checkbox"/> Shoreland <input type="checkbox"/> Wetland <input type="checkbox"/> Flood Zone <input type="checkbox"/> Subdivision <input type="checkbox"/> Site Plan Maj <input type="checkbox"/> Minor <input type="checkbox"/> MM <input type="checkbox"/> Date: <b>JMB 12/15/04</b>	<b>Zoning Appeal</b> <input type="checkbox"/> Variance <input type="checkbox"/> Miscellaneous <input type="checkbox"/> Conditional Use <input type="checkbox"/> Interpretation <input type="checkbox"/> Approved <input type="checkbox"/> Denied Date: _____	<b>Historic Preservation</b> <input checked="" type="checkbox"/> Not in District or Landmark <input type="checkbox"/> Does Not Require Review <input type="checkbox"/> Requires Review <input type="checkbox"/> Approved <input type="checkbox"/> Approved w/Conditions <input type="checkbox"/> Denied Date: <b>JMB</b>
--	---	---	---

**CERTIFICATION**

I hereby certify that I am the owner of record of the named property, or that the proposed work is authorized by the owner of record and that I have been authorized by the owner to make this application as his authorized agent and I agree to conform to all applicable laws of this jurisdiction. In addition, if a permit for work described in the application is issued, I certify that the code official's authorized representative shall have the authority to enter all areas covered by such permit at any reasonable hour to enforce the provision of the code(s) applicable to such permit.

SIGNATURE OF APPLICANT	ADDRESS	DATE	PHONE
RESPONSIBLE PERSON IN CHARGE OF WORK, TITLE		DATE	PHONE

# All Purpose Building Permit Application

If you or the property owner owes real estate or personal property taxes or user charges on any property within the City, payment arrangements must be made before permits of any kind are accepted.

Location/Address of Construction: <b>38 Libby St</b>		
Total Square Footage of Proposed Structure <b>108<sup>sq</sup></b>	Square Footage of Lot <b>Approx 5300<sup>sq</sup></b>	
Tax Assessor's Chart, Block & Lot Chart#      Block#      Lot# <b>238      5013</b>	Owner: <b>Anne (masm) Courtois</b>	Telephone: <b>233-8851</b>
Lessee/Buyer's Name (If Applicable)	Applicant name, address & telephone: <b>Dave Masan 38 Libby St Purt. 04103 / 233-8851</b>	cost Of Work: \$ <b>1000</b> Fee: \$ <del>0</del> <b>30.00</b>
<u>Single Family</u>		
If the location is currently vacant, what was prior use: _____		
Approximately how long has it been vacant: _____		
Proposed use: <u>10' x 9' - <del>wood</del> <del>structure</del> owner</u> Project description: <u>building sh</u>		
Contractor's name, address & telephone:		
Who should we contact when the permit is ready: <u>ave Masan (above)</u>		
Mailing address:		
We will contact you by phone when the permit is ready. You must come in and pick up the permit and review the requirements before starting any work, with a Plan Reviewer. A stop work order will be issued and a \$100.00 fee if any work starts before the permit is picked up.      PHONE: <b>233-8851</b>		

IF THE REQUIRED INFORMATION IS NOT INCLUDED IN THE SUBMISSIONS THE PERMIT WILL BE AUTOMATICALLY DENIED AT THE DISCRETION OF THE BUILDING/PLANNING DEPARTMENT, WE MAY REQUIRE ADDITIONAL INFORMATION IN ORDER TO APPROVE THIS PERMIT.

Signature of applicant: 	Date: <b>Nov 24, 2003</b>
---	---------------------------

This is NOT a permit, you may not commence ANY work until the permit is issued.  
If you are in a Historic District you may be subject to additional permitting and fees with the Planning Department on the 4<sup>th</sup> floor of City Hall

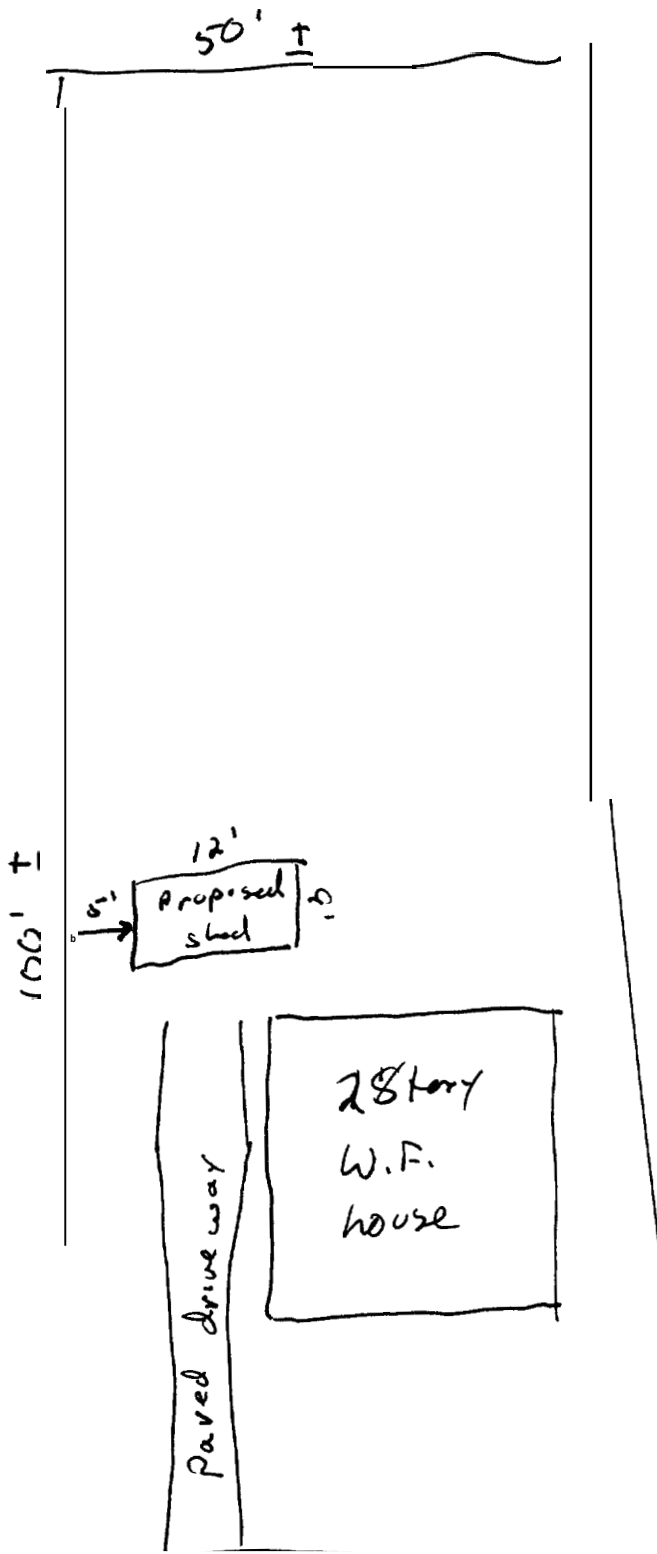

R3  
Min. 5' to side  
& Rear  
Setbacks

Libby St #38