

1
11

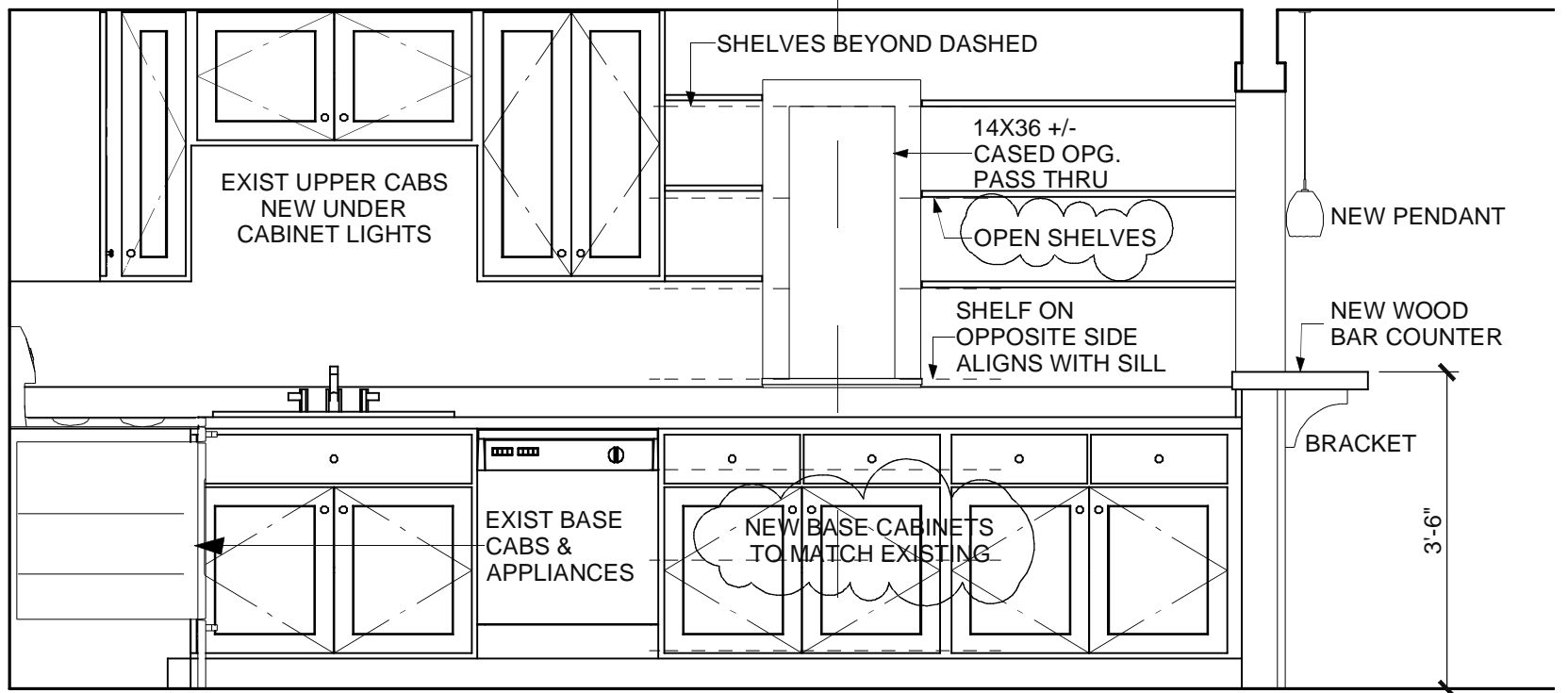

2 ~ Kitchen Elevation ~ 1/2 in = 1 ft

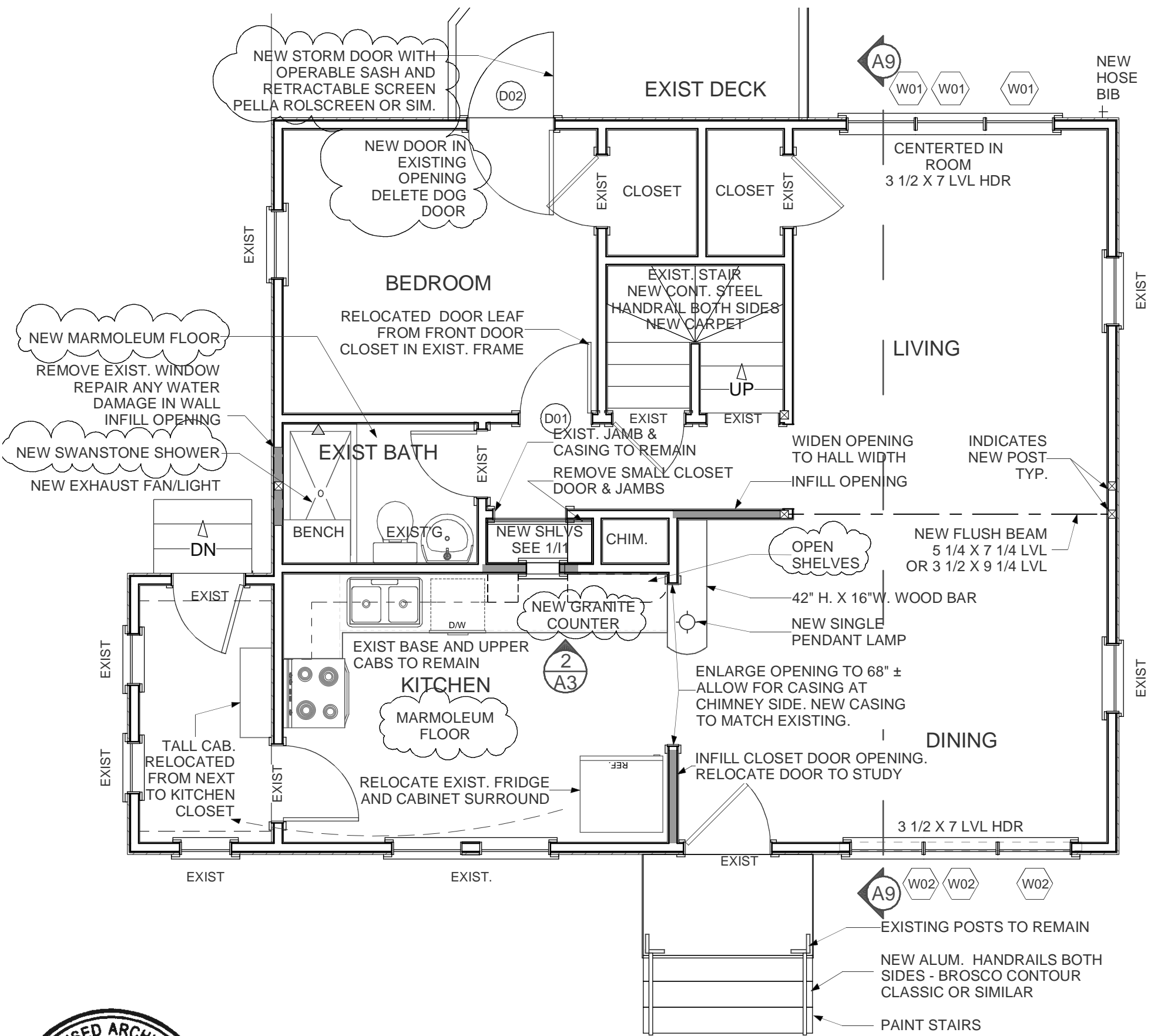

1st Floor ~ 1/4 in = 1 ft

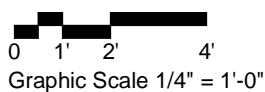

Kevin Moquin Architect
 Maine Licensed Architect
 Portland, ME
 www.km-a.me
 kevin@km-a.me | (207) 615-6421



Nancy & Hugh Hill
 Proposed Renovation
 Eastlawn Road, Portland, ME
 PERMIT SET
 6-4-2014 REV

PROPOSED FIRST FLOOR PLAN
A3