

City of Portland, Maine – Building or Use Permit Application 389 Congress Street, 04101, Tel: (207) 874-8703, FAX: 874-8716

971127

Location of Construction: 1597 Forest Ave		Owner: Stoekner, Mark L.		Phone:	
Owner Address: SAA Pctd, ME 04103		Lessee/Buyer's Name:		Phone:	
Contractor Name: Raymond Dupuis		Address: P.O. Box 8119 Pctd ME 04104		Phone: 758-4901	
Past Use: I-fam		Proposed Use: Same		COST OF WORK: \$ 2,500.00 PERMIT FEE: \$ 35.00 FIRE DEPT. <input type="checkbox"/> Approved <input type="checkbox"/> Denied INSPECTION: Use Group: Type: Signature: Signature:	
Proposed Project Description: Construct Deck (12 x 16) Install Slider				PEDESTRIAN ACTIVITIES DISTRICT (P.A.D.) Action: Approved <input type="checkbox"/> Approved with Conditions: <input type="checkbox"/> Denied <input type="checkbox"/> Signature: Date:	
Permit Taken By: Mary Gresik		Date Applied For: 06 October 1997			

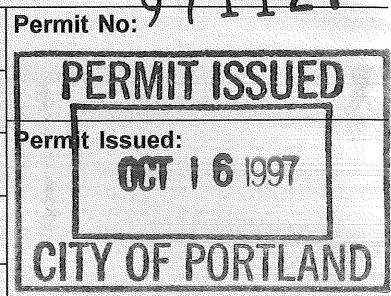

Permit No: 971127

Zone: CBL: 338-8-021

Zoning Approval: 338-8-021

Special Zone or Reviews:

Shoreland
 Wetland
 Flood Zone
 Subdivision
 Site Plan maj minor mm

- This permit application does not preclude the Applicant(s) from meeting applicable State and Federal rules.
- Building permits do not include plumbing, septic or electrical work.
- Building permits are void if work is not started within six (6) months of the date of issuance. False information may invalidate a building permit and stop all work..

Zoning Appeal

Variance
 Miscellaneous
 Conditional Use
 Interpretation
 Approved
 Denied

Historic Preservation

Not in District or Landmark
 Does Not Require Review
 Requires Review

Action:

Approved
 Approved with Conditions
 Denied

Date: _____

PERMIT ISSUED WITH REQUIREMENTS

PERMIT ISSUED WITH REQUIREMENTS

CERTIFICATION

I hereby certify that I am the owner of record of the named property, or that the proposed work is authorized by the owner of record and that I have been authorized by the owner to make this application as his authorized agent and I agree to conform to all applicable laws of this jurisdiction. In addition, if a permit for work described in the application is issued, I certify that the code official's authorized representative shall have the authority to enter all areas covered by such permit at any reasonable hour to enforce the provisions of the code(s) applicable to such permit

SIGNATURE OF APPLICANT: Raymond Dupuis ADDRESS: P.O. Box 8119 DATE: 06 October 1997 PHONE:

RESPONSIBLE PERSON IN CHARGE OF WORK, TITLE PHONE:

CEO DISTRICT 7

Location of Construction: 1597 Forest Ave
 Owner: Stolkner, Mark L.
 Phone: 71127

Owner Address: SAA PtlD, ME 04103
 Lessee/Buyer's Name: P.O. Box 8119 PtlD ME 04104
 Phone: 758-4901

Contractor Name: Raymond Dupuis
 Address: P.O. Box 8119 PtlD ME 04104
 Phone: 758-4901

Past Use: 1-fam
 Proposed Use: Same

COST OF WORK: \$ 2,500.00
PERMIT FEE: \$ 35.00

FIRE DEPT. Approved Denied
INSPECTION: Use Group: Type:

Signature: Signature: Signature:
 PEDESTRIAN ACTIVITIES DISTRICT (P.A.D.)
 Action: Approved
 Approved with Conditions:
 Denied

Permit Taken By: Mary Gresik
 Date Applied For: 06 October 1997

Proposed Project Description:
 Construct Deck (12 x 16)
 Install Slider

Zone: CBL: 338-H-021
 Zoning Approval: *10/14/97*
 Special Zone or Reviews:
 Shoreland
 Wetland
 Flood Zone
 Subdivision
 Site Plan maj minor mm

Zoning Appeal
 Variance
 Miscellaneous
 Conditional Use
 Interpretation
 Approved
 Denied

Historic Preservation
 Not in District or Landmark
 Does Not Require Review
 Requires Review

Action:
 Approved
 Approved with Conditions
 Denied
 Date: 10/17/97

PERMIT ISSUED WITH REQUIREMENTS

CERTIFICATION
 I hereby certify that I am the owner of record of the named property, or that the proposed work is authorized by the owner of record and that I have been authorized by the owner to make this application as his authorized agent and I agree to conform to all applicable laws of this jurisdiction. In addition, if a permit for work described in the application is issued, I certify that the code official's authorized representative shall have the authority to enter all areas covered by such permit at any reasonable hour to enforce the provisions of the code(s) applicable to such permit

SIGNATURE OF APPLICANT: *Raymond Dupuis*
 ADDRESS: P.O. Box 8119
 DATE: 06 October 1997
 PHONE: _____

RESPONSIBLE PERSON IN CHARGE OF WORK, TITLE
 PHONE: _____

White-Permit Desk Green-Assessor's Canary-D.P.W. Pink-Public File Ivory Card-Inspector

CEO DISTRICT **7**
K. Carroll

PERMIT ISSUED

PERMIT ISSUED

PERMIT ISSUED

PERMIT ISSUED

PERMIT ISSUED

PERMIT ISSUED

PERMIT ISSUED

PERMIT ISSUED

PERMIT ISSUED

PERMIT ISSUED

PERMIT ISSUED

PERMIT ISSUED

BUILDING PERMIT REPORT

DATE: 15 OCT 97 ADDRESS: 1597 Forest Ave
REASON FOR PERMIT: To Construct deck / Installed Slider
BUILDING OWNER: Mark L. Stalkner
CONTRACTOR: Raymond Dupuis
PERMIT APPLICANT: Contractor APPROVAL: *1, *2, *8, *10, *30 ~~PERMITS~~
USE GROUP R3 BOCA 1996 CONSTRUCTION TYPE 513

CONDITION(S) OF APPROVAL

- *1. This permit does not excuse the applicant from meeting applicable State and Federal rules and laws.
- *2. Before concrete for foundation is placed, approvals from the Development Review Coordinator and Inspection Services must be obtained. (A 24 hour notice is required prior to inspection)
3. Precaution must be taken to protect concrete from freezing.
4. It is strongly recommended that a registered land surveyor check all foundation forms before concrete is placed. This is done to verify that the proper setbacks are maintained.
5. Private garages located beneath habitable rooms in occupancies in Use Group R-1, R-2, R-3 or I-1 shall be separated from adjacent interior spaces by fire partitions and floor/ceiling assembly which are constructed with not less than 1-hour fire resisting rating. Private garages attached side-by-side to rooms in the above occupancies shall be completely separated from the interior spaces and the attic area by means of ½ inch gypsum board or the equivalent applied to the garage means of ½ inch gypsum board or the equivalent applied to the garage side. (Chapter 4 Section 407.0 of the BOCA/1996)
6. All chimneys and vents shall be installed and maintained as per Chapter 12 of the City's Mechanical Code. (The BOCA National Mechanical Code/1993).
7. Sound transmission control in residential building shall be done in accordance with Chapter 12 section 1214.0 of the city's building code.
- *8. Guardrails & Handrails: A guardrail system is a system of building components located near the open sides of elevated walking surfaces for the purpose of minimizing the possibility of an accidental fall from the walking surface to the lower level. Minimum height all Use Groups 42" , except Use Group R which is 36". In occupancies in Use Group A, B, H-4, I-1, I-2 M and R and public garages and open parking structures, open guards shall have balusters or be of solid material such that a sphere with a diameter of 4" cannot pass through any opening. Guards shall not have an ornamental pattern that would provide a ladder effect. (Handrails shall be a minimum of 34" but not more than 38". Use Group R-3 shall not be less than 30". but not more than 38".)
9. Headroom in habitable space is a minimum of 7'6".
- *10. Stair construction in Use Group R-3 & R-4 is a minimum of 10" tread and 7 3/4" maximum rise. All other Use group minimum 11" tread. 7" maximum rise.
11. The minimum headroom in all parts of a stairway shall not be less than 80 inches. (6' 8")
12. Every sleeping room below the fourth story in buildings of use Groups R and I-1 shall have at least one operable window or exterior door approved for emergency egress or rescue. The units must be operable from the inside without the use of special knowledge or separate tools. Where windows are provided as means of egress or rescue they shall have a sill height not more than 44 inches (1118mm) above the floor. All egress or rescue windows from sleeping rooms shall have a minimum net clear opening height dimension of 24 inches (610mm). The minimum net clear opening width dimension shall be 20 inches (508mm), and a minimum net clear opening of 5.7 sq. ft.
13. Each apartment shall have access to two (2) separate, remote and approved means of egress. A single exit is acceptable when it exits directly from the apartment to the building exterior with no communications to other apartment units.
14. All vertical openings shall be enclosed with construction having a fire rating of at least one (1) hour, including fire doors with self closer's.
15. The boiler shall be protected by enclosing with (1) hour fire-rated construction including fire doors and ceiling, or by providing automatic extinguishment.
16. All single and multiple station smoke detectors shall be of an approved type and shall be installed in accordance with the provisions of the City's Building Code Chapter 9, Section 19, 920.3.2 (BOCA National Building Code/1996), and NFPA 101 Chapter 18 & 19. (Smoke detectors shall be installed and maintained at the following locations):
 - In the immediate vicinity of bedrooms
 - In all bedrooms

• In each story within a dwelling unit, including basements
In addition to the required AC primary power source, required smoke detectors in occupancies in Use Groups R-2, R-3 and I-1 shall receive power from a battery when the AC primary power source is interrupted. (Interconnection is required)

- 17. A portable fire extinguisher shall be located as per NFPA #10. They shall bear the label of an approved agency and be of an approved type.
- 18. The Fire Alarm System shall be maintained to NFPA #72 Standard.
- 19. The Sprinkler System shall maintained to NFPA #13 Standard.
- 20. All exit signs, lights, and means of egress lighting shall be done in accordance with Chapter 10 Section & Subsections 1023. & 1024. Of the City's building code. (The BOCA National Building Code/1996)
- 21. No construction or demolition work shall begin until you have obtained permits for dumpsters or containers. A work Stop Order shall be issued if this requirement is not met.
- 22. Section 25-135 of the Municipal Code for the City of Portland states, "No person or utility shall be granted a permit to excavate or open any street or sidewalk from the time of November 15 of each year to April 15 of the following year".
- 23. The builder of a facility to which Section 4594-C of the Maine State Human Rights Act Title 5 MRSA refers, shall obtain a certification from a design professional that the plans commencing construction of the facility, the builder shall submit the certification to the Division of Inspection Services.
- 24. This permit does not excuse the applicant from obtaining any license which may be needed from the City Clerk's office.
- 25. Ventilation shall meet the requirements of Chapter 12 Sections 1210. of the City's Building Code.
- 26. All electrical, plumbing and HVAC permits must be obtained by a Master Licensed holders of their trade.
- 27. All requirements must be met before a final Certificate of Occupancy is issued.
- 28. All building elements shall meet the fastening schedule as per Table 2305.2 of the City's Building Code. (The BOCA National Building Code/1996).
- 29. Ventilation of spaces within a building shall be done in accordance with the City's Mechanical Code (The BOCA National Mechanical Code/1993).
- 30. *Your proposed 5000 Tubes must rest on a Footing with anchor connecting the two -*
- 31. _____
- 32. _____
- 33. _____
- 34. _____

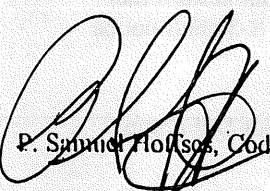
P. Samuel Hoffsoos, Code Enforcement
cc: Lt. McDougall, PFD
Marge Schmuckal

Applicant: Raymond Dupuis

Date: 10/14/97

Address: 1597 Forest Ave

C-B-L: 338-H-21

CHECK-LIST AGAINST ZONING ORDINANCE

Date - Existing 1923

Zone Location - B1 - using R-3 requirements

Interior or corner lot - Forest in Newton

Proposed Use/Work - construct 12x16 deck in stall slider

Sewage Disposal -

Lot Street Frontage -

Front Yard - N/A

Rear Yard - 25' req - 25' shown

Side Yard - 8' req - 15' shown

Projections -

Width of Lot -

Height - 1 story

Lot Area - 9,207 sq ft

Lot Coverage/ Impervious Surface - 25% max or 2302 sq ft

Area per Family -

Off-street Parking -

Loading Bays -

Site Plan - N/A

Shoreland Zoning/ Stream Protection - N/A

Flood Plains - N/A

$4 \times 7 = 28$
 $24 \times 26 = 624$
 $8 \times 24 = 192$

 844 sq ft
 192

 1036

12x16

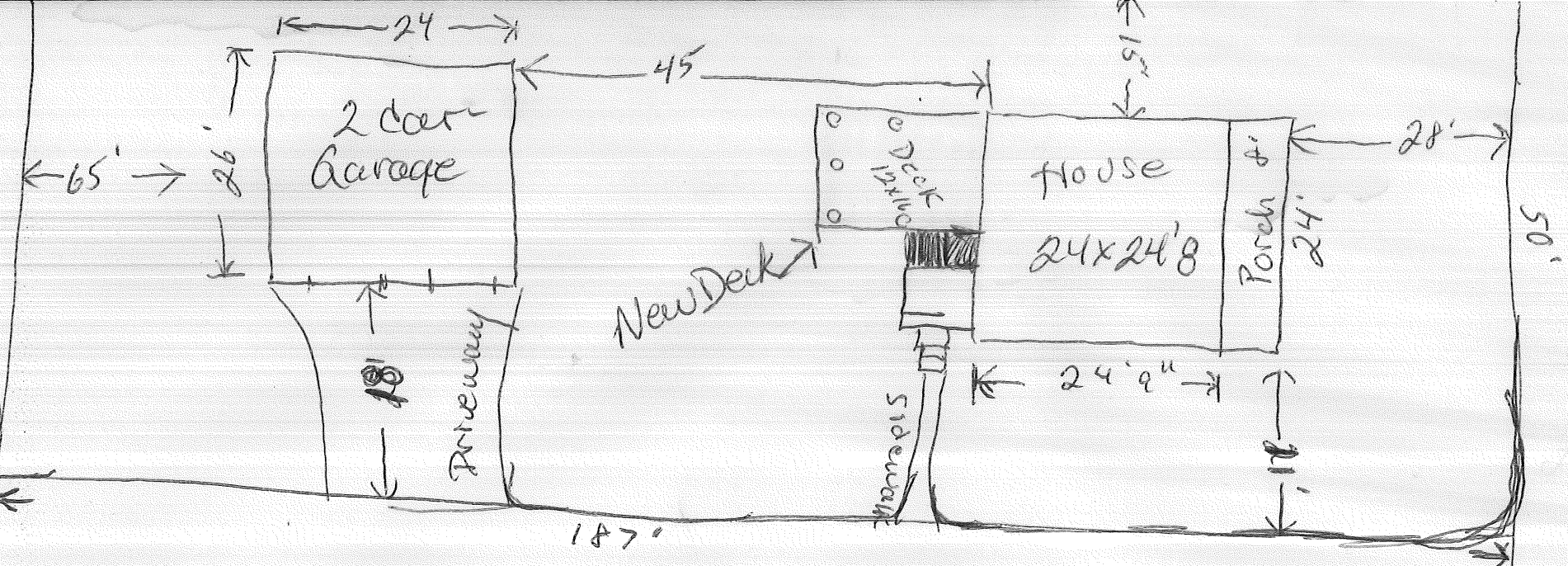

Newton St.

1597 - Forest Ave -

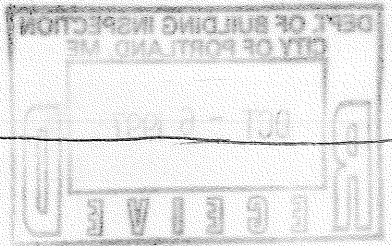

1597 - Forest Ave -
1597 - Forest Ave -
1597 - Forest Ave -
1597 - Forest Ave -
1597 - Forest Ave -

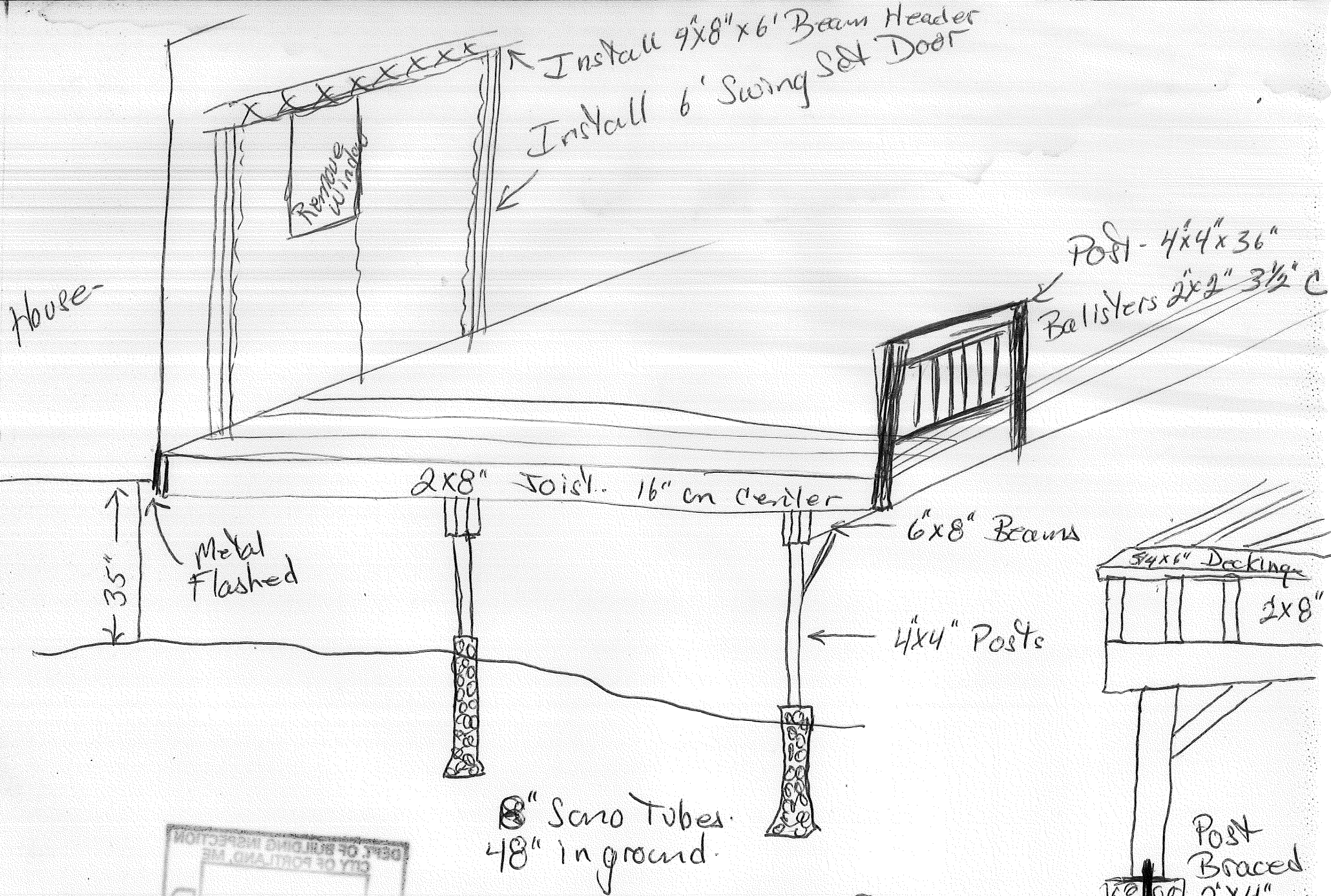

House

Install 4x8"x6' Beam Header
 Install 6' Swing Set Door

Remove Window

Post - 4x4x36"
 Balusters 2x2" 3 1/2" C

35"

Metal Flashed

2x8" Joist - 16" on center

6x8" Beams

4x4" Posts

5/4x6" Decking

2x8"

8" Sano Tubes
 48" in ground.

Post Braced
 2x4"

Pin In
 Concrete.



New Deck + Patio Door

Mark Stolkener
 1597 Forest Ave.
 797-8936

Deck 12' x 16'

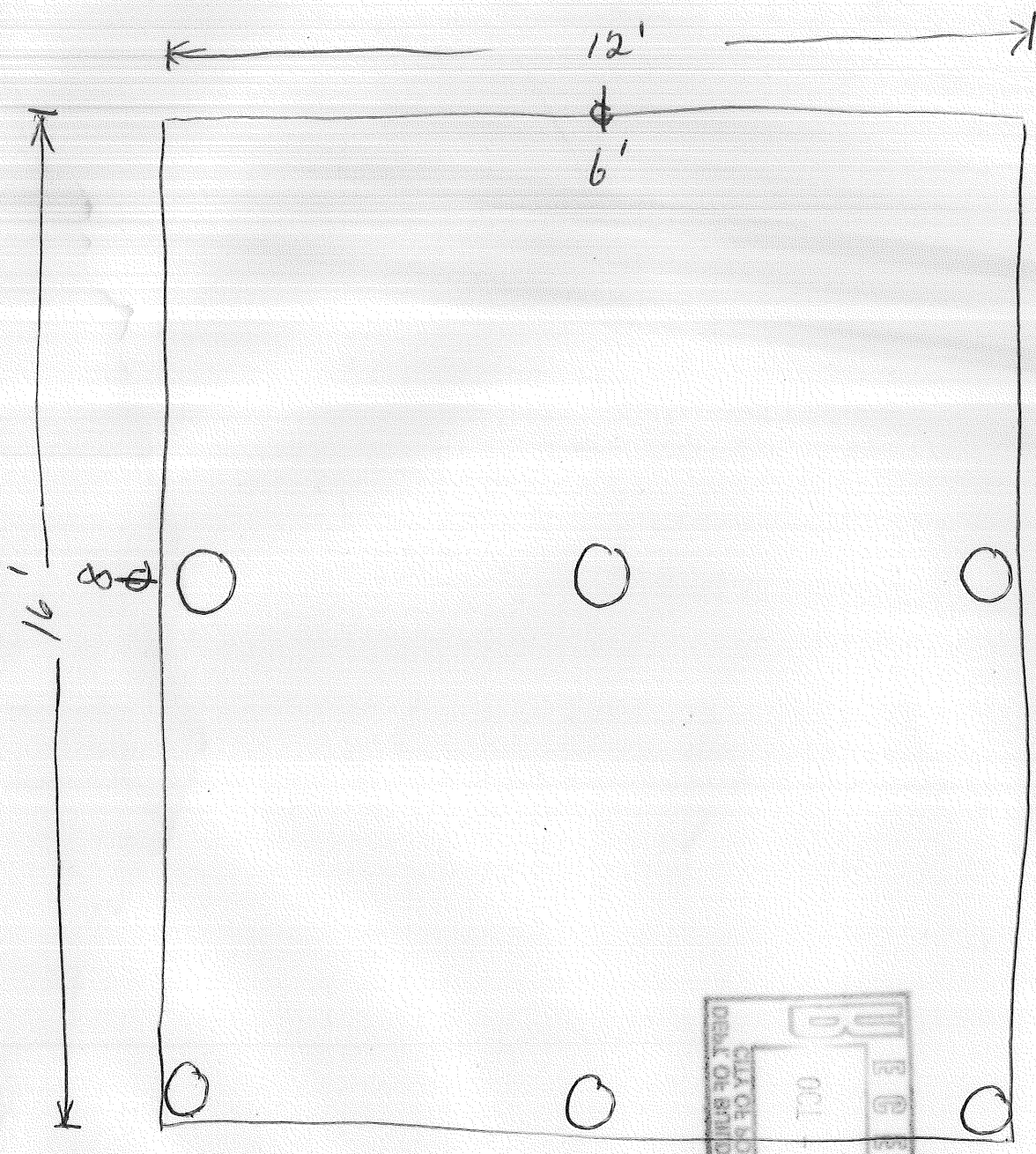

- 8" Sono Tubes 48" inground
- 6" x 8" Center Beams
- 2" x 8" Joist. 16" on Center
- 4" x 4" Post. 36" High
- 2" x 2" Balusters 3 1/2" Centers

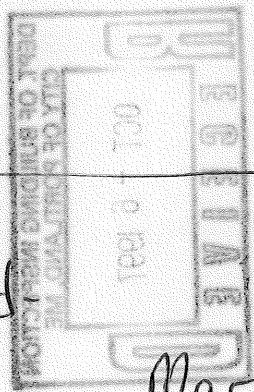

Mark Stolkener
1597 Forest Ave.
797-8934