

17-19 NEWTON ST.

STANDARD FILE
9203-3P



RESIDENCE ZONE - A

APPLICATION FOR PERMIT

Class of Building or Type of Structure Third Class

Portland, Maine, May 29, 1957

PERMIT ISSUED

MAY 31 1957

00764

CITY of PORTLAND

To the INSPECTOR OF BUILDINGS, PORTLAND, MAINE

The undersigned hereby applies for a permit to erect ~~and to install~~ all the following building structure equipment in accordance with the Laws of the State of Maine, the Building Code and Zoning Ordinance of the City of Portland, plans and specifications, if any, submitted herewith and the following specifications:

Location Lots 21-22, Newton Street (11-19) Within Fire Limits? Dist. No.

Owner's name and address Carl Hayden, 1761 Forest Ave. Telephone

Lessee's name and address Telephone

Contractor's name and address owner Telephone

Architect Specifications Plans yes No. of sheets 3

Proposed use of building Dwelling No. families 1

Last use No. families

Material No. stories Heat Style of roof Roofing

Other building on same lot

Estimated cost \$ 7,500. Fee \$ 8.00

General Description of New Work

To construct 1-story frame dwelling house 24' x 36'

show the work of the building department approved for the same.

Permit Issued with Letter

It is understood that this permit does not include installation of heating apparatus which is to be taken out separately by and in the name of the heating contractor. **PERMIT TO BE ISSUED TO** owner

Details of New Work

Is any plumbing involved in this work? yes Is any electrical work involved in this work? yes

Is connection to be made to public sewer? If not, what is proposed for sewage? septic tank

Has septic tank notice been sent? Form notice sent?

Height average grade to top of plate 24' 9" Height average grade to highest point of roof 17'

Size, front 36' depth 24' No. stories 1 Solid or filled land? solid earth or rock? earth

Material of foundation concrete at least 4" below grade Thickness, top 10" bottom 10" cellar yes

Material of underpinning " to sill Height Thickness

Kind of roof pitch Rise per foot 7" Roof covering asphalt roofing Class C Und. Lab.

No. of chimneys 1 Material of chimneys brick of lining tile Kind of heat h.w. fuel gas

Framing Lumber—Kind hemlock Dressed or full size? dressed Corner posts 4x6 Sills 2x8 box

Size Girder 6x8 fs. Columns under girders Lally Size 3 1/2" Max. on centers 7' 6"

Kind and thickness of outside sheathing of exterior walls? 1" boards

Studs (outside walls and carrying partitions) 2x4-16" O. C. Bridging in every floor and flat roof span over 8 feet.

Joists and rafters: 1st floor 2x8 2nd 2x6 3rd roof 2x6

On centers: 1st floor 16" 2nd 24" 3rd roof 24"

Maximum span: 1st floor 12' 2nd 3rd roof 14'

If one story building with masonry walls, thickness of walls? height?

If a Garage

No. cars now accommodated on same lot , to be accommodated number commercial cars to be accommodated

Will automobile repairing be done other than minor repairs to cars habitually stored in the proposed building?

APPROVED:
with letter by AJJ

Miscellaneous

Will work require disturbing of any tree on a public street? no

Will there be in charge of the above work a person competent to see that the State and City requirements pertaining thereto are observed? yes

INSPECTION COPY

Signature of owner

Carl W Hayden

NOTES

7/3/57 - Form work made
2.8.8

7/8/57 - Form gained
and stopped 2.8.8

8/15/57 - Forming wall
along - roof shingled
2.8.8

8/16/57 - 1/2" - 7 b
lines 2.8.8

10/19/57 - programing
0.5. 2.8.8

10/23/57 - installation
Curt. to be made
2.8.8

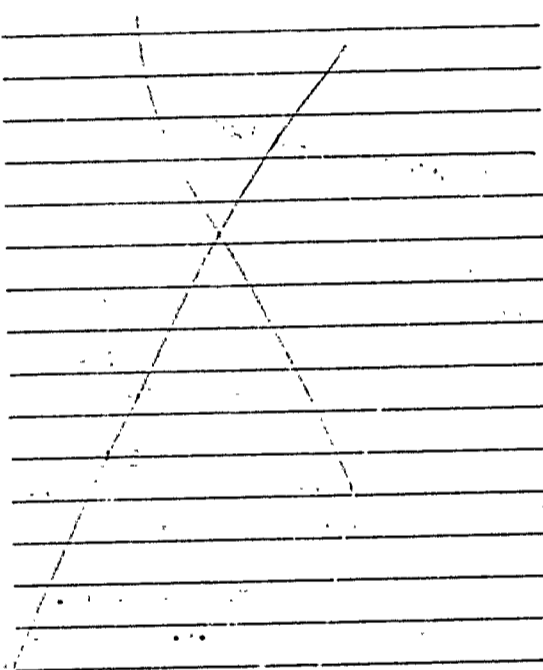

Permit No. 57764

Location 2652102 New-Ex. St

Owner Don E. H. H. H.

Date of permit 5-31-57

Notif. closing-in 8/15/57

Insp. closing-in 8/15/57

Final Notif. 10/23/57

Final Inspn. 10/23/57

Cert. of Occupancy issued 10/23/57

Staking Out Notice

Form Check Notice

(COPY)

CITY OF PORTLAND, MAINE
Department of Building Inspection



Certificate of Occupancy

LOCATION **Lot 21-22 Newton Street**

Issued to **Carl Haylen**

Date of Issue **October 24, 1957**

This is to certify that the building, premises, or part thereof, at the above location, built—~~erected~~
~~erected~~ under Building Permit No. **57764**, has had final inspection, has been found to conform
substantially to requirements of Zoning Ordinance and Building Code of the City, and is hereby approved for
occupancy or use, limited or otherwise, as indicated below.

PORTION OF BUILDING OR PREMISES

APPROVED OCCUPANCY

Entire

1-family dwelling

Limiting Conditions:

This certificate supersedes
certificate issued

Approved:

(Date)

Inspector

Inspector of Buildings

Notice: This certificate identifies lawful use of building or premises, and ought to be transferred from
owner to owner when property changes hands. Copy will be furnished to owner or lessee for one dollar.

CS 147
CS 147

AP - 17-19 Newton Street

May 31, 1957

Mr. Carl W. Hayden
1761 Forest Avenue

Dear Mr. Hayden:

Building permit for construction of a single family dwelling 24 feet by 36 feet at the above named location is issued herewith subject to the condition that before notification is given for check of forms prior to pouring concrete for foundation walls, the following information will be furnished or else approval will be secured for some other type of acceptable construction.

- 0.15.1. Foundation and framing of entrance platforms.
- 0.15.2. That because the 7-inch pitch of roof would allow use or finishing off of attic for living quarters, the 2x6 ceiling timbers will be spaced 16 inches on centers instead of the 24 inch spacing indicated.
- 0.15.3. That girders will be 8x8 or 6x10 spruce or hemlock instead of the 6x8 full size which does not figure out on the 7½ foot spans indicated.

very truly yours,

Albert J. Sears
Deputy Inspector of Buildings

AJS/H



FILL IN AND SIGN WITH INK

APPLICATION FOR PERMIT FOR HEATING, COOKING OR POWER EQUIPMENT

Portland, Maine, September 10, 1957

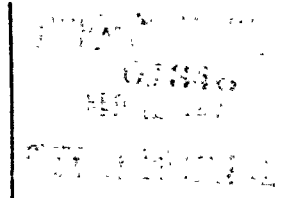

To the INSPECTOR OF BUILDINGS, PORTLAND, ME.

The undersigned hereby applies for a permit to install the following heating, cooking or power equipment in accordance with the Laws of Maine, the Building Code of the City of Portland, and the following specifications:

Location 17-19 Newton Street, Portland Use of Building Residence (new hsg) No. Stories 1 X New Building Existing " Name and address of owner of appliance Carl W. Hayden, Builder, 1761 Forest Ave., City Installer's name and address Ballard Oil & Equipment Co., 135 Marginal Way Telephone SP. 21991

General Description of Work

To install Oil fired forced hot water baseboard radiation heating system with tankless coil.

IF HEATER, OR POWER BOILER

Location of appliance Basement Any burnable material in floor surface or beneath? None so, how protected? Kind of fuel? # 2 oil Minimum distance to burnable material, from top of appliance or casing top of furnace 30" From top of smoke pipe 24" From front of appliance 5' From sides or back of appliance 5' Size of chimney flue 8 x 8 Other connections to same flue None If gas fired, how vented? Rated maximum demand per hour 1.0 GPH Will sufficient fresh air be supplied to the appliance to insure proper and safe combustion? Yes

IF OIL BURNER

Name and type of burner Ballard Gun Type model H7 Labelled by underwriters' laboratories? Yes Will operator be always in attendance? No Does oil supply line feed from top or bottom of tank? Bottom Type of floor beneath burner Concrete Size of vent pipe 1 1/4" Location of oil storage Basement Number and capacity of tanks 1 275 Low water shut off Not required Make No Will all tanks be more than five feet from any flame? Yes How many tanks enclosed? None Total capacity of any existing storage tanks for furnace burners None

IF COOKING APPLIANCE

Location of appliance Any burnable material in floor surface or beneath? If so, how protected? Height of Legs, if any Skirting at bottom of appliance? Distance to combustible material from top of appliance? From front of appliance From sides and back From top of smoke pipe Size of chimney flue Other connections to same flue Is hood to be provided? If so, how vented? Forced or gravity? If gas fired, how vented? Rated maximum demand per hour

MISCELLANEOUS EQUIPMENT OR SPECIAL INFORMATION

Blank lines for miscellaneous information.

Amount of fee enclosed? 2.00 (\$2.00 for one heater, etc., 50 cents additional for each additional heater, etc., in same building at same time.)

APPROVED: 0.15-288 9/11/57

Will there be in charge of the above work a person competent to see that the State and City requirements pertaining thereto are observed?

BALLARD OIL & EQUIPMENT CO. Richard J. Cole, Manager Oil Heating Department

C17 MAINE PRINTING CO.

INSPECTION COPY

Signature of Installer

F.M.



FILL IN AND SIGN WITH INK

APPLICATION FOR PERMIT FOR HEATING, COOKING OR POWER EQUIPMENT

Portland, Maine, August 15, 1957

PERMIT ISSUED
AUG 16 1957
CITY OF PORTLAND

To the INSPECTOR OF BUILDINGS, PORTLAND, ME.

The undersigned hereby applies for a permit to install the following heating, cooking or power equipment in accordance with the Laws of Maine, the Building Code of the City of Portland, and the following specifications.

Location 17 Newton St. Use of Building Dwelling No. Stories 1 New Building Existing " Name and address of owner of appliance Carl W. Hayden, 1781 Forest Ave. Installer's name and address Portland Gas Light Company 5, Temple St. Telephone 2-8321

General Description of Work

To install Gas-fired GK-16 MB National Packet forced hot water heating system.

IF HEATER, OR POWER BOILER

Location of appliance basement Any burnable material in floor surface or beneath? no If so, how protected? Kind of fuel? gas Minimum distance to burnable material, from top of appliance or casing top of furnace 2' From top of smoke pipe over 15" From front of appliance over 4' From sides or back of appliance over 3' Size of chimney flue 8x12 Other connections to same flue none If gas fired, how vented? Rated maximum demand per hour Will sufficient fresh air be supplied to the appliance to insure proper and safe combustion? yes

IF OIL BURNER

Make and type of burner Labelled by underwriters' laboratories? Operator be always in attendance? Does oil supply line feed from top or bottom of tank? Type of floor beneath burner Size of vent pipe Location of oil storage Number and capacity of tanks Low water shut off Make No. Will all tanks be more than five feet from any flame? How many tanks enclosed? Total capacity of any existing storage tanks for furnace burners

IF COOKING APPLIANCE

Location of appliance Any burnable material in floor surface or beneath? If so, how protected? Height of Legs, if any Skirting at bottom of appliance? Distance to combustible material from top of appliance? From front of appliance From sides and back From top of smokepipe Size of chimney flue Other connections to same flue Is hood to be provided? If so, how vented? Forced or gravity? If gas fired, how vented? Rated maximum demand per hour

MISCELLANEOUS EQUIPMENT OR SPECIAL INFORMATION

Furnace is equipped with device which will automatically shut off all gas supply in case pilot flame is extinguished.

Amount of fee enclosed? 2.00 (\$2.00 for one heater, etc., 50 cents additional for each additional heater, etc., in same building at same time.)

APPROVED:

O.K. 8.8. 8/15/57

Will there be in charge of the above work a person competent to see that the State and City requirements pertaining thereto are observed? yes Carl W. Hayden Portland Gas. Light Company

CITY OF PORTLAND MAINE PRINTING CO.

INSPECTION COPY

Signature of Installer by:

Carl W. Hayden

F.M.

17-19

Before notice is given for date of
street line and grade
will be provided from and
staked out by Dept of Public Works

owner - Donald H. McKinnon
Contractor - Brighton Ave. Builders
Plumber - Wm. McEgan.

Applicant takes full responsibility
for accuracy of lot boundary
markings.

Scale of main building project -
6"

12+13

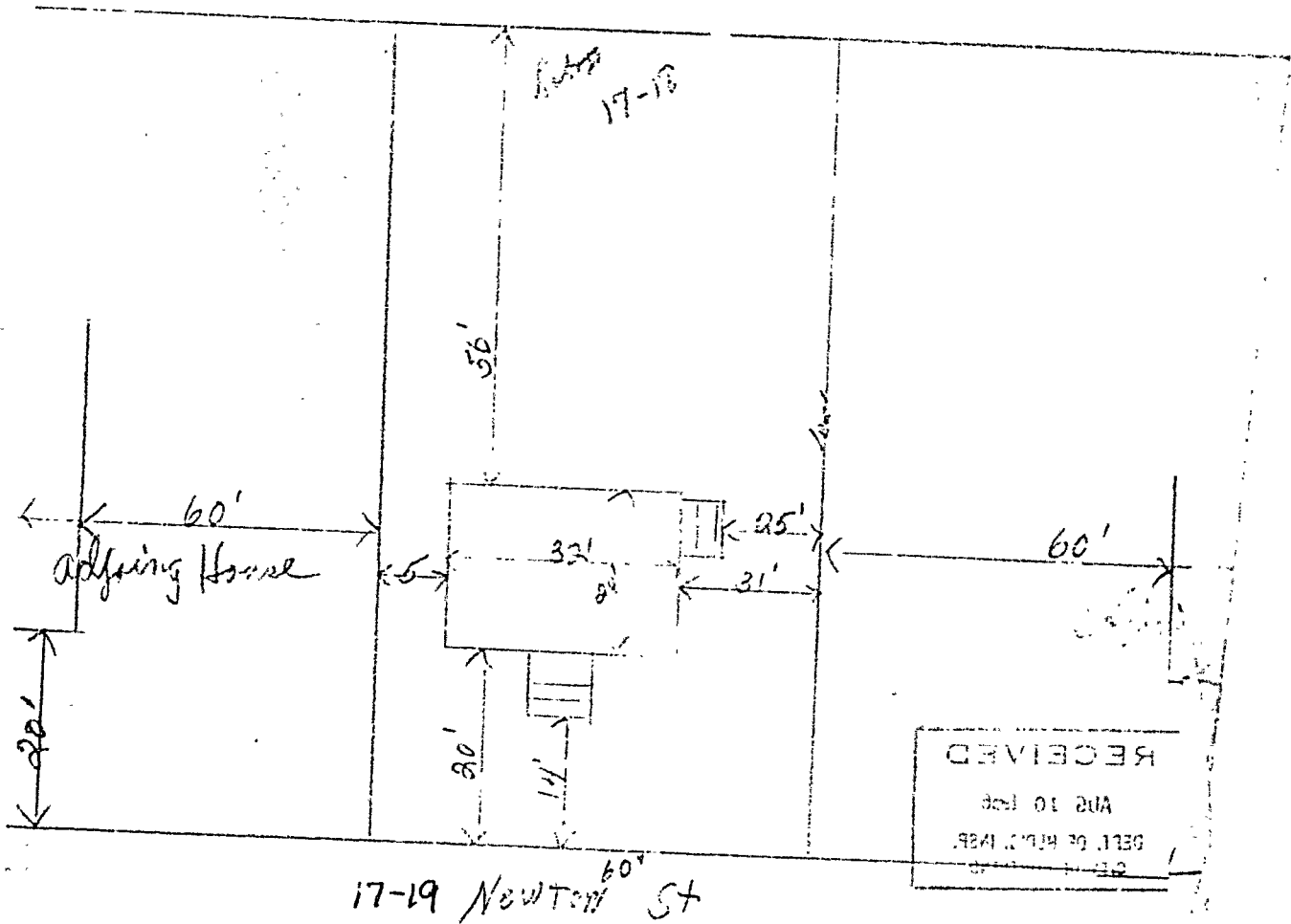

103-103

CITY OF PORTLAND, MAINE
Department of Building Inspection

SEPTIC TANKS
Request for approval of

Date August 15, 1956

Location - 17-18 Nexton Street
Owner - McGann
Contractor - McLaughlin
Type Bldg - Dwelling

To the Health Director:

Application for building permit identified as above has been filed in this office; indicating that a septic tank installation is proposed, as a means of sewage disposal. Applicant represents that connection to a public sewer is not feasible. Copy to owner and contractor is attached.

Your approval as to the method of sewage disposal is requested before a building permit is issued, therefore will you complete and return the appended report as expeditiously as possible.

Inspector of Buildings

Attachment:
Copy of this notice
Copy of letter to owner

Proposed sewage disposal method is ~~is not~~ approved.

Remarks: Percolation test made April 15, 1956 satisfactory.
75 Foot bed required.

Edwardes

Health Director

15 - 15 Aug 56
[Signature]

(RA) RESIDENCE ZONE - A

APPLICATION FOR PERMIT

Class of Building or Type of Structure Third Class

Portland, Maine, Aug. 10, 1956

PERMIT ISSUED

01305
AUG 16 1956



To the INSPECTOR OF BUILDINGS, PORTLAND, MAINE

The undersigned hereby applies for a permit to erect alter repair demolish install the following building structure equipment in accordance with the Laws of the State of Maine, the Building Code and Zoning Ordinance of the City of Portland, plans and specifications, if any, submitted herewith and the following specifications:

Location 17-19 Newton St. Lots 17-18 Within Fire Limits? no Dist. No.
Owner's name and address Donald E. McGann, 1 Lennox St. Telephone
Lessee's name and address Telephone
Contractor's name and address Harvey McLaughlin, 125 Brighton Ave. Telephone 4-8952
Architect Specifications Plans yes No. of sheets 2
Proposed use of building dwelling house No. families 1
Last use No. families
Material No. stories Heat Style of roof Roofing
Other buildings on same lot
Estimated cost \$ 8,000. Fee \$ 8.00

General Description of New Work

To construct 1 1/2-story frame dwelling house 32' x 24'.

Lopez

Permit Issued with Letter

Kind and thickness of outside sheathing of exterior walls? 1" boards

It is understood that this permit does not include installation of heating apparatus which is to be taken out separately by and in the name of the heating contractor. PERMIT TO BE ISSUED TO Harvey McLaughlin

Details of New Work

Is any plumbing involved in this work? yes Is any electrical work involved in this work? yes
Is connection to be made to public sewer? no If not, what is proposed for sewage? septic tank
Has septic tank notice been sent? Form notice sent?
Height average grade to top of plate 10' Height average grade to highest point of roof 20'
Size, front 32' depth 24' No. stories 1 solid or filled land? solid earth or rock? earth
Material of foundation concrete at least 4" below grade but not more than 6" Thickness, top 8" bottom 10" cellar yes
Material of underpinning " to sill Height Thickness
Kind of roof pitch-gable Rise per foot 10" Roof covering Asphalt Class C Und Lab
No. of chimneys 1 Material of chimneys brick of lining tile Kind of heat f h water fuel oil
Framing lumber—Kind hemlock Dressed or full size? dressed
Corner posts 4x6 Sills 4x6 Girt or ledger board? Size
Girders yes Size 6x8 Full size Columns under girders Lally Size 3 1/2" Max. on centers 8'
Studs (outside walls and carrying partitions) 2x4-16" O. C. Bridging in every floor and flat roof span over 8 feet.
Joists and rafters: 1st floor 2x8, 2nd 2x8, 3rd, roof 2x6
On centers: 1st floor 16", 2nd 16", 3rd, roof 16"
Maximum span: 1st floor 12', 2nd 12', 3rd, roof
If one story building with masonry walls, thickness of walls? height?

If a Garage

No. cars now accommodated on same lot, to be accommodated number commercial cars to be accommodated
Will automobile repairing be done other than minor repairs to cars habitually stored in the proposed building?

APPROVED:

with letter by [Signature]

Miscellaneous

Will work require disturbing of any tree on a public street? no
Will there be in charge of the above work a person competent to see that the State and City requirements pertaining thereto are observed? yes

Donald H. McGann

Signature of owner by:

*Brighton Ave Builders Inc
H. S. M. [Signature]*

INSPECTION COPY

