

DISPLAY THIS CARD ON PRINCIPAL FRONTAGE OF WORK

CITY OF PORTLAND

Please Read Application And Notes, If Any, Attached

BUILDING DEPARTMENT

PERMIT ISSUED

Permit Number: 050088

JAN 28 2005

CITY OF PORTLAND

PERMIT

This is to certify that Custom Built Homes Of Maine Inc /Irving Oil
 has permission to Install 120 gallon Propane Tank
 AT 10 Ninth St City 338 D005001

provided that the person or persons, firm or corporation accepting this permit shall comply with all of the provisions of the Statutes of Maine and of the ordinances of the City of Portland regulating the construction, maintenance and use of buildings and structures, and of the application on file in this department.

Apply to Public Works for street line and grade if nature of work requires such information.

Notification of inspection must be given and written permission procured before this building or part thereof is loaded or closed-in.
 24 HOUR NOTICE IS REQUIRED.

A certificate of occupancy must be procured by owner before this building or part thereof is occupied.

~~OTHER REQUIRED APPROVALS~~

Fire Dept. _____
 Health Dept. _____
 Appeal Board _____
 Other _____

Marie Bourke 1/26/05
 Director - Building & Inspection Services

PENALTY FOR REMOVING THIS CARD

Jeanie Bourke

All Purpose Building Permit Application

If you or the property owner owes real estate or personal property taxes or user charges on any property within the City, **payment arrangements must be made before permits of any kind are accepted.**

Location/Address of Construction: <u>10 Ninth St Portland</u>		
Total Square Footage of Proposed Structure	Square Footage of Lot	
Tax Assessor's Chart, Block & Lot Chart# <u>338</u> Block# <u>D</u> Lot# <u>5</u>	Owner: <u>Elise Kiely</u>	Telephone: <u>838 1050</u>
Lessee/Buyer's Name (If Applicable) <u>Elise Kiely</u>	Applicant name, address & telephone: <u>Ed Gale - 350 Main St S.P. 772-8304</u>	Cost Of Work: \$ <u>900⁰⁰/100</u> Fee: \$ <u>30⁰⁰/100</u>
Current use: <u>Stone Fireplace</u>		
If the location is currently vacant, what was prior use: <u>New House</u>		
Approximately how long has it been vacant: _____		
Proposed use: <u>Install 120 gallon Propane tank.</u>		
Project description: _____		
Contractor's name, address & telephone: <u>Custom Bldg Home S</u>		
Who should we contact when the permit is ready: <u>Ed Gale</u>		
Mailing address: <u>350 Main St S.</u>		
We will contact you by phone when the permit is ready. You must come in and pick up the permit and review the requirements before starting any work, with a Plan Reviewer, A stop work order will be Issued and a \$100.00 fee if any work starts before the permit is picked up. PHONE: <u>772 8304</u>		

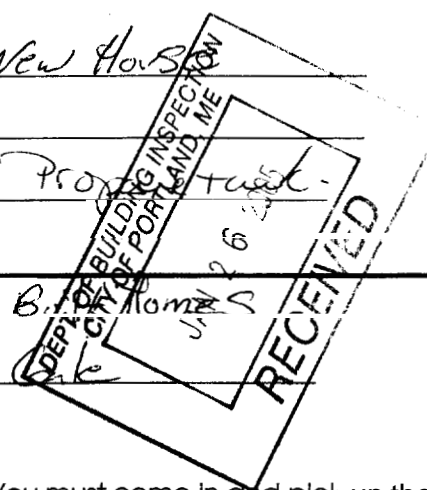

IF THE REQUIRED INFORMATION IS NOT INCLUDED IN THE SUBMISSIONS THE PERMIT WILL BE AUTOMATICALLY DENIED AT THE DISCRETION OF THE BUILDING/PLANNING DEPARTMENT WE MAY REQUIRE ADDITIONAL INFORMATION IN ORDER TO APPROVE THIS PERMIT.

I hereby certify that I am the Owner of record of the named property, or that the owner of record authorizes the proposed work and that I have been authorized by the owner to make this application as his/her authorized agent. I agree to conform to all applicable laws of this jurisdiction. In addition, if a permit for work described in this application is issued, I certify that the Code Official's authorized representative shall have the authority to enter all areas covered by this permit at any reasonable hour to enforce the provisions of the codes applicable to this permit.

Signature of applicant: <u>Peter Ryan</u>	Date: <u>1-26-</u>
---	--------------------

This is NOT a permit, you may not commence ANY work until the permit is issued. If you are in a Historic District you may be subject to additional permitting and fees with the Planning Department on the 4th floor of City Hall

APANE INSTALLATION SHEET

SCHEDULE DATE AND TIME: 1-17-04

COUNT#	Svc#	Tnk#
CUSTOMER NAME: ELISE KIELY		
SITE CONTACT:		
TELEPHONE #'S: CELL 838-1050		

INSTALLATION LOCATION & DIRECTIONS:
LOCK BOX COMBINATION # SPI
10 NINTH ST. PORTLAND, ME.
(OFF RYE 302 NEAR LIBBY ST.)

Site diagram: tank and regulator location, pipe sizing and distances, new and/or existing piping, and appliance locations.

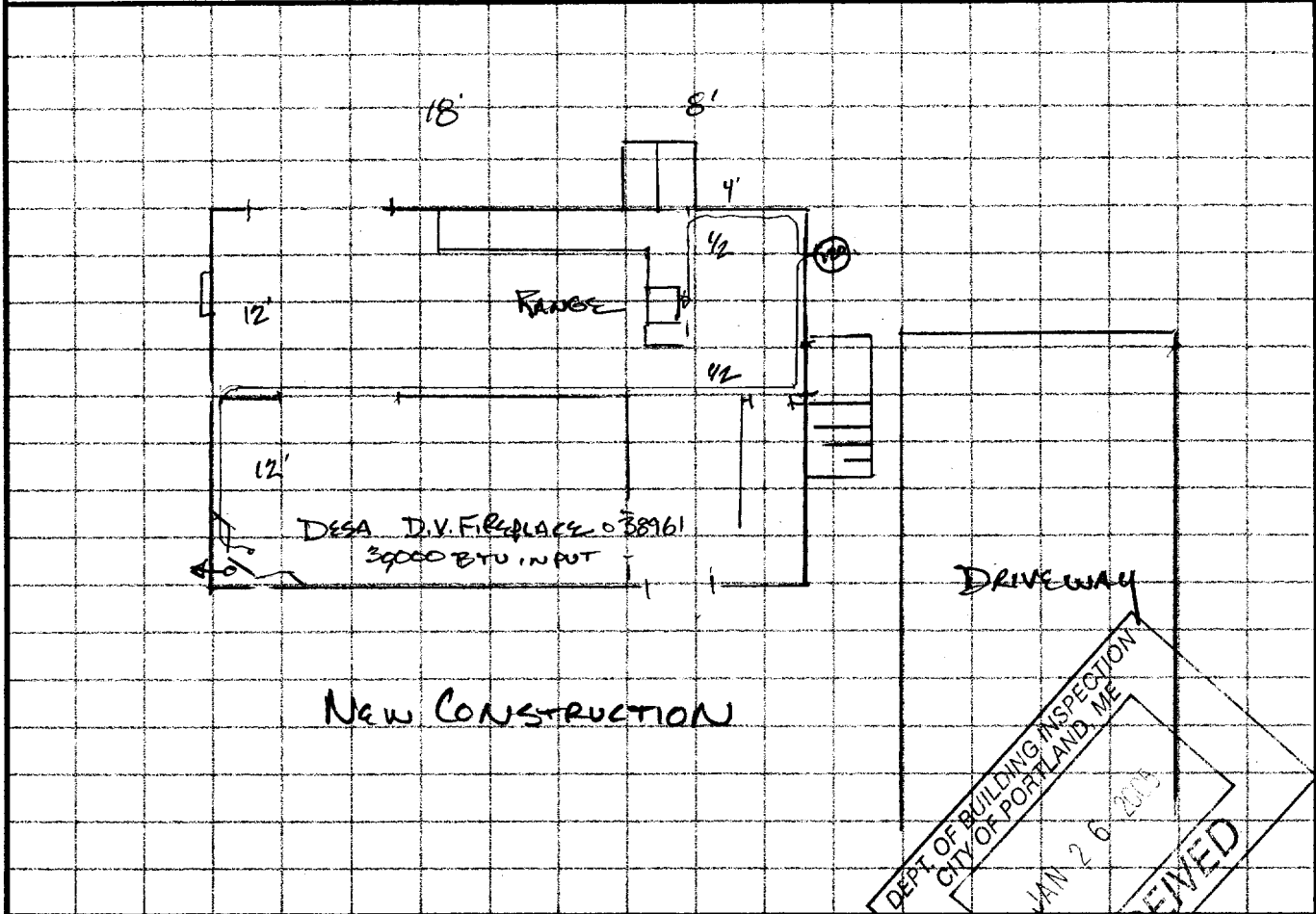

DRIVEWAY

DEPT. OF BUILDING INSPECTION
CITY OF PORTLAND, ME.

JAN 26 2004

RECEIVED

TANK SIZE:	120
TANK SET:	ONE OR TWO MEN
APP#1 MODEL:	RANGE
APP#1 BTU:	65,000
APP#2 MODEL:	DESA FIREPLACE
APP#2 BTU:	30,000
APP#3 MODEL:	
APP#3 BTU:	
APP#4 MODEL:	
APP#4 BTU:	

ESTIMATED YEARLY USAGE:	450
PRIMARY HEAT:	YES <input checked="" type="radio"/> NO <input type="radio"/> CH or SH
HOT WATER GALLONS:	
SPECIAL USAGE INFORMATION:	

TOOLS NEEDED:
Booms Track: Y or N
Brindle: Y or N
Step Ladder: Y or N
Ext. Ladder: Y or N
Hole Saw: Y or N
Hammer Drill: Y or N
Thread Gear: Y or N
Size: _____

TOTAL LABOR:	1 men 4 hours = Total Hours
PIPE LENGTH AND SIZE(S):	65' - 1/2" COASTAL COPPER
Regulator System:	TWIN OR 2STAGE
Parts Ordered, where and PO #'s:	

SALESPERSON:

City of Portland, Maine - Building or Use Permit

389 Congress Street, 04101 Tel: (207) 874-8703, Fax: (207) 874-8716

Permit No: 05-0088	Date Applied For: 01/26/2005	CBL: 338 D005001
------------------------------	--	----------------------------

Location of Construction: 10 Ninth St	Owner Name: Custom Built Homes Of Maine Inc	Owner Address: 35 Main St	Phone:
Business Name:	Contractor Name: Irving Oil	Contractor Address: 385 Main Street South Portland	Phone (207) 772-8304
Lessee/Buyer's Name	Phone:	Permit Type: Tanks - Dwellings	

Proposed Use: Single Family Home / Install 120 gallon Propane Tank	Proposed Project Description: Install 120 gallon Propane Tank
--	---

Dept: Zoning **Status:** Approved **Reviewer:** Jeanine Bourke **Approval Date:** 01/26/2005
Note: **Ok to Issue:**

Dept: Building **Status:** Approved **Reviewer:** Jeanine Bourke **Approval Date:** 01/26/2005
Note: **Ok to Issue:**