

All drawings, plans, sketches, etc. are provided to our clients based upon information provided by the client and drawn in accordance with common building practices and local codes. None of the employees of Diverse Drafting & Design Associates, Inc. are engineers or land surveyors. All dimensions and specifications should be verified by client and/or contractor before actual construction begins. If dimensions and specifications are not verified by client and/or contractor before actual construction begins Diverse Drafting & Design Associates, Inc. will be held harmless. Diverse Drafting & Design Associates, Inc. assumes no liability for changes and/or revisions made to plans by the client and/or contractor.

GENERAL NOTES

TYPICAL EXTERIOR WALLS

- 2X6 @ 24" O.C. STUDS ✓
- 6" BATT INSUL. ✓
- 7/16" OSB SHEATHING ✓
- TYPAR FLD'G WRAP ✓
- 6" CLAPBDS 4" T.W. ✓
- 6 MIL POLY VAPOR BARRIER ✓
- 1/2" SHTRK ✓

TYPICAL INTERIOR WALLS

- 2X4 @ 16" O.C. STUDS ✓
- 1/2" SHTRK EA. SIDE ✓

TYPICAL FLOOR SYSTEM

- 3/4" OSB T&G SUBFLOOR ✓
- 1/4" OSB KIT. & BATTIS ✓
- HARDWOOD OWNER OPTION ✓

TYPICAL SLOPED CEILING

- 5/8" RIGID INSUL ✓
- 1X3 @ 16" O.C. STRAPPING ✓
- 1/2" SHTRK ✓

TYPICAL FLAT CEILING

- 1X3 @ 16" O.C. STRAPPING ✓
- 1/2" SHTRK ✓

TYPICAL WINDOW HEADER

- 3-2X6 W/1/2" PLYWD
- TYP. HEADER HGT 6'-10 1/2"
- DORMER HEADER HGT. 6'-3"

14" INSULAT
ONLY - INS
OF CEILING

NOTE
DOUBLE BOX SILL
OVER LARGE OPN'GS

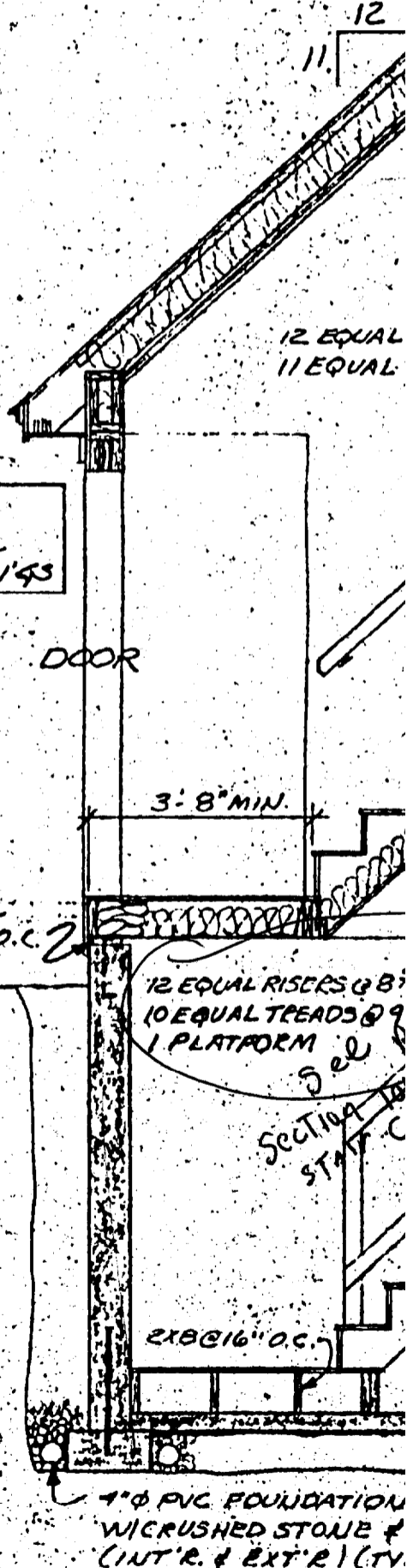

2X6 P.T. SILL W/ SILL
SEAL BOLTED @ 4'-0" O.C.

12 EQUAL RISERS @ 8"
10 EQUAL TREADS @ 9"
1 PLATFORM

2X6 @ 16" O.C.

4" PVC FOUNDATION
W/ CRUSHED STONE
(INT'R. & EXT'R.) (TY)