

NOTES:

1. HALFTONE INDICATES EXISTING

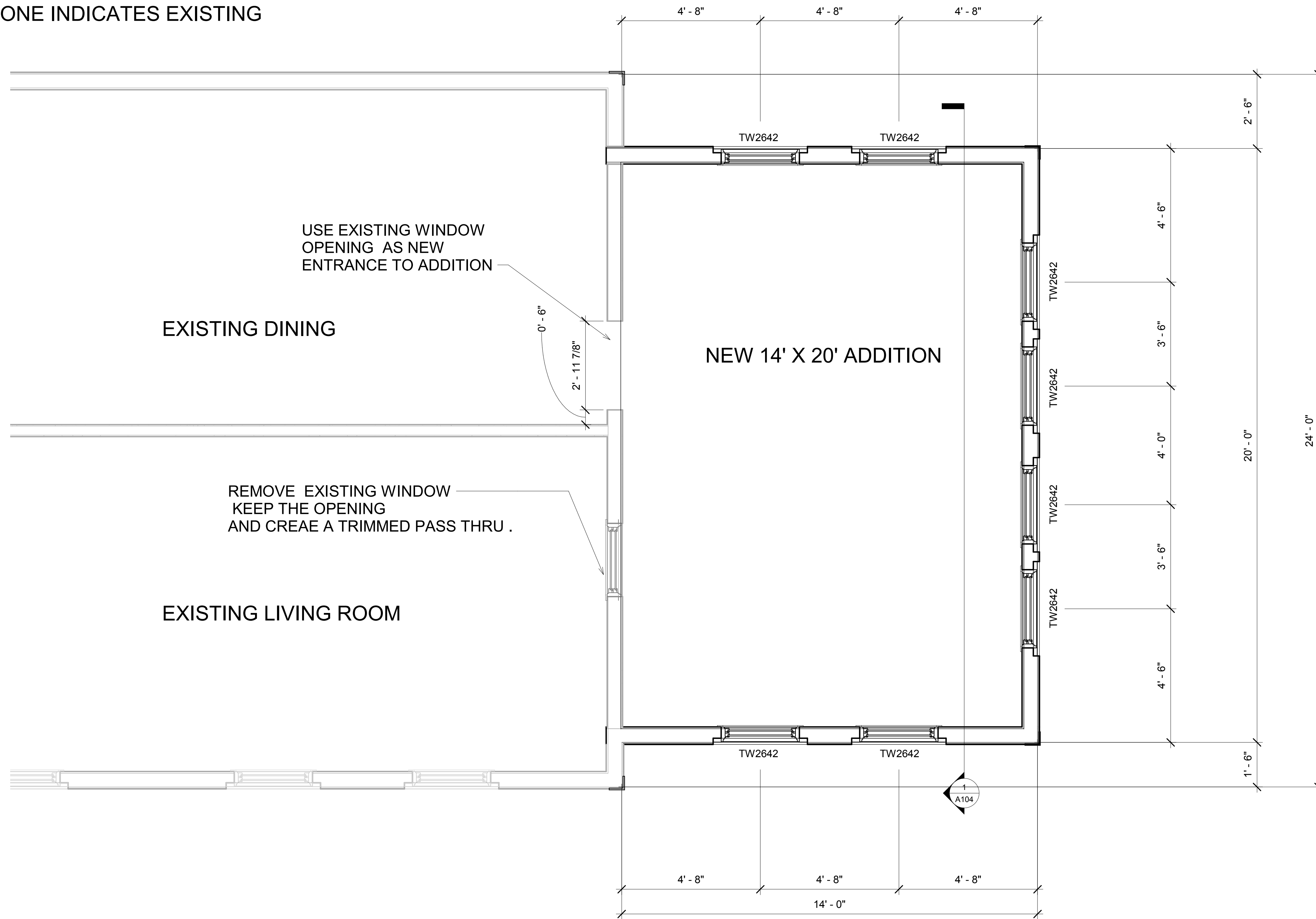

① FIRST FLOOR
1/2" = 1'-0"

Window Schedule							
Manufacturer	Description	Designation	Height	Width	Rough Height	Rough Width	Mark
JELDWEN	CASEMENT EGRESS	ECC3042/4"	3'-0 1/2"				53
Andersen Corporation	Vinyl-clad hung window	TW2642	4' - 4 7/8"	2' - 7 5/8"	4' - 5 3/8"	2' - 8 1/8"	39
Andersen Corporation	Vinyl-clad hung window	TW2642	4' - 4 7/8"	2' - 7 5/8"	4' - 5 3/8"	2' - 8 1/8"	41
Andersen Corporation	Vinyl-clad hung window	TW2642	4' - 4 7/8"	2' - 7 5/8"	4' - 5 3/8"	2' - 8 1/8"	46
Andersen Corporation	Vinyl-clad hung window	TW2642	4' - 4 7/8"	2' - 7 5/8"	4' - 5 3/8"	2' - 8 1/8"	47
Andersen Corporation	Vinyl-clad hung window	TW2642	4' - 4 7/8"	2' - 7 5/8"	4' - 5 3/8"	2' - 8 1/8"	48
Andersen Corporation	Vinyl-clad hung window	TW2642	4' - 4 7/8"	2' - 7 5/8"	4' - 5 3/8"	2' - 8 1/8"	49
Andersen Corporation	Vinyl-clad hung window	TW2642	4' - 4 7/8"	2' - 7 5/8"	4' - 5 3/8"	2' - 8 1/8"	50
Andersen Corporation	Vinyl-clad hung window	TW2642	4' - 4 7/8"	2' - 7 5/8"	4' - 5 3/8"	2' - 8 1/8"	56



TINY HOMES OF MAINE

BASSI/LAWRENCE
14x20 ADDITION
Floor Plan

Project number 001
Date 10/6/16
Drawn by TES

Checked by
A101
Scale 1/2" = 1'-0"