

# City of Portland, Maine – Building or Use Permit Application 389 Congress Street, 04101, Tel: (207) 874-8703, FAX: 874-8716

Location of Construction: ****107 MILTON ST		Owner: **** MARK SILVERMAN		Phone: 797-7301		Permit No: <b>001409</b>	
Owner Address: SAA		Lessee/Buyer's Name:		Phone:		BusinessName:	
Contractor Name: BUTCH GAGNON 878-2028		Address:		Phone:		Permit Issued:  DEC. 18 2000	
Past Use:  SINGLE FAMILY		Proposed Use:  SAME		COST OF WORK: \$ <del>0</del> 3,500.		PERMIT FEE: \$ 30.00 38.00	
				FIRE DEPT. <input type="checkbox"/> Approved <input type="checkbox"/> Denied		INSPECTION: Use Group A-3 Type: 5B BOCA 449	
				Signature:		Signature: <i>H. J. J.</i>	
Proposed Project Description:  AMENDMENT TO PERMIT 000954 <u>ADD DECK</u>				PEDESTRIAN ACTIVITIES DISTRICT (P.A.D.)			
				Action: <input type="checkbox"/> Approved <input type="checkbox"/> Approved with Conditions <input type="checkbox"/> Denied			
				Signature: _____ Date: _____			
Permit Taken By: K		Date Applied For: NOV 30 2000					

1. This permit application does not preclude the Applicant(s) from meeting applicable State and Federal rules.
2. Building permits do not include plumbing, septic or electrical work.
3. Building permits are void if work is not started within six (6) months of the date of issuance. False information may invalidate a building permit and stop all work..

PERMIT ISSUED  
WITH REQUIREMENTS

## CERTIFICATION

I hereby certify that I am the owner of record of the named property, or that the proposed work is authorized by the owner of record and that I have been authorized by the owner to make this application as his authorized agent and I agree to conform to all applicable laws of this jurisdiction. In addition, if a permit for work described in the application is issued, I certify that the code official's authorized representative shall have the authority to enter all areas covered by such permit at any reasonable hour to enforce the provisions of the code(s) applicable to such permit

NOV 30 2000K

SIGNATURE OF APPLICANT ADDRESS: DATE: PHONE:

RESPONSIBLE PERSON IN CHARGE OF WORK, TITLE PHONE:

White-Permit Desk Green-Assessor's Canary-D.P.W. Pink-Public File Ivory Card-Inspector

Zone: **R-3** CBL: 336-H-040

Zoning Approval: *OK with conditions*

Special Zone or Reviews:

- ☐ Shoreland *NO OPEN*
- ☐ Wetland *EXTERIOR STAIRS*
- ☐ Flood Zone *from the deck*
- ☐ Subdivision
- ☐ Site Plan *12/15/00*

Zoning Appeal

- ☐ Variance
- ☐ Miscellaneous
- ☐ Conditional Use
- ☐ Interpretation
- ☐ Approved
- ☐ Denied

Historic Preservation

- ☒ Not in District or Landmark
- ☐ Does Not Require Review
- ☐ Requires Review

Action:

- ☐ Approved
- ☐ Approved with Conditions
- ☐ Denied

Date: \_\_\_\_\_

PERMIT ISSUED  
WITH REQUIREMENTS

VED DISTRICT

1

## COMMENTS

12-21-00 Spoke w/ Butch Gagnon about Egress for in-law Apt. There will be no stairs off the deck per zoning for this use group. The designated egress for the in-law apt. is the interior stairway exiting to the front of the house. There shall be a complete fire separation of the garage and this stairway i.e. a fire door at the garage or  $5/8$ " sheetrock 2 sides and a fire door at the house entrance ~~at~~ in that stairwell. JBG See plans.

## Inspection Record

### Type

Foundation: \_\_\_\_\_

Framing: \_\_\_\_\_

Plumbing: \_\_\_\_\_

Final: \_\_\_\_\_

Other: \_\_\_\_\_

Date

\_\_\_\_\_

\_\_\_\_\_

\_\_\_\_\_

\_\_\_\_\_

\_\_\_\_\_

# BUILDING PERMIT REPORT

DATE: 15 Dec. 2000 ADDRESS: 107 MILTON ST. CBL: 336-H-040

REASON FOR PERMIT: Amend. Perm. 7 #000954 add deck

BUILDING OWNER: Mark Silverman

PERMIT APPLICANT: \_\_\_\_\_ CONTRACTOR Butch Gagnon

USE GROUP: R-3 CONSTRUCTION TYPE: 53 CONSTRUCTION COST: 3500.00 PERMIT FEES: 30.00

The City's Adopted Building Code (The BOCA National Building Code/1999 with City Amendments)  
The City's Adopted Mechanical Code (The BOCA National Mechanical Code/1993)

## CONDITION(S) OF APPROVAL

This permit is being issued with the understanding that the following conditions shall be met: \*1, \*2, \*11, \*13  
\*22 \*29 \*31 \*32 \*33 \*36

- \*1. This permit does not excuse the applicant from meeting applicable State and Federal rules and laws.
- \*2. Before concrete for foundation is placed, approvals from the Development Review Coordinator and Inspection Services must be obtained. (A 24 hour notice is required prior to inspection) **"ALL LOT LINES SHALL BE CLEARLY MARKED BEFORE CALLING."**
3. Foundation drain shall be placed around the perimeter of a foundation that consists of gravel or crushed stone containing not more than 10 percent material that passes through a No. 4 sieve. The drain shall extend a minimum of 12 inches beyond the outside edge of the footing. The thickness shall be such that the bottom of the drain is not higher than the bottom of the base under the floor, and that the top of the drain is not less than 6 inches above the top of the footing. The top of the drain shall be covered with an approved filter membrane material. Where a drain tile or perforated pipe is used, the invert of the pipe or tile shall not be higher than the floor elevation. The top of joints or top of perforations shall be protected with an approved filter membrane material. The pipe or tile shall be placed on not less than 2" of gravel or crushed stone, and shall be covered with not less than 6" of the same material. Section 1813.5.2
4. Foundations anchors shall be a minimum of 1/2" in diameter, 7" into the foundation wall, minimum of 12" from corners of foundation and a maximum 6' O.C. between bolts. Section 2305.17
5. Waterproofing and dampproofing shall be done in accordance with Section 1813.0 of the building code.
6. Precaution must be taken to protect concrete from freezing. Section 1908.0
7. It is strongly recommended that a registered land surveyor check all foundation forms before concrete is placed. This is done to verify that the proper setbacks are maintained.
8. Private garages located beneath habitable rooms in occupancies in Use Group R-1, R-2, R-3 or I-1 shall be separated from adjacent interior spaces by fire partitions and floor/ceiling assembly which are constructed with not less than 1-hour fire resisting rating. Private garages attached side-by-side to rooms in the above occupancies shall be completely separated from the interior spaces and the attic area by means of 1/2 inch gypsum board or the equivalent applied to the garage side. (Chapter 4, Section 407.0 of the BOCA/1999)
9. All chimneys and vents shall be installed and maintained as per Chapter 12 of the City's Mechanical Code. (The BOCA National Mechanical Code/1993). Chapter 12 & NFPA 211
10. Sound transmission control in residential building shall be done in accordance with Chapter 12, Section 1214.0 of the City's Building Code.
- \*11. Guardrails & Handrails: A guardrail system is a system of building components located near the open sides of elevated walking surfaces for the purpose of minimizing the possibility of an accidental fall from the walking surface to the lower level. Minimum height all Use Groups 42". In occupancies in Use Group A, B, H-4, I-1, I-2, M, R, public garages and open parking structures, open guards shall have balusters or be of solid material such that a sphere with a diameter of 4" cannot pass through any opening. Guards shall not have an ornamental pattern that would provide a ladder effect. Handrails shall be a minimum of 34" but not more than 38". Exception: Handrails that form part of a guard shall have a height not less than 36 inches (914 mm) and not more than 42 inches (1067 mm). Handrail grip size shall have a circular cross section with an outside diameter of at least 1 1/4" and not greater than 2". (Sections 1021 & 1022.0). Handrails shall be on both sides of stairway. (Section 1014.7)
12. Headroom in habitable space is a minimum of 7'6". (Section 1204.0)
- \*13. Stair construction in Use Group R-3 & R-4 is a minimum of 10" tread and 7 1/2" maximum rise. All other Use Group minimum 11" tread, 7" maximum rise. (Section 1014.0)
14. The minimum headroom in all parts of a stairway shall not be less than 80 inches. (6'8") 1014.4
15. Every sleeping room below the fourth story in buildings of Use Groups R and I-1 shall have at least one operable window or exterior door approved for emergency egress or rescue. The units must be operable from the inside without the use of special knowledge or separate tools. Where windows are provided as means of egress or rescue they shall have a sill height not more than 44 inches (1118mm) above the floor. All egress or rescue windows from sleeping rooms shall have a minimum net clear opening height dimension of 24 inches (610mm). The minimum net clear opening width dimension shall be 20 inches (508mm), and a minimum net clear opening of 5.7 sq. ft. (Section 1010.4)
16. Each apartment shall have access to two (2) separate, remote and approved means of egress. A single exit is acceptable when it exits directly from the apartment to the building exterior with no communications to other apartment units. (Section 1010.1)
17. All vertical openings shall be enclosed with construction having a fire rating of at least one (1) hour, including fire doors with self closure's. (Over 3 stories in height requirements for fire rating is two (2) hours. (Section 710.0)
18. The boiler shall be protected by enclosing with (1) hour fire rated construction including fire doors and ceiling, or by providing automatic extinguishment. (Table 302.1.1)



19. All single and multiple station smoke detectors shall be of an approved type and shall be installed in accordance with the provisions of the City's Building Code Chapter 9, Section 920.3.2 (BOCA National Building Code/1999), and NFPA 101 Chapter 18 & 19. (Smoke detectors shall be installed and maintained at the following locations):

- In the immediate vicinity of bedrooms
- In all bedrooms
- In each story within a dwelling unit, including basements

20. A portable fire extinguisher shall be located as per NFPA #10. They shall bear the label of an approved agency and be of an approved type. (Section 921.0)

21. The Fire Alarm System shall be installed and maintained to NFPA #72 Standard.

22. The Sprinkler System shall be installed and maintained to NFPA #13 Standard.

23. All exit signs, lights and means of egress lighting shall be done in accordance with Chapter 10 Section & Subsections 1023.0 & 1024.0 of the City's Building Code. (The BOCA National Building Code/1999)

24. Section 25 - 135 of the Municipal Code for the City of Portland states, "No person or utility shall be granted a permit to excavate or open any street or sidewalk from the time of November 15 of each year to April 15 of the following year".

25. The builder of a facility to which Section 4594-C of the Maine State Human Rights Act Title 5 MRSA refers, shall obtain a certification from a design professional that the plans commencing construction of the facility, the builder shall submit the certification the Division of Inspection Services.

26. Ventilation and access shall meet the requirements of Chapter 12 Sections 1210.0 and 1211.0 of the City's Building Code. (Crawl spaces & attics).

X 27. All electrical, plumbing and HVAC permits must be obtained by Master Licensed holders of their trade. No closing in of walls until all electrical (min. 72 hours notice) and plumbing inspections have been done.

28. All requirements must be met before a final Certificate of Occupancy is issued.

X 29. All building elements shall meet the fastening schedule as per Table 2305.2 of the City's Building Code (The BOCA National Building Code/1999).

30. Ventilation of spaces within a building shall be done in accordance with the City's Mechanical code (The BOCA National Mechanical Code/1993). (Chapter M-16)

31. Please read and implement the attached Land Use Zoning report requirements. *There shall be NO exterior open stairways from this deck to the ground. Any stair*

X 32. Boring, cutting and notching shall be done in accordance with Sections 2305.3, 2305.3.1, 2305.4.4 and 2305.5.1 of the City's Building Code. *shall be interior and enclosed*

X 33. Bridging shall comply with Section 2305.16.

34. Glass and glazing shall meet the requirements of Chapter 24 of the building code. (Safety Glazing Section 2406.0)

35. All signage, shall be done in accordance with Section 3102.0 signs of the City's Building Code, (The BOCA National Building Code/1999).

X 36. All flashing shall comply with Section 1406.3.10.

P. Samuel Hoffes, Building Inspector

Cc: Lt. McDougall, PFD

Marge Schmuckal, Zoning Administrator

PSH 10/1/00

\*\*This permit is herewith issued, on the basis of plans submitted and conditions placed on these plans, any deviations shall require a separate approval.

\*\*\*THIS PERMIT HAS BEEN ISSUED WITH THE UNDERSTANDING THAT ALL THE CONDITIONS OF THE APPROVAL SHALL BE COMPLETED. THEREFORE, BEFORE THE WORK IS COMPLETED A REVISED PLAN OR STATEMENT FROM THE PERMIT HOLDER SHALL BE SUBMITTED TO THIS OFFICE SHOWING OR EXPLAINING THAT THE CONDITIONS HAVE BEEN MET. IF THIS REQUIREMENT IS NOT RECEIVED YOUR CERTIFICATE OF OCCUPANCY SHALL BE WITHHELD.

\*\*\*\*ALL PLANS THAT REQUIRE A PROFESSIONAL DESIGNER'S SEAL, (AS PER SECTION 114.0 OF THE BUILDING CODE) SHALL ALSO BE PRESENTED TO THIS DIVISION ON AUTO CAD LT. 2000, DXF FORMAT OR EQUIVALENT.

\*\*\*\*\*CERTIFICATE OF OCCUPANCY FEE \$50.00

7-2  
Time

FRONT: N/A

REAR: 25' reg -  
37' Show

SIDES: 14' reg -  
14' + show  
OK

Lot coverage:  
 $10,000 \times 206 = 2,000$

$24 \times 40 = 960$   
 $22 \times 28 = 616$   
 $12 \times 20 = 240$   
1816

OVER FOR DECK PLAN

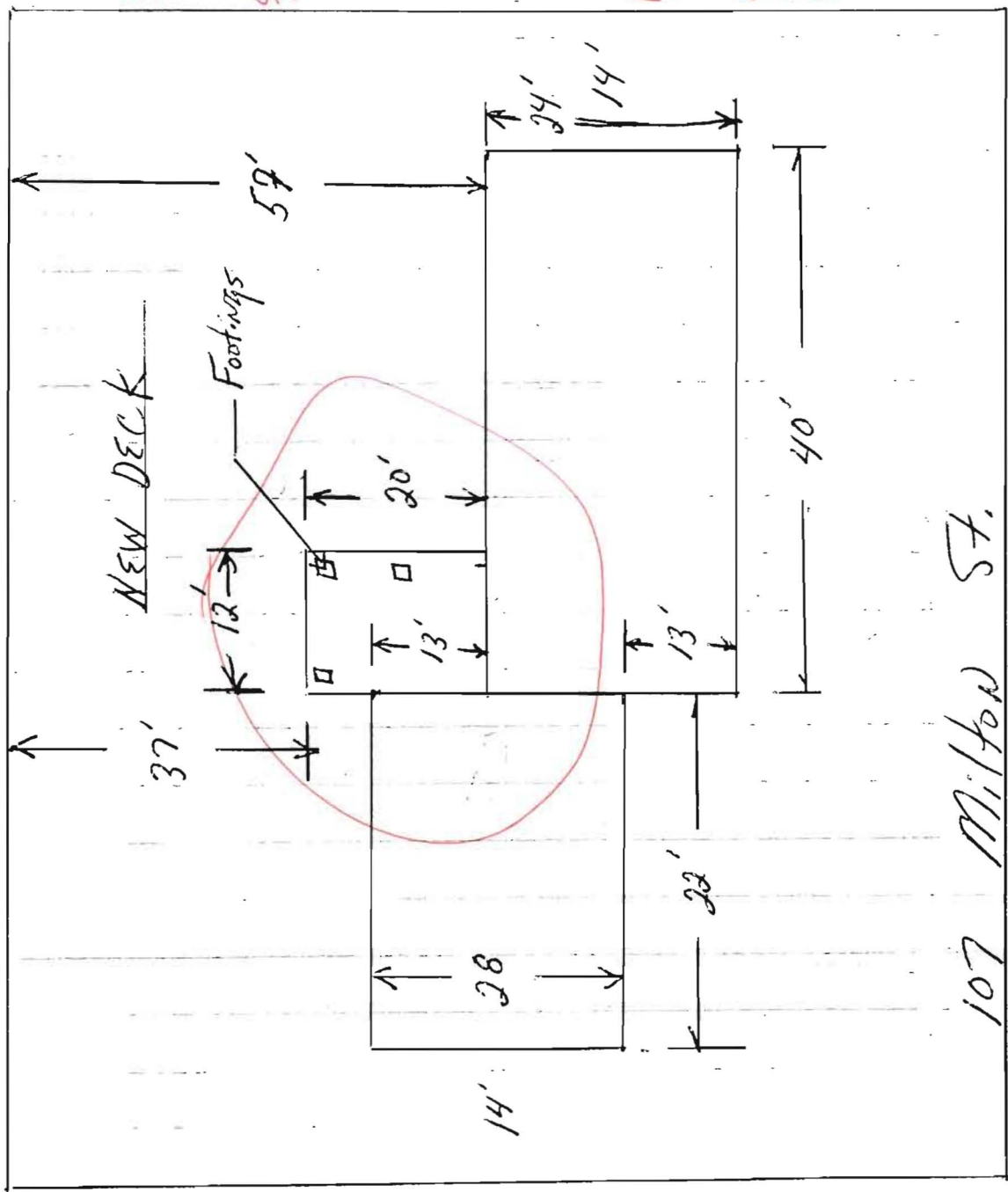

107 Milton St.

90'

Mark Silberman

on Footing?

A RAILING SYSTEM 42" HIGH - LESS THAN 4" SPACES

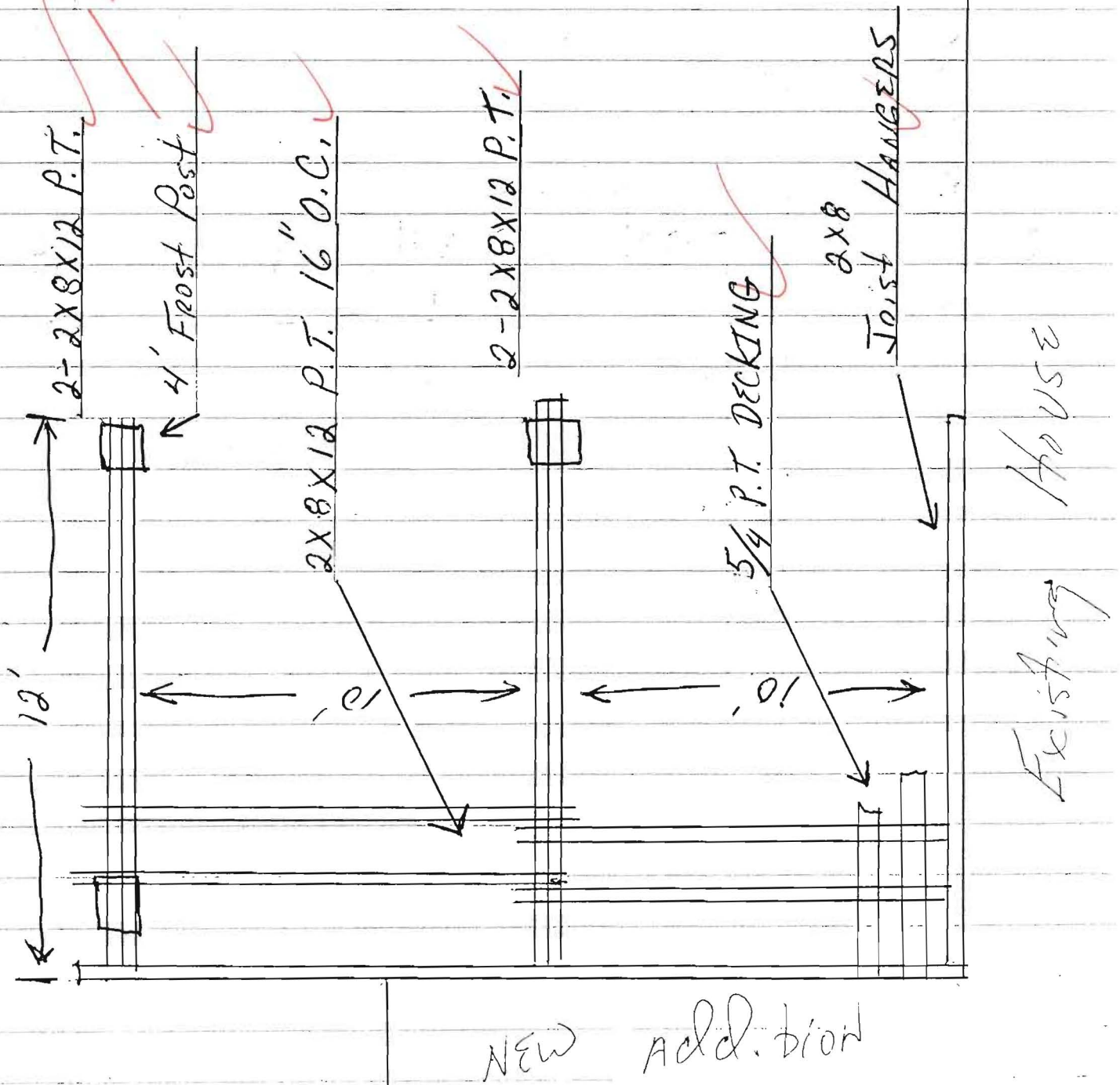



DATE	TIME	CONTACT	NARRATIVE	INITIALS
------	------	---------	-----------	----------

1 Dec	6:15		No Plans for deck-return To Front deck.	\$
12/16		(Butch)	Talked to Mark - He is calling Cont - to get floor Plan, & Deck Plans to me ASAP	P
12/15	11:30	Winford Gagnon	brought in deck plan + fee for deck.	GG

**BRUCE W. MACLEOD, P.E.**

---

November 13, 2000

Fred Panico  
Planning/Design Associates  
Partridge Road  
Windham, Maine

Re: New residence for  
The Silverman Family  
107 Milton Street  
Portland, Me.

Dear Fred:

I have reviewed the design for the floor framing above the garage for the above referenced project. The LVL beams include:

1. (3) 1 1/2x16 x 16ft at the garage door.
2. (2) 1 1/2x18 x 18.5ft .

The floor joists are 2x10s @ 16"o.c.

These members are adequate based on BOCA design criteria of 40psf live load plus applicable dead loads and 42psf roof snow load.

Very truly yours,

Bruce MacLeod, P.E.

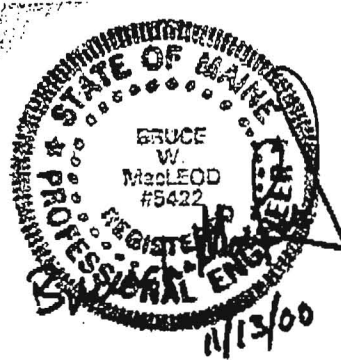

#000954



**THIS IS NOT A PERMIT/CONSTRUCTION CANNOT COMMENCE UNTIL THE  
PERMIT IS ISSUED**

**Minor/Minor Site Review for New Detached Single Family Dwelling,  
Additions/Alterations/Accessory Structures, Multi-Family, Commercial Interior Rehab  
(other than additions), Change of Use**

In the interest of processing your application in the quickest possible manner, please complete the Information below for a Building or Use Permit.

**NOTE\*\*If you or the property owner owes real estate or personal property taxes or user charges on any property within the City, payment arrangements must be made before permits of any kind are accepted.**

Location/Address of Construction: <u>2107 Milton St. Portland, ME 04103</u>		
Total Square Footage of Proposed Structure		Square Footage of Lot
Tax Assessor's Chart, Block & Lot Number  Chart# <u>336</u> Block# <u>4</u> Lot# <u>040</u>	Owner: <u>Mark Silverman</u> <u>MS</u>	Telephone#: <u>797-7301</u>
Lessee/Buyer's Name (If Applicable)	Owner's/Purchaser/Lessee Address:	Cost Of Work: Fee: \$ <u>30.00</u>
Current use: _____ Proposed use: _____ <u>Amendment to permit # 000954 - Adding Deck &amp; Setbacks</u> Project description:		
Contractor's Name, Address & Telephone <u>Butch Gagnon</u> <u>878-2028</u>		Rec'd By: <u>[Signature]</u>

Separate permits are required for Internal & External Plumbing, HVAC and Electrical installation.

- All construction must be conducted in compliance with the 1999 B.O.C.A. Building Code as amended by Section 6-Art II.
- All plumbing must be conducted in compliance with the State of Maine Plumbing Code.
- All Electrical Installation must comply with the 1999 National Electrical Code as amended by Section 6-Art III.
- HVAC(Heating, Ventilation and Air Conditioning) installation must comply with the 1993 BOCA Mechanical Code.

**YOU MUST INCLUDE THE FOLLOWING WITH YOUR APPLICATION:**

- A Copy of Your Deed or Purchase and Sale Agreement if purchased in the last 365 days
- A Plot Plan (Sample Attached)

**A "minor/minor" site plan review is required for New Single Family Homes Only (does not include additions, alterations or accessory structures) prior to permit issuance. The Site plan must be prepared and sealed by a registered land surveyor. FOUR COPIES ARE REQUIRED FOR NEW SINGLE FAMILY HOMES**

**THIS IS NOT A PERMIT/CONSTRUCTION CANNOT COMMENCE UNTIL THE  
PERMIT IS ISSUED**

**A complete plot plan (Site Plan) includes:**

- The shape and dimension of the lot, all existing buildings (if any), the proposed structure and the distance from the actual property lines. Structures include decks porches, a bow windows cantilever sections and roof overhangs, as well as, sheds, pools, garages and any other accessory structures.
- Scale and North arrow; Zoning District & Setbacks
- First Floor sill elevation ( based on mean sea level datum);
- Location and dimensions of parking areas and driveways;
- Location and size of both existing utilities in the street and the proposed utilities serving the building;
- Location of areas on the site that will be used to dispose of surface water.
- Existing and proposed grade contours

**Building Plans are required for all construction, including interior rehab (Sample Attached)**

A complete set of construction drawings showing all of the following elements of construction:

- Cross Sections w/Framing details (including porches, decks w/ railings, and accessory structures)
- Floor Plans & Elevations
- Window and door schedules
- Foundation plans with required drainage and damp proofing
- Electrical and plumbing layout. Mechanical drawings for any specialized equipment such as furnaces, chimneys, gas equipment, HVAC equipment (air handling) or other types of work that may require special review must be included.

**Certification**

*I hereby certify that I am the Owner of record of the named property, or that the proposed work is authorized by the owner of record and that I have been authorized by the owner to make this application as his/her authorized agent. I agree to conform to all applicable laws of this jurisdiction. In addition, if a permit for work described in this application is issued, I certify that the Code Official's authorized representative shall have the authority to enter all areas covered by this permit at any reasonable hour to enforce the provisions of the codes applicable to this permit.*

<b>Signature of applicant:</b> 	<b>Date:</b> 11-30-00
--	-----------------------

Minor/Minor Site Review Fee: \$300.00/Building Permit Fee: \$30.00 for the 1st \$1000.cost plus \$6.00 per \$1,000.00 construction cost thereafter.

**AUTOCAD OR ADOBE FORMAT REQUIRED FOR ALL COMMERICAL PROJECTS**



## CITY OF PORTLAND, MAINE

### Department of Building Inspection

Received from Mark Silverman a fee

of thirty /100 Dollars \$ 30

for permit to install  
erect  
alter Amend 000954 Add Deck

at 107 Milton St Est. Cost \$ —

(Signature)  
Inspector of buildings

Per —

## THIS IS NOT A PERMIT

No work is to be started until PERMIT CARD is actually posted upon the premises. Acceptance of fee is no guarantee that permit will be granted. PRESERVE THIS RECEIPT. In case permit cannot be granted the amount of the fee will be refunded upon return of the receipt less \$5.00 or 10% whichever is greater.

WHITE - Applicant's Copy

YELLOW - Office Copy

PINK - Auditors Copy