

City of Portland, Maine - Building or Use Permit Application 389 Congress Street, 04101, Tel: (207) 874-8703, FAX: 874-8716

Permit No: **950359**

PERMIT ISSUED

APR 20 1995

CITY OF PORTLAND

Zone: **2-335-C-033/34/35/36**

Zoning Approval: **OK** **4/19/95**

Special Zone or Reviews:

Shoreland

Wetland

Flood Zone

Subdivision

Site Plan maj minor mm

Zoning Appeal

Variance

Miscellaneous

Conditional Use

Interpretation

Approved

Denied

Historic Preservation

Not in District or Landmark

Does Not Require Review

Requires Review

Action:

Approved

Approved with Conditions

Denied

Date: _____

CEO DISTRICT

M. J. [Signature]

Location of Construction: **426 Randolph St**

Owner: **Peter & Claudia Risbara** Phone: **797-5782**

Leasee/Buyer's Name: _____ Phone: _____

Address: _____ Phone: _____

Proposed Use: **1-fam**

COST OF WORK: \$ _____

PERMIT FEE: \$ **25.00**

FIRE DEPT. Approved Denied

INSPECTION: **4**, Type: _____

Use Group: **30 CA-93**

Signature: *Hoffman*

PEDESTRIAN ACTIVITIES DISTRICT (P.U.D.)

Action: Approved Approved with Conditions Denied

Signature: _____ Date: _____

Date Applied For: **14 April 1995**

Permit Taken By: **Mary Gresik**

Proposed Project Description:

To erect temporary structure (greenhouse) to be used seasonally.

1. This permit application doesn't preclude the Applicant(s) from meeting applicable State and Federal rules.

2. Building permits do not include plumbing, septic or electrical work.

3. Building permits are void if work is not started within six (6) months of the date of issuance. False information may invalidate a building permit and stop all work..

CERTIFICATION

I hereby certify that I am the owner of record of the named property, or that the proposed work is authorized by the owner of record and that I have been authorized by the owner to make this application as his authorized agent and I agree to conform to all applicable laws of this jurisdiction. In addition, if a permit for work described in the application issued, I certify that the code official's authorized representative shall have the authority to enter all areas covered by such permit at any reasonable hour to enforce the provisions of the code(s) applicable to such permit

Claudia Risbara

SIGNATURE OF APPLICANT **CLAUDIA RISBARA** **ADDRESS:** _____ **PHONE:** _____

DATE: **14 April 1995**

RESPONSIBLE PERSON IN CHARGE OF WORK, TITLE

White-Permit Desk Green-Assessor's Canary-D.P.W. Pink-Public File Ivory Card-Inspector

Applicant: Peter & Claudia Pisbana

Date: 4/19/95

Address: 426 Randolph St

Assessors No.: 335-C-033/34/35/36

CHECK LIST AGAINST ZONING ORDINANCE

Date -

Zone Location - R-2

Interior or corner lot -

Use - temp Greenhouse used seasonally

Sewage Disposal - N/A

Rear Yards - 25' req - 25' shown

Side Yards - 12' req - 12' + shown

Front Yards - 25' req - 25' + shown

Projections -

Height - 1 story

Lot Area -

Building Area -

Area per Family -

Width of Lot -

Lot Frontage -

Off-street Parking -

Loading Bays -

Site Plan - N/A

Shoreland Zoning -

Flood Plains -

Peter + Claudia A. Risbana

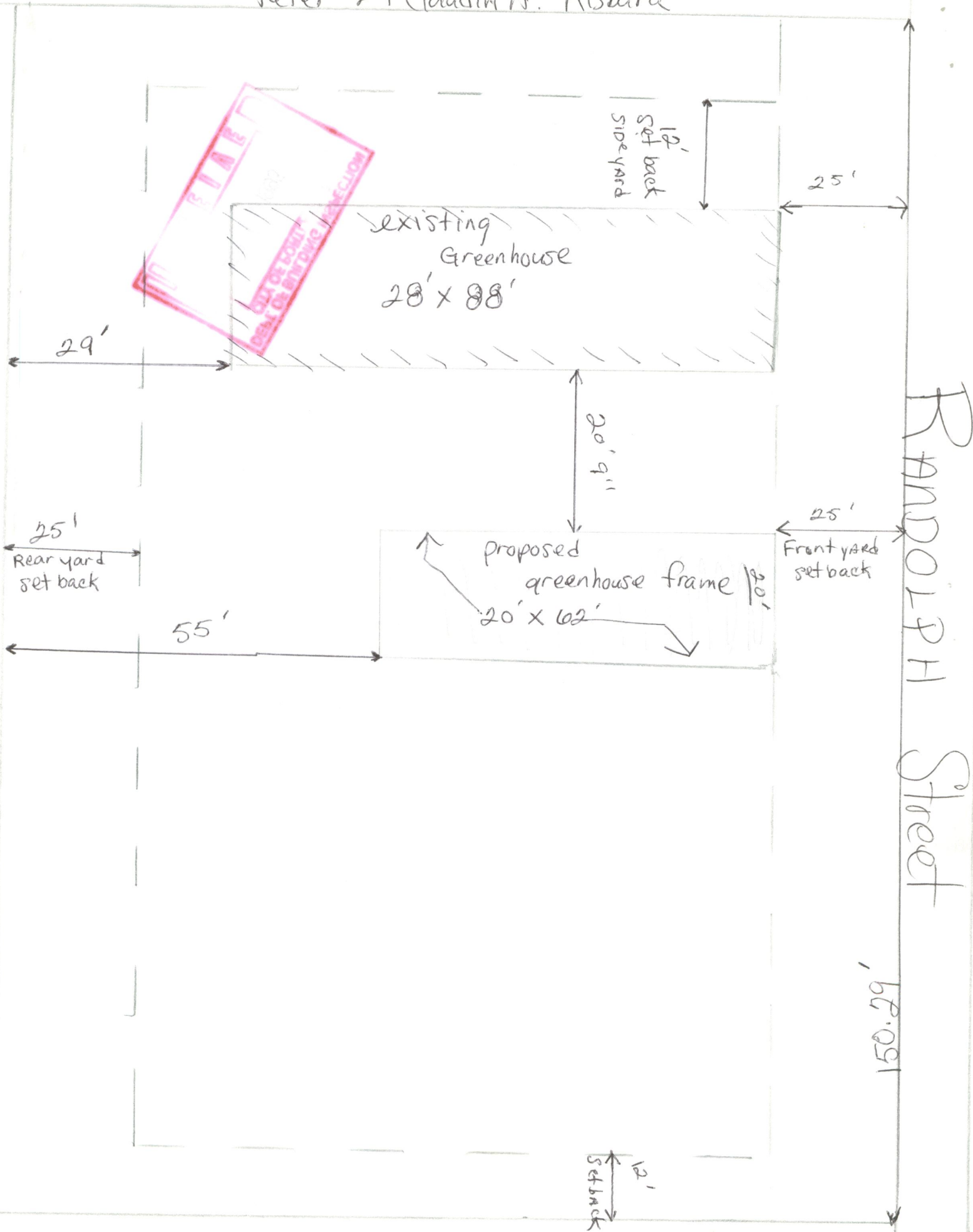

earth floor
no foundation

FRAME
1/4" galvanized steel tubing 4' o.c.
2' ground stakes
2" x 10" skirt board
2" x 4 end walls
6 mil poly covering, (plastic film)



Risbar
426 Randolph St.
04/03