

ZONING: IM ZONE		
DESCRIPTION	REQUIRED / ALLOWED	PROPOSED
MIN LOT SIZE	10,000 SF	1,359,510 SF
MIN FRONTAGE	60 FT	1,580 FT
SETBACKS		
- FRONT	25 FT	460 FT
- SIDE	25 FT	188 FT
- REAR	25 FT	48 FT
MAX IMPERVIOUS SURFACE RATIO	75%	37%
PARKING SPACE SIZE	9' X 18'	NONE PROPOSED

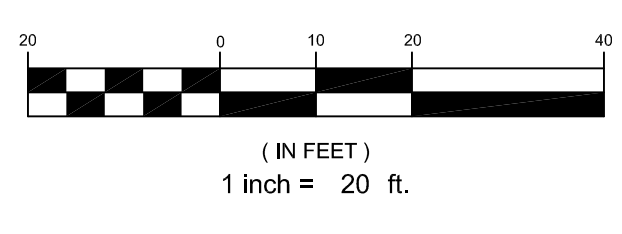
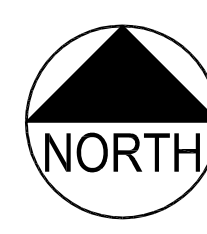

PRELIMINARY - NOT FOR CONSTRUCTION

**SIGN LEGEND**

36" x 12" R6-1R A	18" x 24" B1	18" x 24" B2	30" x 30" R6-1 C

**SURFACE LEGEND**

	HEAVY DUTY CONCRETE PAVEMENT
	GRAVEL SURFACE
	HEAVY DUTY BITUMINOUS PAVEMENT

REV	DATE	DESCRIPTION	REVISIONS
2	08.09.13	REVISED PER CITY REVIEW COMMENTS	
1	07.16.13	LEVEL II SITE PLAN APPLICATION	

P.E. ROBERT J. WOODMAN  
LIC. # 12442

PROJECT	PROPOSED TRUCK LOADING AREA AT 56 MILLIKEN STREET PORTLAND MAINE
SHEET TITLE	SITE LAYOUT AND UTILITY PLAN
CLIENT	JHR DEVELOPMENT OF MAINE, LLC

<b>FAY, SPOFFORD &amp; THORNDIKE, INC.</b> ENGINEERS · PLANNERS · SCIENTISTS 778 MAIN ST, SUITE 8, SOUTH PORTLAND, ME 04106	
DRAWN: CMW	DATE: JULY 2013
DESIGNED: RJW	SCALE: 1" = 20'
CHECKED: RJW	JOB NO. 3215
FILE NAME: 3215-SP	
SHEET	C-2.0

R:\3215-SP-Milliken Street-Loading Exp/Cadd/Permit Set/dwg/3215-SP.dwg winter\_c 8/8/2013 3:08 PM

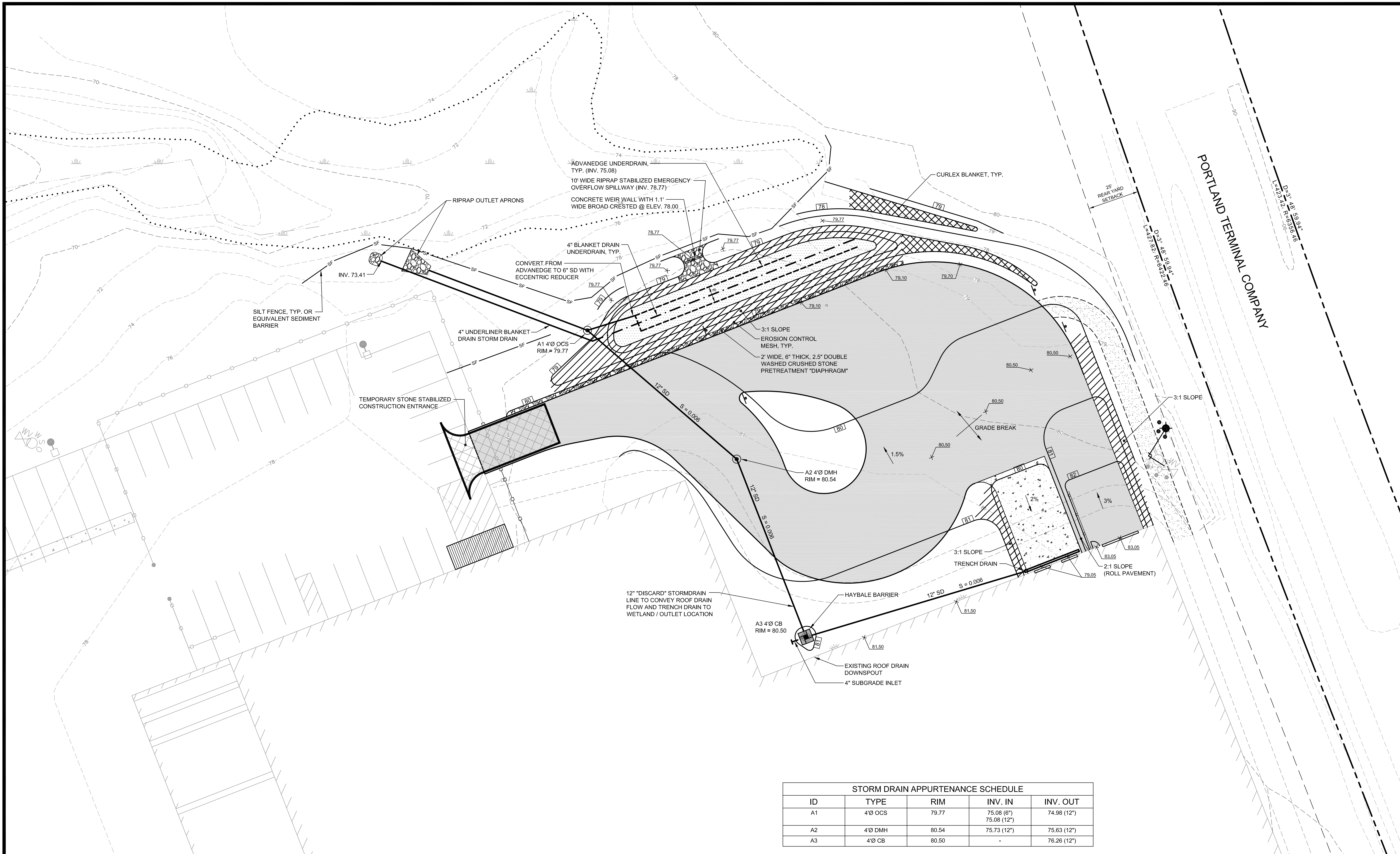

PORTLAND TERMINAL COMPANY

STORM DRAIN APPURTENANCE SCHEDULE				
ID	TYPE	RIM	INV. IN	INV. OUT
A1	4" OCS	79.77	75.08 (6") 75.08 (12")	74.98 (12")
A2	4" DMH	80.54	75.73 (12")	75.63 (12")
A3	4" CB	80.50	-	76.26 (12")

REV	DATE	DESCRIPTION
2	08.09.13	REVISED PER CITY REVIEW COMMENTS
1	07.16.13	LEVEL II SITE PLAN APPLICATION

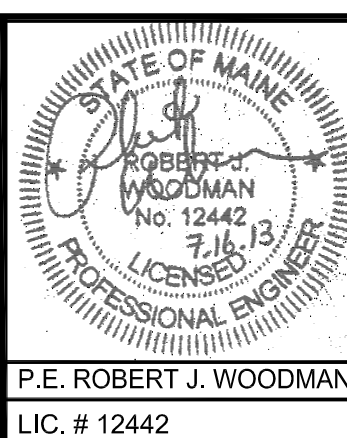

PROJECT  
**PROPOSED TRUCK LOADING AREA AT  
 56 MILLIKEN STREET PORTLAND MAINE**

SHEET TITLE  
**GRADING, DRAINAGE AND  
 EROSION CONTROL PLAN**

CLIENT  
**JHR DEVELOPMENT  
 OF MAINE, LLC**

**FST** **FAY, SPOFFORD & THORNDIKE, INC.**  
 ENGINEERS · PLANNERS · SCIENTISTS  
 778 MAIN ST, SUITE 8, SOUTH PORTLAND, ME 04106

DRAWN: CMW      DATE: JULY 2013  
 DESIGNED: RJW      SCALE: 1" = 20'  
 CHECKED: RJW      JOB NO. 3215  
 FILE NAME: 3215-SP  
 SHEET **C-3.0**

TOPOGRAPHIC SURVEY BASED ON "SITE PLAN" BY SEBAGO TECHNICS DATED 04.24.95.  
 SUPPLEMENTAL TOPOGRAPHIC SURVEY BY FAY, SPOFFORD & THORNDIKE, INC. PERFORMED ON JULY 2013.

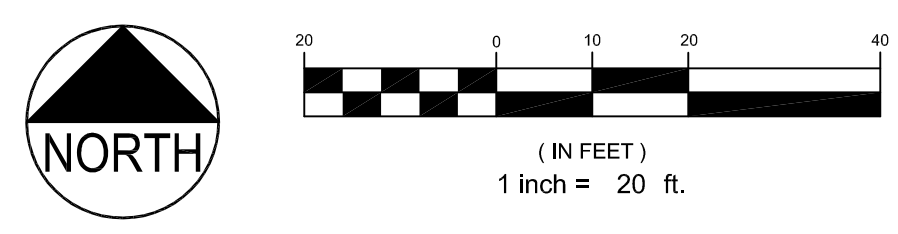

**PRELIMINARY - NOT FOR CONSTRUCTION**

POST DIAMETER SCHEDULE	
GATE SIZE	PIPE DIAMETER
6' AND LESS	3" O.D., 5.79 LBS/FT
6' TO 10'	4" O.D., 9.10 LBS/FT

CHAIN LINK FENCE INSTALLATION SCHEDULE			
FENCE HEIGHT (A)	TOP RAIL PIPE DIA. (B)	LINE POST PIPE DIA. (C)	CORNER, TERMINAL & GATE POST PIPE DIA. (D)
4'	1.66"	1.90"	2.375"
6'	1.66"	1.90"	2.375"
8'	1.66"	2.375"	2.875"
10'	1.66"	2.875"	2.875"

- NOTES:
- DIMENSIONS FOR PIPE DIAMETERS ARE NOMINAL OUTSIDE DIAMETERS.
  - REFER TO PLANS FOR LOCATION & HEIGHT OF FENCES TO BE INSTALLED.
  - REFER TO PLANS FOR GATE WIDTH AT EACH INSTALLATION.
  - ALL FENCE FABRIC, POSTS AND HARDWARE SHALL BE BLACK VINYL COATED.

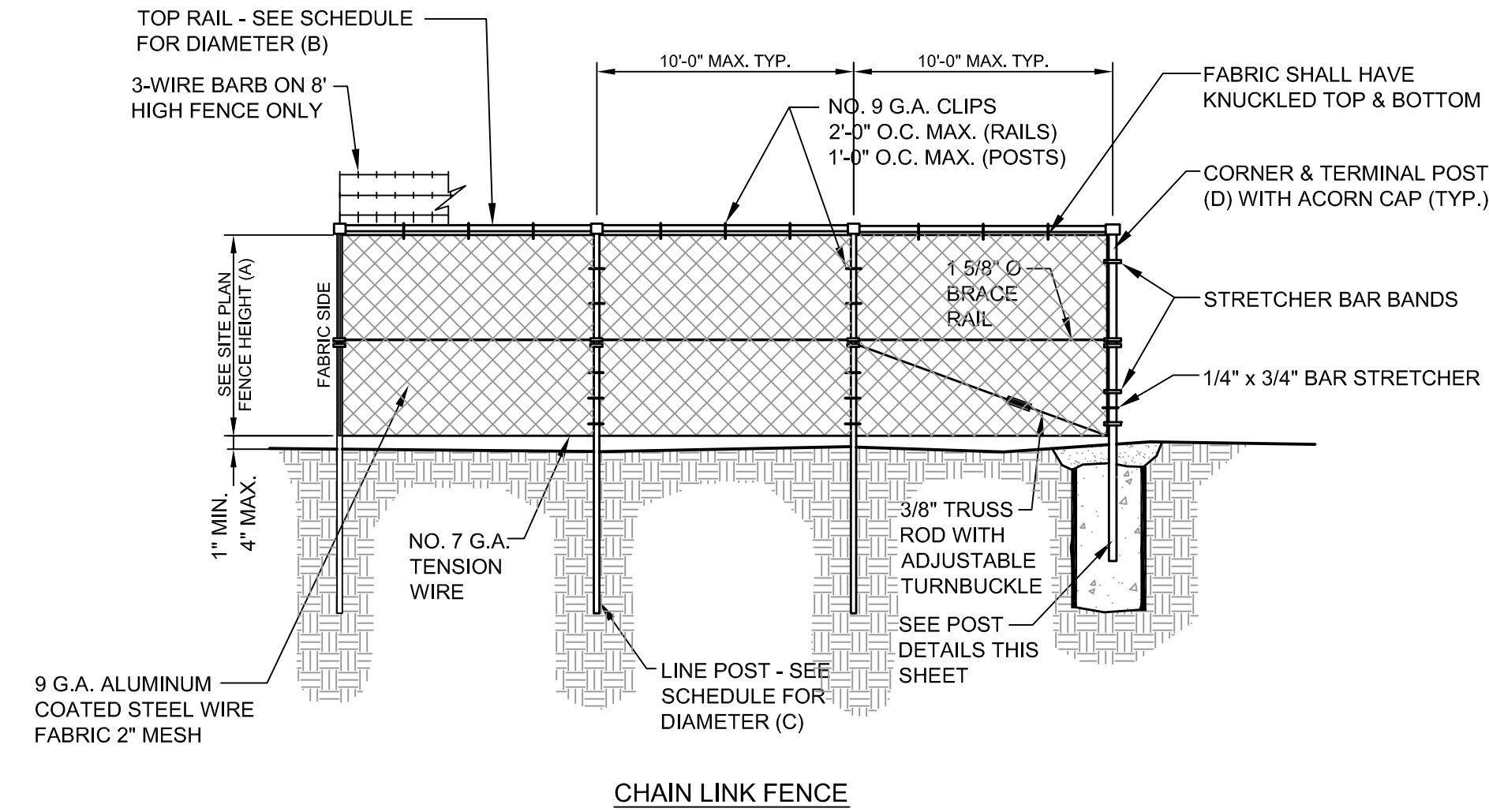

**(A) CHAIN LINK FENCE**  
N.T.S.

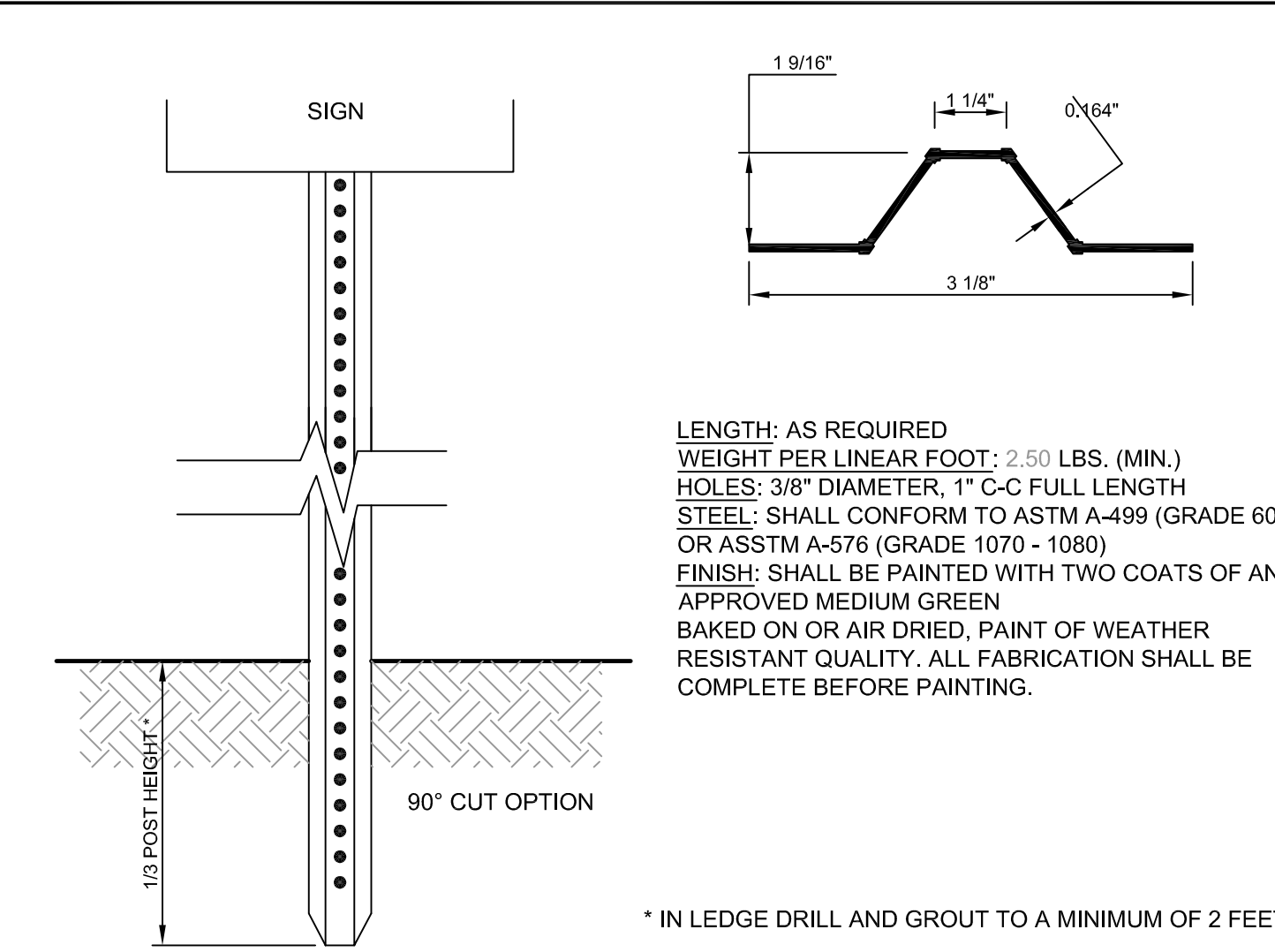

**(F) U-CHANNEL METAL SIGN POST**  
N.T.S.

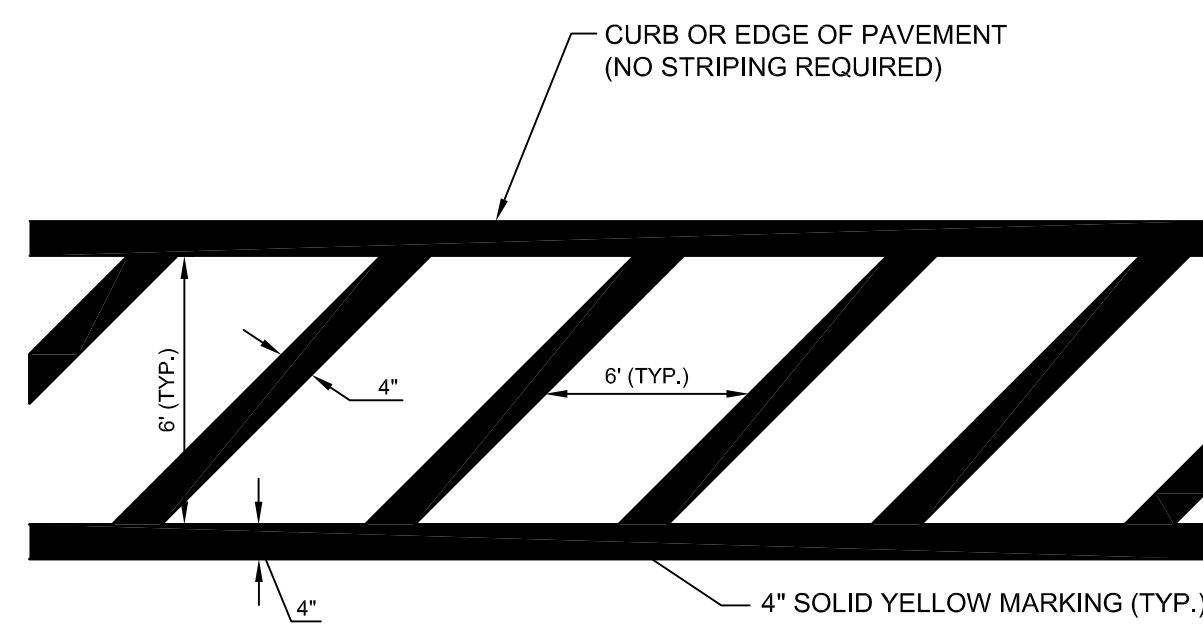

NOTE:  
USE CHEVRONS 3'-0" OUT FROM CURB W/ DIAGONALS AT 4'-0" SPACING TO DESIGNATE FIRE LANE IN BUS DROP-OFF AREA.

**(B) CHEVRON STRIPING DETAIL**  
N.T.S.

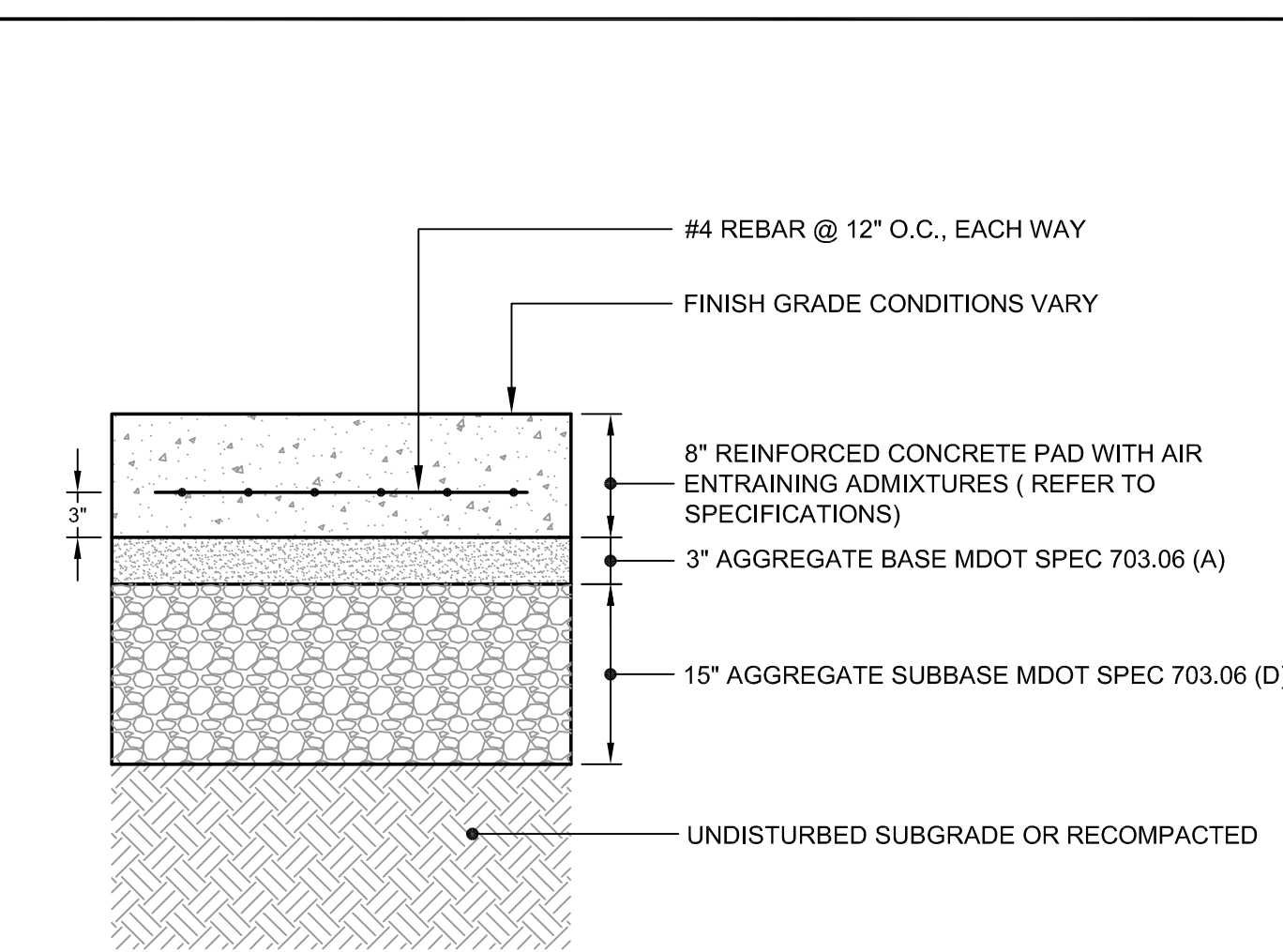

**(D) REINFORCED CONCRETE SECTION**  
N.T.S.

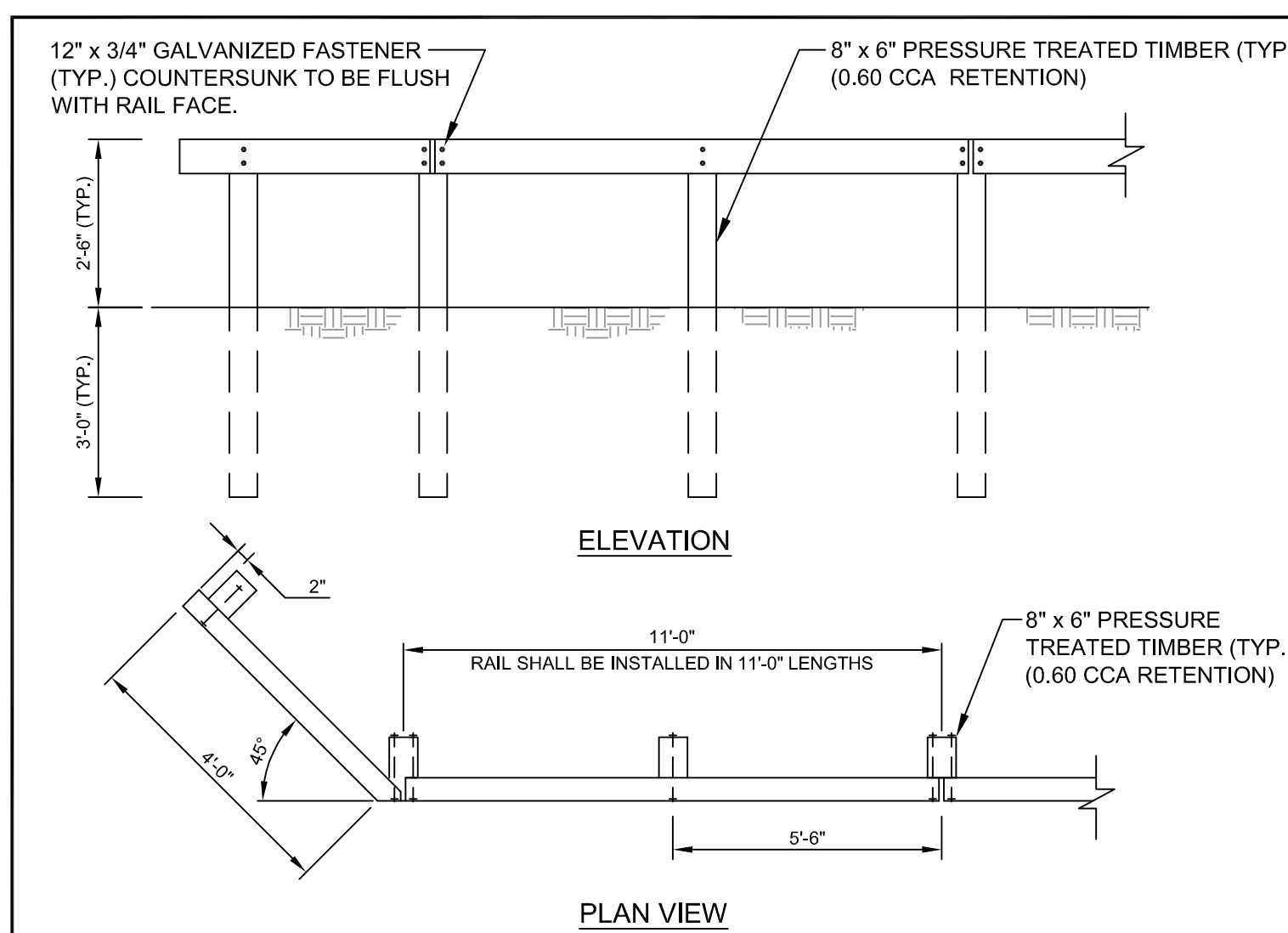

**(G) TIMBER GUIDERAIL DETAIL**  
N.T.S.

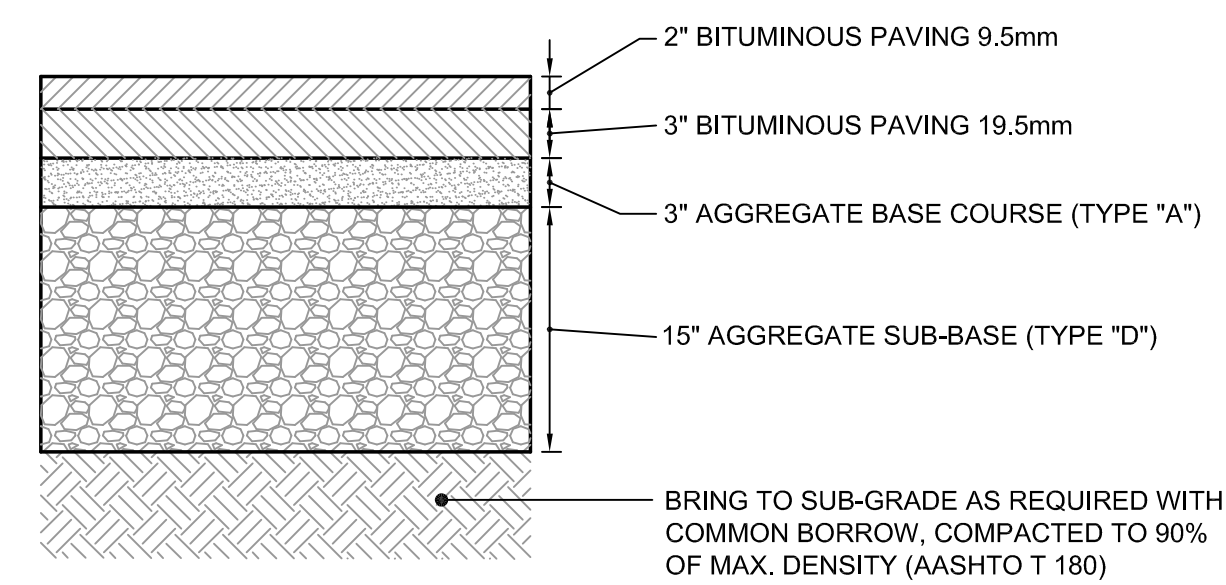

**(C) HEAVY DUTY BITUMINOUS CONCRETE PAVEMENT SECTION**  
N.T.S.

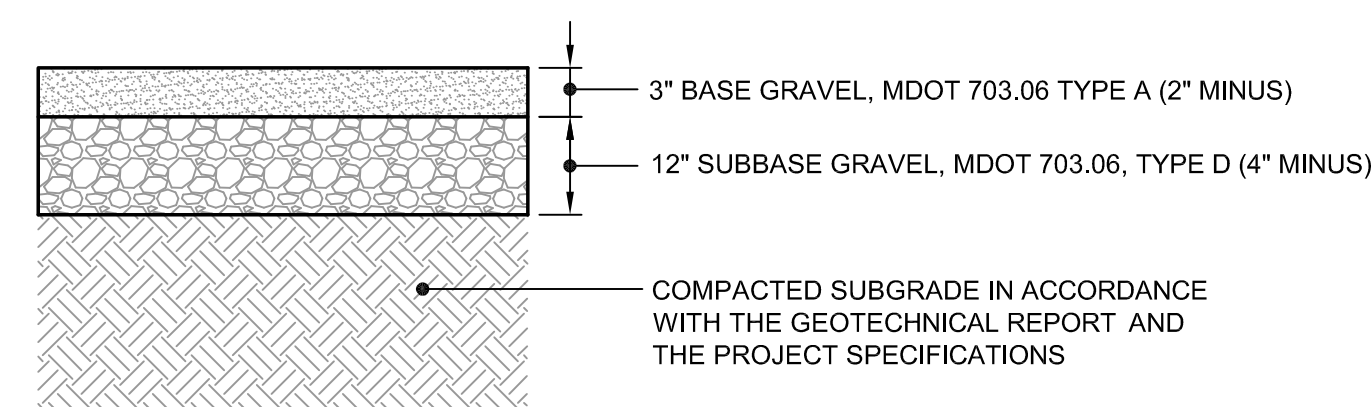

NOTES:  
ALL MATERIALS SHALL CONFORM TO MDOT SPECIFICATIONS, LATEST REVISION. COMPACTION OF ALL MATERIALS TO BE IN ACCORDANCE WITH THE SPECIFICATIONS AND THE GEOTECHNICAL REPORT.

**(E) GRAVEL SECTION**  
N.T.S.

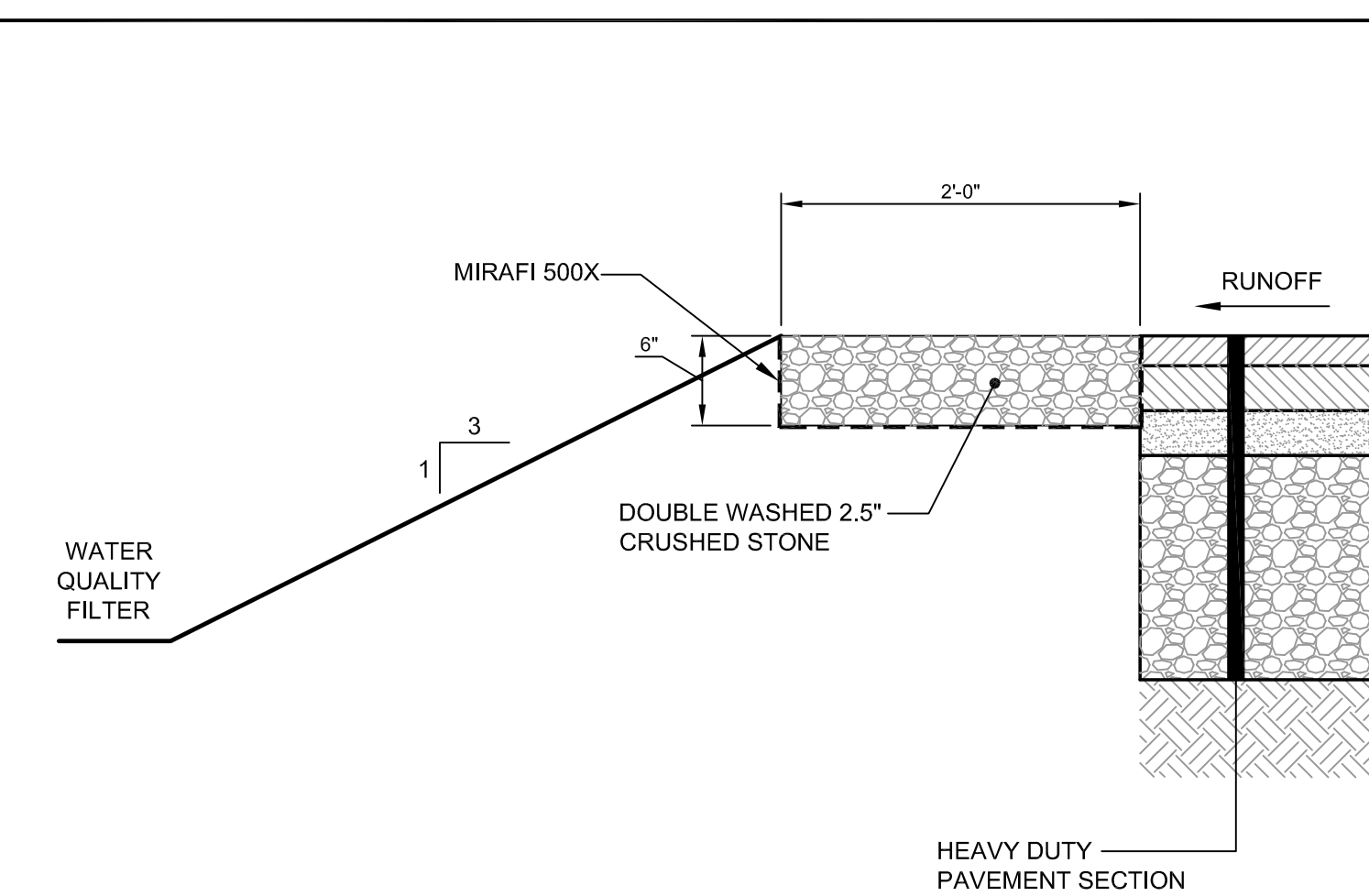

**(H) PRETREATMENT STONE DIAPHRAGM**  
N.T.S.

PRELIMINARY - NOT FOR CONSTRUCTION

REV	DATE	DESCRIPTION
2	08.09.13	REVISED PER CITY REVIEW COMMENTS
1	07.16.13	LEVEL II SITE PLAN APPLICATION
		REVISIONS

P.E. ROBERT J. WOODMAN  
LIC. # 12442

PROJECT PROPOSED TRUCK LOADING AREA AT 56 MILLIKEN STREET PORTLAND MAINE	ENGINEERS <b>FST</b> FAY, SPOFFORD & THORNDIKE, INC. ENGINEERS · PLANNERS · SCIENTISTS 778 MAIN ST, SUITE 8, SOUTH PORTLAND, ME 04106
SHEET TITLE <b>SITE DETAILS</b>	DATE: JULY 2013 SCALE: AS NOTED
CLIENT <b>JHR DEVELOPMENT OF MAINE, LLC</b>	DRAWN: CMW CHECKED: RJW FILE NAME: 3215-DET SHEET: C-6.1

