

COMPANY

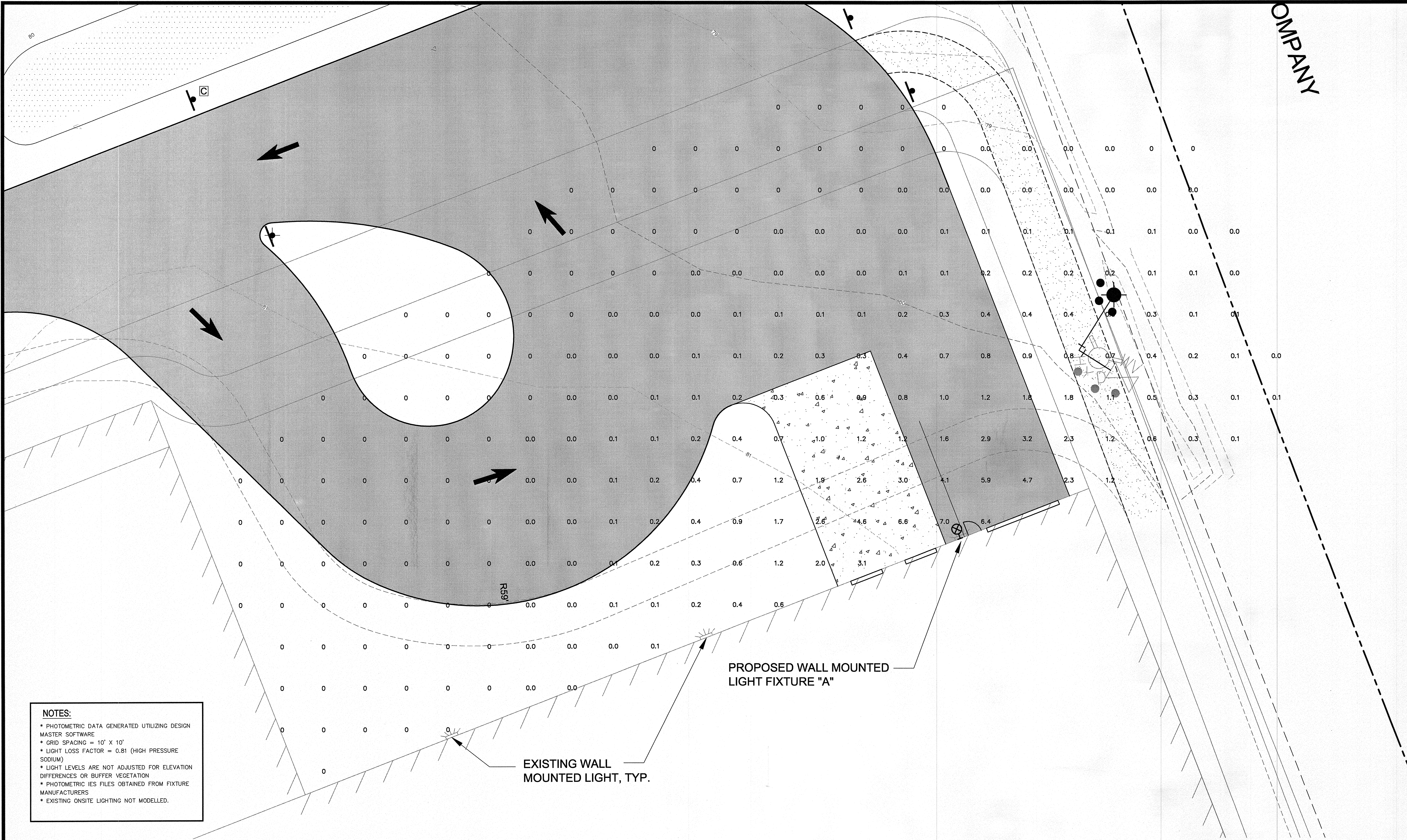

NOTES:

- * PHOTOMETRIC DATA GENERATED UTILIZING DESIGN MASTER SOFTWARE
- * GRID SPACING = 10' X 10'
- * LIGHT LOSS FACTOR = 0.81 (HIGH PRESSURE SODIUM)
- * LIGHT LEVELS ARE NOT ADJUSTED FOR ELEVATION DIFFERENCES OR BUFFER VEGETATION
- * PHOTOMETRIC IES FILES OBTAINED FROM FIXTURE MANUFACTURERS
- * EXISTING ONSITE LIGHTING NOT MODELLED.

LIGHT FIXTURE LEGEND

LIGHT FIXTURE A

KIM LIGHTING - WD18D3-250HPS OR EQUAL
250 WATT, HIGH PRESSURE SODIUM
WALL MOUNTED - MOUNTING HEIGHT = 18FT

PROPOSED WALL MOUNTED LIGHT FIXTURE "A"

EXISTING WALL MOUNTED LIGHT, TYP.

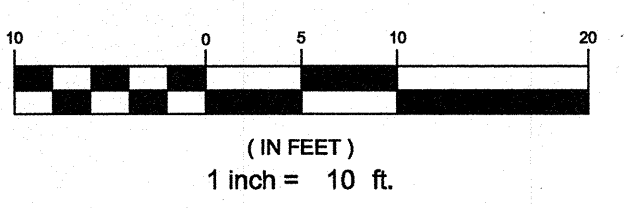

PRELIMINARY - NOT FOR CONSTRUCTION

REV	DATE	DESCRIPTION
1	07.16.13	LEVEL II SITE PLAN APPLICATION

REVISIONS

P.E. ROBERT J. WOODMAN
LIC. # 12442

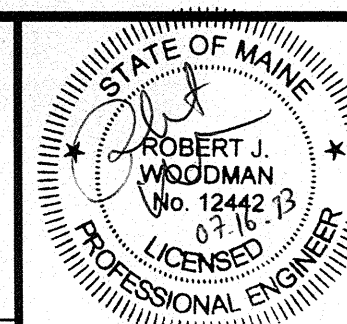

PROJECT
PROPOSED TRUCK LOADING AREA AT
56 MILLIKEN STREET PORTLAND MAINE

SHEET TITLE
PHOTOMETRIC PLAN

CLIENT
JHR DEVELOPMENT
OF MAINE, LLC

ENGINEERS
FST
FAY, SPOFFORD & THORNDIKE, INC.
ENGINEERS · PLANNERS · SCIENTISTS
778 MAIN ST, SUITE 8, SOUTH PORTLAND, ME 04106

DRAWN: CMW DATE: JULY 2013
DESIGNED: RJW SCALE: 1" = 10'
CHECKED: RJW JOB NO. 3215
FILE NAME: 3215-PHOTO
SHEET C-4.0