

DATE OF ISSUE

PRICING SET - 23 July 2013
 ISSUED FOR PERMIT - 23 July 2013

Paradigm Windows

56 Milliken Street, Portland, Maine

DRAWING LIST

GENERAL

- A0.00 COVER SHEET
- A0.01 LIFE SAFETY PLAN

STRUCTURAL DRAWINGS

- S1.01 STRUCTURAL DETAILS

ARCHITECTURAL DRAWINGS

- FLOOR PLANS
- A1.01 FLOOR PLANS

ELEVATIONS

- A2.01 ELEVATIONS & SECTIONS

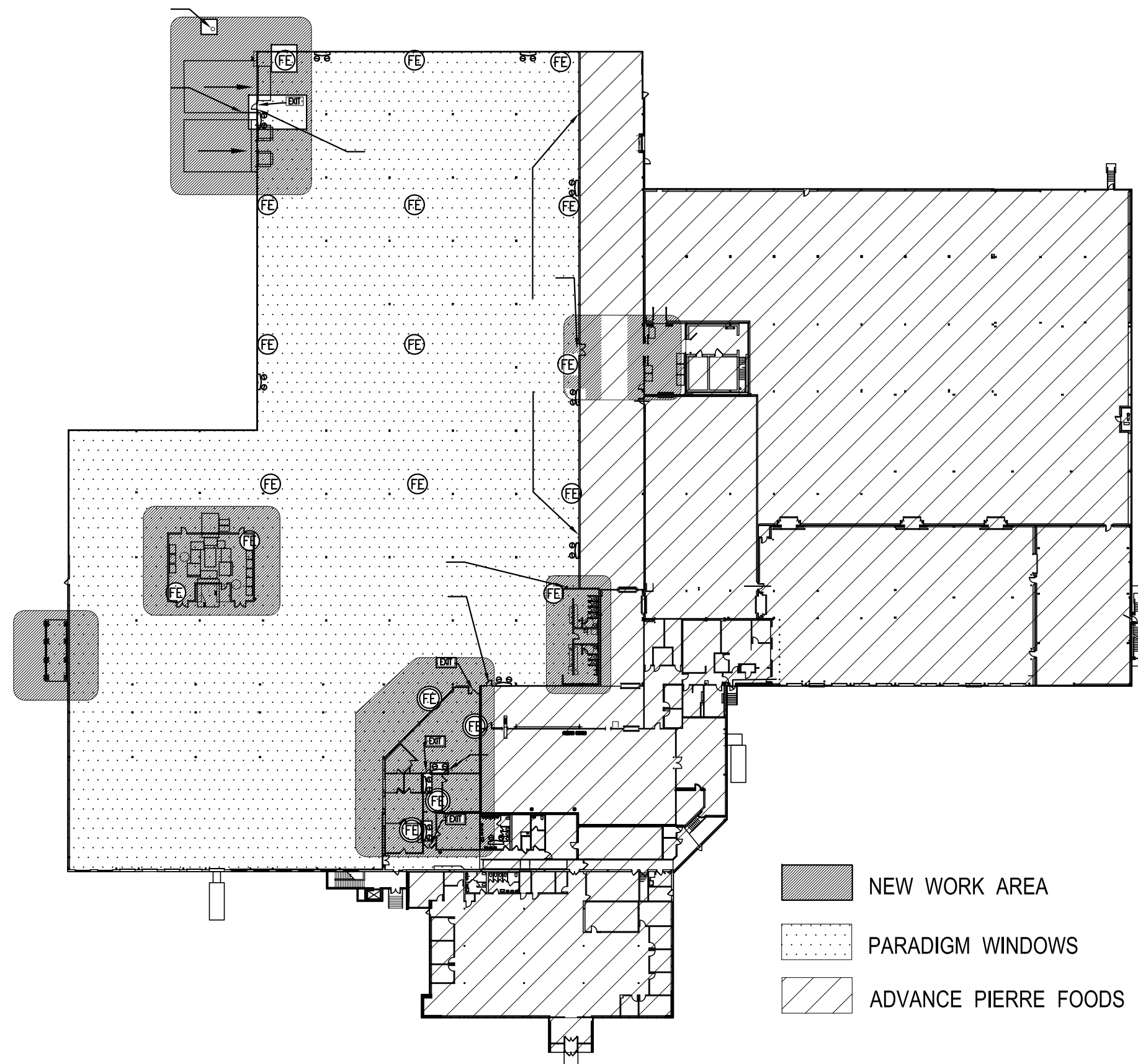

- NEW WORK AREA
- PARADIGM WINDOWS
- ADVANCE PIERRE FOODS

CONTACTS

Developer: JHR Development 169 Park Row, suite 5 Brunswick, ME 04011 (207) 729-0166	Architect: Archetype P.A. 48 Union Wharf Portland, ME 04101 (207) 772-6022	Structural Engineer: Structural Integrity Consulting Engineers, Inc. 77 Oak Street Portland, ME 04106 (207) 774-4614	Civil Engineer: Fay, Spofford & Thorndike 778 Main Street South Portland, ME 04106 (207) 775-1121	Contractor: Wright-Ryan Construction, Inc. 10 Danforth Street Portland, ME 04101 (207) 773-3625
--	---	--	---	---

AREA IDENTIFICATION LEGEND (N.T.S.)

RELEVANT CODES

<u>IBC 2009</u>	<u>REFERENCE</u>
• OCCUPANCY F-2 (FACTORY - LOW HAZARD)	306
• CONSTRUCTION TYPE IIB	T601
• ALLOWABLE FLOOR AREA F-2 (UNLIMITED) W/AUTOMATIC SPRINKLER	T503/507.3
• EXISTING FOOTPRINT F-2 (200,400 SQ.FT.)	
• SPRINKLED WITH NFPA 13 AUTOMATIC SPRINKLER SYSTEM	903.3.1.1
• ALLOWABLE HEIGHT F-2 (2) STORIES WITH SPRINKLER INCREASE	T503
• BUILDING HEIGHT (1) STORIES (EXISTING)	
• FIRE RESISTANCE RATING STRUCTURAL FRAME (0 HOURS)	T601
• FIRE RESISTANCE RATING BEARING WALLS (0 HOURS)	T601
• FIRE RESISTANCE RATING NON-BEARING WALLS AND PARTITIONS (0 HOURS)	T601
• FIRE RESISTANCE RATING FLOOR CONSTRUCTION (0 HOURS)	T601
• FIRE RESISTANCE RATING ROOF CONSTRUCTION (0 HOURS)	T601
• STANDPIPE NOT REQUIRED	905.3.1
• FIRE DEPARTMENT CONNECTION REQUIRED (AS DIRECTED BY FIRE)	903.3.6
• MANUAL ALARM NOT REQUIRED WHERE EQUIPPED WITH AUTOMATIC SPRINKLER SYSTEM	907.2.7
• SMOKE DETECTORS NOT REQUIRED	907.2.10
• DURING TIMES THAT THE BUILDING IS OCCUPIED, THE INITIATION OF A SIGNAL FROM A MANUAL FIRE ALARM BOX OR FROM A WATERFLOW SWITCH SHALL NOT BE REQUIRED TO ACTIVATE THE ALARM NOTIFICATION APPLIANCES WHEN AN ALARM SIGNAL IS ACTIVATED AT A CONSTANTLY ATTENDED LOCATION FROM WHICH EVACUATION INSTRUCTIONS SHALL BE INITIATED OVER AN EMERGENCY VOICE/ALARM COMMUNICATION SYSTEM	907.2.7.1

NFPA 101 LIFE SAFETY 2009

• USE GROUPS - INDUSTRIAL (SPECIAL PURPOSE)	40.1.4.1.2
• REMOTENESS OF EXITS: IN BUILDINGS PROTECTED THROUGHOUT BY AN APPROVED, SUPERVISED AUTOMATIC SPRINKLER SYSTEM, SEPARATION OF NOT LESS THAN 1/3 DISTANCE OF OVERALL DIAGONAL DISTANCE OF BUILDING OR AREA TO BE SERVED. (NOTE: BUILDING HAS BEEN DIVIDED INTO THREE GENERAL AREAS W/ SOME OVERLAP THAT DEMONSTRATES REQ'D SEPARATIONS. DETAILS SHOWN ON SHEET A0.01 - LIFE SAFETY PLAN)	7.5.1.3.3
• OCCUPANT LOAD: SPECIAL PURPOSE BASED ON PROBABLE OCCUPANCY OF 100 PERSONS	T7.3.1.2, 40.1.7
• CAPACITY OF MEANS OF EGRESS SIZED TO ACCOMMODATE OCCUPANT LOAD AS DETERMINED BY 40.1.7 (SEE ABOVE)	40.2.3.2
• NUMBER OF MEANS OF EGRESS: NOT LESS THAN 2 (ACTUAL: PARADIGM SIDE - 3 PROVIDED ADVANCE PIERRE SIDE - 8 PROVIDED)	40.2.4.1.1
• NO DEAD END CORRIDORS UNLESS PERMITTED BY, AND LIMITED TO THE LENGTHS SPECIFIED IN CHAPTERS 11 THROUGH 43.	7.5.1.5
• DEAD END CORRIDORS NOT TO EXCEED 50 FT.	T40.2.5
• COMMON PATH OF TRAVEL - 100 FT.	T-40.2.5
• MAXIMUM TRAVEL DISTANCE TO EXITS = 400 FT.	T40.2.6
• DISCHARGE FROM EXITS: DIRECTLY AT A PUBLIC WAY OR EXTERIOR EXIT DISCHARGE	7.7.1, 40.2.7
• ILLUMINATION OF MEANS OF EGRESS SHALL BE CONTINUOUS DURING OCCUPANCY	7.8.1.2, 40.2.8
• EMERGENCY LIGHTING REQUIRED	40.2.9
• MARKING OF MEANS OF EGRESS W/ APPROVED EXIT SIGNS, TACTILE SIGNAGE AND IN ACCORDANCE WITH ALL OTHER REQUIREMENTS OF 7.10.1.2, 7.10.1.3	
• FIRE ALARMS W/ AUDIBLE & VISIBLE SIGNAL IN AN ATTENDED LOCATION REQUIRED	40.3.4.3
• ONE HOUR RATED EXIT ACCESS CORRIDOR NOT REQUIRED	7.1.3.1 (2), 40.3.6
• FIRE EXTINGUISHERS PROVIDED TO MEET NFPA 10	

