

**ENLARGED FLOOR PLAN: DOCK AREA**  
 SCALE: 1/8" = 1'-0"  
 EXISTING WAREHOUSE FINISH FLOOR CALLED ELEVATION = 100'-0"

**KEY NOTES**

- DK1** EXISTING PIT LEVELERS TO BE REMOVED REFER TO DRAWING AD1.1 FOR SLAB REMOVAL INFORMATION
- DK2** FOUNDATION OPENING TO BE FILLED WITH CONCRETE - REFER TO A1.2
- DK3** SAWCUT NEW FOUNDATION OPENINGS AT EXISTING LEVELER PITS - COORDINATE SIZE WITH LEVELERS TO BE RELOCATED
- DK4** SAWCUT NEW FOUNDATION OPENINGS COORDINATE SIZE WITH LEVELERS TO BE RELOCATED - REMOVE COVERS AT VENT OPENINGS BELOW - INFILL WITH CONCRETE
- DK5** NEW OHD WALL OPENINGS COORDINATE WITH DOOR SIZE REQUIREMENTS REFER TO A1.2

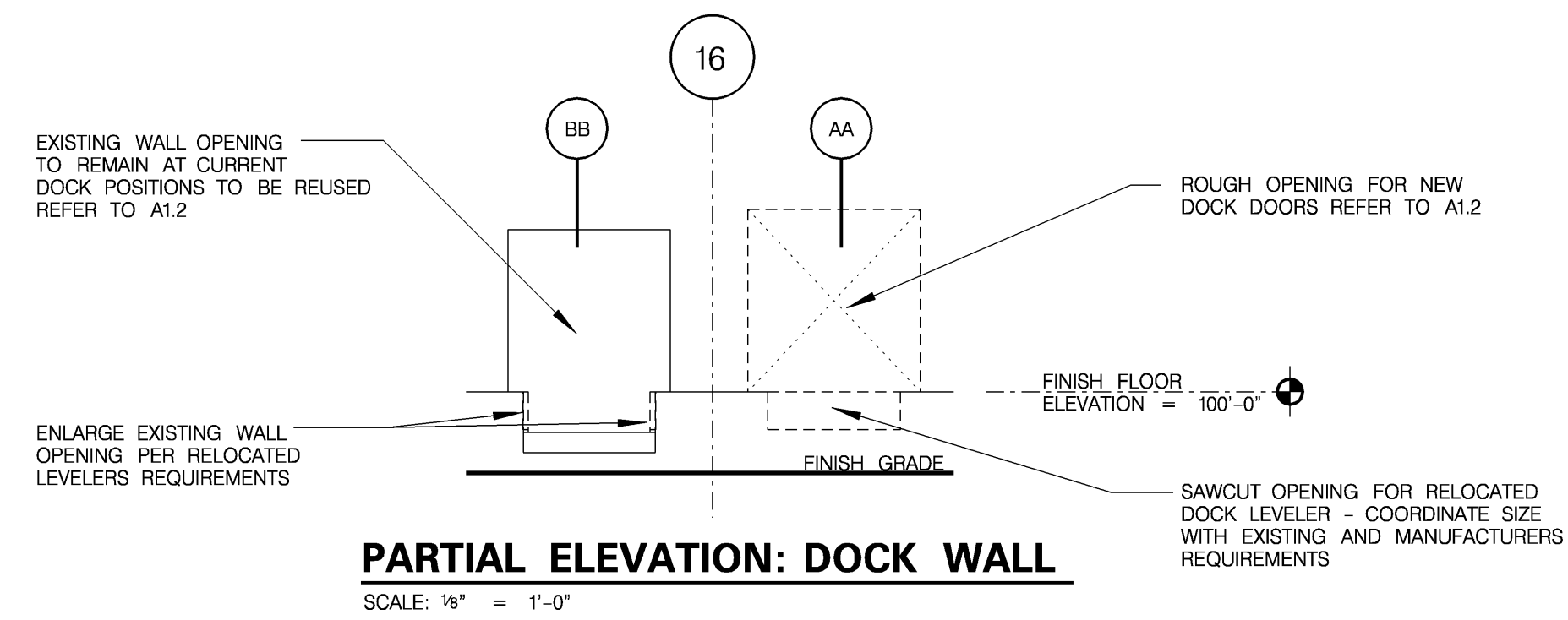

**PARTIAL ELEVATION: DOCK WALL**  
 SCALE: 1/8" = 1'-0"

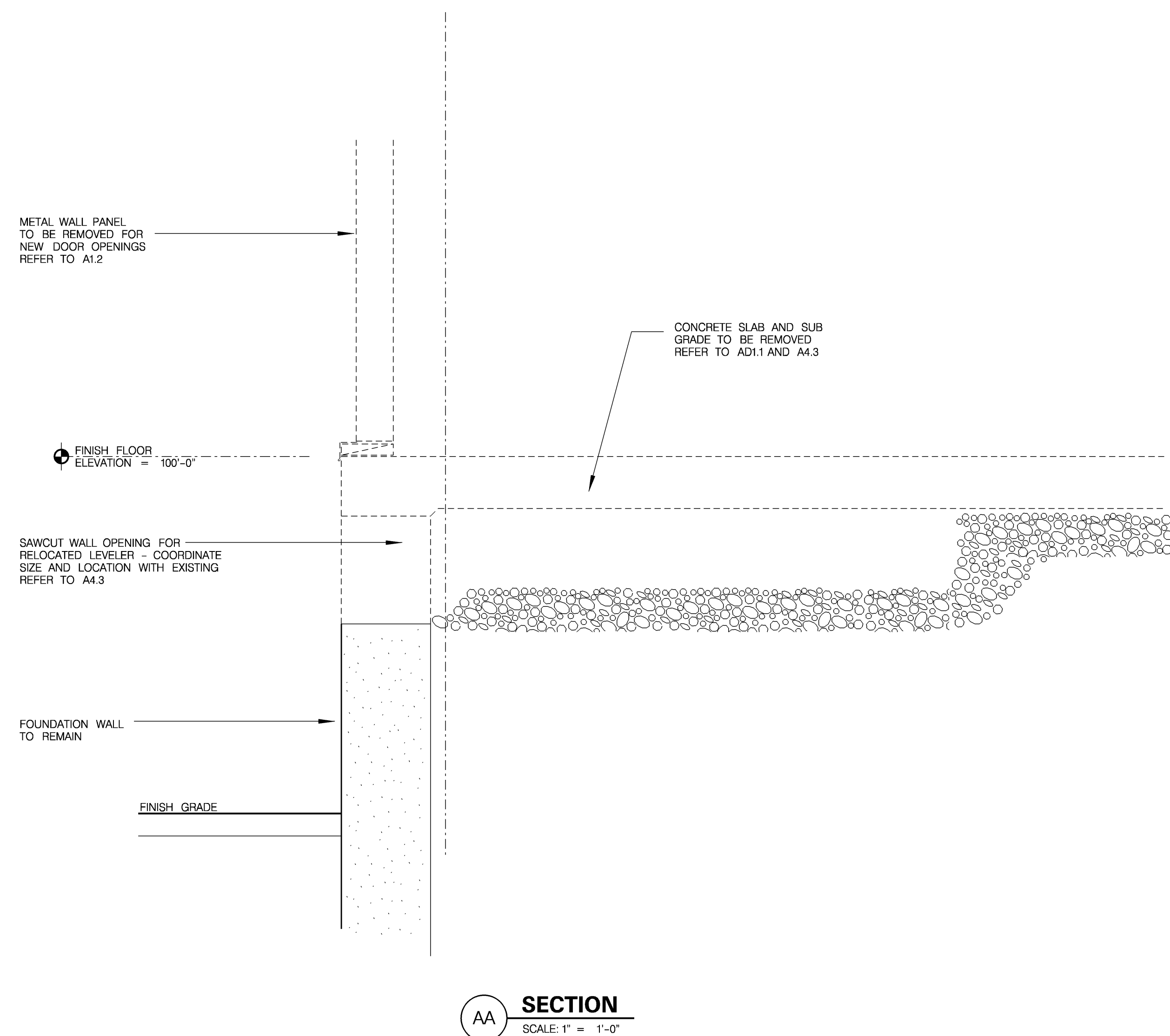

**SECTION AA**  
 SCALE: 1" = 1'-0"

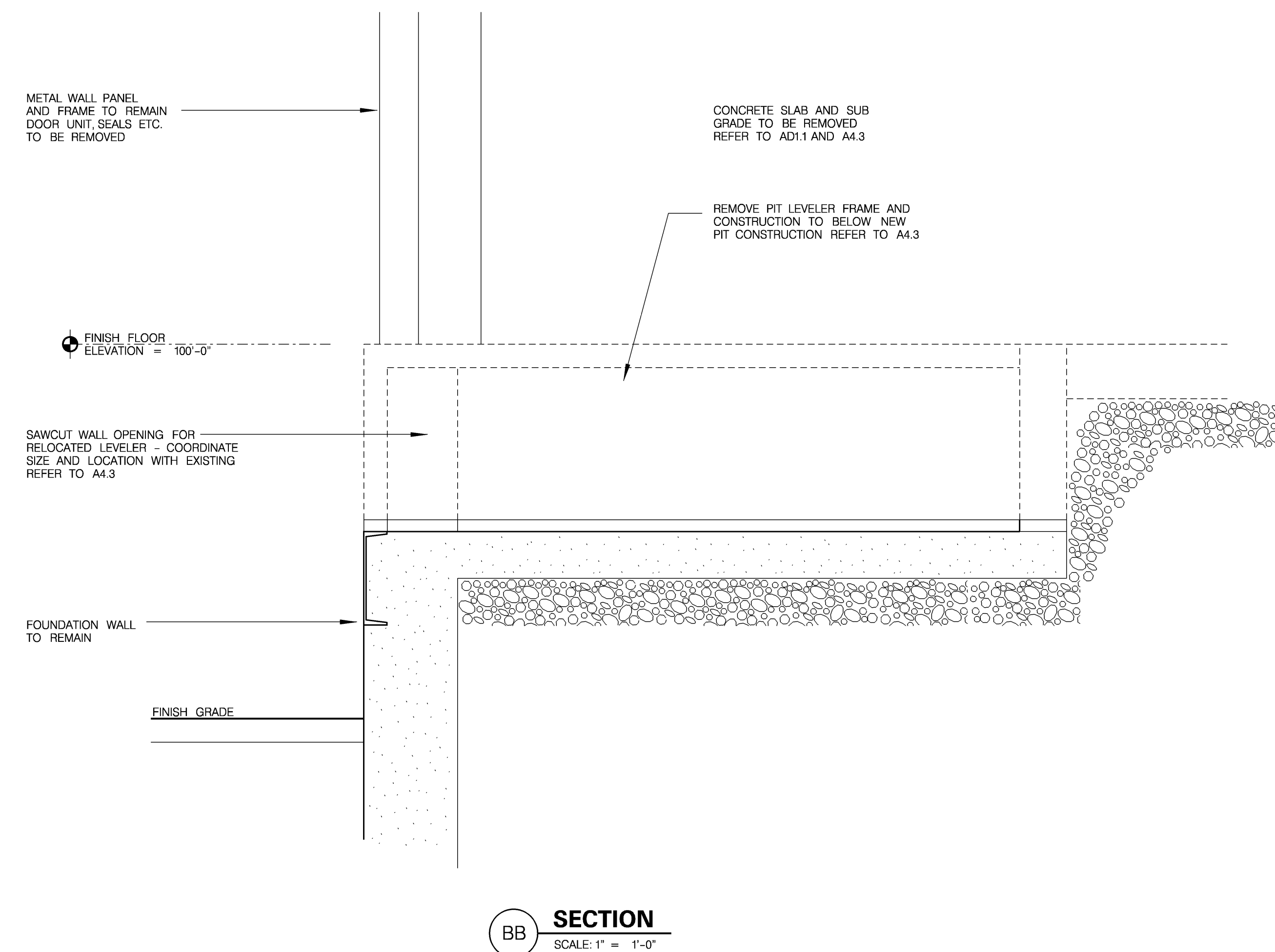

**SECTION BB**  
 SCALE: 1" = 1'-0"

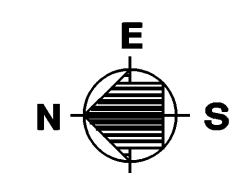
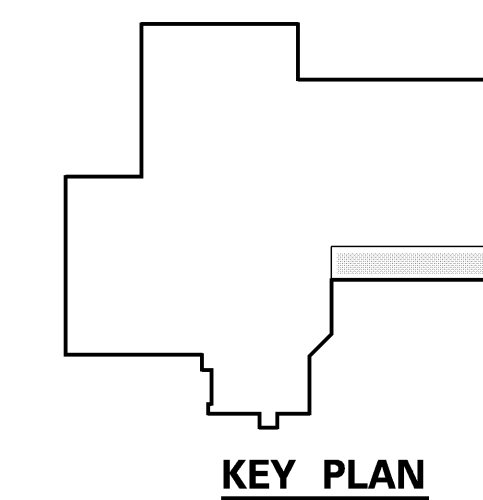

| DATE     | DESCRIPTION      |
|----------|------------------|
| 11-17-04 | RELEASED FOR BID |
| A        | ACTION           |

Warehouse and Office Renovations for :  
**BARBER FOODS**  
 Portland, Maine

**DEMOLITION FLOOR PLAN AND DETAILS - DOCK AREA**

PLANNERS - ENGINEERS - BUILDERS :  
**FOOD TECH STRUCTURES, LLC**  
 2100 WASHINGTON STREET  
 HANOVER, MA 02339  
 Tel: (781) 261-9700  
 Fax: (781) 261-9701

**FOOD TECH**

DATE : 11-17-04  
 DESIGNED BY : lbs  
 DRAWN BY : psA,pc  
 CHECKED BY : dsW

DRAWING NO.

**AD1.3**

**0412**